

Twickenham Riverside Landscape & Public Realm Strategy



Design Team

Client	London Borough of Richmond upon Thames
Project Manager	Arcadis
Architect	Hopkins Architects
Landscape Architect	LDA Design
Structural Engineer	Webb Yates Engineers
Mechanical & Electrical Engineer	Skelly & Couch
Transport Consultant	WSP
Quantity Surveyor	Arcadis
Planning Consultant	Savills
Townscape & Heritage Consultant	Iceni Projects
Sustainability Consultant	Method Consulting
Accessibility Consultant	Lord Consultants
Fire Consultant	FDS Consult UK
Ecology Consultant	BSG Ecology
Arboricultural Consultant	Thomson Environmental Consultants
Daylight & Sunlight Consultant	GIA Chartered Surveyors
Acoustic Consultant	TetraTech
Air Quality Consultant	Entran
Land Contamination Consultant	Geosphere Environmental
Archaeological Consultant	AOC Archaeology Group
Viability Consultant	Lambert Smith Hampton
Principal Designer	Nick Perry Associates
BIM Consultant	BIM Technologies

Context

Connections to the Thames Heritage

The position of Twickenham Riverside on the banks of the river Thames is key to understanding the site's cultural and historic character. For centuries the Thames has connected London to the rest of the world, running through the heart of the capital it has been the focus of trade and connectivity, culture and leisure and has united Londoners.

The site at Twickenham has a long history of being used as a destination for leisure and recreation, being in close proximity to the surrounding 18th and 19th century manor houses, records of recreational uses of the site by people of 'fashion and distinction' date back to the 18th century.

The landscape design aims to continue the traditional use of the site for various recreational activities and draw on some of the colourful history to create a new character for the people of Twickenham today. The nearby historic parklands to the manor houses provide the perfect context for a beautiful modern recreational green space on the banks of the Thames.



Context

Twickenham's Local Distinctiveness

Modern day Twickenham is a vibrant town with a strong identity. It is famous for being the home of rugby, and has historic recreational roots in 18th and 19th century pleasure grounds and manor houses.

There is a strong sense local community, and a variety of activities, events and festivals in the surrounding area. - a few examples shown in the adjacent photographs.

The aspiration for the landscape design is to provide a new space that will enable the community to come together and accommodate existing and new gatherings.



Best Banger Festival



Holly Road Farmers Market



Concert next to St Mary's Church



Church Street Market



Church Street temporary installation

Context
Connections to the Thames Heritage



Riverside downstream of site

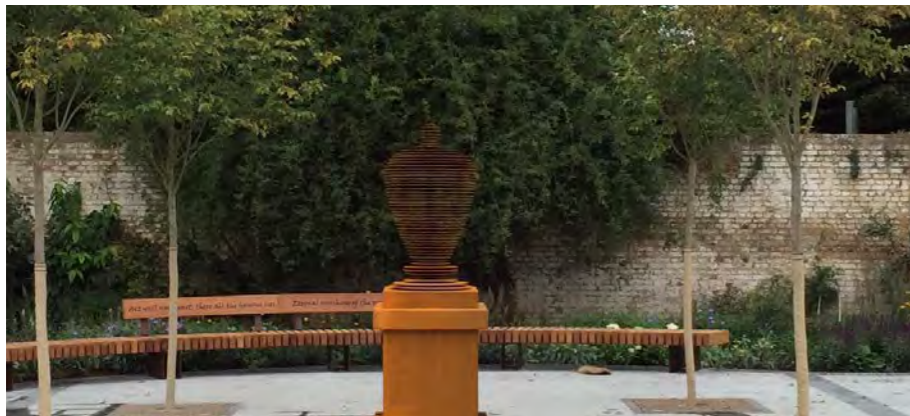

Nearby gardens



Nearby gardens



Nearby Manor House



Boathouses and river activity in Richmond



Riverside within site



View upstream along Thames path towards site and Eel Pie Island Bridge

Principles

Connecting People and Place through Landscape

The landscape design builds on the location of the site between the medieval town centre and the water. The connection to the water and the surrounding parklands is used as the inspiration to create a new biodiversity recreational space for Twickenham.



Nature and Biodiversity



The River Thames – is the key defining landscape and cultural feature of the valley. Maximise the opportunity to connect Twickenham to the water and its rhythms.



Heritage of the town centre – Twickenham Riverside is part of the medieval town centre and should reinforce its sense of place.



Historic landscape context – the riverside path connects this unique landscape setting to Twickenham Riverside. The public realm should reflect this.

Principles

Continuation of Green Corridor

Extending the green corridor along the Thames path is an important design principle for the gardens and town square, continuing the riverside garden typology.



Continuation of green corridor into the site

Design Masterplan

The project aims to reconnect the site with the river and provides a variety of spaces for different uses and activities, from quiet to sociable, and informal to formal gatherings.

1. Existing Oak tree retained
2. Planted terraces
3. Accessible route to gardens
4. Cafe with out door seating
5. Lawn terraces
6. Accessible sloped path to gardens
7. Service bays for Eel Pie Island
8. Existing slipway to be repaired
9. Feature tree with seating
10. Petanque under London Plane trees
11. Play area
12. Vehicle access and storage
13. Hornbeam trees and planted buffer
14. Ampitheatre / seating terraces
15. Town Square / event space
16. Riverside promenade
17. Pub / restaurant outdoor terrace and seating
18. Secure boat store
19. River activity space
20. Floating pontoon
21. Floating ecosystem
22. Rain garden
23. Service bay and parking
24. Shared surface entrance to gardens
25. Service road
26. Additional cycle parking







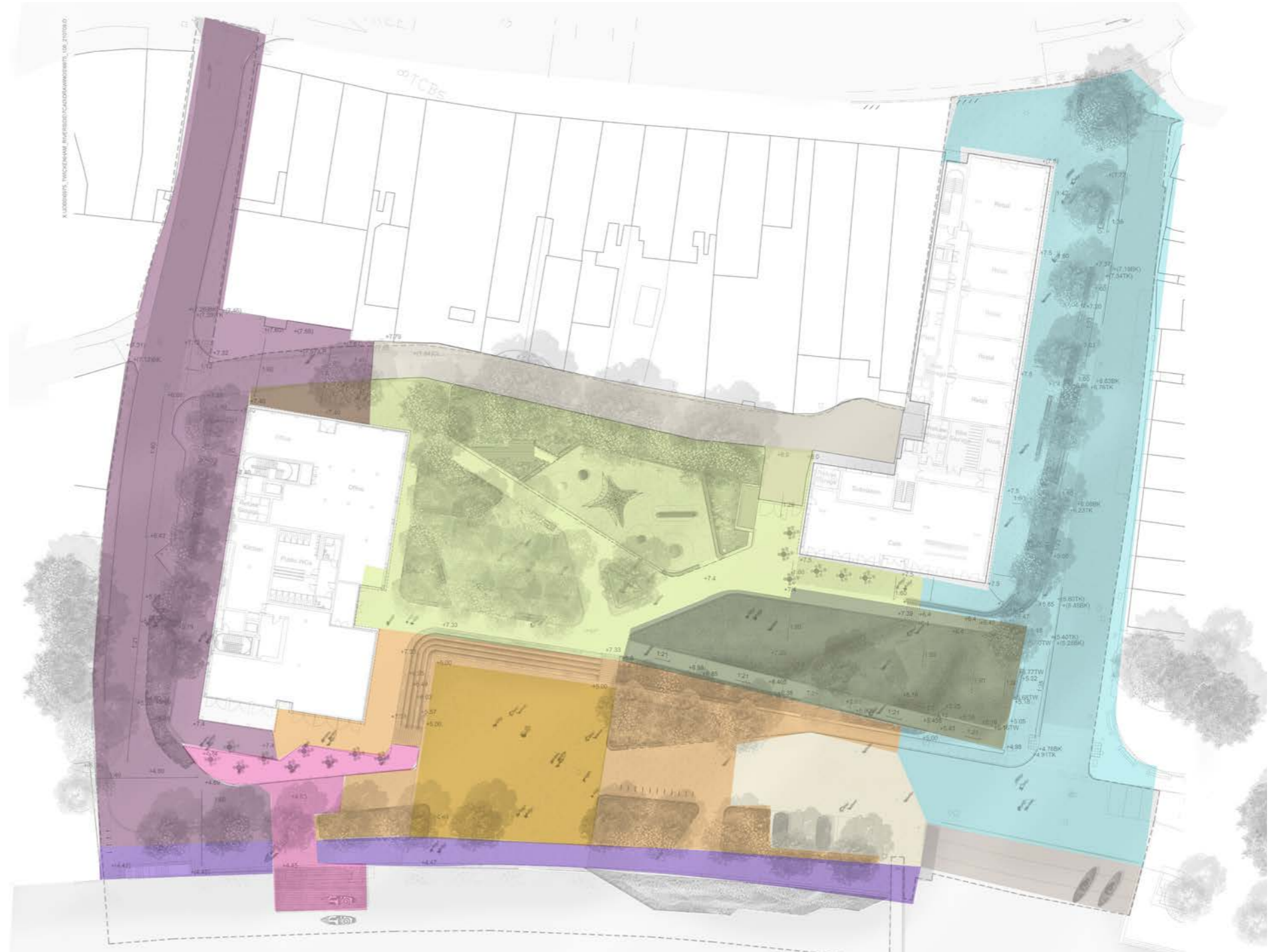

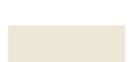

Design Character Areas

The adjacent plan shows an overview of the main spaces within the site and their proposed function and character.



Key

	The Gardens		River Gardens		River Promenade		Service Road /Area		Water Lane
	Lawn Terraces		River Activity Area		Town Square		Slip Way		Wharf Lane

Design Water Lane



Cycle stands

Existing oak tree retained with seating

Entrance sign and information

Accessible route to gardens

Steps

Planted terraces and seating

Steps to gardens

Lawn terraces



Perennial and herbaceous flowering



Seating and planted terraces

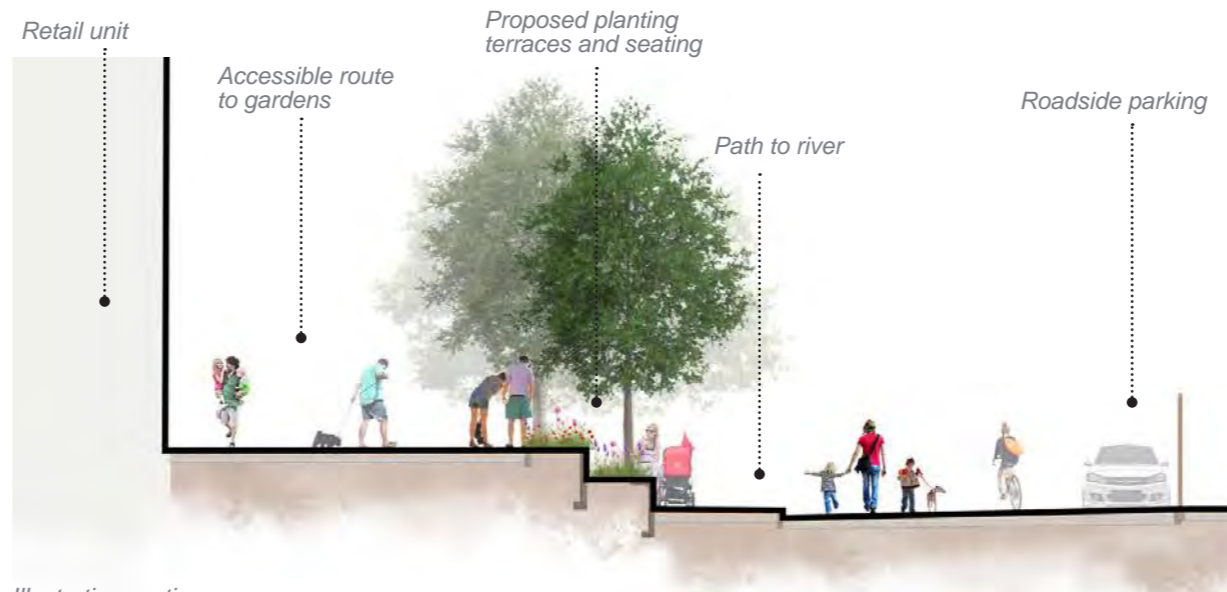

Illustrative section

The existing Oak tree at the top of Water Lane is to be retained with new seating, signage and cycle parking to create a welcoming public space. The high quality stone paving used in Church Lane will continue down Water Lane to create a single connected public space.

The new building adjacent to Water Lane is to be set back from the pavement, creating a widened public space all the way down Water Lane, an accessible route round into the gardens, and an improved view down to the river.

As Water Lane slopes down towards the river, planted terraces with integrated seating step down from the path adjacent to the building to the pavement.



Existing Oak tree at corner of King Street and Water Lane

Design
Water Lane



Design Lawn Terraces

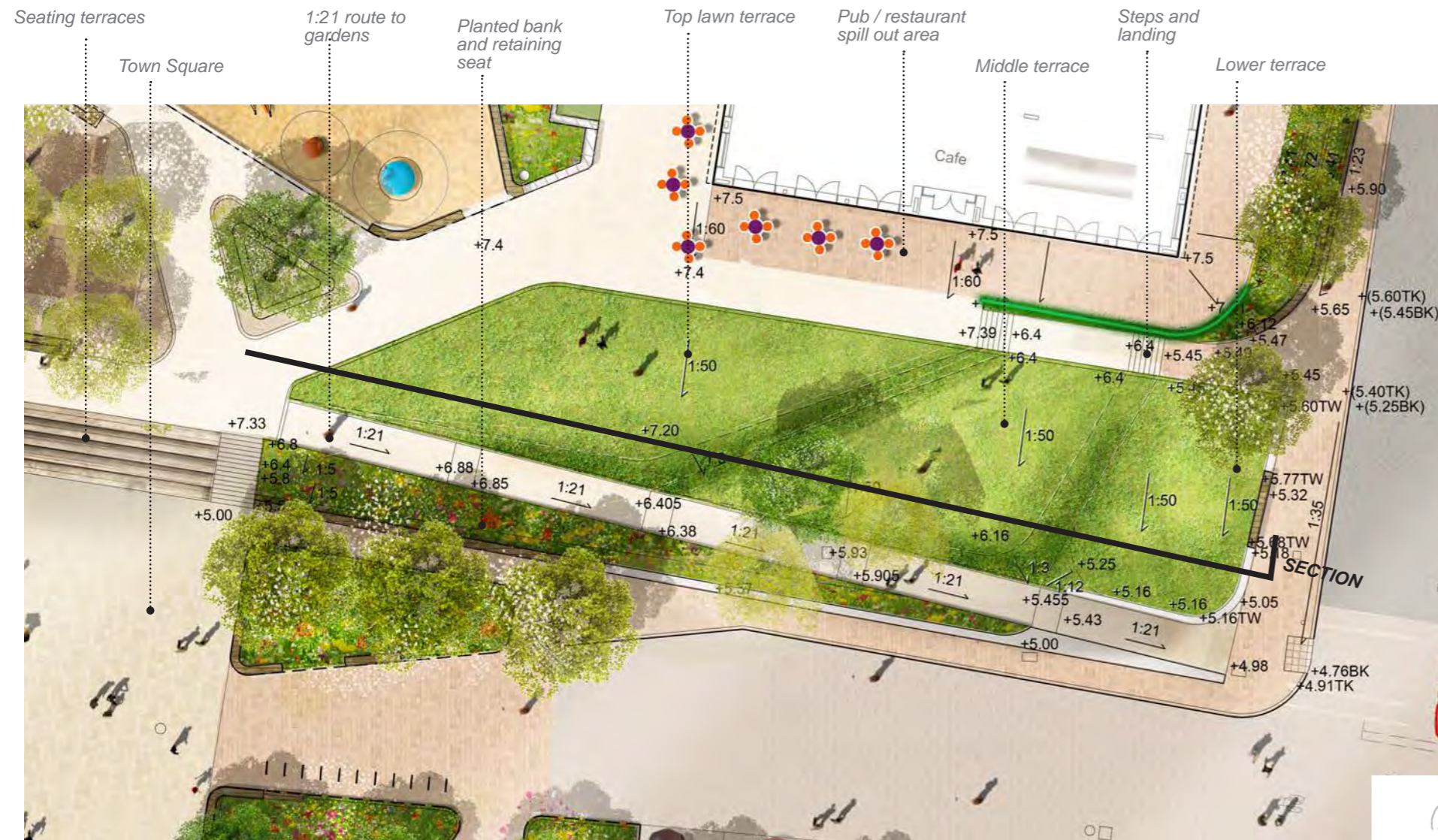

Lawn Terraces plan

The lawn terraces comprise three flat areas with sloped grass banks between as they step down towards Water Lane. They have been designed so can be used flexibly for a variety of uses from informal sitting and relaxing and enjoying the view of the river, to more formal events and activities.

The top lawn is level with the adjacent paved area of outdoor cafe seating, and movable furniture could be provided on the grass terraces to extend this use. Each terrace is directly accessible from the adjacent graded path that provides a connection between the river front and the gardens.



Sociable lawn terraces

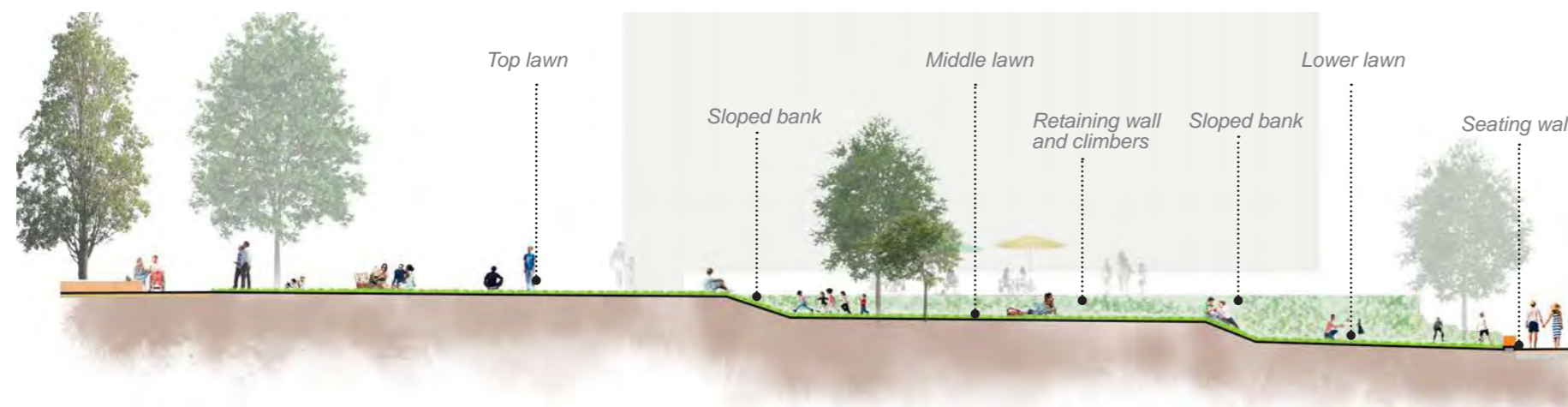

Section through lawn terraces



Example of grass bank with similar gradient and height

Design
Lawn Terraces



Design Diamond Jubilee Gardens

The garden is designed as a lush green space that wraps around the play area and two petanque courts. The existing pleached London Plane trees are to be carefully re-located so they provide a frame for the petanque courts, and the existing Black Poplar tree is to be moved to down along the riverside promenade.

Two of the existing Hornbeam trees adjacent to the service road are to be retained and protected, with the raised planter extended in order to provide these trees with more soil. This raised edge to the planters is to be designed as a seating wall and defines the boundary of the sunken sand play area. The wall raises up towards the cafe, to become a low climbing wall.

Between the play area and the cafe there is space for vehicles to turn and access the gardens through the gate, and next to the gate is a secure store to be used by the Trust for storing furniture and equipment used for events and activities.

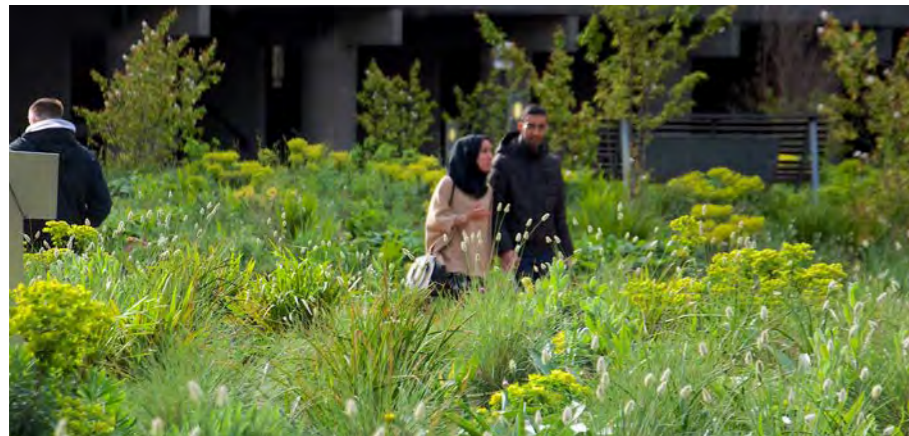

Planting beds



Climbing net primary

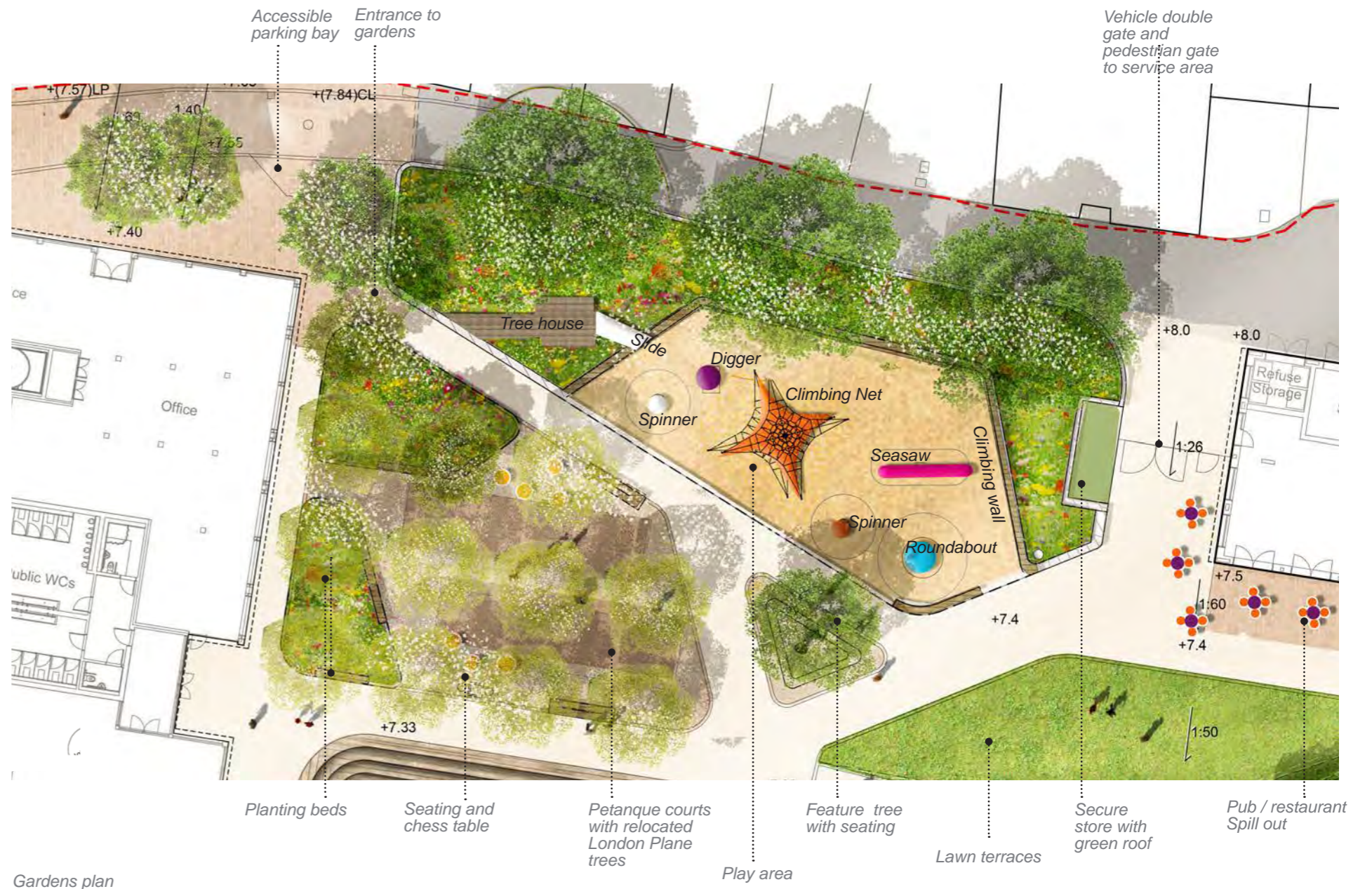

Gardens plan



Existing pleached London Plane trees to be moved to new location



Spill out space to cafe



Black poplar tree relocated along riverside

Design
Diamond Jubilee Gardens



Design
Diamond Jubilee Gardens



Design Town Square

This paved flexible event space extends from the timber seating terraces down to the riverside and has been designed to accommodate a wide variety of different as illustrated on the next page. External lighting, power and water will be provided around the perimeter of the space.

The terraces that form the two sided amphitheater, and that step up to the gardens, are to be constructed from chunky timbers to provide comfortable seating overlooking river.

The trees and planting beds between the Town Square and vehicle service bays provide a space of shade and seating by the river, and also function as a visual and acoustic buffer between these two spaces.



Timber terraces to water edge



Town square

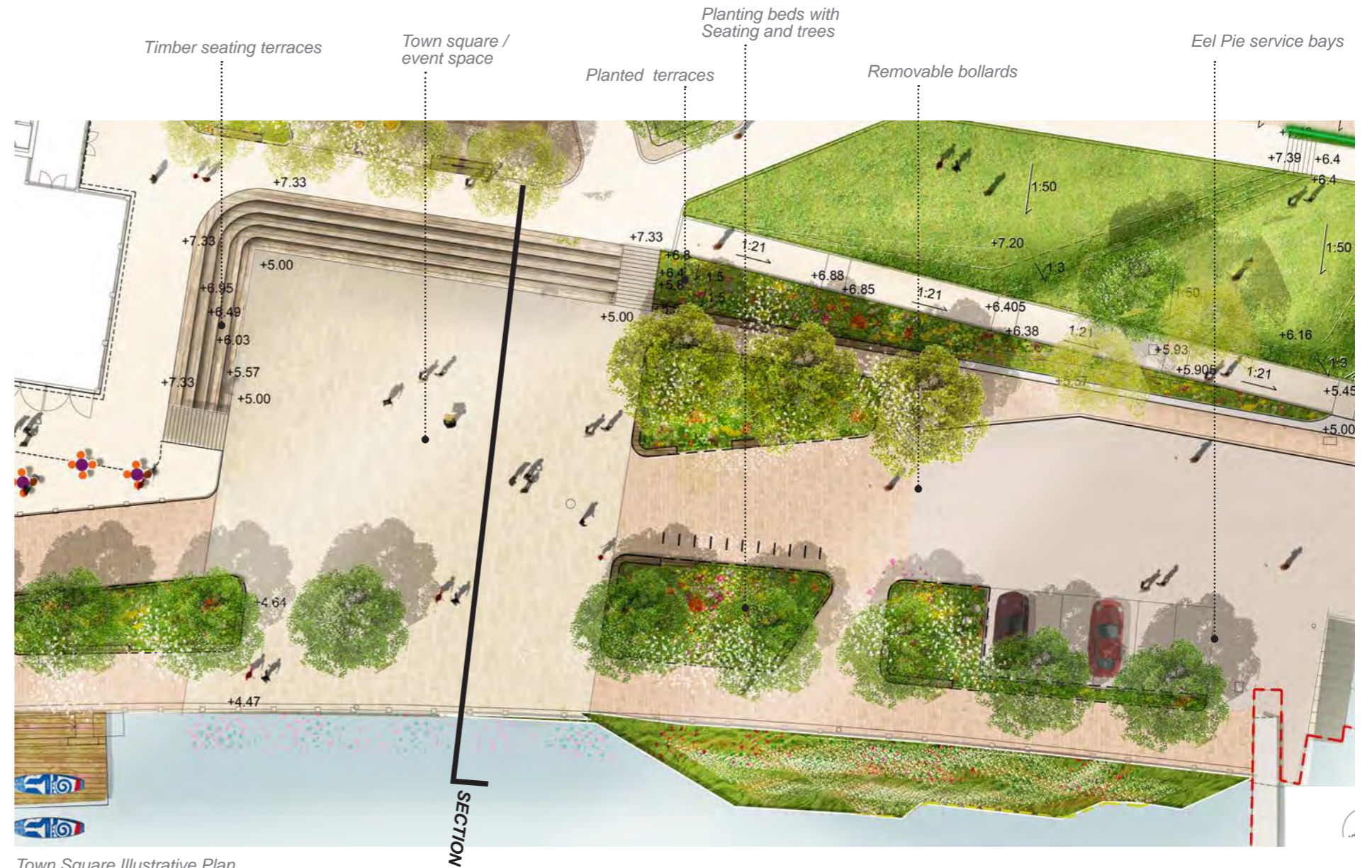

Town Square Illustrative Plan



Illustrative section

Design

Town Square - Event capacity studies

The dimensions and proportions of the space have been scaled to accommodate a wide variety of temporary events including concerts and markets.

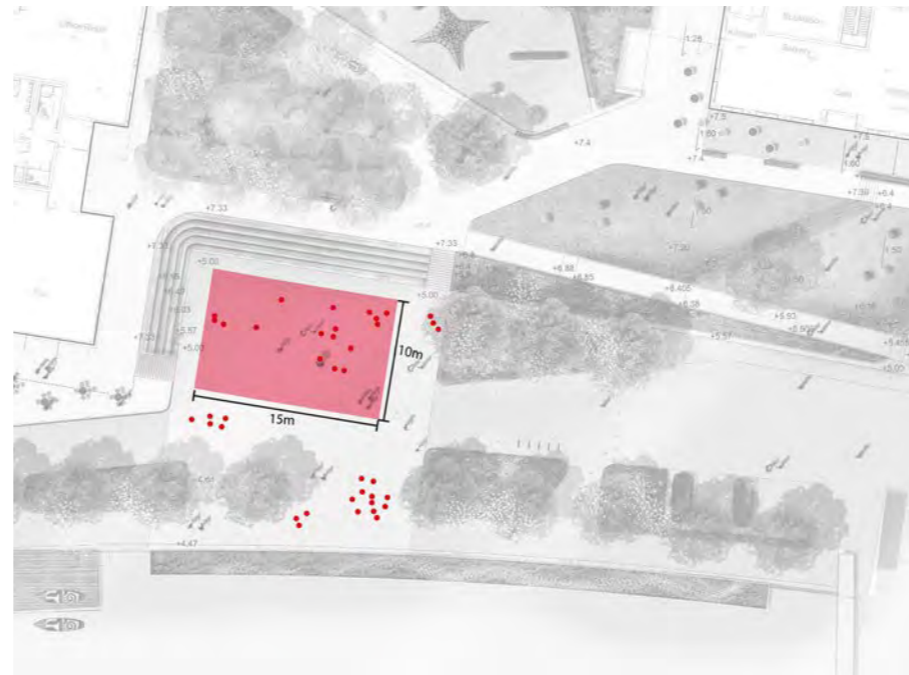
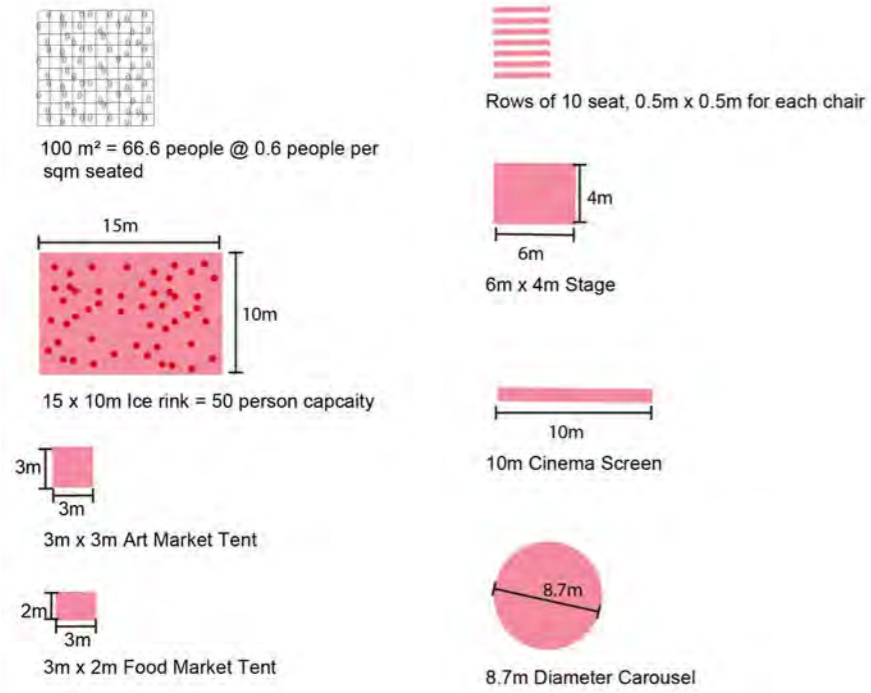

Ice Skating



Cinema



Farmers market

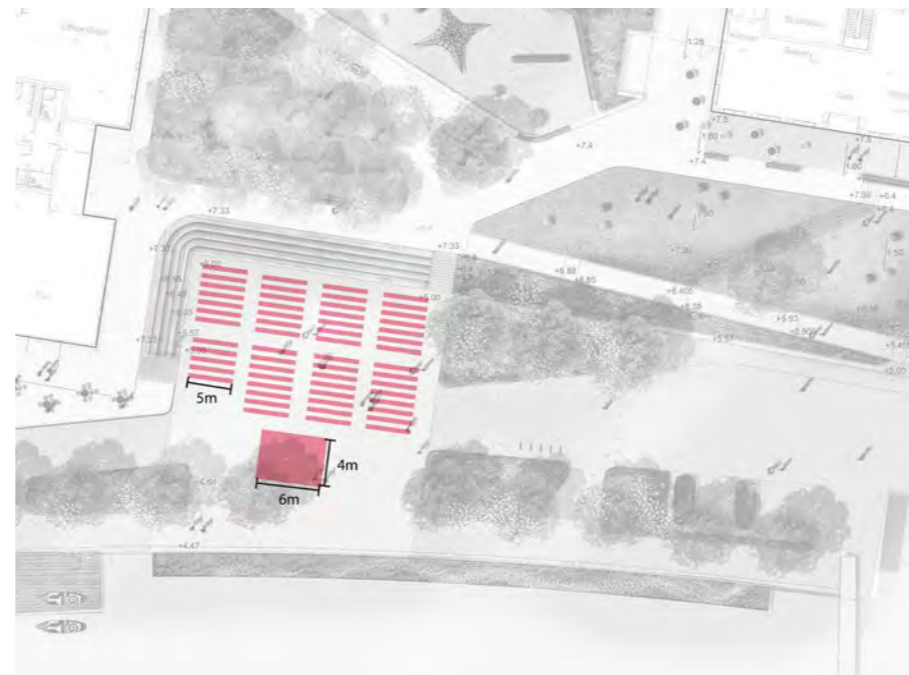

Concert

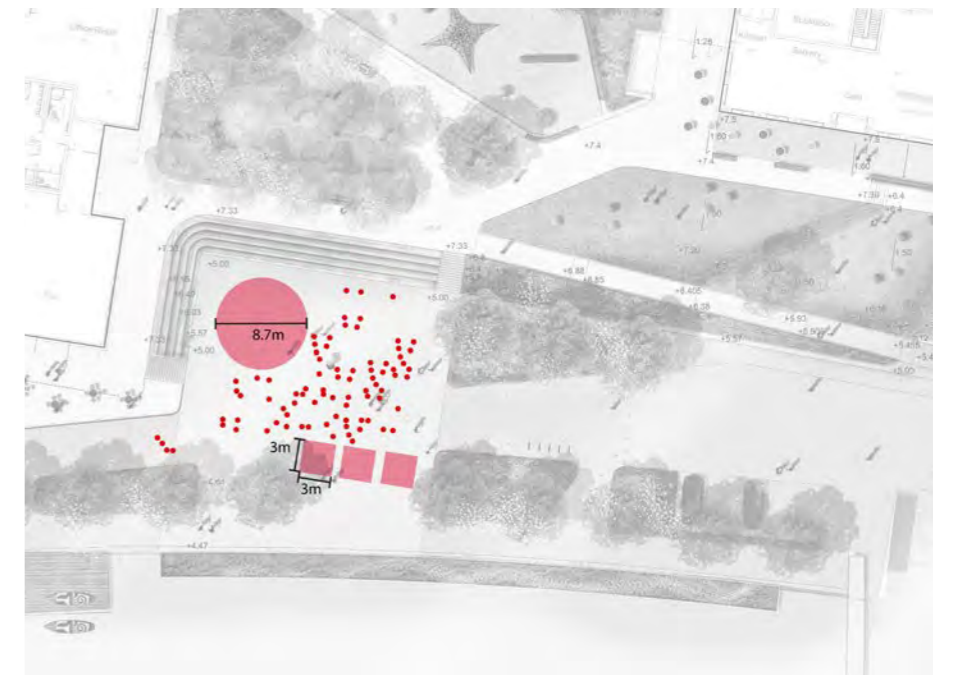



Fun fair

Design

Town Square - Scale comparisons

Covent Garden

-  Precedent Site Area
-  Twickenham Riverside Square Area

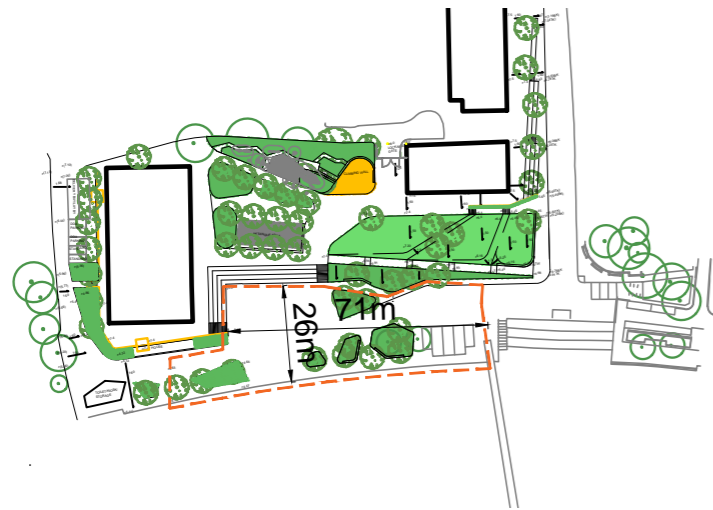

Twickenham Riverside - area of Town Square

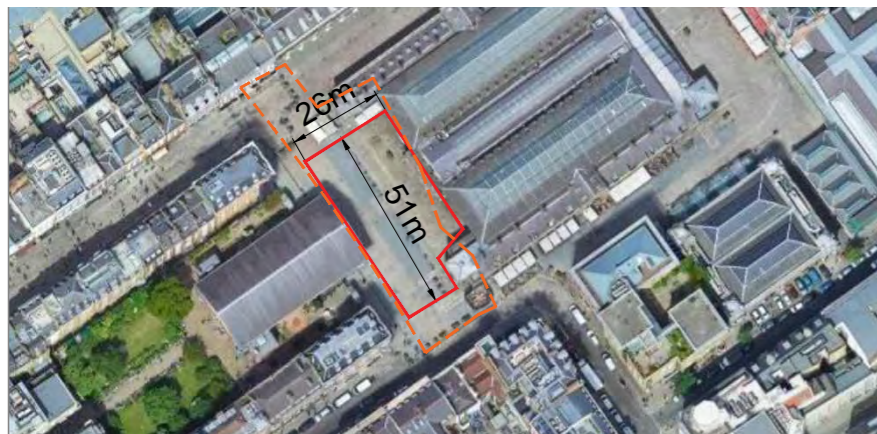

Covent Garden - Performance area