

# PLANNING

Elements for demolition/ removal

Non-original timber cupboards removed

New door penetration to create access to new WC

Doors removed to connect spaces

Single storey rear building extended.

Non-original stud partition removed to connect spaces

Open historic window to create doorway to new extension

Existing Foul Drain

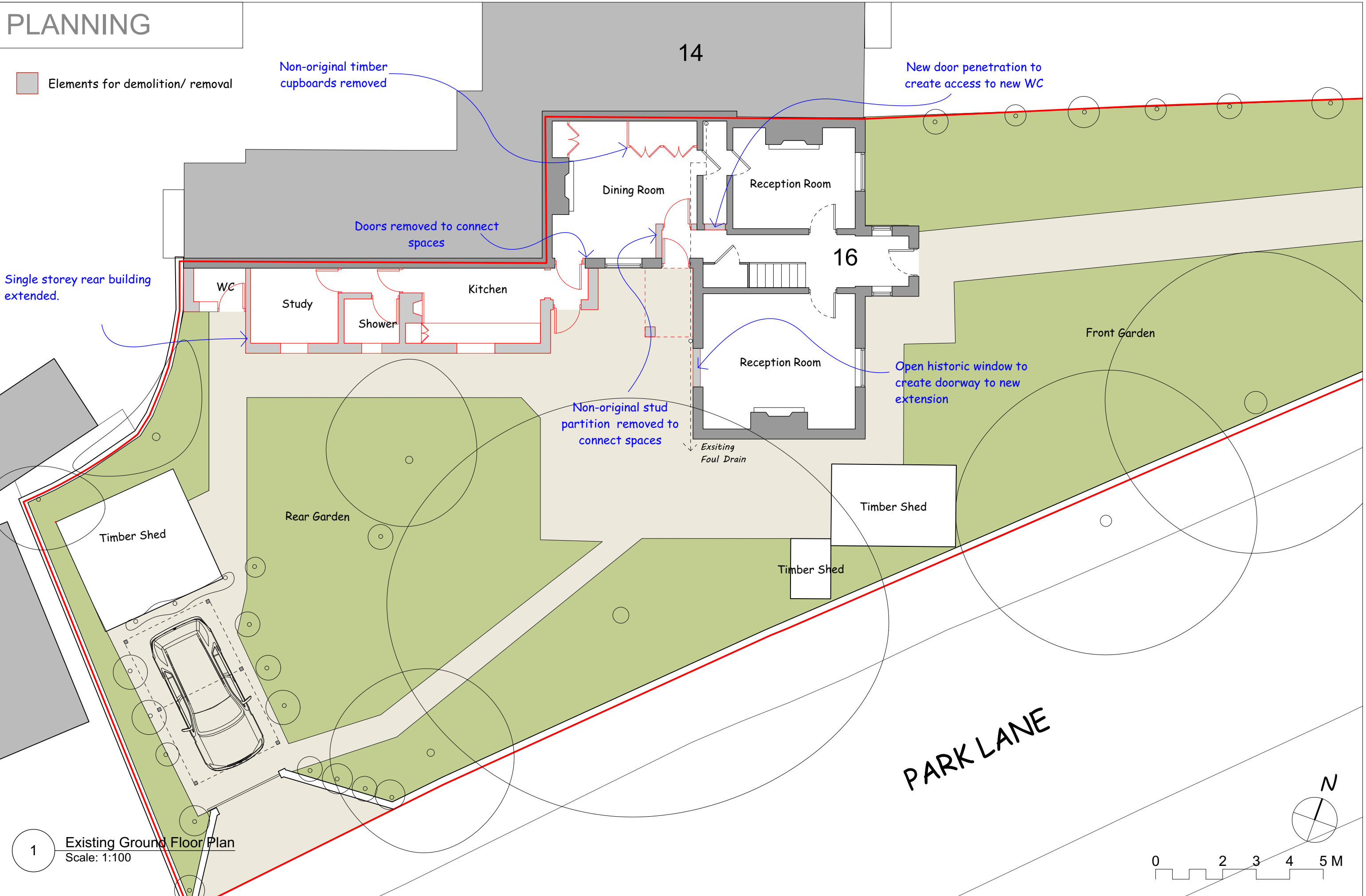

1 Existing Ground Floor Plan  
Scale: 1:100