

Flat 01 :

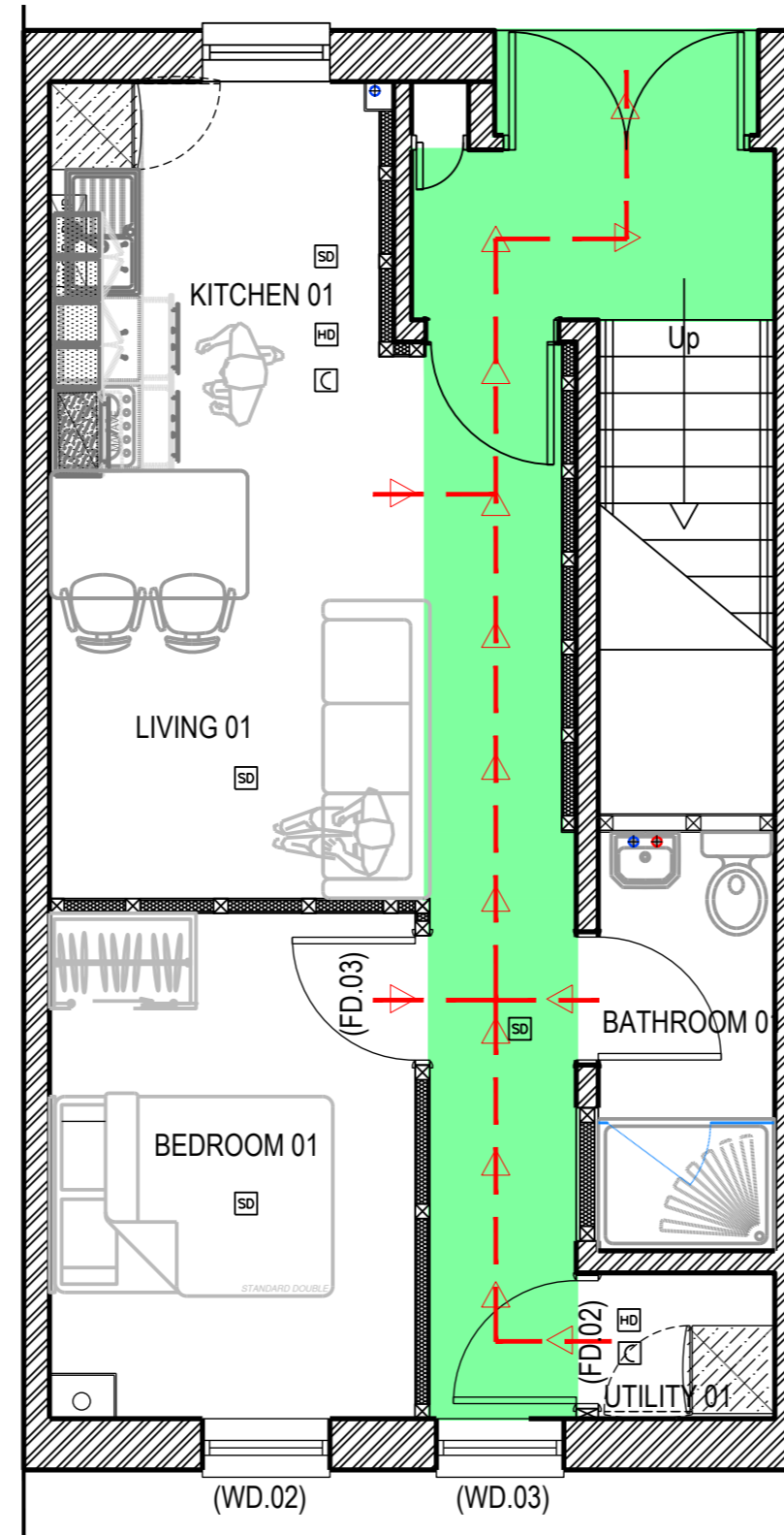

Flat 02 :

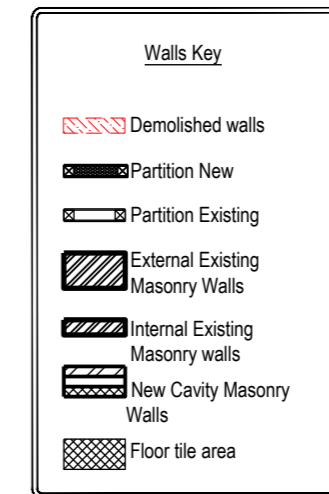

FIRE ALARM

- Carbon Monoxide detector - mains operated with backup battery backup
- Smoke detector - mains operated with battery backup
- Heat detector - mains operated with battery backup
- Internal Fire doors to offer a minimum 30 minutes resistance to the spread of fire and combustion of gaseous materials fitted with intumescent seals supplied by a certified manufacturer or under the BWF Fire Door Alliance Scheme
- Fire Exit Signage to BS 5266 standards and compliance
- Emergency Exit Lighting - Mains operated with battery backup
- Self illuminating Fire Exit Signage - Mains operated with battery backup
- Proposed windows to be used as a means of escape in the event of fire. To provide a minimum unobstructed opening of 0.33m² with a minimum width of 450mm and height of 450mm. The lowest part of the window to be 800 - 1100mm from the floor level

Wall Mounted Fire Extinguishers Specified to manufacturers guidance and comply with all implicated classes A to F in the 'The Regulatory Reform (Fire Safety) Order 2005

Arrow indicating fire exit path towards building exit - shown indicatively on plan

Evacuation Route

Assembly point

PART "B1" FIRE SAFETY

Means of Warning and Escape

Means of escape windows to be fitted with proprietary hinges to open to the minimum required clear width of 450mm. Escape windows must have minimum height of 450mm, and a clear opening casement area of 0.33m². Be located within 800mm - 1100mm above floor level to all bedrooms and habitable rooms at 1st floor level and inner habitable rooms on the ground floor. Windows above the ground floor storey and within 800mm of floor level are to be provided with containment/ guarding/ proprietary catches which should be removable (child proof) in the event of a fire. Where escape windows cannot be achieved, direct access to a protected stairs (or protected route to inner rooms) is acceptable in compliance with the below guidance sections and Approved Document B1 (ADB1) paragraph 2.6 (a) or (b). Fire extinguishers to be provided to each outward opening fire exit door and 9 liter water extinguishers fixed to wall brackets so that the carry handle of each extinguishers is approximately 1 meter above floor level. Glazing 800mm above the floor level in windows, and 1500mm in doors or windows adjacent to doors must be safety glass to BS 6206. To conform with BS EN 14604 or BS 5446-2, mains powered interlinked smoke and heat detectors must be provided on all floors.

General Notes

Socket outlets to be positioned at 600mm above FFL unless otherwise stated (Except where above worktops), measured to top of faceplate.

Socket outlets to be at least 750mm minimum from the corner if above a worktop that returns along an adjacent wall.

Kitchen sockets positioned 150mm above worktop. Under-counter sockets positioned 500mm above FFL, both measured to bottom of faceplate.

All light switches, switches, thermostats, High level thermostatic radiator valves etc. To be positioned at a common height of between 900mm and 1150mm above the finish floor level to assist persons with impaired vision. Measured to top of faceplate.

All Radiators to have thermostatic valves. All bathrooms and kitchens to have thermostatic taps. For specified radiator sizes, positions and specification refer to the heating engineers drawings/details and specifications.

For power-points located on the party wall space them to a minimum distance of 300mm between each other.

All visible electrical plates to be Plished stainless steel less client specifies otherwise.

Drainage runs, Manhole locations and to be confirmed prior to construction start by contractor.

See Structural engineers drawings for all proposed structural information

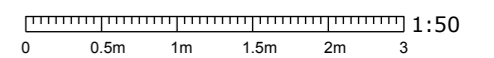

DWM Designs

Address:	2 MOUNT MEWS, HAMPTON, TW12 2SH	
Status:	ISSUED- FIRE ESCAPE PLAN	
Shown:	FIRE ESCAPE PLANS FOR FLAT 1 & FLAT 02	
Scale:	A2 @ 1/50	
Drawn:	DWM	
Checked:	DWM	REV: C
Date:	AUGUST 2021	
Ref No:	0033	Sheet: 006

David Wallace-Mesgna
 Architecture & Planning
 07516830995
 dwmdesignarch@gmail.com