



1 Proposed Street Elevation 1:100



2 Proposed South-East Elevation 1:100



3 Proposed South-West Elevation 1:100

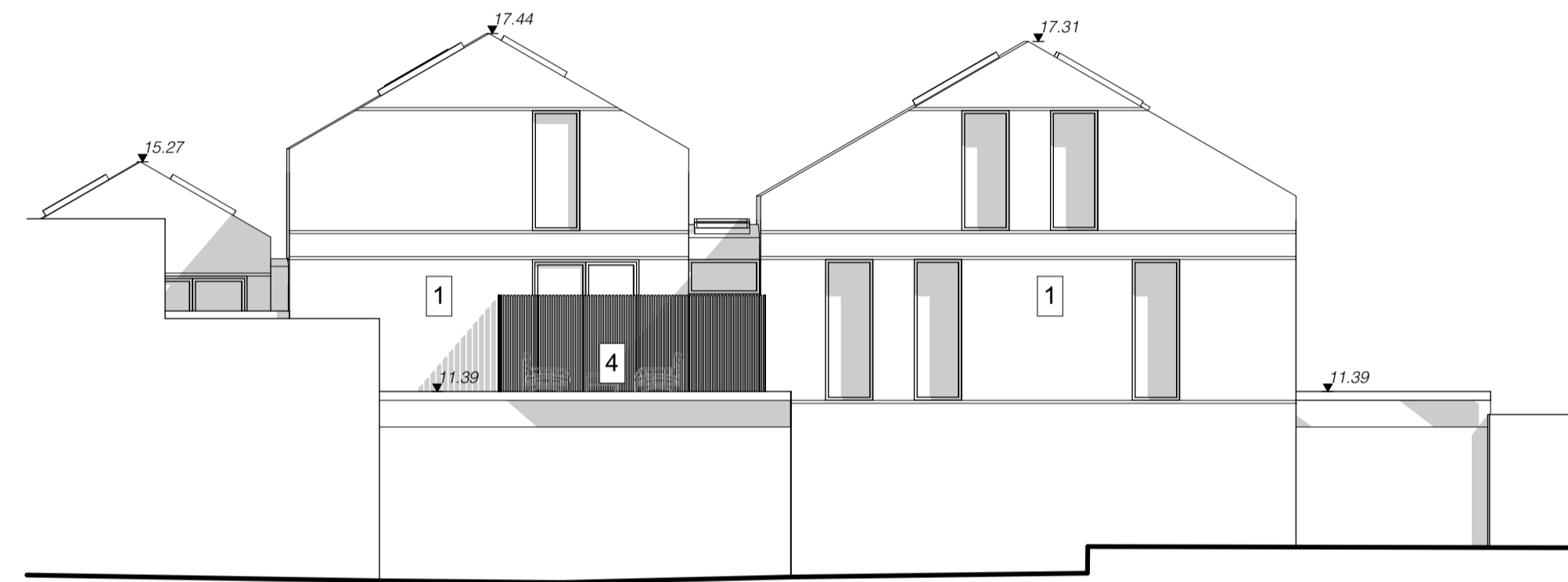

4 Proposed North-West Elevation 1:100

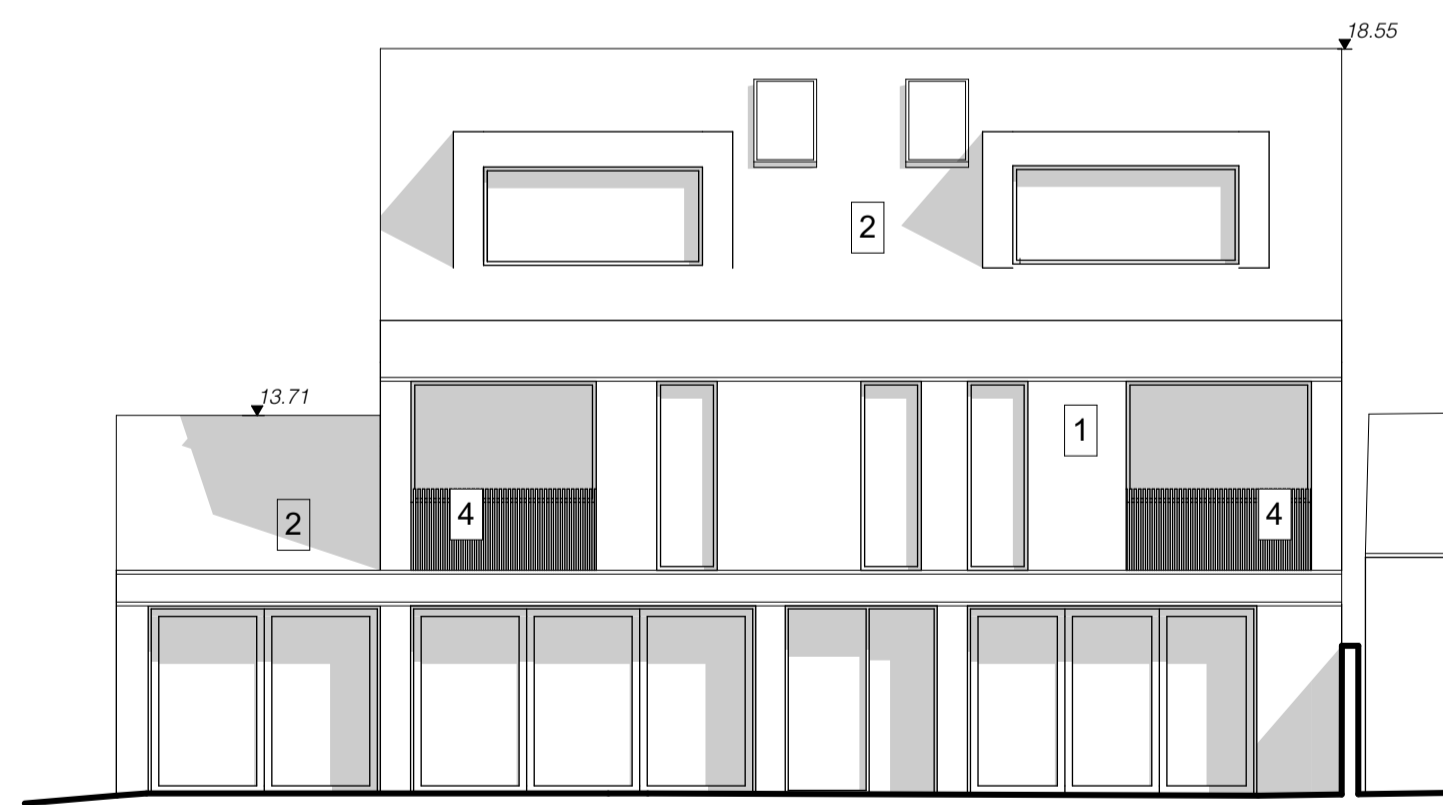

5 Proposed North-East Elevation 1:100

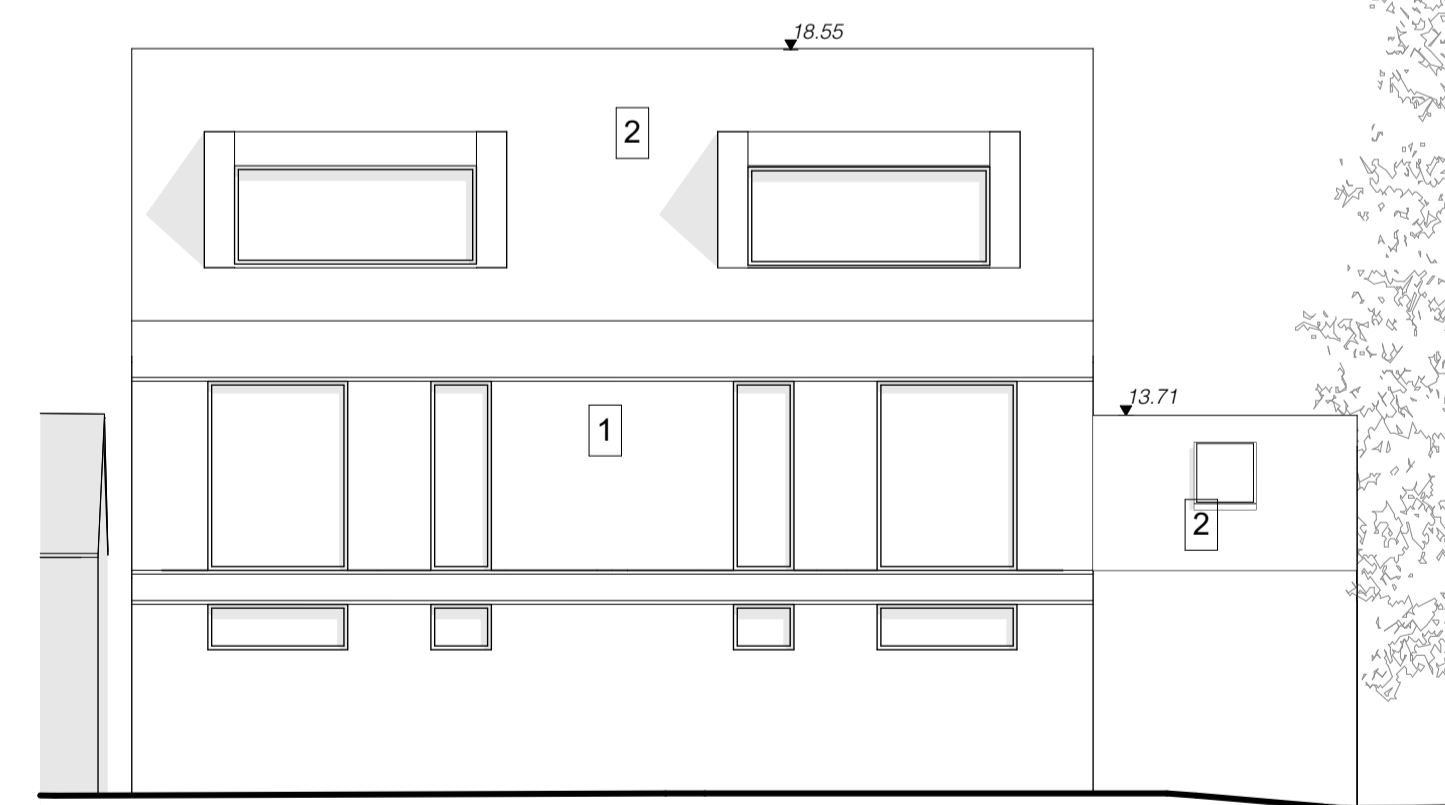

6 Proposed South-West Elevation 1:100

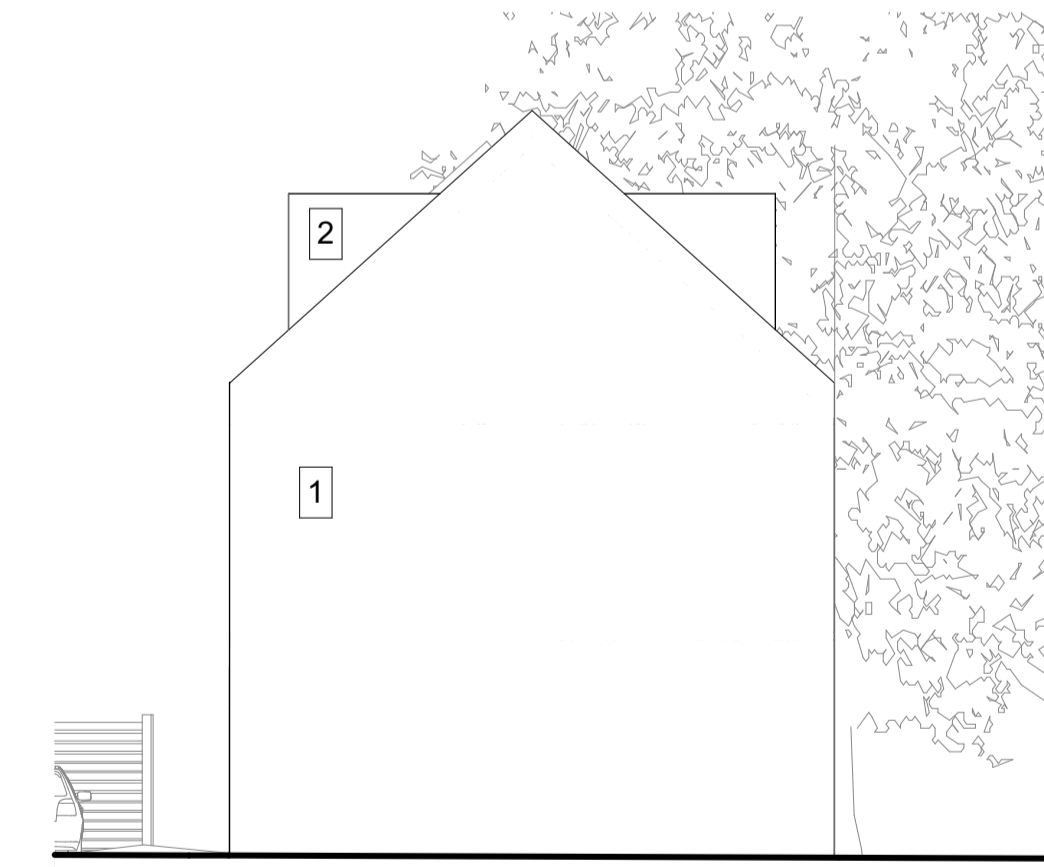

7 Proposed Elevation 1:100

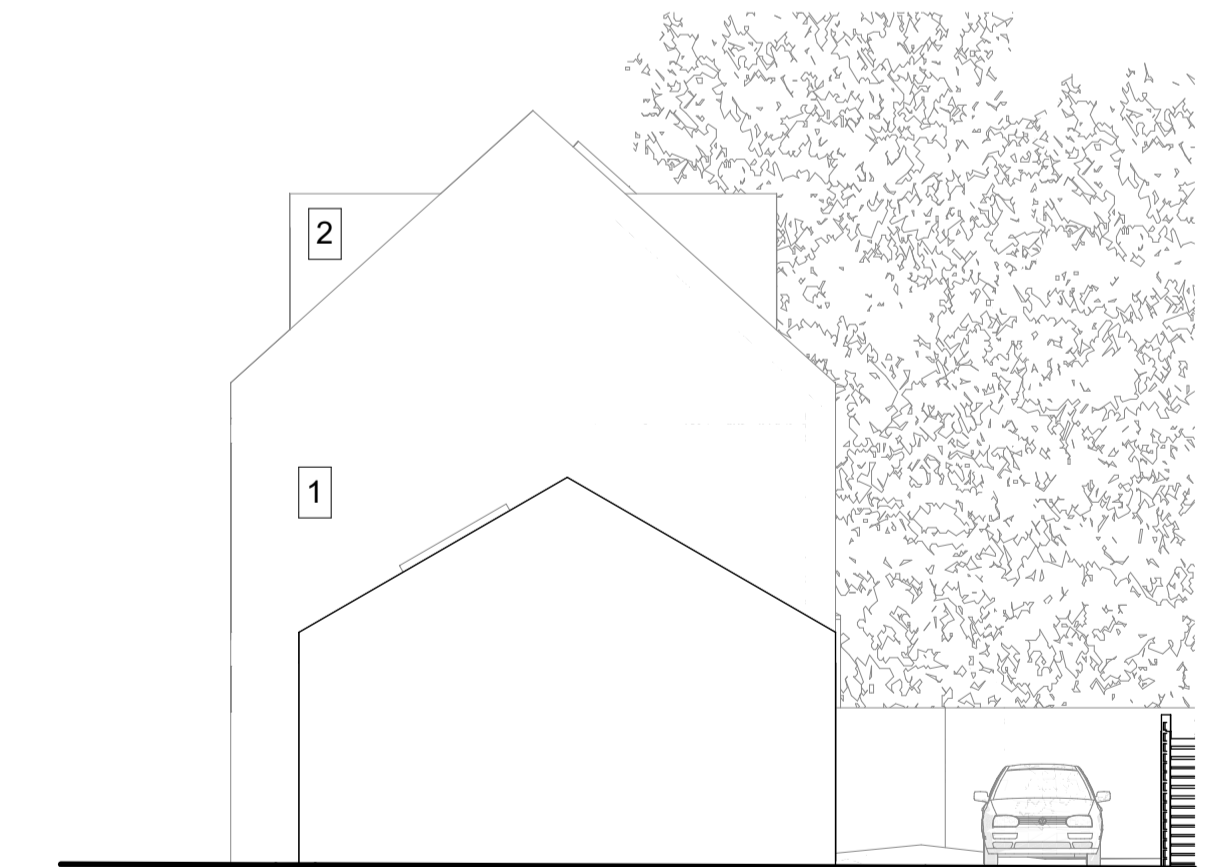

8 Proposed Elevation 1:100

- Key**
- 1 Timber Cladding
 - 2 Zinc Roof
 - 3 Green Roof
 - 4 Metal Railing
 - 5 White Render
 - 6 Hanging Clay Tiles
 - 7 Roof Clay Tiles

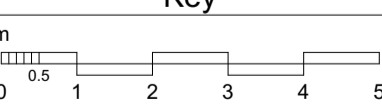
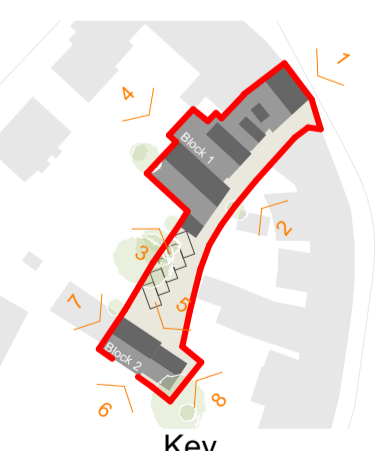

Fletcher Crane Architects Ltd
3-4 Home Park Parade, Hampton Wick, Kingston upon Thames, Surrey, KT1 4BY

T +44 (0)20 8977 4693
www.fletchercranearchitects.com

Figured dimensions only are to be taken from this drawing. All dimensions are to be checked on site before any work is put in hand. Where applicable this drawing must be read in conjunction with additional information prepared by Fletcher Crane Ltd and/ or others.

Rev	Description	Drawn	Checked	Date
C	HWHS Elevation corrected	SD	IC	10.12.21
B	Block 2 updated	SD	IC	20.08.21
A	Block 2 updated	SD	IC	18.05.21

Client's name
Liz & Allan Frost

Scale:
1:100 @ A1 **1:200 @ A3**

Note: To print at A3, set print scale to 50%

Drawn Checked Date

10/12/2021

Job title
Hampton Wick High Street

Drawing title
Proposed Elevations

Job No Drawing No Status: Rev

1911 TP(11)21 C

FLETCHER CRANE ARCHITECTS