

Strategies Seating

The plans below show a comparison between the existing seating within the planning application boundary, and the proposed seating to be incorporated within the re-designed spaces. In addition to an increase in the number and total length of seating provided, the proposal also now provides a wider range in the type and form of seating, which allows for different ways of sitting and also different social groupings. The seating walls and curved benches allow for people to sit adjacent to or opposite each other, and the timber terraces to the town square provide space for larger groups to sit, either informally, or as part of an organised event. A proportion of this sitting will include backs and arm rests.

Moveable tables and chairs are to be provided outside both the cafe and the restaurant / pub, to allow for flexible use, and they can be stacked and put to one side if an event is organised that requires more space. These moveable chairs are not included in the total length of seating given below each plan.

Existing Seating

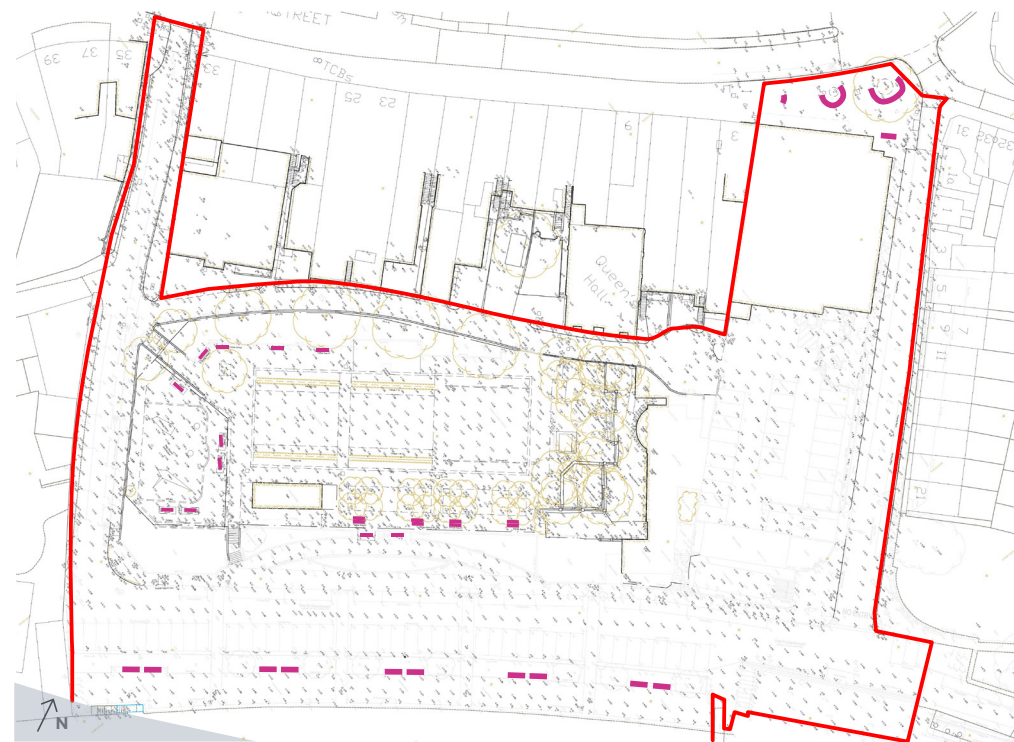

— Planning Application Boundary - - - Existing benches

Total Length of Fixed Seating = 78 m

Proposed Seating



— Planning Application Boundary — Benches and Seating Walls ■ Timber Seating Terraces (Only lower terrace is accessible) ● Proposed Informal Movable Seating

Total Length of Fixed Seating = 446 m