

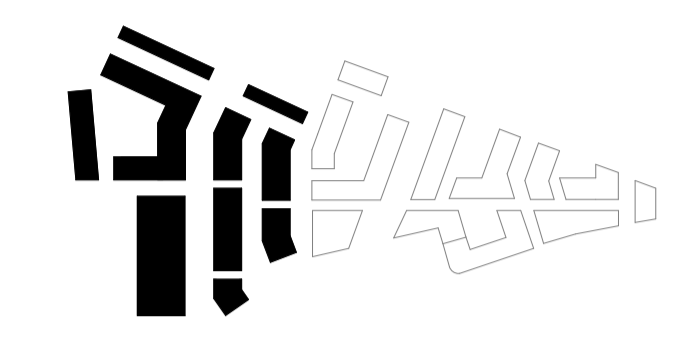

NOTES:
DO NOT SCALE FROM THIS DRAWING. ALL DIMENSIONS TO BE CHECKED ON SITE. ALL OMISSIONS AND DISCREPANCIES TO BE REPORTED TO THE ARCHITECT IMMEDIATELY.

ALL RIGHTS RESERVED. THIS WORK IS COPYRIGHT AND CANNOT BE REPRODUCED OR COPIED OR MODIFIED IN ANY FORM OR BY ANY MEANS, GRAPHIC ELECTRONIC OR MECHANICAL, INCLUDING PHOTOCOPYING WITHOUT THE WRITTEN PERMISSION OF SQUIRE AND PARTNERS ARCHITECTS.

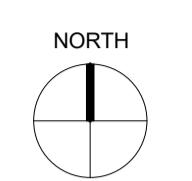

NOTE: UNIT MIX AND LAYOUT FOR DEVELOPMENT AREA 2 IS INDICATIVE AT THIS STAGE

- RESIDENTIAL - PRIVATE
- RESIDENTIAL - POTENTIAL SOCIAL RENT
- SCHOOL

| | | | |
|----------------------------------|----------|----|---|
| LB/UT 2 APPLICATION | 25/02/22 | BJ | D |
| LEGAL REVIEW COMMENTS | 21/05/20 | BJ | C |
| GLA SUBMISSION | 27/04/20 | BJ | B |
| DRAFT GLA SUBMISSION | 24/03/20 | KH | A |
| FINAL DRAFT PLANNING APPLICATION | 21/10/19 | KH | - |

| Revision description | Date | Check | Rev |
|----------------------|------|-------|-----|
| | | | |

SQUIRE & PARTNERS

The Department Store
248 Ferndale Road London SW9 8FR
T: 020 7278 5555 F: 020 7239 0495

info@squireandpartners.com
www.squireandpartners.com

Project
Stag Brewery
Richmond

Drawing
PROPOSED DEVELOPMENT AREA 02
GROUND LEVEL PLAN

| | | |
|------------|------------------|--------------------------|
| Drawn | Date | Scale |
| RKL | 18/01/18 | 1:500 @ A1 1:400 @ A3 |
| Job Number | Drawing number | Revision |
| 18125 | C645_Z2_P_00_002 | D |