

NOTES:
 DO NOT SCALE FROM THIS DRAWING. ALL DIMENSIONS TO BE CHECKED ON SITE. ALL OMISSIONS AND DISCREPANCIES TO BE REPORTED TO THE ARCHITECT IMMEDIATELY.
 ALL RIGHTS RESERVED. THIS WORK IS COPYRIGHT AND CANNOT BE REPRODUCED OR COPIED OR MODIFIED IN ANY FORM OR BY ANY MEANS, GRAPHIC ELECTRONIC OR MECHANICAL, INCLUDING PHOTOCOPIING WITHOUT THE WRITTEN PERMISSION OF SQUIRE AND PARTNERS ARCHITECTS.

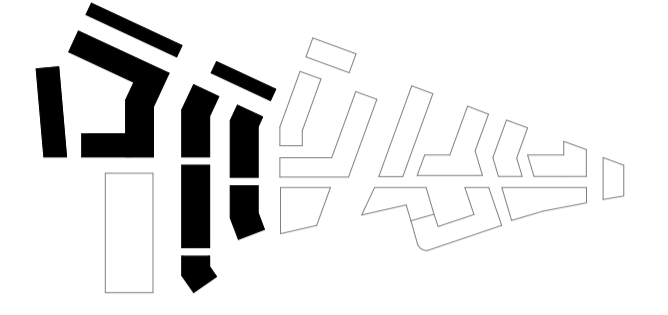
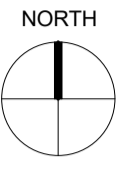

- HORIZONTAL LIMITS OF DEVIATION
- MINIMUM BLOCK FOOTPRINT
 - UP TO +1.5M FROM MINIMUM BLOCK FOOTPRINT
 - UP TO +2.2M FROM MINIMUM BLOCK FOOTPRINT
 - UP TO +3.0M FROM MINIMUM BLOCK FOOTPRINT
 - - - BLOCKS BELOW
 - 13-21** BLOCK NUMBER
 - - - PLANNING APPLICATION BOUNDARY

* REFER TO PARAGRAPH 3.1.1 ON PAGE 15 OF THE DESIGN CODE FOR RELEVANT DESIGN CODE CRITERIA WHICH MUST/SHOULD BE ADHERED TO

LBRUT 2 APPLICATION	25/02/22	BJ	E
FINAL DRAFT HYBRID SUBMISSION	12/01/22	RKB	D
GLA SUBMISSION	27/04/20	BJ	C
DRAFT GLA SUBMISSION	24/01/20	KH	B
FINAL DRAFT PLANNING APPLICATION	21/10/19	KH	A
LEGAL REVIEW	13/09/19	KH	-

Revision description	Date	Check	Rev
----------------------	------	-------	-----

SQUIRE & PARTNERS

The Department Store
 248 Ferndale Road London SW9 8FR
 T: 020 7278 5555 F: 020 7239 0495

info@squireandpartners.com
 www.squireandpartners.com

Project
Stag Brewery
 Richmond

Drawing BLOCK FOOTPRINT AND HORIZONTAL LINES OF DEVIATION SIX STOREYS

Drawn	Date	Scale
KHO	13/09/19	1 : 1000 @ A1 1 : 2000 @ A3
Job Number	Drawing number	Revision
18125	C645_Z2_P_PR_004	E

