

NOTES:
 DO NOT SCALE FROM THIS DRAWING. ALL DIMENSIONS TO BE CHECKED ON SITE. ALL OMISSIONS AND DISCREPANCIES TO BE REPORTED TO THE ARCHITECT IMMEDIATELY.
 ALL RIGHTS RESERVED. THIS WORK IS COPYRIGHT AND CANNOT BE REPRODUCED OR COPIED OR MODIFIED IN ANY FORM OR BY ANY MEANS, GRAPHIC ELECTRONIC OR MECHANICAL, INCLUDING PHOTOCOPIING WITHOUT THE WRITTEN PERMISSION OF SQUIRE AND PARTNERS ARCHITECTS.

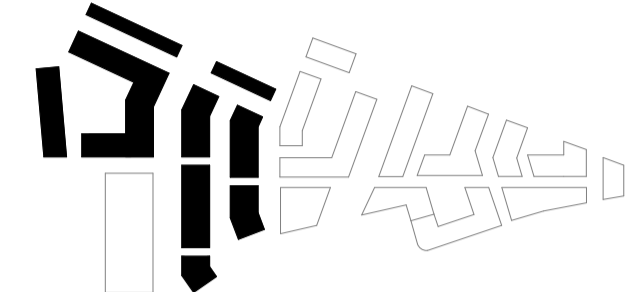
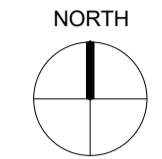

LAND USE DISTRIBUTION

RESIDENTIAL

13-21 BLOCK NUMBER

PLANNING APPLICATION BOUNDARY

APPLICATION A:
 DEVELOPMENT AREA 1
 REFER TO DETAIL
 APPLICATION

APPLICATION A:
 DEVELOPMENT AREA 2

APPLICATION B:
 SCHOOL
 APPLICATION

| | | | |
|----------------------------------|----------|-----|---|
| LBURT 2 APPLICATION | 25/02/22 | BJ | E |
| FINAL DRAFT HYBRID SUBMISSION | 12/01/22 | RKB | D |
| GLA SUBMISSION | 27/04/20 | BJ | C |
| DRAFT GLA SUBMISSION | 24/01/20 | KH | B |
| FINAL DRAFT PLANNING APPLICATION | 21/10/19 | KH | A |
| LEGAL REVIEW | 13/09/19 | KH | - |

| Revision description | Date | Check | Rev |
|----------------------|------|-------|-----|
|----------------------|------|-------|-----|

SQUIRE & PARTNERS

The Department Store
 248 Ferndale Road London SW9 8FR
 T: 020 7278 5555 F: 020 7239 0495

info@squireandpartners.com
 www.squireandpartners.com

Project
Stag Brewery
 Richmond

PROPOSED LAND USE DISTRIBUTION - GROUND AND UPPER FLOORS

| Drawn | Date | Scale |
|------------|------------------|--------------------------------|
| KHO | 13/09/19 | 1 : 1000 @ A1 1 : 2000 @ A3 |
| Job Number | Drawing number | Revision |
| 18125 | C645_Z2_P_PR_008 | E |

