

Ham Close Regeneration

Planning Application:

Healthy Streets Transport
Assessment Appendices Pt1

Author: Velocity Transport Planning
April 2022



APPENDICES

APPENDIX A	PROPOSED DEVELOPMENT PLANS
APPENDIX B	PARKING BEAT SURVEY DATA
APPENDIX C	ACTIVE TRAVEL ZONE ASSESSMENT
APPENDIX D	SWEPT PATH ANALYSIS
APPENDIX E	CYCLE STORAGE STRATEGY
APPENDIX F	ZIPCAR PROPOSAL
APPENDIX G	TRICS DATA (EXISTING)
APPENDIX H	TRICS DATA (PROPOSED)
APPENDIX I	TRICS REVIEW SERVICING TRIPS
APPENDIX J	ACCESS DISTRIBUTION REVIEW
APPENDIX K	TRAFFIC FLOW DIAGRAMS
APPENDIX L	MODELLING MEASUREMENTS
APPENDIX M	JUNCTIONS 10 OUTPUT FILES



APPENDIX A

PROPOSED DEVELOPMENT PLANS



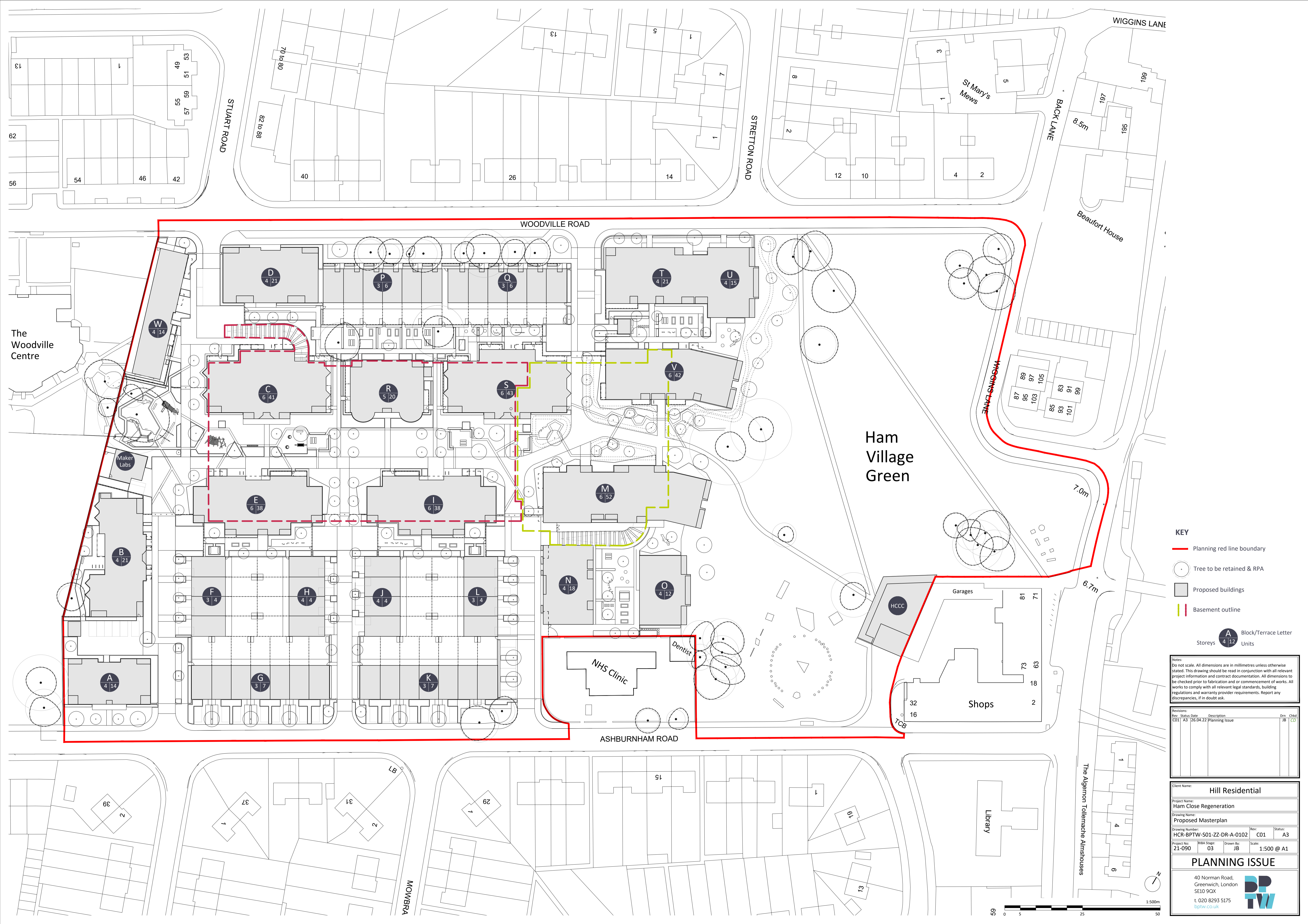

KEY

- Planning red line boundary
- Tree to be retained & RPA
- Proposed buildings
- - - Basement outline
- Block/Terrace Letter Units

Notes:
Do not scale. All dimensions are in millimetres unless otherwise stated. This drawing should be read in conjunction with all relevant project information and contract documentation. All dimensions to be checked prior to fabrication and/or commencement of works. All works to comply with all relevant legal standards, building regulations and warranty provider requirements. Report any discrepancies, if in doubt ask.

Revisions	Rev	Status	Date	Description	Dim	Chkd
	001	A3	12/04/22	Planning Issue		JB / CD

Client Name:		Hill Residential	
Project Name:		Ham Close Regeneration	
Drawing Name:		Proposed Masterplan	
Drawing Number:	HCR-BPTW-S01-ZZ-DR-A-0102	Rev:	CO1
Project No:	21-090	Status:	A3
RBIA Stage:	03	Drawn By:	JB
Scale:	1:500 @ A1		

PLANNING ISSUE

40 Norman Road,
Greenwich, London
SE10 9GX

t. 020 8293 5175
bptw.co.uk



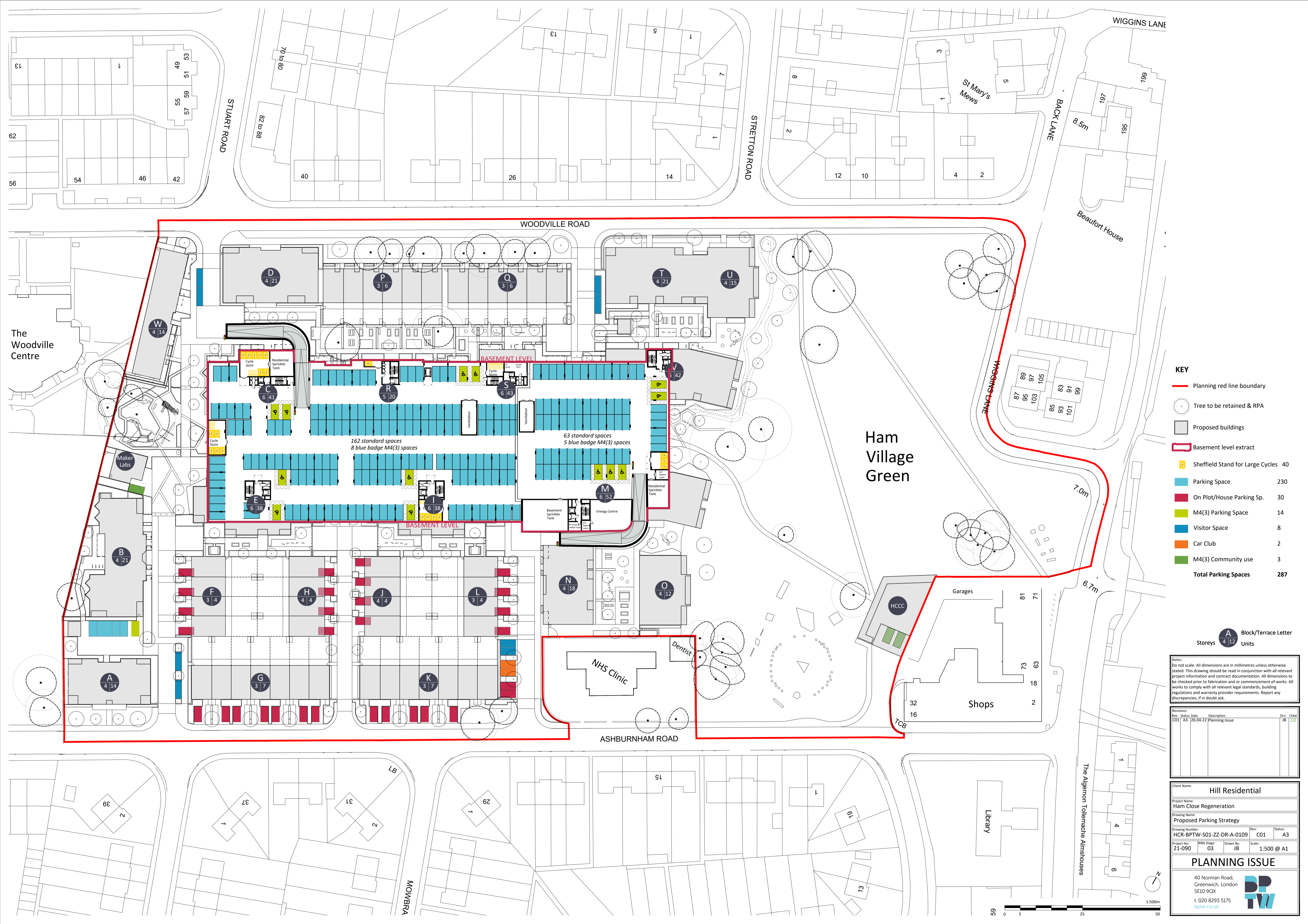

KEY

- Planning red line boundary
- Tree to be retained & RPA
- Proposed buildings
- Basement level extract
- Sheffield Stand for Large Cycles 40
- Parking Space 230
- On Plot/House Parking Sp. 30
- M4(3) Parking Space 14
- Visitor Space 8
- Car Club 2
- M4(3) Community use 3
- Total Parking Spaces 287**

Block/Terrace Letter
Storeys
 Units

Notes:
 Do not scale. All dimensions are in millimetres unless otherwise stated. This drawing should be read in conjunction with all relevant project information and contract documentation. All dimensions to be checked prior to fabrication and/or commencement of works. All works to comply with all relevant legal standards, building regulations and warranty provider requirements. Report any discrepancies, if in doubt ask.

Revisions	Rev	Status	Date	Description	Dim	Chkd
	001	A3	12/04/22	Planning Issue		JB / CD

Client Name: Hill Residential	
Project Name: Ham Close Regeneration	
Drawing Name: Proposed Parking Strategy	
Drawing Number: HCR-BPTW-S01-ZZ-DR-A-0109	Rev: CO1 Status: A3
Project No: 21-090	RIBA Stage: 03 Drawn By: JB Scale: 1:500 @ A1

PLANNING ISSUE

40 Norman Road,
 Greenwich, London
 SE10 9GX
 t. 020 8293 5175
 bptw.co.uk

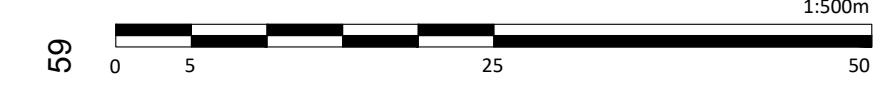
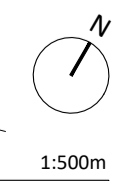

APPENDIX B

PARKING BEAT SURVEY DATA



29854 Ham Close, Richmond, TW10 7FL
Street Inventory
Sunday 12th December 2021

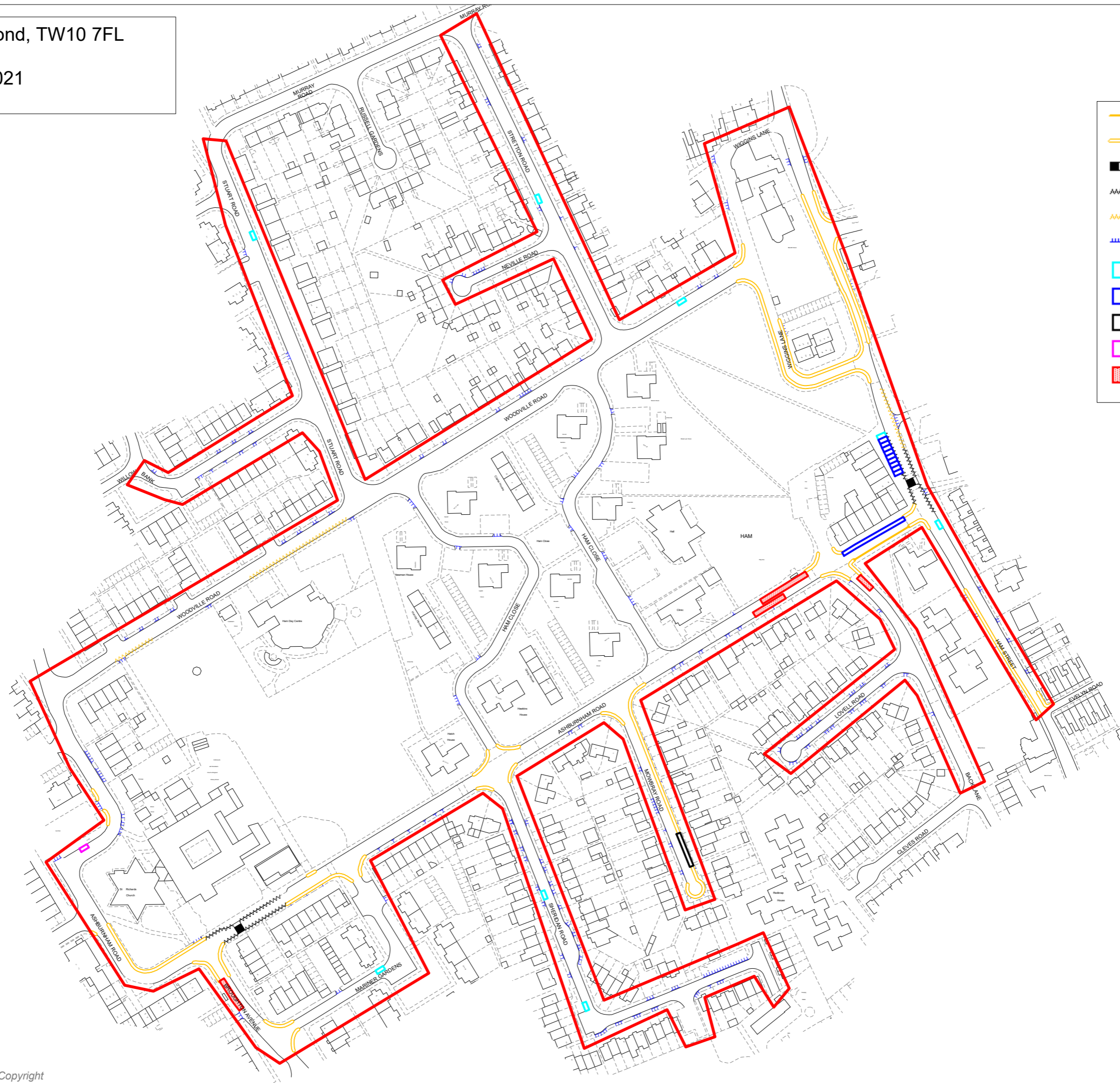

- Single Yellow Line
- Double Yellow Line
- Pedestrian Crossing
- White Zigzag
- School Keep Clear
- Dropped Kerb
- Disabled Permit Bay
- Short Stay Bay
- Unrestricted Bay
- Electric Scooters Only
- Bus Stop



ADVANCED
TRANSPORT
RESEARCH



ADVANCED
TRANSPORT
RESEARCH

Job Number & Name: 29854 Ham Close, Richmond

Site Number/Name: Ham Close

Client: Velocity

Date: 12/12/2021

Weather: Cold, Dry

Description of column headers

- Total Length of Available Kerb Space** Measured length (in metres) of kerb space excluding sides of the road which are too narrow for two cars to pass
- Length of Junctions** Measurement of 7.5m on either side of road at a junction
- Length of Bus stops/other** Measured length (in metres) of other restrictions which preclude parking
- Length (m)** Measured length (in metres) of total parking per restriction, rounded to the nearest 5m
- Calculated Spaces** Calculation of number of available spaces based on 5m length
- Cars Parked** Number of vehicles parked per time period
- Stress** Calculated stress per restriction per road based on number of parked vehicles and number of available spaces

0100 Sunday 12th December 2021	Street	Total Length of Available Kerb Space	Length of Junctions	Length of Bus stops/other	Unrestricted Kerb Space				Disabled Permit Bay				Short Stay Bay				Unrestricted Bay				Double Yellow Line					
					Length (m)	Calculated Spaces	Cars Parked	Stress	Length (m)	Calculated Spaces	Cars Parked	Stress	Length (m)	Calculated Spaces	Cars Parked	Stress	Length (m)	Calculated Spaces	Cars Parked	Stress	Length (m)	Calculated Spaces	Cars Parked	Stress		
					Wiggins Lane	195	30	14	58	11	6	55%														
Stretton Road	376	45	28	298	49	33	67%	5	1	1	100%															
Neville Road	61	7.5	9	44.5	7	8	114%																			
Stuart Road	373	45	8	315	55	52	95%	5	1	1	100%															
Willow Bank	118	15	24	79	15	14	93%																			
Woodville Road	821	90	178	548	98	65	66%	5	1	0	0%															
Ham Close	401	30	38	333	53	9	17%																			
Ham Close Car Parks	570			570	228	63	28%																			
Ashburnham Road	641	90	145	325	65	35	54%					40	8	0	0%								41	8	0	0%
Broughton Avenue	70	7.5	5	48.5	9	5	56%															9	1	0	0%	
Mariner Gardens	161	15	4	137	32	30	94%	5	1	1	100%															
Sheridan Road	310	7.5	76	216.5	39	25	64%	10	2	1	50%															
Mowbray Road	158	7.5	32	80.5	14	8	57%									20	4	0	0%			18	3	2	67%	
Back Lane	140	15	14	111	18	8	44%																			
Lovell Road	158	15	74	69	13	15	115%																			
Ham Street	366	30	101	136	27	9	33%	7.5	2	0	0%	22.5	9	1	11%							69	13	0	0%	
Total per Beat by restriction					733	385	53%		8	4	50%		17	1	6%		4	0	0%			43	2	5%		
Total per Beat					762	392	51%																			

29854 Ham Close, Richmond, TW10 7FL
Parking Beat
0100
Sunday 12th December 2021

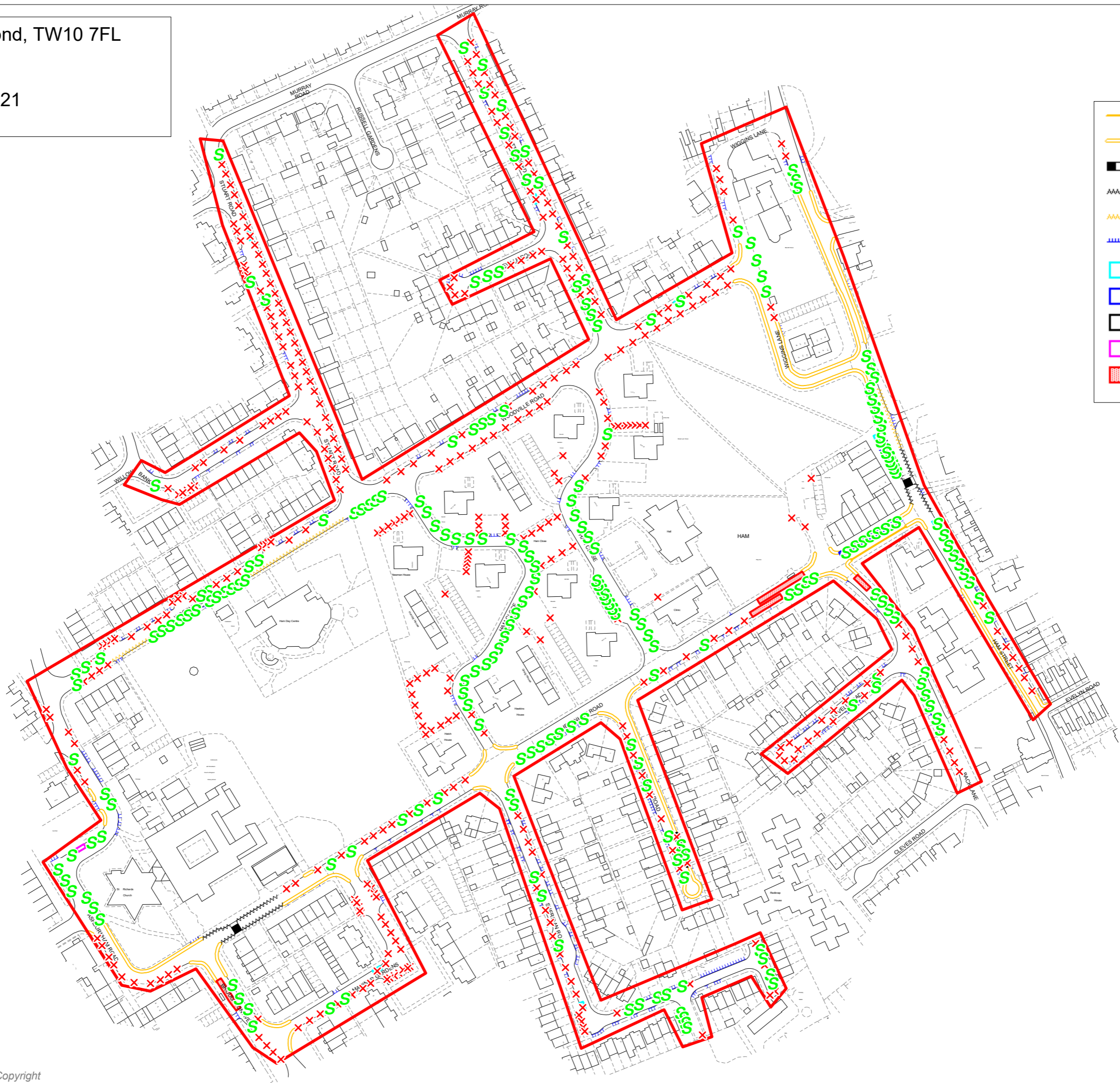

ADVANCED
TRANSPORT
RESEARCH



ADVANCED
TRANSPORT
RESEARCH

Job Number & Name: 29854 Ham Close, Richmond

Site Number/Name: Ham Close

Client: Velocity

Date: 11th & 12th January 2022

Weather: Cold, Dry

Description of column headers

- Total Length of Available Kerb Space** Measured length (in metres) of kerb space excluding sides of the road which are too narrow for two cars to pass
- Length of Junctions** Measurement of 7.5m on either side of road at a junction
- Length of Bus stops/other** Measured length (in metres) of other restrictions which preclude parking
- Length (m)** Measured length (in metres) of total parking per restriction, rounded to the nearest 5m
- Calculated Spaces** Calculation of number of available spaces based on 5m length
- Cars Parked** Number of vehicles parked per time period
- Stress** Calculated stress per restriction per road based on number of parked vehicles and number of available spaces

29854 Ham Close, Richmond, TW10 7FL
Parking Beat
0100
Tuesday 11th January 2022

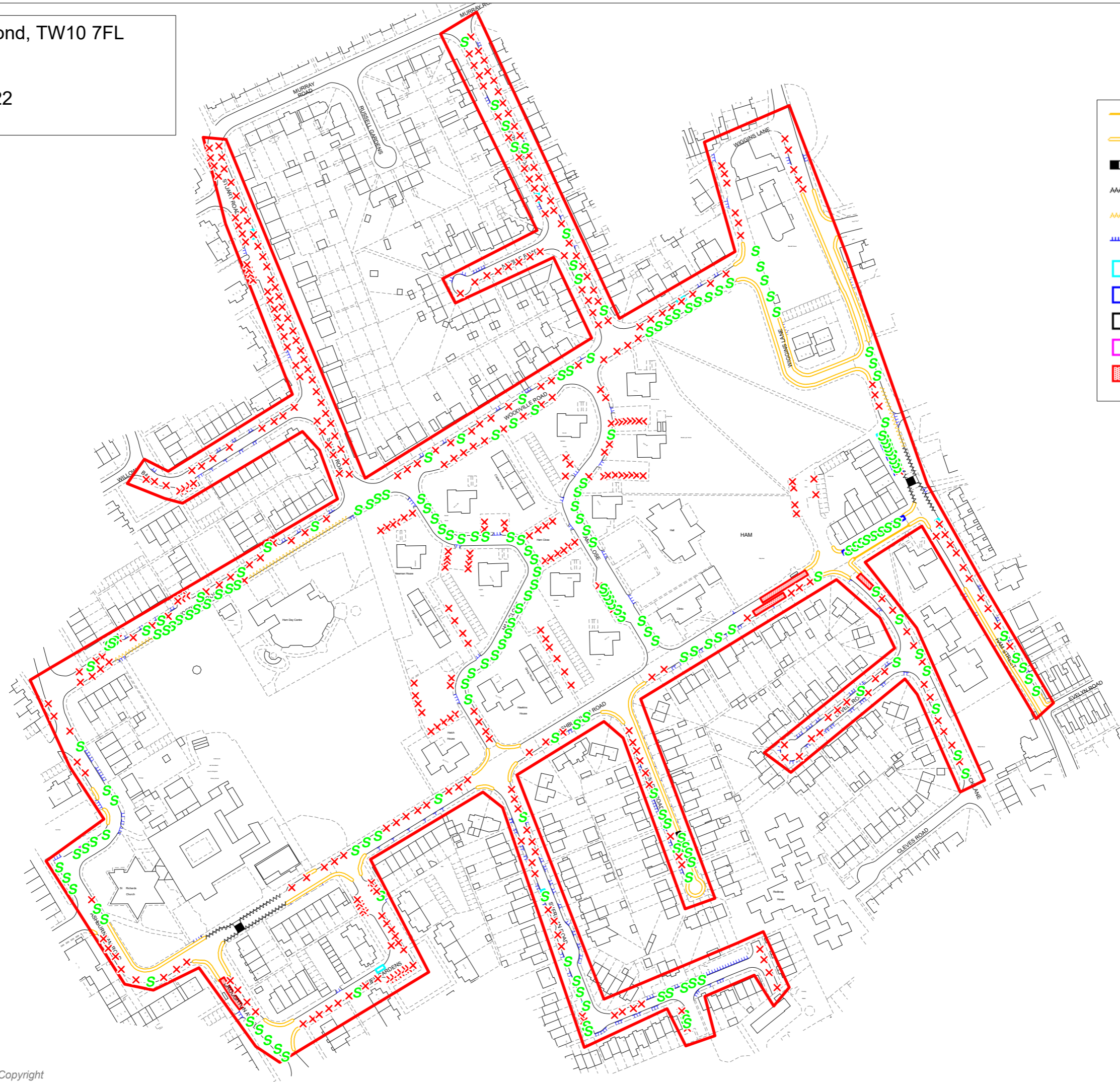

- Single Yellow Line
- Double Yellow Line
- Pedestrian Crossing
- White Zigzag
- School Keep Clear
- Dropped Kerb
- Disabled Permit Bay
- Short Stay Bay
- Unrestricted Bay
- Electric Scooters Only
- Bus Stop



ADVANCED
TRANSPORT
RESEARCH

29854 Ham Close, Richmond, TW10 7FL
Parking Beat
0100
Wednesday 12th January 2022

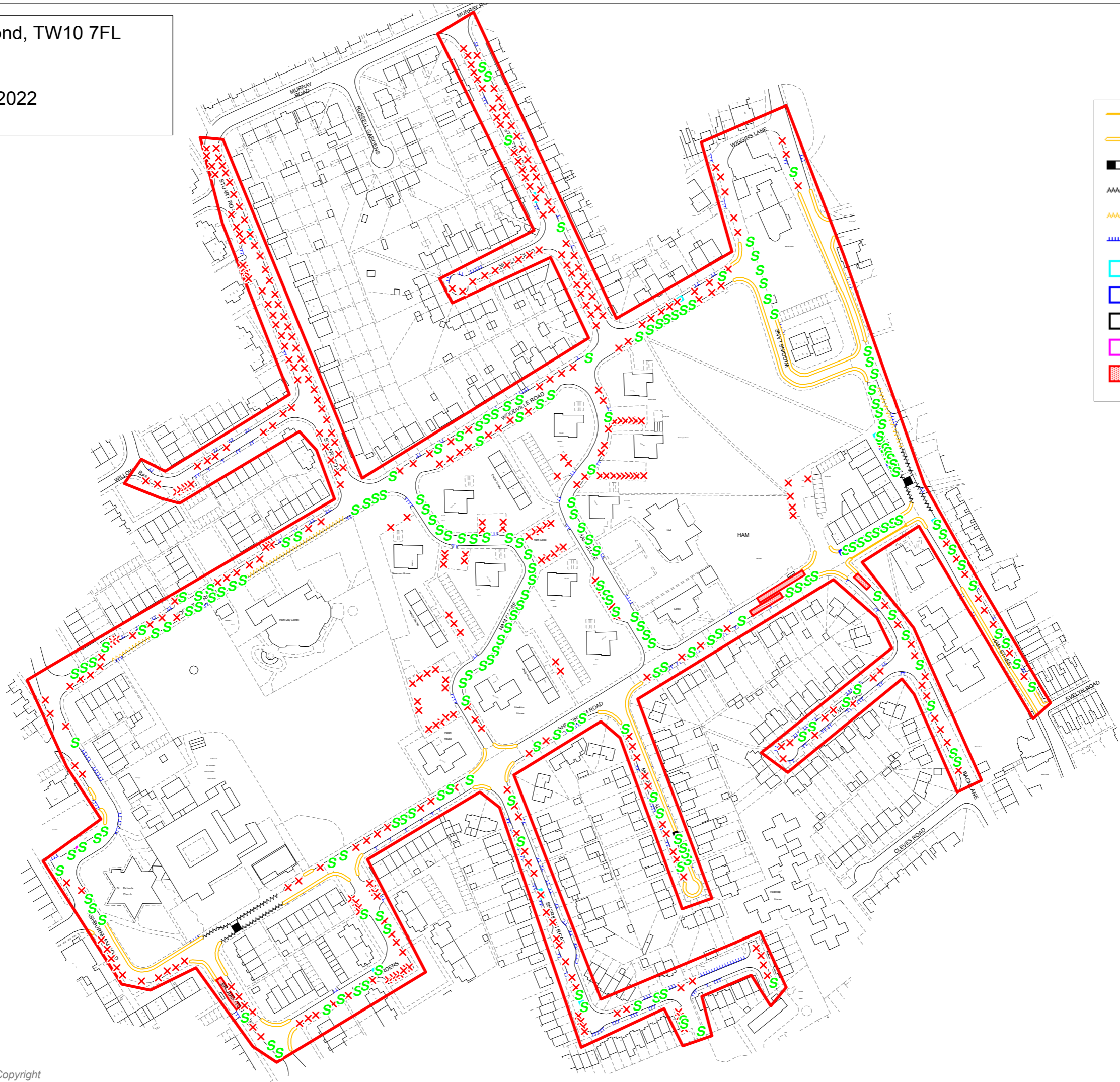

ADVANCED
TRANSPORT
RESEARCH