

Notes
 Do not scale from this drawing.
 All dimensions are drawn in millimetres.
 Drawing & design copyright LUC.
 Reproduction of this drawing in whole or in part is prohibited without prior permission.

- KEY**
- Extent of works boundary
 - Existing Trees
 - Dashed line indicates Root Protection Area.
 - No-Dig Construction
 - Areas of no-dig construction. For detail refer to Arboricultural Method Statement.
 - Proposed Trees
 - Majority semi-mature with some heavy standards

- Hard Landscape**
- PT1 - Light Grey Concrete Block Paving 210x140x80mm
 - PT2 - Dark Grey Concrete Block Paving 105x140x80mm
 - PT3 - Light Grey Concrete Block Paving 105x140x80mm
 - PT4 - Dark Grey Concrete Block Paving 105x140x80mm
 - PT5 - Dark Grey Concrete Block Paving 210x140x80mm
 - PT6 - Buff Concrete Block Paving 200x200x80mm & 300x300x80mm
 - PT7 - Pearl Grey Concrete Block Paving 200x100x80mm
 - PT8 - Burnt Oak Concrete Block Paving 105x140x60mm
 - PT9 - Light Grey Concrete Set Feature Banding 100x100x100mm
 - PT10 - Buff Concrete Pavers 450x450x30mm
 - PT11 - Buff Resin Bound Gravel
 - PT12 - Macadam
 - PT13 - Existing Macadam Retained
 - PT14 - Self-binding Gravel
 - PT15 - Rubber Safety Surface

- Street Furniture**
- F1 - Demountable Bollard
 - F2 - Cycle Stand
 - F3 - Bench - timber top over stone gabion
 - F4 - Picnic Table
 - F5 - Bleacher
 - F6 - Informal Doorstep Play using reclaimed timber from site
 - F7 - Ventilation turret with integrated seating, insect hotel and biodiverse roof

- Catalogue Play Equipment**
- P1 - Robinia Climbing Frame
 - P2 - Clatter Bridge
 - P3 - Wobble Dish
 - P4 - Robinia Seesaw and Balance Beam
 - P5 - Robinia Climbing Frame & Net
 - P6 - Robinia Hammock
 - P7 - Balance Beam Bench

- Illustrative Boundaries**
- B1 - 1800mm High railing with matching gate where shown
 - B2 - 1800mm High brick wall, to match facade interface
 - B3 - 1000mm High railing with matching gate where shown
 - B4 - 1800mm High timber hit and miss fence with trellis to top 300mm and matching gate where shown
 - B5 - 1000mm High estate rail
 - B6 - Parapet Wall, to architects detail
 - BW - 1800mm High brick wall, using reclaimed bricks from existing boundary

- Misc**
- CS - Cycle Store, to architect's specification
 - BS - Bin Store, to architect's specification
 - TP - Timber Pergola structure over basement ramp, to architect's specification

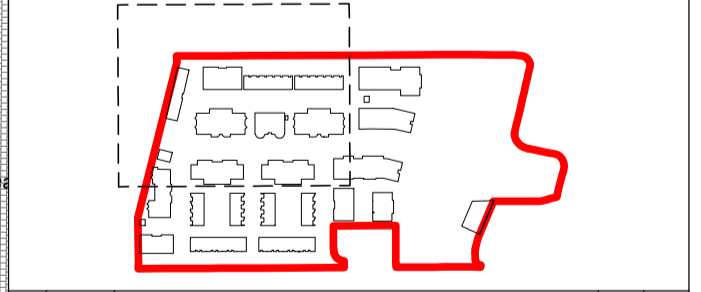

No	Date	Description	Drn	Chk
PH3	21.03.22	Final Approval	AT	JL
PH2	07.03.22	Final Approval	AT	JL
PH1	01.03.22	Design Freeze	AT	JL

LUC LUC London
 250 Waterloo Road, London, SE1 8RD
 +44 (0)20 7383 5784
 london@landuse.co.uk
 www.landuse.co.uk

Project
HAM CLOSE REGENERATION

Client
HILL RESIDENTIAL

Scale @A1
 1:250

Status
FOR APPROVAL

Drawing Title
HARD LANDSCAPE GENERAL ARRANGEMENT (SHEET 1 OF 4)

Job Nr
 11265

Drawing Nr
 LD-PLN-201

Issue
 P03