

7.5t Box Van
 Overall Length 8.010m
 Overall Width 2.100m
 Overall Body Height 3.556m
 Min Body Ground Clearance 0.351m
 Track Width 2.064m
 Lock to lock time 4.00s
 Kerb to Kerb Turning Radius 7.400m

Key - Swept Path Analysis

- Swept Path Envelope - Forward
- Swept Path Envelope - Reverse
- Body Outline
- Vehicle wheels

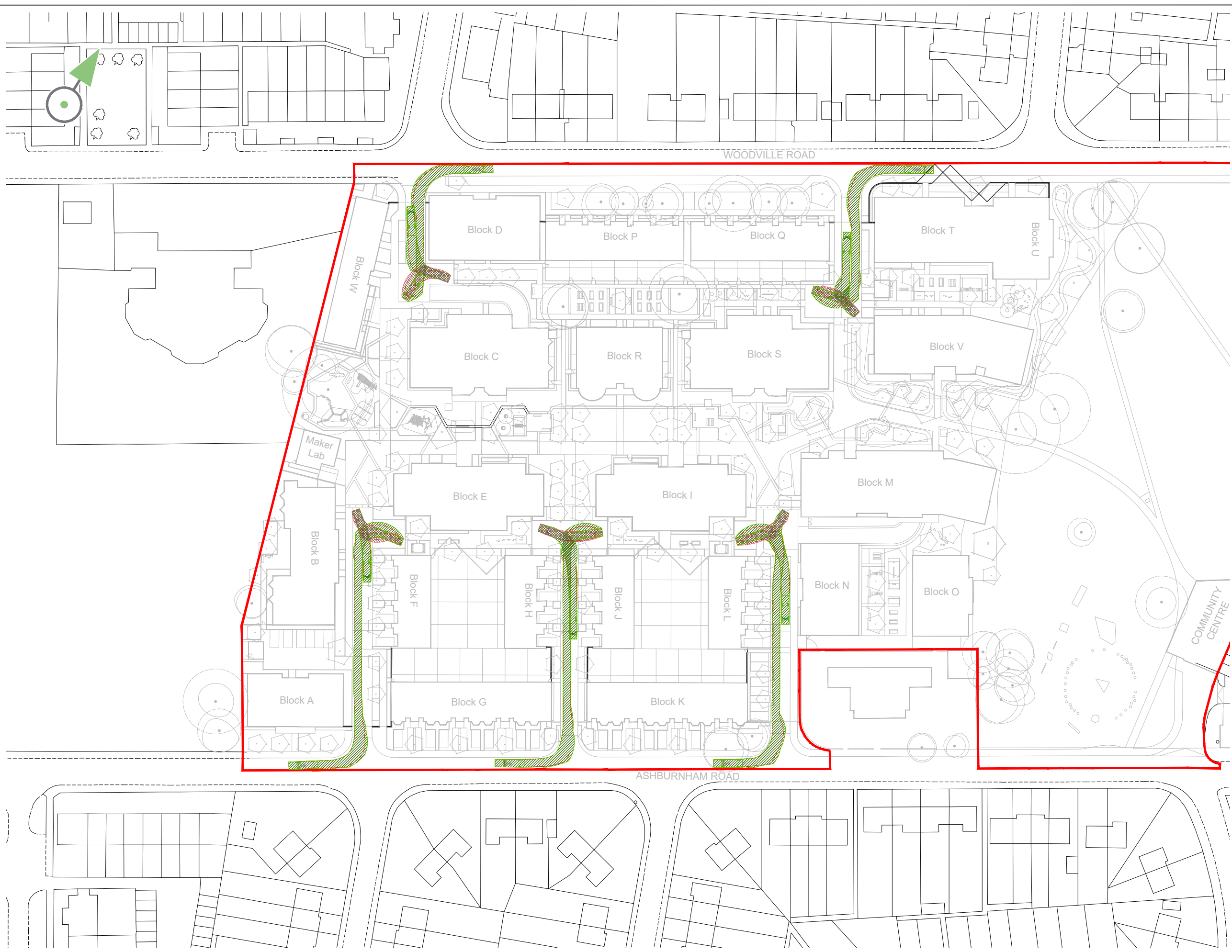

A	10.01.22	GSF	First Issue
REV	DATE	BY	COMMENT
REVISION DETAILS			
DRAWING NO.			
21-102-T-017			
DRAWN		APPROVED	DATE
GSF		CG	JAN 22
SCALE			REV
1:1000 @ A3			A

