

4.6t Light Van	
Overall Length	5.885m
Overall Width	2.000m
Overall Body Height	2.526m
Min Body Ground Clearance	0.299m
Track Width	1.765m
Lock to lock time	4.00s
Kerb to Kerb Turning Radius	6.000m

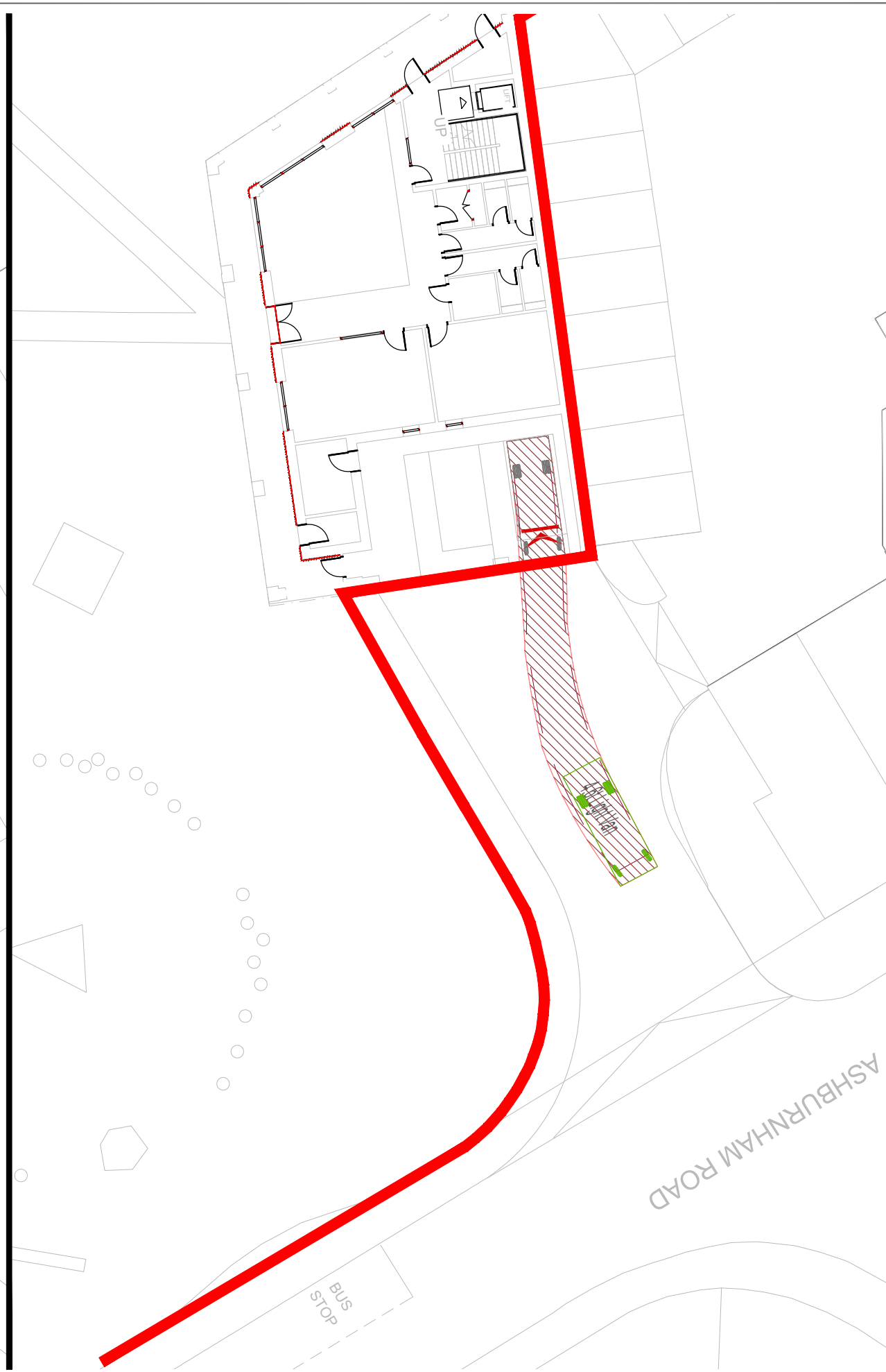
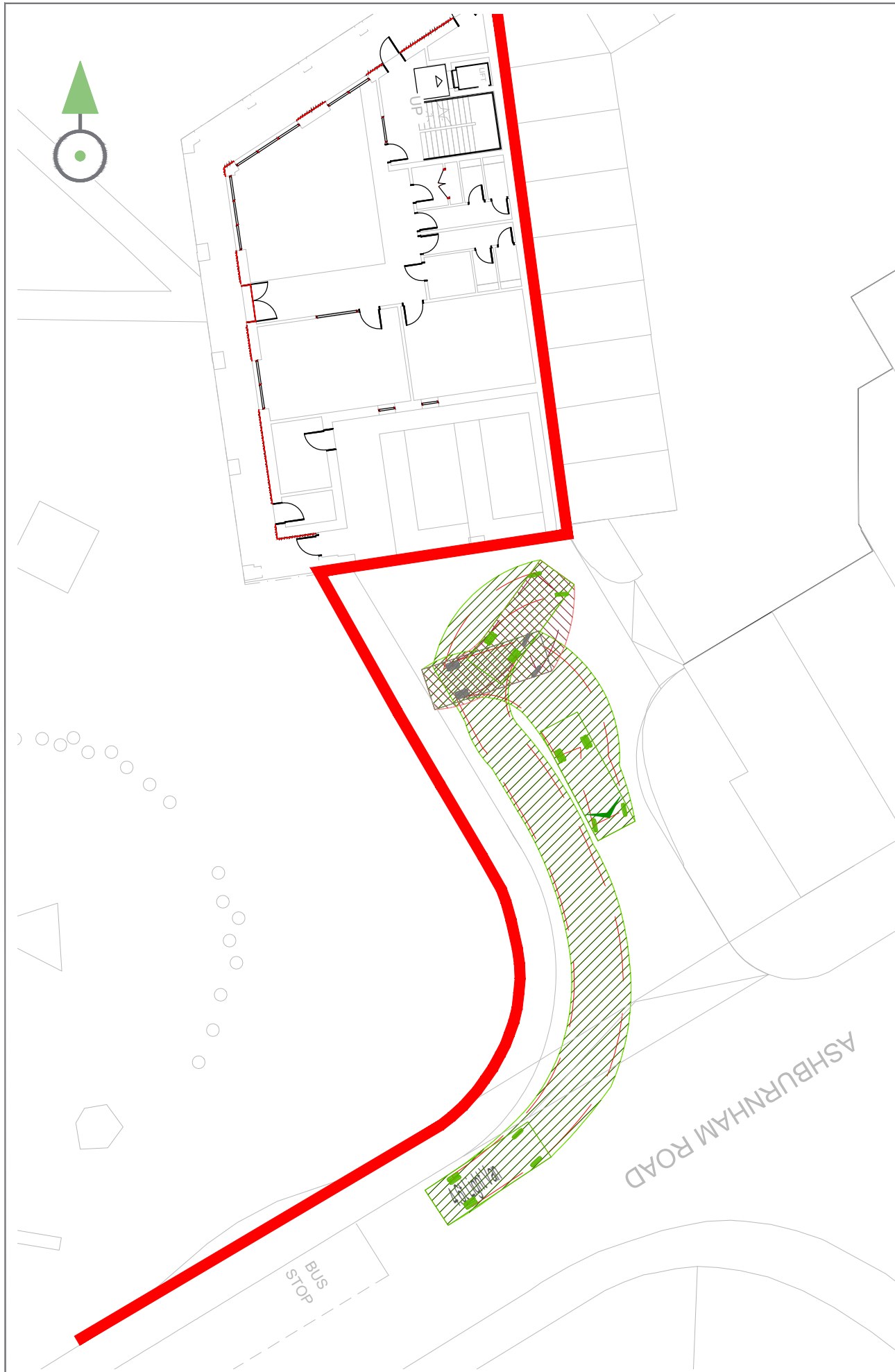

A	20.04.22	GSF	First Issue
REV	DATE	BY	COMMENT
REVISION DETAILS			
DRAWING NO.			
21-102-T-023			
DRAWN	APPROVED	DATE	
GSF	CG	APR 22	
SCALE			REV
1:250 @ A3			A

CLIENT
HILL RESIDENTIAL
PROJECT
HAM CLOSE

DRAWING TITLE
SWEPT PATH ANALYSIS OF 4.6T VAN

