

# PLANNING

RED NOTES/ SHOW AMENDMENTS TO ORIGINAL PLANNING APPLICATION

Red dotted line indicates original outhouse

Existing doorways opened to connect hallway to new extension. Retain central window as feature

Original Application dividing wall removed and existing joinery retained to Anteroom

Existing storeroom doorways infilled and new door to hallway creating WC. All original corning and architraves retained.

Blue dotted line indicates footprint of original application. Revised Proposal reduces overall footprint with additional set back at SW boundary and new external courtyard separating extension from existing house.

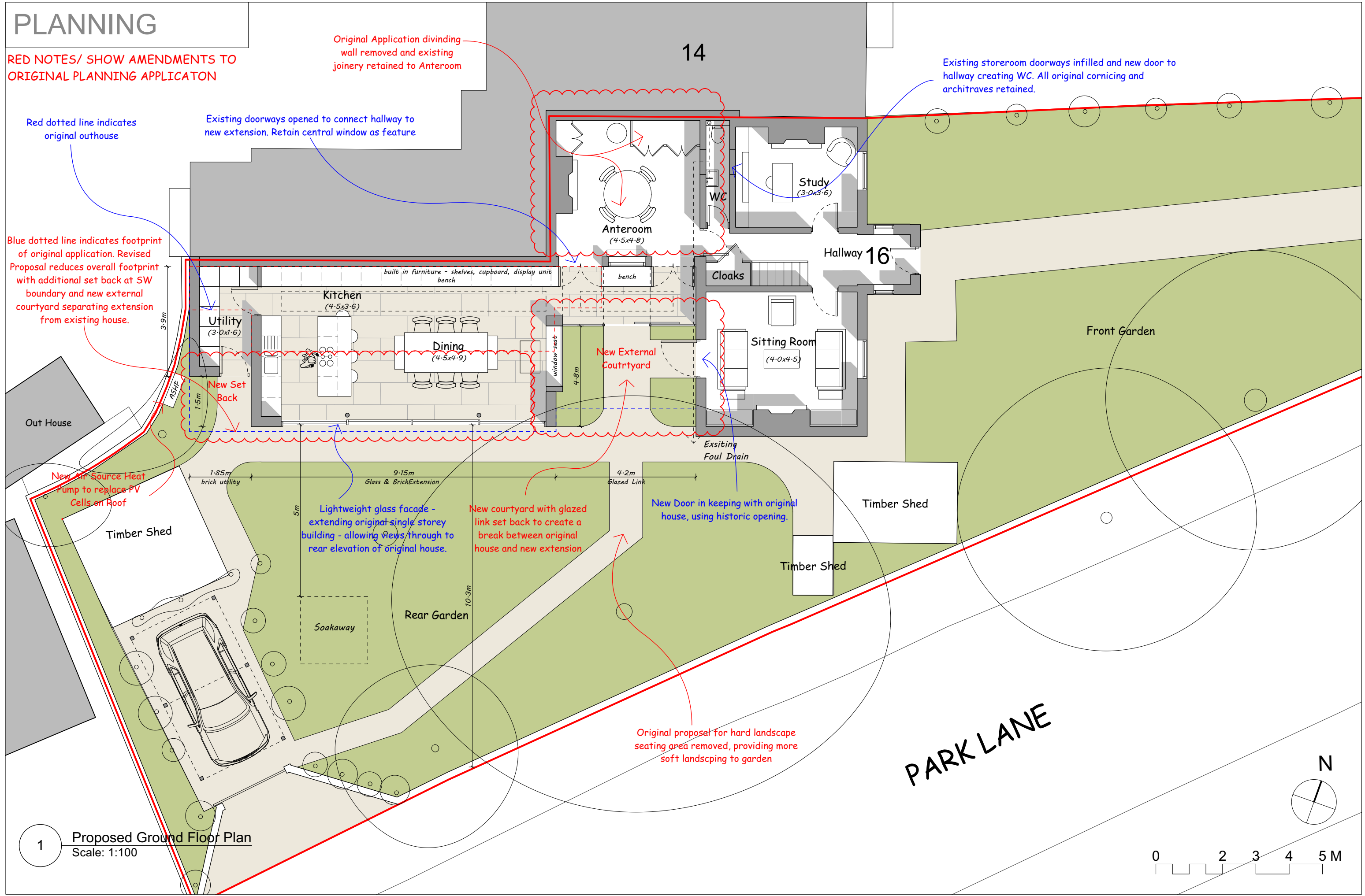

1 Proposed Ground Floor Plan  
Scale: 1:100

