

# PLANNING

RED NOTES/ SHOW AMENDMENTS TO ORIGINAL PLANNING APPLICATION

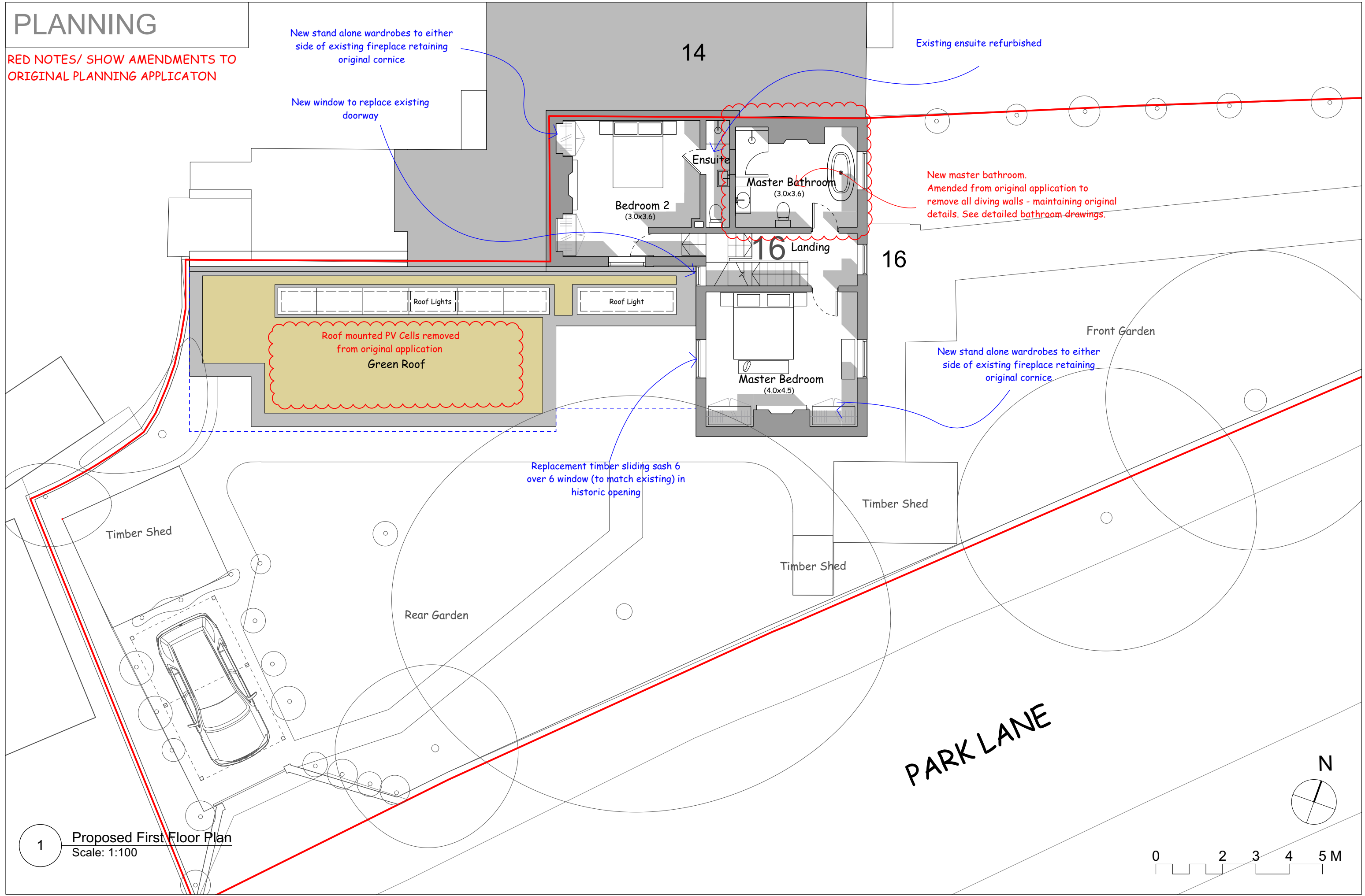

New stand alone wardrobes to either side of existing fireplace retaining original cornice

New window to replace existing doorway

Existing ensuite refurbished

New master bathroom. Amended from original application to remove all diving walls - maintaining original details. See detailed bathroom drawings.

Roof mounted PV Cells removed from original application  
Green Roof

New stand alone wardrobes to either side of existing fireplace retaining original cornice

Replacement timber sliding sash 6 over 6 window (to match existing) in historic opening

1 Proposed First Floor Plan  
Scale: 1:100

0 2 3 4 5 M