

GENERAL NOTES

1. THIS PLAN IS A PRELIMINARY DESIGN AND SHOULD NOT BE USED FOR CONSTRUCTION WITHOUT THE APPROVAL OF THE ARCHITECT.

2. THE ARCHITECT HAS CONDUCTED VISUAL SURVEYS AND PHOTOGRAPHS OF THE SITE AND HAS TAKEN INTO ACCOUNT THE SURROUNDING ENVIRONMENT AND THE NEED TO PRESERVE THE CHARACTER OF THE AREA.

3. THE ARCHITECT HAS CONDUCTED VISUAL SURVEYS AND PHOTOGRAPHS OF THE SITE AND HAS TAKEN INTO ACCOUNT THE SURROUNDING ENVIRONMENT AND THE NEED TO PRESERVE THE CHARACTER OF THE AREA.

4. THE ARCHITECT HAS CONDUCTED VISUAL SURVEYS AND PHOTOGRAPHS OF THE SITE AND HAS TAKEN INTO ACCOUNT THE SURROUNDING ENVIRONMENT AND THE NEED TO PRESERVE THE CHARACTER OF THE AREA.

5. THE ARCHITECT HAS CONDUCTED VISUAL SURVEYS AND PHOTOGRAPHS OF THE SITE AND HAS TAKEN INTO ACCOUNT THE SURROUNDING ENVIRONMENT AND THE NEED TO PRESERVE THE CHARACTER OF THE AREA.

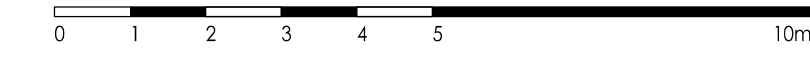

GREEN ROOFS
(COMBINED AREA = 1397.4 sq m)

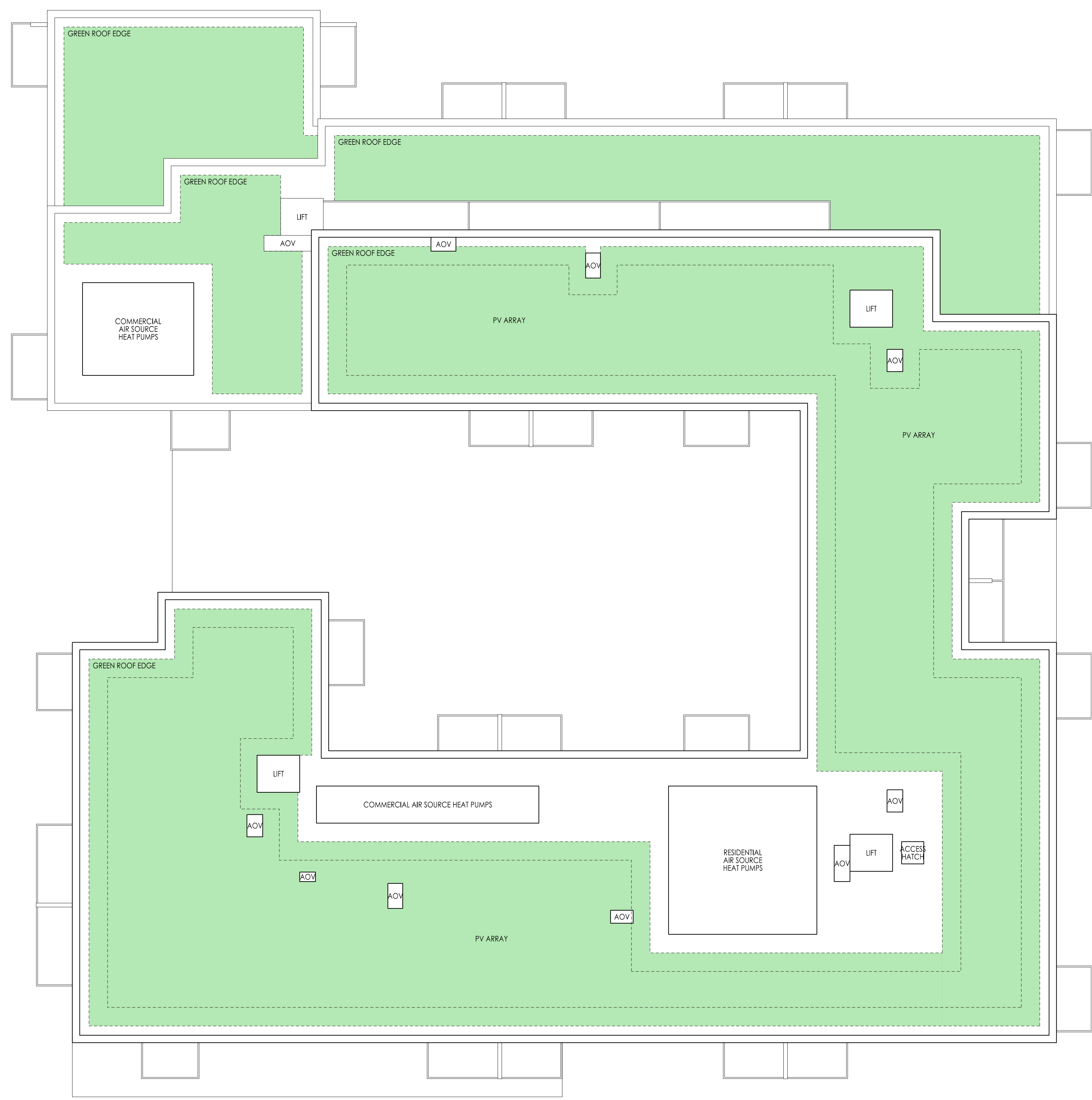

BLOCK B1: ROOF PLAN

2019.04.01	PRELIMINARY FOR PERMITTING APPLICATION	PP	DCS
2019.04.01	PRELIMINARY FOR PERMITTING APPLICATION	PP	DCS
2019.04.01	PRELIMINARY FOR PERMITTING APPLICATION	PP	DCS
2019.04.01	PRELIMINARY FOR PERMITTING APPLICATION	PP	DCS

AHR ARCHITECTS
31-35 KIRBY STREET
LONDON, EC1N 8TE
TEL: 020-7837-9789
www.ahr.co.uk

CLIENT	Notting Hill Genesis
PROJECT	St Clare SCL-AHR Block B1 Roof Plan
STATUS	PLANNING
DATE	2019.04
DRAWING NO.	B1-R1-DR-A-20-016-P1
VERSION	P03