

**GENERAL NOTES**  
 1. ALL WORK TO BE IN ACCORDANCE WITH THE CURRENT BUILDING REGULATIONS AND ALL APPLICABLE STANDARDS.  
 2. THE CONTRACTOR SHALL BE RESPONSIBLE FOR OBTAINING ALL NECESSARY PERMITS AND APPROVALS FROM THE LOCAL AUTHORITIES.  
 3. THE CONTRACTOR SHALL BE RESPONSIBLE FOR OBTAINING ALL NECESSARY APPROVALS FROM THE LOCAL AUTHORITIES.  
 4. ALL WORK SHALL BE IN ACCORDANCE WITH THE CURRENT BUILDING REGULATIONS AND ALL APPLICABLE STANDARDS.  
 5. THE CONTRACTOR SHALL BE RESPONSIBLE FOR OBTAINING ALL NECESSARY PERMITS AND APPROVALS FROM THE LOCAL AUTHORITIES.  
 6. ALL WORK SHALL BE IN ACCORDANCE WITH THE CURRENT BUILDING REGULATIONS AND ALL APPLICABLE STANDARDS.  
 7. THE CONTRACTOR SHALL BE RESPONSIBLE FOR OBTAINING ALL NECESSARY PERMITS AND APPROVALS FROM THE LOCAL AUTHORITIES.  
 8. ALL WORK SHALL BE IN ACCORDANCE WITH THE CURRENT BUILDING REGULATIONS AND ALL APPLICABLE STANDARDS.  
 9. THE CONTRACTOR SHALL BE RESPONSIBLE FOR OBTAINING ALL NECESSARY PERMITS AND APPROVALS FROM THE LOCAL AUTHORITIES.  
 10. ALL WORK SHALL BE IN ACCORDANCE WITH THE CURRENT BUILDING REGULATIONS AND ALL APPLICABLE STANDARDS.

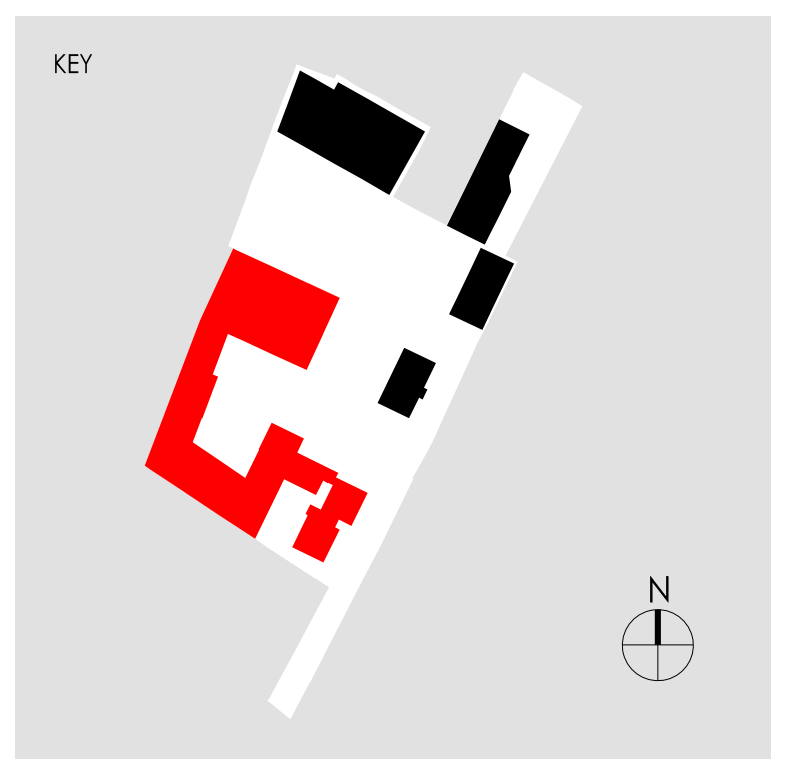
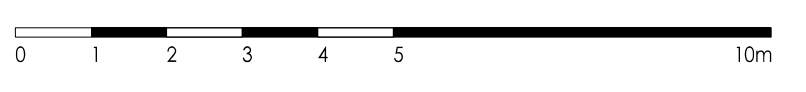

EXISTING FIRST FLOOR PLAN (SOUTH SIDE)

DATE	BY	CHKD
DATE	BY	CHKD
<b>PCKO</b> an HR company		
ARCHITECTS		INTERIOR DESIGNERS
MASTER PLANNERS		URBAN DESIGNERS
Client		
Notling Hill Genesis		
Project		
St Clare SCL-AHR		
Drawing Title		
Existing First Floor Plan South Side PLANNING		
Scale	1:250	Drawn by
Date	2019.10	Checked by
Drawing No.	S0-01-DR-B-10-011-P1	Revision
		P01