

Sources: Point2Surveyors
 Scan Data (received 28/08/18)
 Greggs Twickenham_UpdateAug2018_Recap.rcp
 Site Photos (received 17/08/18)
 Surrounding Elevs/IMG_1144-1912.jpg
 Proposed Scheme (21/02/22, 24/02/22 and 12/07/22)
 A2871 Greggs Scheme 1 Industrial 3d Export.3ds
 A2871 250 Plans 2d Export.dwg to A2871 255 Plans 2d Export.dwg

Key: Daylight Illuminance
 (achieved for 50% over daylight hours)

<50 Lux
>50 Lux
>100 Lux
>150 Lux
>200 Lux

Project: Greggs, Twickenham

Title: Internal Room Layouts and Daylight Illuminance Study
 Proposed Residential and Industrial Scheme 12/07/22

Scheme Confirmed:
-

Date:
-

Drawn By:
NB

Scale:
1:300 @ A3

Date:
JULY 2022

Dwg No:
P1886/CBDM RI B

Rel:
12 14



BLOCKS A AND F - GROUND FLOOR

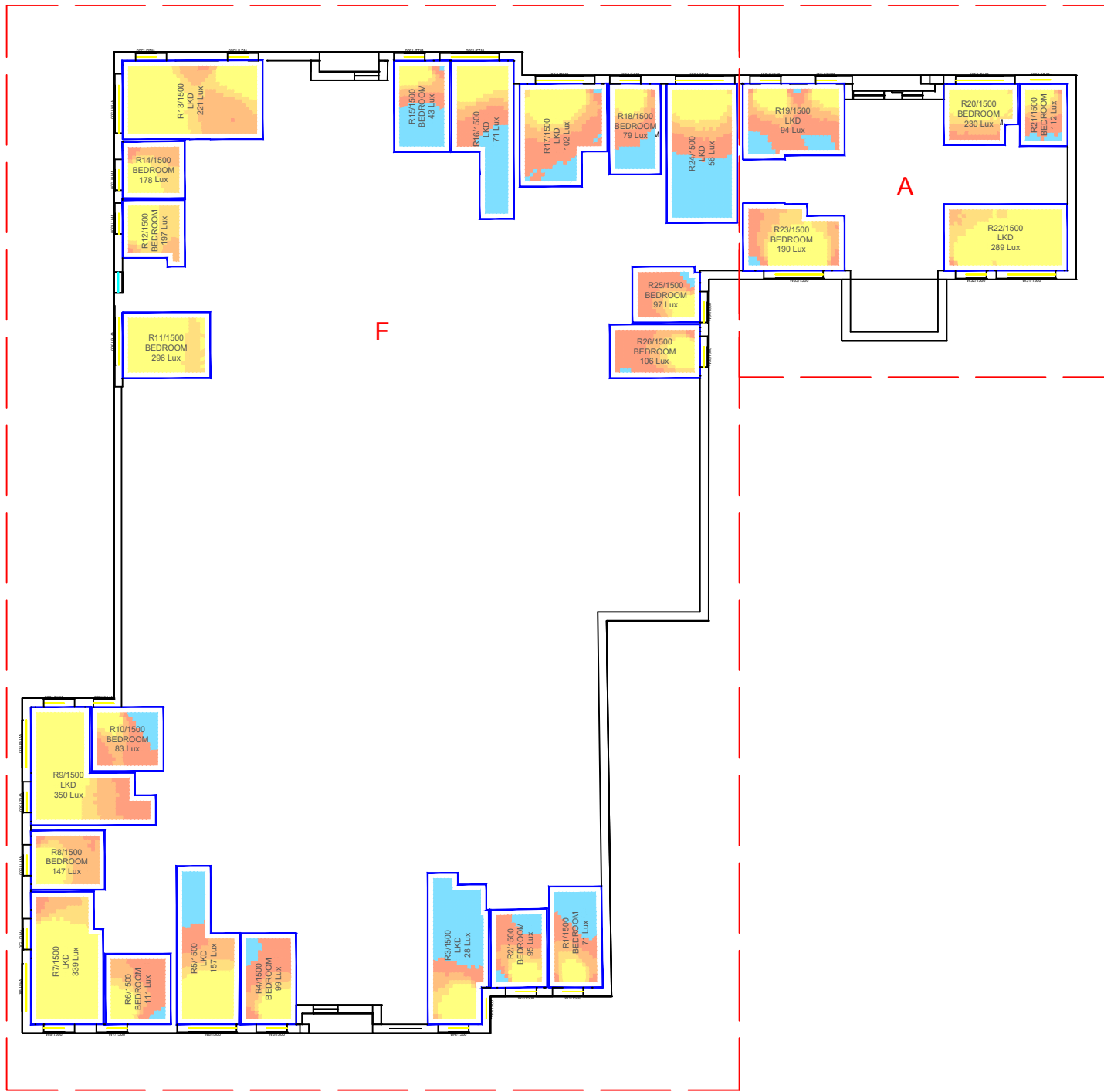
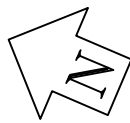

BLOCKS A AND F - FIRST FLOOR

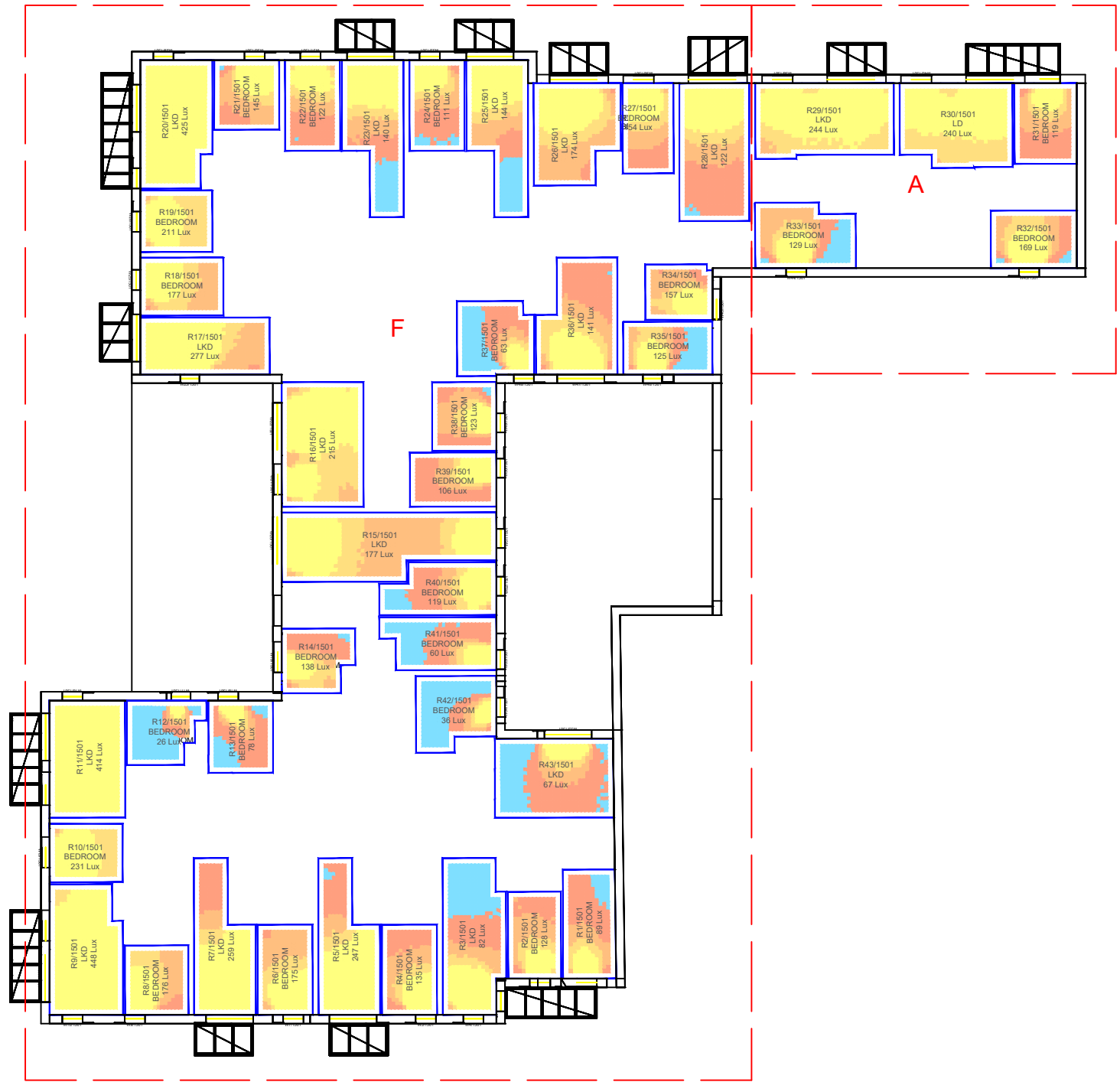

Sources: Point2Surveyors
 Scan Data (received 28/08/18)
 Greggs Twickenham_UpdateAug2018_Recap.rcp
 Site Photos (received 17/08/18)
 Surrounding Elevs/IMG_1144-1912.jpg
 Proposed Scheme (21/02/22, 24/02/22 and 12/07/22)
 A2871 Greggs Scheme 1 Industrial 3d Export.3ds
 A2871 250 Plans 2d Export.dwg to A2871 255 Plans 2d Export.dwg

Key: Daylight Illuminance
 (achieved for 50% over daylight hours)

- <50 Lux
- >50 Lux
- >100 Lux
- >150 Lux
- >200 Lux

Project: Greggs, Twickenham

Title: Internal Room Layouts and Daylight Illuminance Study
 Proposed Residential and Industrial Scheme 12/07/22

Scheme Confirmed: -

Date: -

Drawn By: NB

Scale: 1:300 @ A3

Date: JULY 2022

Dwg No: P1886/CBDM RI B

Rel: 13 14



BLOCKS A AND F - SECOND FLOOR

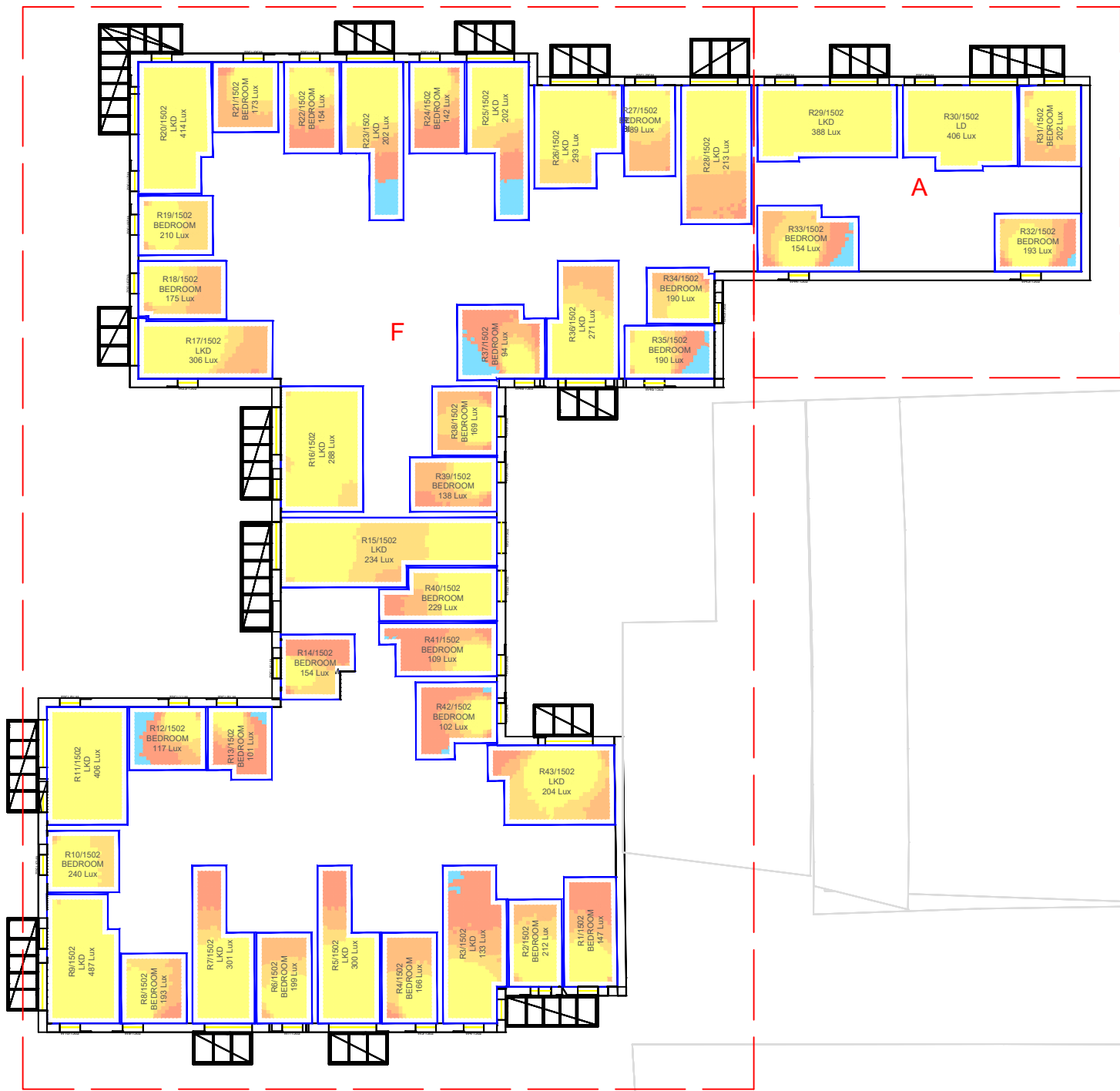
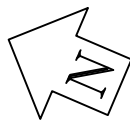

BLOCKS A AND F - THIRD FLOOR

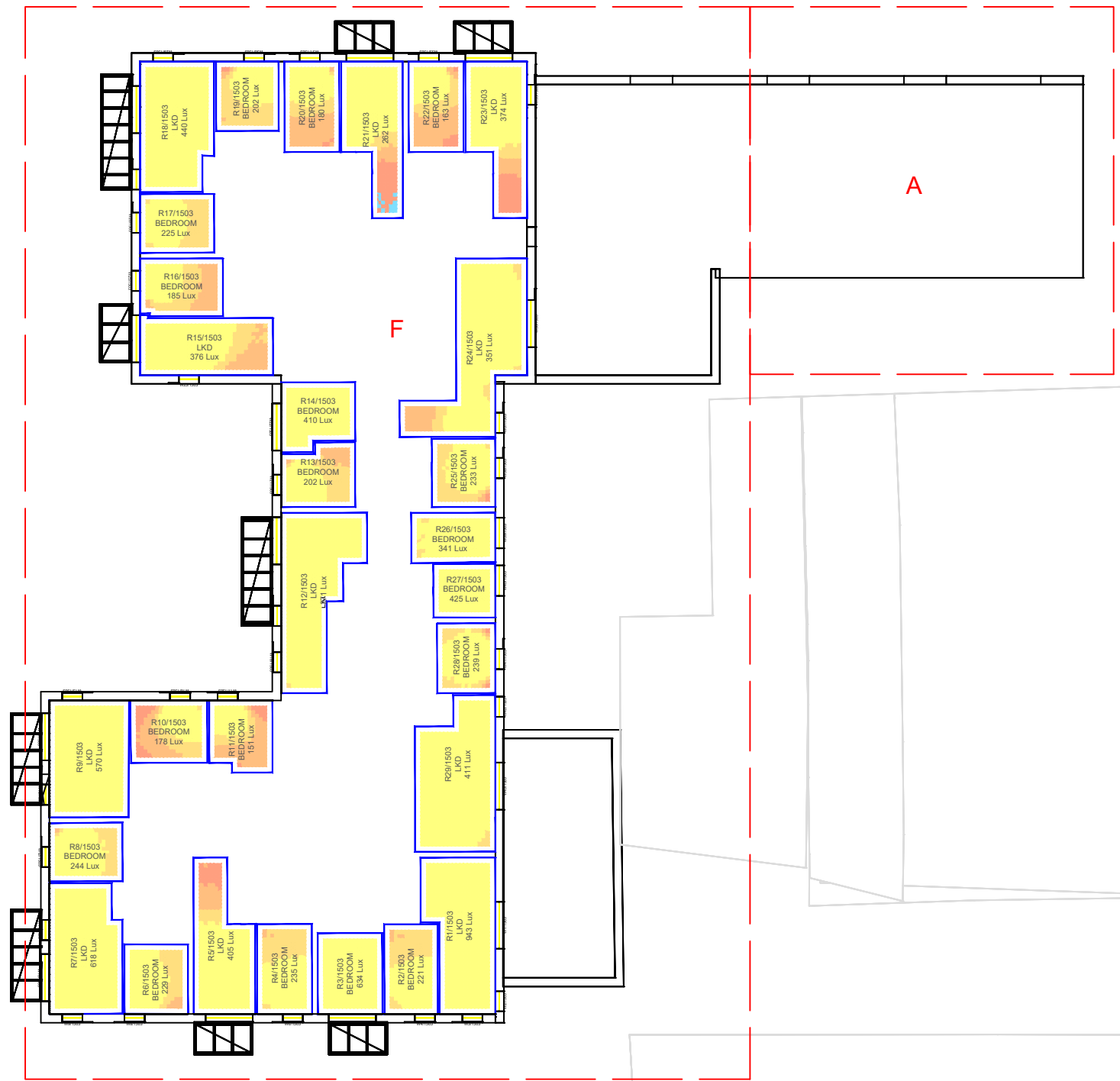

Sources: Point2Surveyors
 Scan Data (received 28/08/18)
 Greggs Twickenham_UpdateAug2018_Recap.rcp
 Site Photos (received 17/08/18)
 Surrounding Elevs/IMG_1144-1912.jpg
 Proposed Scheme (21/02/22, 24/02/22 and 12/07/22)
 A2871 Greggs Scheme 1 Industrial 3d Export.3ds
 A2871 250 Plans 2d Export.dwg to A2871 255 Plans 2d Export.dwg

Key: Daylight Illuminance
 (achieved for 50% over daylight hours)

- <50 Lux
- >50 Lux
- >100 Lux
- >150 Lux
- >200 Lux

Project: Greggs, Twickenham

Title: Internal Room Layouts and Daylight Illuminance Study
 Proposed Residential and Industrial Scheme 12/07/22

Scheme Confirmed: -

Date: -

Drawn By: NB

Scale: 1:300 @ A3

Date: JULY 2022

Dwg No: P1886/CBDM RI B 14

Rel: 14



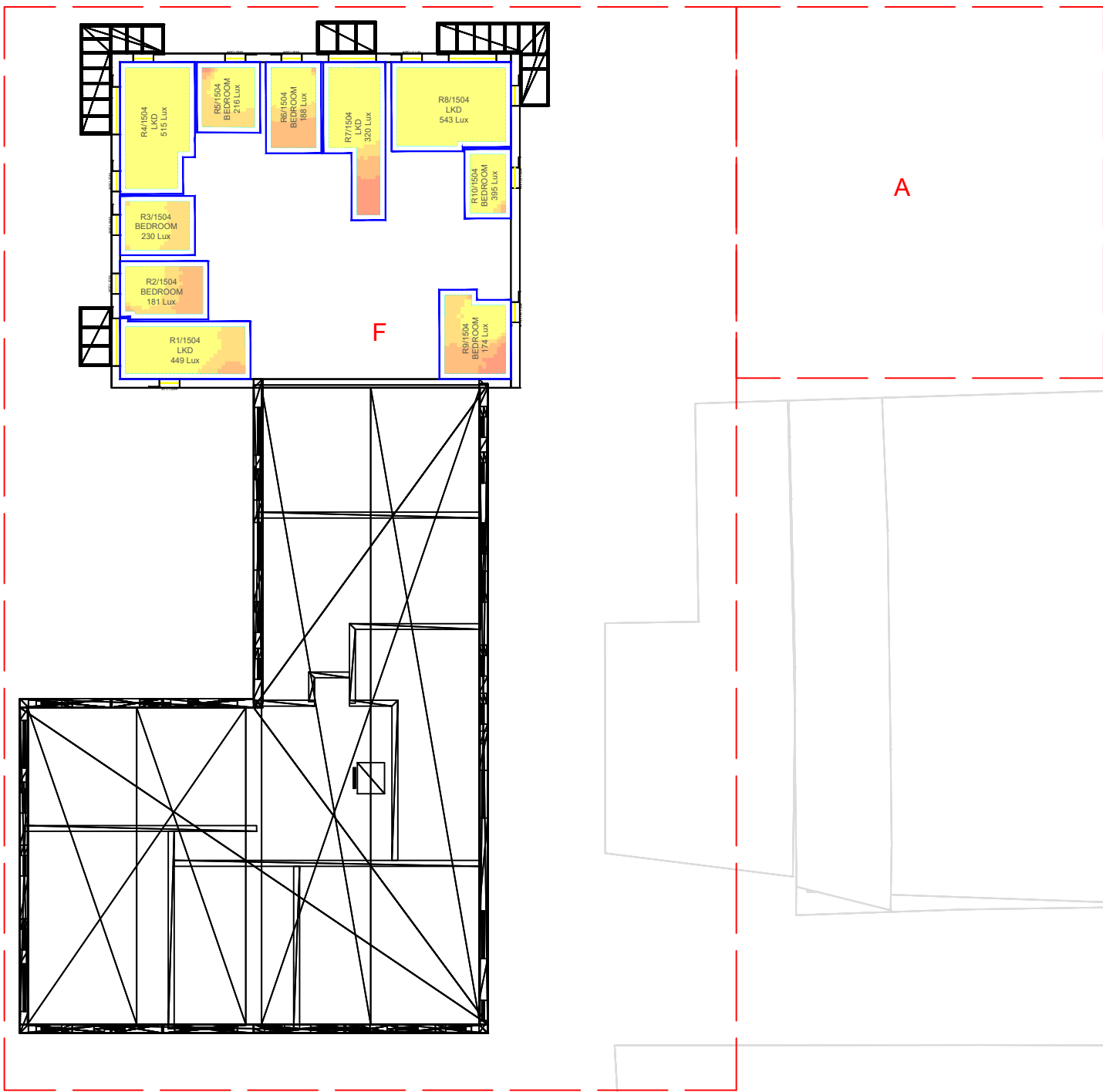
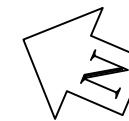
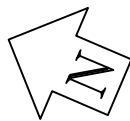

A

A

F

Sources: Point2Surveyors
 Scan Data (received 28/08/18)
 Greggs Twickenham_UpdateAug2018_Recap.rcp
 Site Photos (received 17/08/18)
 Surrounding Elevs/IMG_1144-1912.jpg
 Proposed Scheme (21/02/22, 24/02/22 and 12/07/22)
 A2871 Greggs Scheme 1 Industrial 3d Export.3ds
 A2871 250 Plans 2d Export.dwg to A2871 255 Plans 2d Export.dwg

Key: Daylight Illuminance
 (achieved for 50% over daylight hours)

- <50 Lux
- >50 Lux
- >100 Lux
- >150 Lux
- >200 Lux

Project: Greggs, Twickenham

Title: Internal Room Layouts and Daylight Illuminance Study
 Proposed Residential and Industrial Scheme 12/07/22

Scheme Confirmed: -

Date: -

Drawn By: NB

Scale: 1:300 @ A3

Date: JULY 2022

Dwg No: P1886/CBDM RI B

Rel: 15 14



BLOCK G - GROUND FLOOR

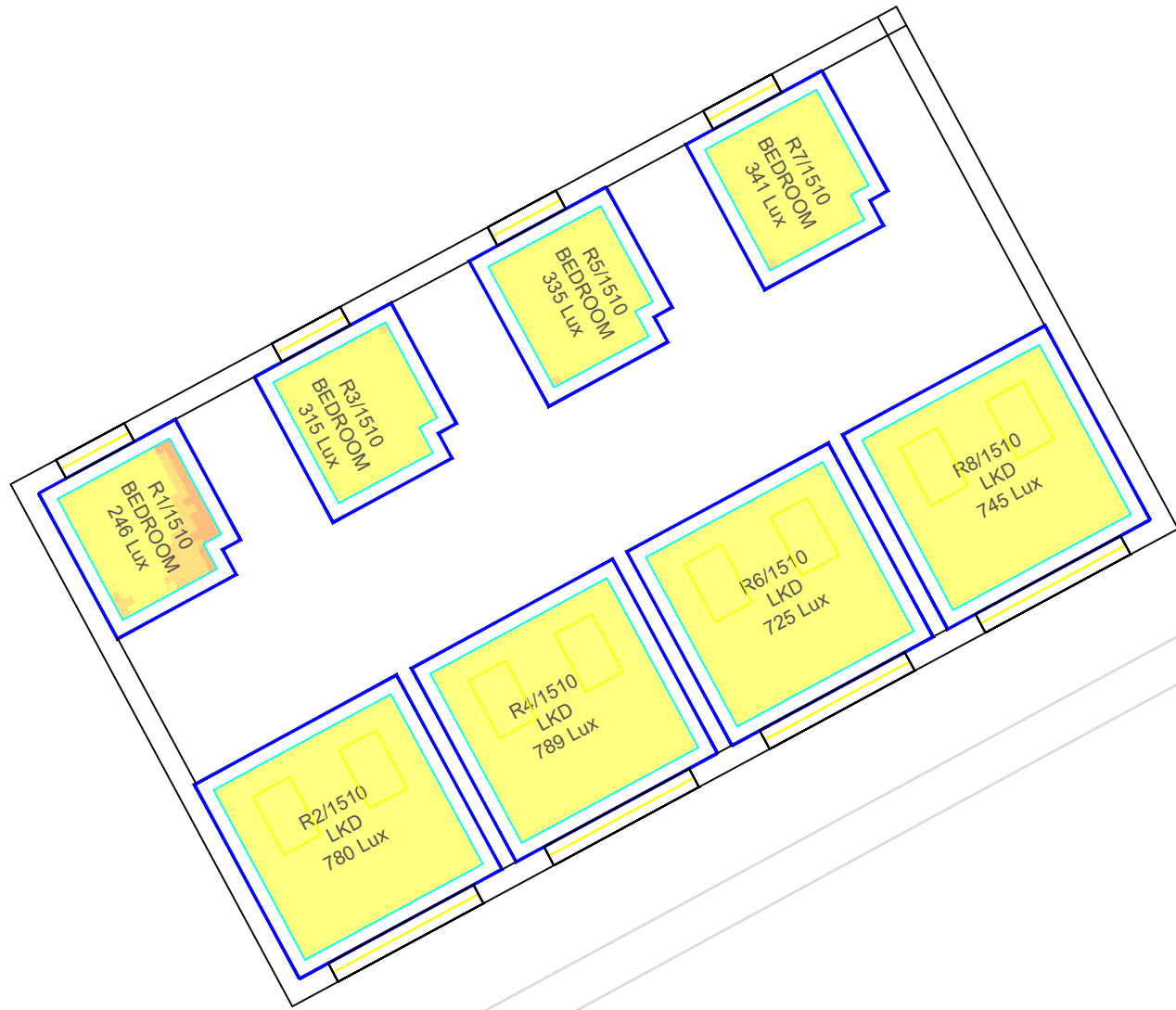
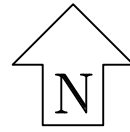

BLOCK G - FIRST FLOOR

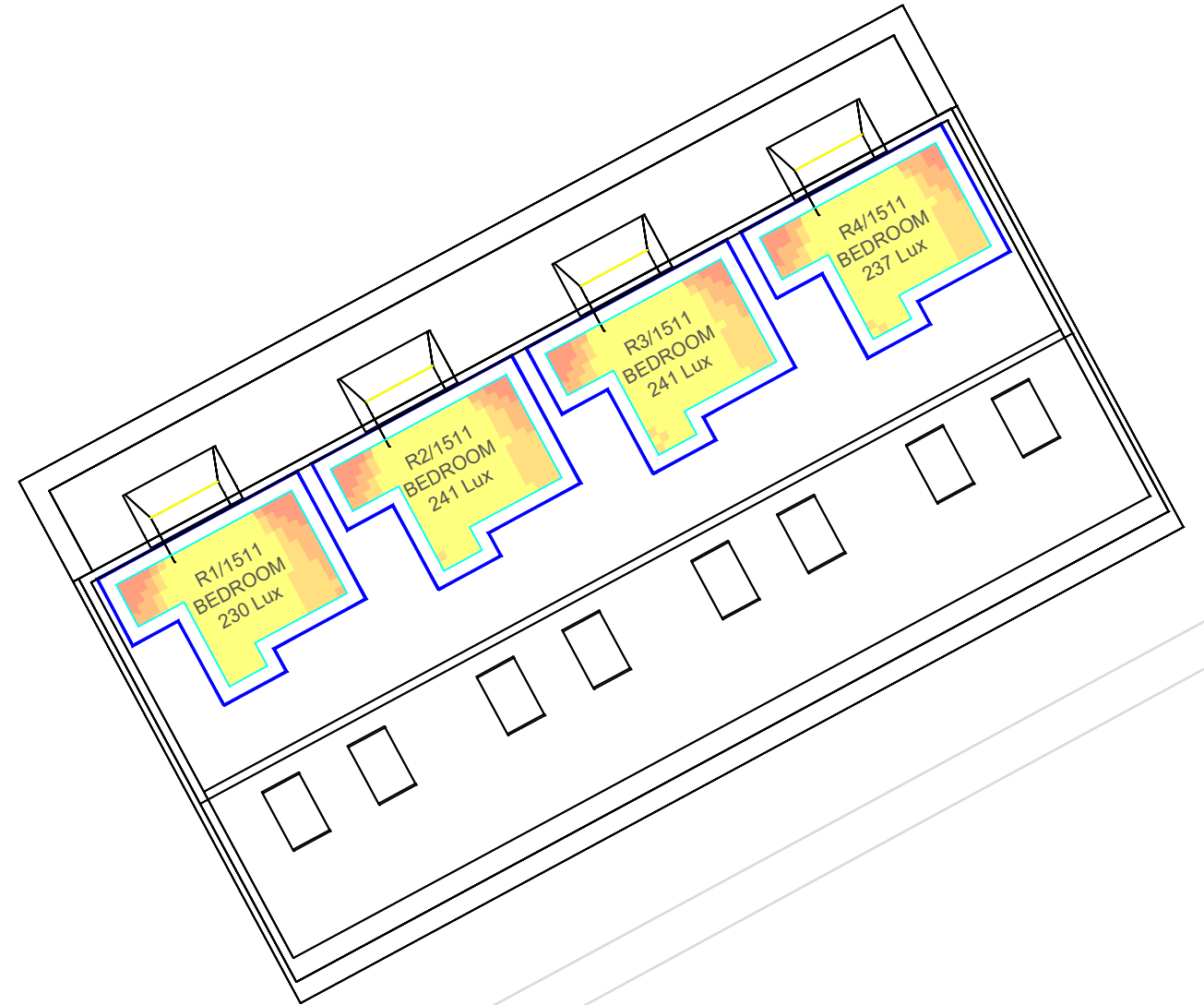
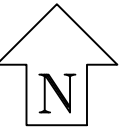

Sources: Point2Surveyors
 Scan Data (received 28/08/18)
 Greggs Twickenham_UpdateAug2018_Recap.rcp
 Site Photos (received 17/08/18)
 Surrounding Elevs/IMG_1144-1912.jpg
 Proposed Scheme (21/02/22, 24/02/22 and 12/07/22)
 A2871 Greggs Scheme 1 Industrial 3d Export.3ds
 A2871 250 Plans 2d Export.dwg to A2871 255 Plans 2d Export.dwg

Key: Daylight Illuminance
 (achieved for 50% over daylight hours)

- <50 Lux
- >50 Lux
- >100 Lux
- >150 Lux
- >200 Lux

Project: Greggs, Twickenham

Title: Internal Room Layouts and Daylight Illuminance Study
 Proposed Residential and Industrial Scheme 12/07/22

Scheme Confirmed: -

Date: -

Drawn By: NB

Scale: 1:150 @ A3

Date: JULY 2022

Dwg No: P1886/CBDM RI B_16

Rel: 14



BLOCK E - GROUND FLOOR

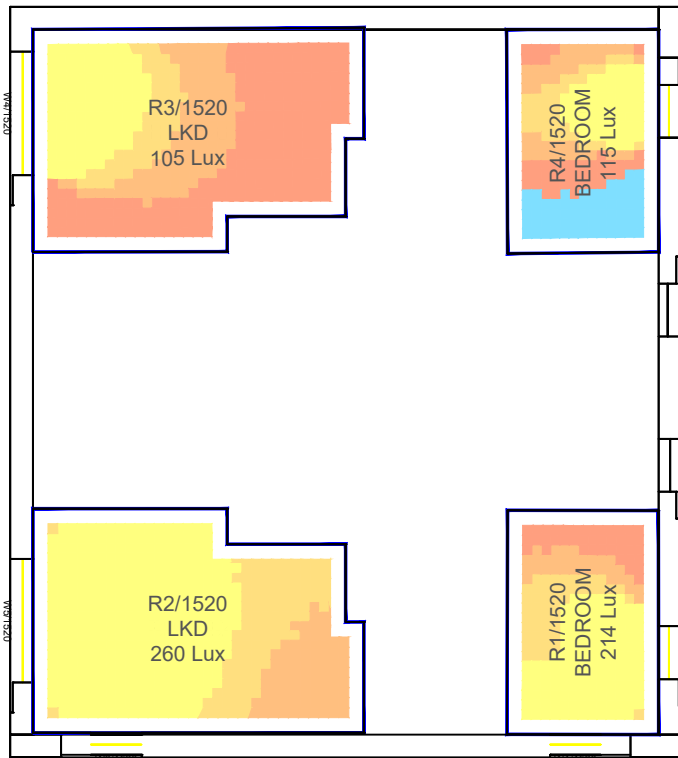
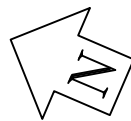

BLOCK E - FIRST FLOOR

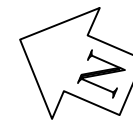

BLOCK E - SECOND FLOOR

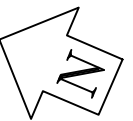

Sources: Point2Surveyors
 Scan Data (received 28/08/18)
 Greggs Twickenham_UpdateAug2018_Recap.rcp
 Site Photos (received 17/08/18)
 Surrounding Elevs/IMG_1144-1912.jpg
 Proposed Scheme (21/02/22, 24/02/22 and 12/07/22)
 A2871 Greggs Scheme 1 Industrial 3d Export.3ds
 A2871 250 Plans 2d Export.dwg to A2871 255 Plans 2d Export.dwg

Key: Daylight Illuminance
 (achieved for 50% over daylight hours)

- <50 Lux
- >50 Lux
- >100 Lux
- >150 Lux
- >200 Lux

Project: Greggs, Twickenham

Title: Internal Room Layouts and Daylight Illuminance Study
 Proposed Residential and Industrial Scheme 12/07/22

Scheme Confirmed:

Date:

Drawn By:
 NB

Scale:
 1:150 @ A3

Date:
 JULY 2022

Dwg No:

P1886/CBDM RI B_17_14

Rel:



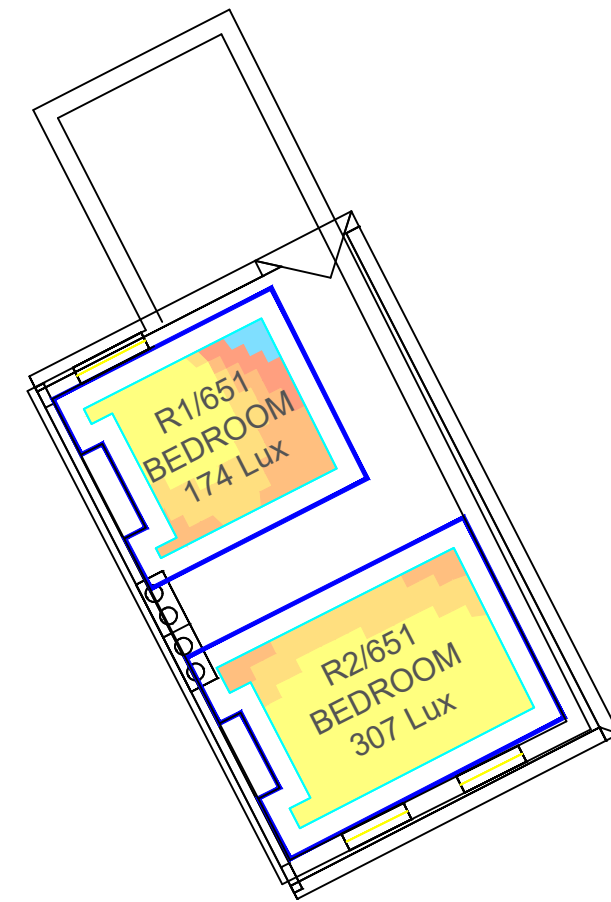
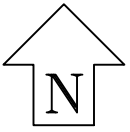
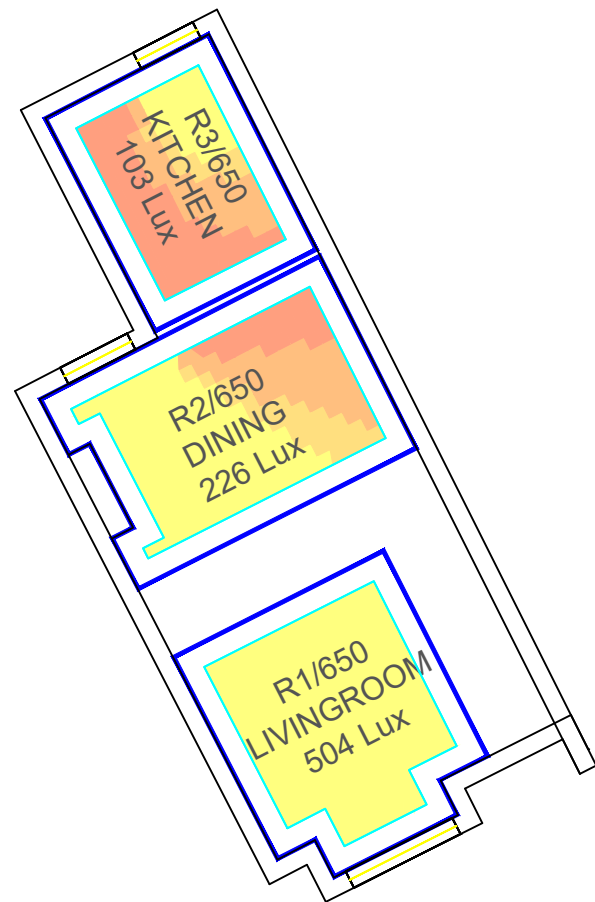
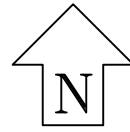

Sources: Point2Surveyors
 Scan Data (received 28/08/18)
 Greggs Twickenham_UpdateAug2018_Recap.rcp

 Site Photos (received 17/08/18)
 Surrounding Elevs/IMG_1144-1912.jpg

 Proposed Scheme (21/02/22, 24/02/22 and 12/07/22)

 A2871 Greggs Scheme 1 Industrial 3d Export.3ds
 A2871 250 Plans 2d Export.dwg to A2871 255 Plans 2d Export.dwg

Key: Daylight Illuminance
 (achieved for 50% over daylight hours)

- <50 Lux
- >50 Lux
- >100 Lux
- >150 Lux
- >200 Lux

Project: Greggs, Twickenham

Title: Internal Room Layouts and Daylight Illuminance Study
 Proposed Residential and Industrial Scheme 12/07/22

Scheme Confirmed:
 -

Date:
 -

Drawn By:
 NB

Scale:
 1:150 @ A3

Date:
 JULY 2022

Dwg No: P1886/CBDM RI B_18
Rel: 14





BRE CBDM ANALYSIS

PROJECT GREGGS, PROJECT LOCATION
140722 CBDM

BRE CBDM ANALYSIS

Room Label	Room Use	Room Use Target Illuminance Lux	Median Illuminance Lux	Fraction of Working Plane % Area	BRE ADF(%)
------------	----------	---------------------------------	------------------------	----------------------------------	------------

Block D5-D8

R4/1590	KD	200	538.9	100	4.9
R10/1591	BEDROOM	100	196.2	99.2	1.6
R11/1591	LIVINGROOM	150	335.7	100	2.7
R12/1591	BEDROOM	100	286.9	100	3.1
R1/1852	BEDROOM	100	121.8	69.1	1.3
R6/1852	BEDROOM	100	346	99.5	2.7

Block D9-C12

R5/1590	KD	200	521	100	4.9
R6/1590	KD	200	537.9	100	4.9
R7/1590	KD	200	542.5	100	4.9
R8/1590	KD	200	552.2	100	5
R13/1591	BEDROOM	100	167.7	97.7	1.6
R14/1591	LIVINGROOM	150	396.4	100	2.8
R15/1591	BEDROOM	100	283.4	100	3.1
R16/1591	BEDROOM	100	189.7	99.2	1.7
R17/1591	LIVINGROOM	150	394.1	100	2.8
R18/1591	BEDROOM	100	261.4	100	3.1
R19/1591	BEDROOM	100	144.2	83	1.6
R20/1591	LIVINGROOM	150	319.9	100	2.8
R21/1591	BEDROOM	100	204.1	96.2	3.1
R23/1591	LIVINGROOM	150	276.2	100	2.7
R24/1591	BEDROOM	100	222.4	100	2.8
R13/1592	BEDROOM	100	246.1	99.9	2.6
R14/1592	BEDROOM	100	112	62.1	1.3
R15/1592	BEDROOM	100	212.1	97.9	2.5
R16/1592	BEDROOM	100	89.7	44.6	1.4
R2/1852	BEDROOM	100	122.1	70.4	1.3
R3/1852	BEDROOM	100	121	69.5	1.3
R4/1852	BEDROOM	100	346.9	100	2.7
R5/1852	BEDROOM	100	343.3	99.8	2.7

Block D13-16



BRE CBDM ANALYSIS

PROJECT GREGGS, PROJECT LOCATION
140722 CBDM

BRE CBDM ANALYSIS

R1/1600	KD	200	572.4	100	5
R2/1600	KD	200	576.3	100	5
R3/1600	KD	200	569.5	100	5
R4/1600	KD	200	555.1	100	4.9
R1/1601	LIVINGROOM	150	320.8	100	2.7
R2/1601	BEDROOM	100	259	100	2.8
R3/1601	LIVINGROOM	150	322.2	100	2.7
R4/1601	BEDROOM	100	258.8	100	2.8
R5/1601	LIVINGROOM	150	320.5	100	2.7
R6/1601	BEDROOM	100	260.1	100	2.8
R7/1601	LIVINGROOM	150	316.6	100	2.7
R8/1601	BEDROOM	100	254.6	100	2.8
R1/1602	BEDROOM	100	259.2	99.8	2.6
R2/1602	BEDROOM	100	102	51.7	1.4
R3/1602	BEDROOM	100	259.5	99.5	2.6
R4/1602	BEDROOM	100	104.4	51.2	1.4
R5/1602	BEDROOM	100	256.4	99.7	2.6
R6/1602	BEDROOM	100	107.3	54.7	1.4
R7/1602	BEDROOM	100	248.2	99.5	2.6
R8/1602	BEDROOM	100	120.4	76.3	1.4

Block A

R19/1500	LKD	200	93.5	18.2	1.8
R20/1500	BEDROOM	100	227.7	91.3	2.7
R21/1500	BEDROOM	100	113.8	57.5	1.5
R22/1500	LKD	200	288.3	84.6	3.5
R23/1500	BEDROOM	100	191.6	84	2.5
R29/1501	LKD	200	243	77.8	2.4
R30/1501	LD	150	241.3	99.7	2.4
R31/1501	BEDROOM	100	116.1	62.7	1.1
R32/1501	BEDROOM	100	167	80.4	1.5
R33/1501	BEDROOM	100	128.3	65.7	1.1
R29/1502	LKD	200	387.3	100	3.5
R30/1502	LD	150	406	100	3.7
R31/1502	BEDROOM	100	200.6	100	1.8
R32/1502	BEDROOM	100	191.8	82.3	1.6
R33/1502	BEDROOM	100	155.1	73.5	1.3

Block F

R1/1500	BEDROOM	100	67.5	37.1	1
---------	---------	-----	------	------	---



BRE CBDM ANALYSIS

PROJECT GREGGS, PROJECT LOCATION
140722 CBDM

BRE CBDM ANALYSIS

R2/1500	BEDROOM	100	95.3	47.8	1.2
R3/1500	LKD	200	27.4	17.4	1.3
R4/1500	BEDROOM	100	98.4	48.8	1.6
R5/1500	LKD	200	159.3	41.9	2.2
R6/1500	BEDROOM	100	110.1	56.2	1.9
R7/1500	LKD	200	336.1	82.5	3.9
R8/1500	BEDROOM	100	146.9	95	2.1
R9/1500	LKD	200	350.1	69.7	3.5
R10/1500	BEDROOM	100	83.1	38.4	1.4
R11/1500	BEDROOM	100	294.5	100	3.5
R12/1500	BEDROOM	100	194.1	99.5	2.3
R13/1500	LKD	200	221.9	54.6	3.5
R14/1500	BEDROOM	100	178.8	97.1	2.2
R15/1500	BEDROOM	100	44.2	30.4	1.4
R16/1500	LKD	200	69.8	26.5	1.9
R17/1500	LKD	200	102.2	28	1.8
R18/1500	BEDROOM	100	78.3	42.2	1.5
R24/1500	LKD	200	55.8	21.1	1.6
R25/1500	BEDROOM	100	96.2	49.1	1.5
R26/1500	BEDROOM	100	106.2	53.1	1.4
R1/1501	BEDROOM	100	87.6	44.2	1.1
R2/1501	BEDROOM	100	130.5	75.9	1.2
R3/1501	LKD	200	80.6	25.2	1.4
R4/1501	BEDROOM	100	136.9	73.9	1.8
R5/1501	LKD	200	248.4	64.5	2
R6/1501	BEDROOM	100	177.1	98.5	1.8
R7/1501	LKD	200	260	67.9	2.1
R8/1501	BEDROOM	100	173.6	93.3	2.1
R9/1501	LKD	200	453.6	97.8	3.6
R10/1501	BEDROOM	100	235.8	100	2.2
R11/1501	LKD	200	415.6	100	3.7
R12/1501	BEDROOM	100	26.9	16.8	1.4
R13/1501	BEDROOM	100	77.7	29.5	1.2
R14/1501	BEDROOM	100	141.9	59.9	1.5
R15/1501	LKD	200	177.4	42.8	1.8
R16/1501	LKD	200	215.4	67.4	2
R17/1501	LKD	200	276.1	63.2	3.1
R18/1501	BEDROOM	100	175.4	99.6	1.9
R19/1501	BEDROOM	100	206.6	100	2.1
R20/1501	LKD	200	421.8	100	3.6
R21/1501	BEDROOM	100	144.4	83.1	1.8
R22/1501	BEDROOM	100	125.7	60.1	1.6



BRE CBDM ANALYSIS

PROJECT GREGGS, PROJECT LOCATION
140722 CBDM

BRE CBDM ANALYSIS

R23/1501	LKD	200	141.4	38.6	1.8
R24/1501	BEDROOM	100	110.1	55.1	1.6
R25/1501	LKD	200	143.8	37.5	1.8
R26/1501	LKD	200	174.7	41.1	1.7
R27/1501	BEDROOM	100	151.2	74.7	1.7
R28/1501	LKD	200	122.5	32	1.5
R34/1501	BEDROOM	100	156.5	93.7	1.5
R35/1501	BEDROOM	100	125.2	55.6	1.4
R36/1501	LKD	200	139.6	29.5	1.3
R37/1501	BEDROOM	100	62.7	28.8	0.9
R38/1501	BEDROOM	100	124.2	72.6	1.4
R39/1501	BEDROOM	100	106.9	53	1.5
R40/1501	BEDROOM	100	117.8	57.7	1.4
R41/1501	BEDROOM	100	59.2	26.8	1.2
R42/1501	BEDROOM	100	35.6	20.6	0.9
R43/1501	LKD	200	66.7	8	0.9
R1/1502	BEDROOM	100	146.5	68.3	1.7
R2/1502	BEDROOM	100	210.2	100	1.8
R3/1502	LKD	200	130.6	33.2	1.9
R4/1502	BEDROOM	100	163.1	98.1	1.9
R5/1502	LKD	200	300.7	71.6	2.2
R6/1502	BEDROOM	100	199.8	100	1.9
R7/1502	LKD	200	301	71.5	2.2
R8/1502	BEDROOM	100	193.9	94.2	2.1
R9/1502	LKD	200	487.6	100	3.9
R10/1502	BEDROOM	100	240.5	100	2.1
R11/1502	LKD	200	405.3	100	3.6
R12/1502	BEDROOM	100	114	55.5	1.6
R13/1502	BEDROOM	100	99	48.8	1.5
R14/1502	BEDROOM	100	154.4	62.6	1.5
R15/1502	LKD	200	234.7	62.1	2.2
R16/1502	LKD	200	289.2	93.7	2.8
R17/1502	LKD	200	309.4	63.1	3.2
R18/1502	BEDROOM	100	172.7	100	1.8
R19/1502	BEDROOM	100	210.1	100	2.1
R20/1502	LKD	200	414.4	100	3.6
R21/1502	BEDROOM	100	173.3	97.8	1.9
R22/1502	BEDROOM	100	154.9	77.2	1.7
R23/1502	LKD	200	206.1	51	2
R24/1502	BEDROOM	100	139.5	70.7	1.7
R25/1502	LKD	200	204.3	51.1	2
R26/1502	LKD	200	289.4	80.9	2.8



BRE CBDM ANALYSIS

PROJECT GREGGS, PROJECT LOCATION
140722 CBDM

BRE CBDM ANALYSIS

R27/1502	BEDROOM	100	188.9	100	1.9
R28/1502	LKD	200	212.1	52.3	2.7
R34/1502	BEDROOM	100	189.8	98.7	1.7
R35/1502	BEDROOM	100	192.3	65.1	1.5
R36/1502	LKD	200	270.6	64.1	2.7
R37/1502	BEDROOM	100	94.5	43.6	1
R38/1502	BEDROOM	100	167.2	95.9	1.5
R39/1502	BEDROOM	100	139.8	89.2	1.6
R40/1502	BEDROOM	100	228.6	90	2.2
R41/1502	BEDROOM	100	107.5	56.2	1.3
R42/1502	BEDROOM	100	101.6	51.9	1.1
R43/1502	LKD	200	204	52.2	2.2
R1/1503	LKD	200	945.7	100	4.4
R2/1503	BEDROOM	100	222.4	100	2
R3/1503	BEDROOM	100	635.6	100	4.5
R4/1503	BEDROOM	100	237.7	100	1.9
R5/1503	LKD	200	400.9	75.7	3.2
R6/1503	BEDROOM	100	228.4	100	2.1
R7/1503	LKD	200	619.3	100	4.7
R8/1503	BEDROOM	100	241.2	100	2.1
R9/1503	LKD	200	567.5	100	4.8
R10/1503	BEDROOM	100	178.8	89.5	1.7
R11/1503	BEDROOM	100	148.8	95	1.8
R12/1503	LKD	200	369.3	99.8	3.6
R13/1503	BEDROOM	100	204.2	100	1.9
R14/1503	BEDROOM	100	411.3	100	3.6
R15/1503	LKD	200	380.9	68.5	3.4
R16/1503	BEDROOM	100	183.8	100	1.9
R17/1503	BEDROOM	100	224.9	100	2.1
R18/1503	LKD	200	438.3	100	3.6
R19/1503	BEDROOM	100	203.5	99.1	2.1
R20/1503	BEDROOM	100	180.6	99.2	1.8
R21/1503	LKD	200	264.2	70.2	2.2
R22/1503	BEDROOM	100	162.5	97.7	1.8
R23/1503	LKD	200	369.7	72.8	2.8
R24/1503	LKD	200	353.3	88.1	2.7
R25/1503	BEDROOM	100	230	99.1	1.8
R26/1503	BEDROOM	100	340.6	100	2.8
R27/1503	BEDROOM	100	422.1	100	3.4
R28/1503	BEDROOM	100	238.4	99.1	1.9
R29/1503	LKD	200	412.3	98.9	3.2
R1/1504	LKD	200	447.9	75	4.5



BRE CBDM ANALYSIS

PROJECT GREGGS, PROJECT LOCATION
140722 CBDM

BRE CBDM ANALYSIS

R2/1504	BEDROOM	100	180.7	100	1.9
R3/1504	BEDROOM	100	228.4	100	2.1
R4/1504	LKD	200	514.3	100	4.7
R5/1504	BEDROOM	100	215.2	99.1	2.1
R6/1504	BEDROOM	100	190.7	100	1.9
R7/1504	LKD	200	324.1	72.1	3.1
R8/1504	LKD	200	543.7	100	4.6
R9/1504	BEDROOM	100	173.3	89	1.7
R10/1504	BEDROOM	100	393	100	2.6

Block G1-G4

R1/1510	BEDROOM	100	245	100	2.6
R2/1510	LKD	200	715.7	100	6.7
R3/1510	BEDROOM	100	318.6	100	3.1
R4/1510	LKD	200	786.6	100	6.6
R5/1510	BEDROOM	100	335.7	100	3.1
R6/1510	LKD	200	726.4	100	6.6
R7/1510	BEDROOM	100	340.2	100	3.1
R8/1510	LKD	200	743.5	100	6.6
R1/1511	BEDROOM	100	232.1	92.6	2
R2/1511	BEDROOM	100	239.8	94.8	2
R3/1511	BEDROOM	100	239	94.8	2
R4/1511	BEDROOM	100	238.1	94.1	2

Block E

R1/1520	BEDROOM	100	212	85.2	2.2
R2/1520	LKD	200	262.9	66.1	2.3
R3/1520	LKD	200	104.7	22.5	1.5
R4/1520	BEDROOM	100	114.1	55.9	1.3
R1/1521	LKD	200	286.7	73.5	2.6
R2/1521	LKD	200	239.4	85.3	2.3
R3/1521	BEDROOM	100	160.4	84.3	1.8
R4/1521	BEDROOM	100	174.9	97.7	1.7
R5/1521	BEDROOM	100	183.5	93.1	1.7
R6/1521	BEDROOM	100	158.4	89.5	1.7
R1/1522	LKD	200	360.6	80.9	3.6
R2/1522	LKD	200	291	91.6	3.3
R3/1522	BEDROOM	100	206.2	100	2
R4/1522	BEDROOM	100	220.6	100	1.9
R5/1522	BEDROOM	100	219.1	99.6	1.9



BRE CBDM ANALYSIS

PROJECT GREGGS, PROJECT LOCATION
140722 CBDM

BRE CBDM ANALYSIS

R6/1522	BEDROOM	100	191.3	99.1	1.9
---------	---------	-----	-------	------	-----

Block C21-C30

R13/1570	LKD	200	119.3	34	2.4
R14/1570	LKD	200	112	31.5	2.3
R15/1570	LKD	200	114.5	32.9	2.4
R16/1570	LKD	200	95.1	29.6	2.4
R17/1570	LD	150	116.7	41.5	2.4
R18/1570	LD	150	96.3	38.2	2.4
R19/1570	LD	150	120.4	42.9	2.4
R20/1570	LD	150	133.5	45.9	2.4
R21/1570	LD	150	139.5	47.2	2.3
R22/1570	LD	150	126.6	44.1	2.2
R25/1571	BEDROOM	100	282.1	88.1	2.8
R26/1571	BEDROOM	100	187.1	84.2	2.6
R27/1571	BEDROOM	100	225.1	85.7	2.6
R28/1571	BEDROOM	100	181.9	84.5	2.6
R29/1571	BEDROOM	100	233.2	85.7	2.6
R30/1571	BEDROOM	100	175.9	84.5	2.6
R31/1571	BEDROOM	100	232.3	86.7	2.6
R32/1571	BEDROOM	100	165.2	84.5	2.6
R33/1571	BEDROOM	100	240.7	87.6	2.7
R34/1571	BEDROOM	100	176.4	72.3	2.6
R35/1571	BEDROOM	100	235.7	100	2
R36/1571	BEDROOM	100	241.3	100	2
R37/1571	BEDROOM	100	261	100	2.2
R38/1571	BEDROOM	100	290.6	100	2.2
R39/1571	BEDROOM	100	300.1	100	2.2
R40/1571	BEDROOM	100	313.7	100	2.3
R41/1571	BEDROOM	100	331.4	100	2.4
R42/1571	BEDROOM	100	337.6	100	2.4
R43/1571	BEDROOM	100	343.4	100	2.4
R44/1571	BEDROOM	100	344	100	2.4
R13/1572	BEDROOM	100	126	68.1	1.7
R14/1572	BEDROOM	100	136.8	76.2	1.8
R15/1572	BEDROOM	100	130.4	74.8	1.8
R16/1572	BEDROOM	100	168.7	90.2	1.9
R17/1572	BEDROOM	100	162.5	81.2	1.9
R18/1572	BEDROOM	100	204.6	89	2
R19/1572	BEDROOM	100	176.6	83.7	2
R20/1572	BEDROOM	100	153.9	77.2	2



BRE CBDM ANALYSIS

PROJECT GREGGS, PROJECT LOCATION
140722 CBDM

BRE CBDM ANALYSIS

R21/1572	BEDROOM	100	173.6	83.8	2
R22/1572	BEDROOM	100	176.4	85.1	2

Block C13-C20

R7/1570	LKD	200	116	35.5	2.2
R8/1570	LKD	200	86.4	29.6	2.1
R9/1570	LD	150	88.7	37.2	2.1
R10/1570	LD	150	94.7	37.6	2.1
R11/1570	LD	150	93.8	38.1	2
R12/1570	LD	150	100.5	39.4	2.2
R11/1571	BEDROOM	100	178.3	76.8	2.2
R12/1571	BEDROOM	100	142.1	67.2	2.3
R13/1571	BEDROOM	100	388.2	100	2.6
R14/1571	BEDROOM	100	351.6	100	2.6
R17/1571	BEDROOM	100	160.1	74.6	2.3
R18/1571	BEDROOM	100	159.3	66.5	2.5
R19/1571	BEDROOM	100	208.2	80	2.4
R20/1571	BEDROOM	100	182.2	71.6	2.6
R21/1571	BEDROOM	100	332	100	2.4
R22/1571	BEDROOM	100	335.6	100	2.4
R23/1571	BEDROOM	100	335	100	2.4
R24/1571	BEDROOM	100	343.4	100	2.4
R5/1572	BEDROOM	100	179	81.3	2.1
R6/1572	BEDROOM	100	179	80.1	2
R9/1572	BEDROOM	100	201.8	84.6	2
R10/1572	BEDROOM	100	166.1	81.9	2
R11/1572	BEDROOM	100	160.6	79.9	2
R12/1572	BEDROOM	100	175.3	87.8	2
R3/1580	LKD	200	71.8	25.5	2.3
R4/1580	LKD	200	79.7	24.7	2.3
R5/1581	BEDROOM	100	160.2	66.2	2.4
R6/1581	BEDROOM	100	121.5	56.2	2.3
R7/1581	BEDROOM	100	344.3	100	2.4
R8/1581	BEDROOM	100	334	100	2.5
R3/1582	BEDROOM	100	246.1	90.6	1.6
R4/1582	BEDROOM	100	233.3	87.8	1.6

2 Gould Road

R1/650	LIVINGROOM	150	506.3	100	3.2
R2/650	DINING	150	226.8	67.9	1.2



BRE CBDM ANALYSIS

PROJECT GREGGS, PROJECT LOCATION
140722 CBDM

BRE CBDM ANALYSIS

R3/650	KITCHEN	200	102	20.1	1.4
R1/651	BEDROOM	100	174.5	89.5	2
R2/651	BEDROOM	100	308.8	100	3