

CONSTRUCTION BUILD-UP  
SECTION DETAIL SCALE 1:5

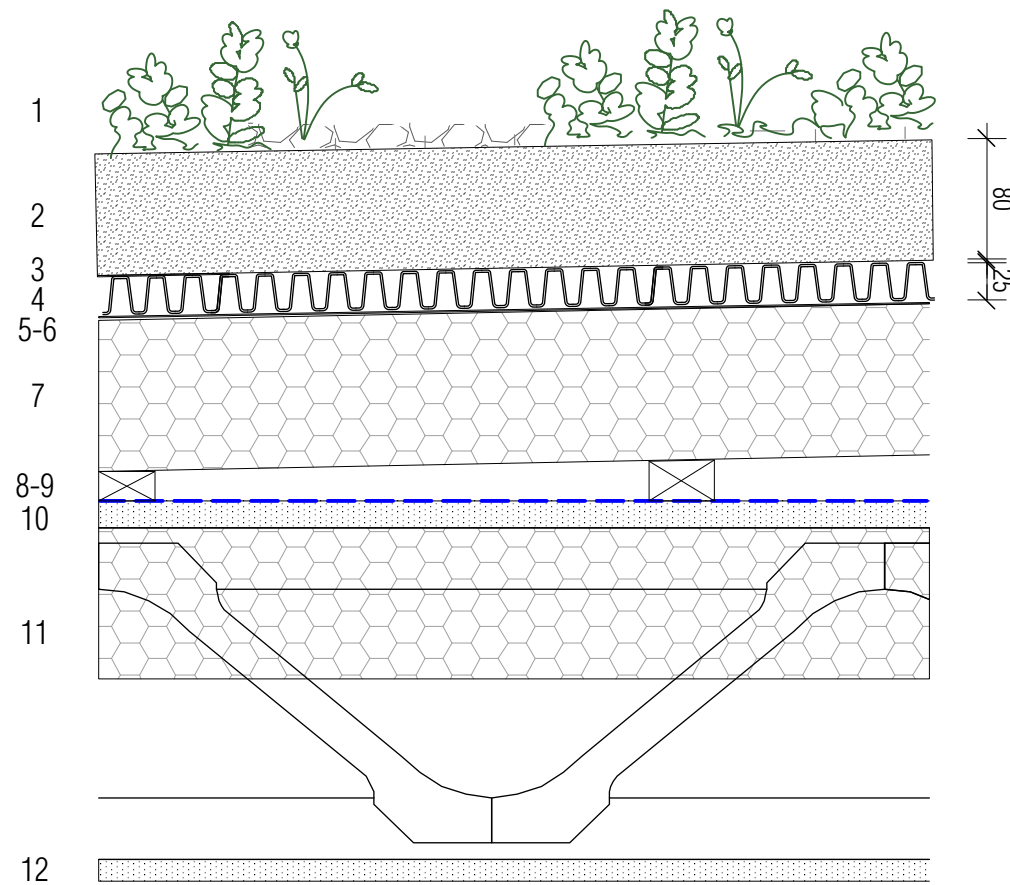

FLAT GREEN ROOF CONSTRUCTION BUILD-UP

U-VALUE = 0.11W/m<sup>2</sup>K

EVAGREEN ICB WATERPROOFING (OR SIMILAR APPROVED) GREEN ROOF SYSTEM:

1. GROWING MEDIUM (WILD FLOWERS, GRASSES, AND BARE AREAS GRAVEL)
2. 80MM BIODIVERSE SUBSTRATE
3. FL200 FILTER FLEECE (OR SIMILAR APPROVED)
4. 25MM DRAINAGE MAT
5. PL500 PROTECTION FLEECE (OR SIMILAR APPROVED)
6. SINGLE PLY MEMBRANE
7. 100MM CELOTEX GA4000 (100+90) (OR SIMILAR APPROVED)
8. TIMBER FIRRINGS LAID TO 1:60 FALLS (WIDTH VARIES)
9. PRO CLIMA INTELLO PLUS VAPOUR CONTROL LAYER (OR SIMILAR APPROVED)
10. 18MM PLYWOOD DECK
11. 219MM WS200 EASY-JOIST @ 400CTRS WITH 100MM CELOTEX GA4000 (OR SIMILAR APPROVED)
12. 12.5MM GYPSUM PLASTERBOARD + 3MM PAINT SKIM

The green roof proposes a good mixture of wildflower species with brown and gravel bare areas to promote new habitats and enhance biodiversity in the immediate context area.

Drainage outlets and inspection chambers cleared of vegetation (bare areas 500mm along perimeter of roof parapet and 250mm around rooflights).

Regular maintenance as recommended by ICB Waterproofing will be undertaken by experienced professionals who will carry out the necessary risk assessments and comply with all current health and safety legislation throughout the duration of the work.

EXAMPLE - NATIVE WILDFLOWER GREEN ROOF



- Levels of light, moisture, aeration and nutrients will be achieved with the selection and varied depth of the Extensive Biodiverse substrate (50-80mm)
- Localised habitat variation and free draining substrate on a drainage mat.
- Depth of substrate will secure good levels of moisture to ensure plug plants survival during dry periods.
- Regular maintenance will be executed twice per year to clear gutters, rainwater outlets and vegetation breaks; including removal of any unwanted debris (in autumn) or litter; replenishment of any areas of settled substrate.
- Once a year, strimming of the roof will be performed to keep species in check
- Applying organic slow release granular fertilizer in early spring; prevent the growth of unintentional vegetation or invasive species; replace any failed plants or dead flower heads.

TYPICAL SECTION  
SECTION DETAIL SCALE 1:50

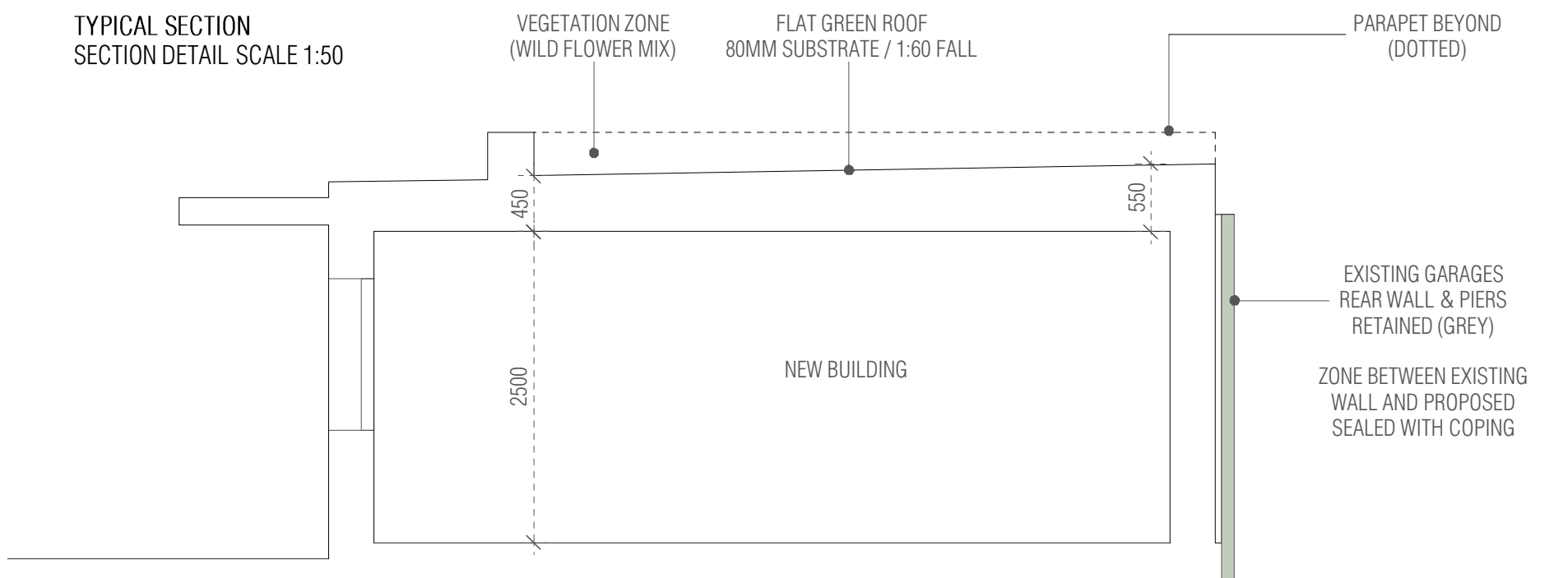

EXAMPLE - NATIVE WILDFLOWER MIX



PLANNING

Project ST MARY'S GROVE GARAGES, RICHMOND, TW9		
Drawing GREEN ROOF DETAIL & SPECIFICATION		
Drawing No. SMGG21-13	Scale 1:5 & 1:50 @ A3	Date 23.08.22

CLIVE CHAPMAN  
ARCHITECTS  
SUSTAINABILITY CONSULTANTS  
4 EEL PIE ISLAND  
TWICKENHAM MIDDX  
TW1 3DY  
TELEPHONE 020 8891 4837  
EMAIL INFO@CCAR.CO.UK  
WEBSITE WWW.CCAR.CO.UK