

2 PROPOSED GROUND FLOOR PLAN

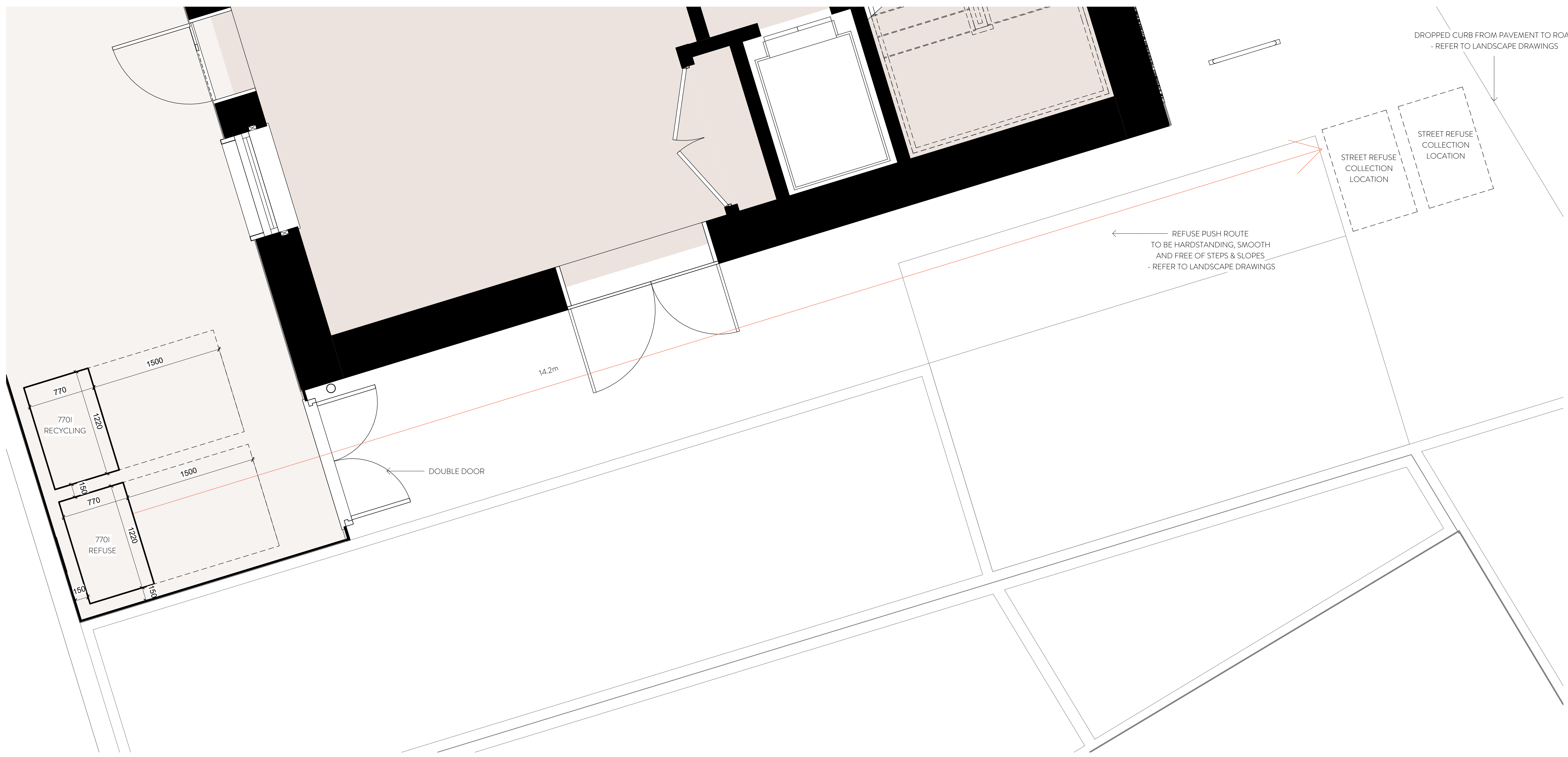

1 PROPOSED GROUND FLOOR REFUSE STORE PLAN

- DISCLAIMER:
1. This drawing is copyright and remains the property of Weston Rengfo Architects Practice
 2. This drawing is protected by copyright and is for use on this specific project site only.
 3. Do not scale from this drawing.
 4. This drawing is to be read in conjunction with all related drawings.
 5. The originator should be notified immediately of any discrepancy.
 6. All dimensions and Setting-out must be confirmed on site, prior to start fabrication and installation.
 7. This drawing is to be read in conjunction with M&E, Fire, Structural, Landscape information, drawings and specifications.
 8. Fire rating as per fire strategy.
 9. Refer to landscape drawings for further information on landscape strategy
 10. All existing drawings show indicative heights and measurements.
 11. Refer to BPTW's drawings for final residential masterplan

PROPOSED PLANS LEGEND

- - - - Denotes indicative proposed Ham Close site boundary

LBRuT Refuse and recycling storage requirements for commercial developments is suggested to be 2.6m³ for every 1,000m² gross floor space.

The Richmond MakerLabs has a gross floor space of 130m² so the required storage should be 2.6m³.

50% of this capacity should be retained for the storage of separated waste for recycling.

2 x 770l bins (1,220 (w) x 770 (l) x 1,360 (h)) would provide this 2.6m³ requirement.

The bins will be located in the enclosed outdoor space and brought to the street frontage on collection days.

rev	description	date	by	app'd by
P02	Refuse Store - Amended Configuration	10.08.22	AH	SW

ORIGINAL BY AH



Client
HILL RESIDENTIAL

Project
RICHMOND MAKERLABS

Drawing
PROPOSED GROUND FLOOR REFUSE STORE PLAN

Drawing number
WRAP - GA - A - 0190

Scale
As indicated

Project number
NO. 21017

Issue status
FOR PLANNING

WRAP	GA	A	0190	P02

This drawing is to be read in conjunction with all related drawings and specifications. Do not scale from this drawing. All dimensions must be checked and verified on site before commencing any work or producing construction/drawing. The originator should be notified immediately of any discrepancy. This drawing is copyright and remains the property of Weston Rengfo Architects Practice Limited.

