

## 05 Green Infrastructure Community Access

- + There are a number of community benefits to the proposal at Kneller Hall which are listed on the drawing on this page.
- + For more Information please refer to the community use agreement

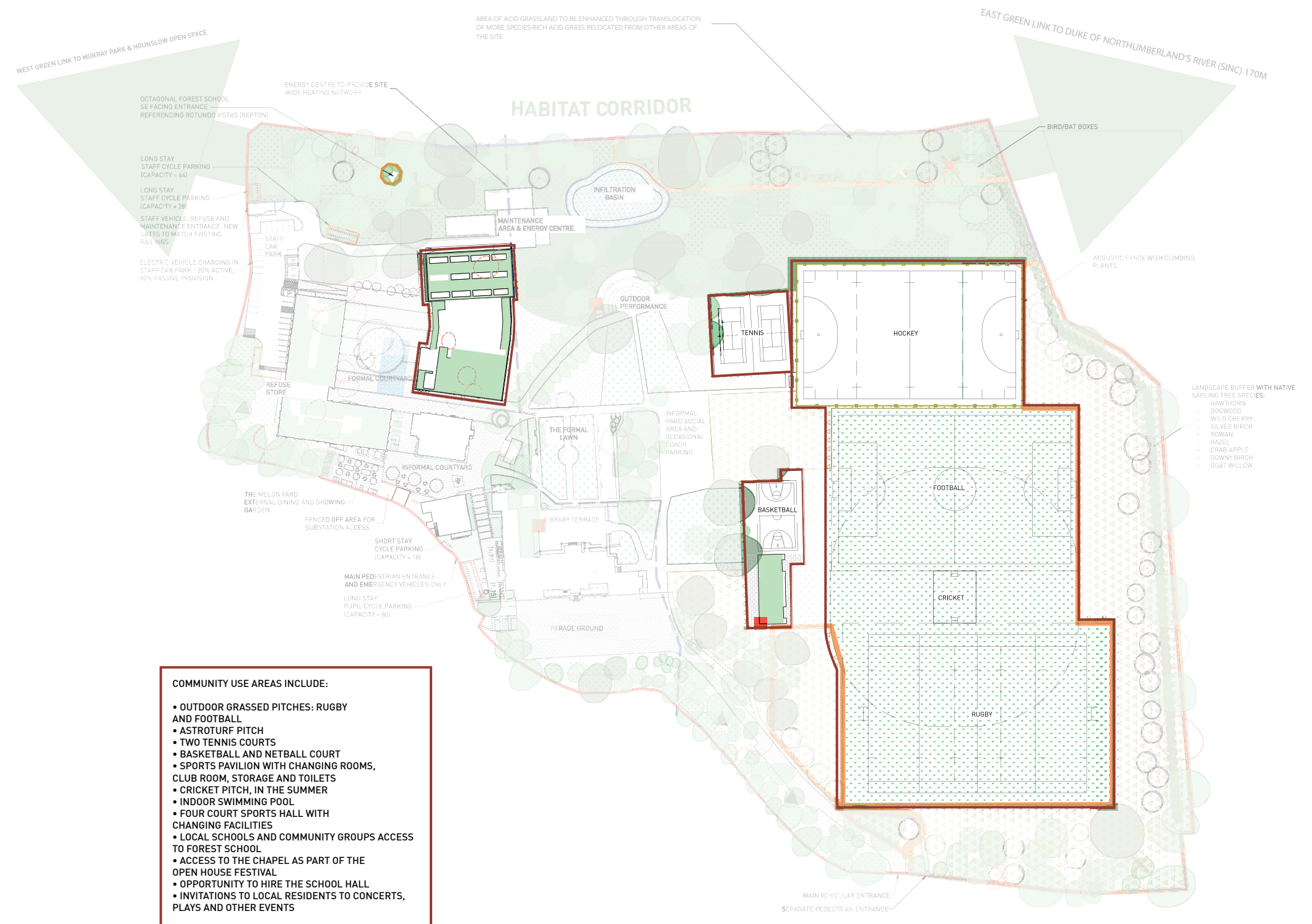

## 05 Green Infrastructure

### Management of Green Infrastructure

The entire site will be managed by the school, including those parts of the site that there will be managed community access to.

The Landscape Management Plan, will be implemented to ensure that the site is appropriately managed. Specialist advice will be obtained, where required, to ensure appropriate management of the site including:

- + SUDS Maintenance - see submitted Drainage and Foul Water Strategy prepared by AKS Ward
- + Ecology and Biodiversity Enhancement - see next section of this report and submitted Ecology Enhancement Plan prepared by RPS
- + Sports Pitches - advice from sports pitch consultant. See submitted Sports Provision Statement prepared by ADP

The hire charges for use of the facilities by local schools and community groups will go towards the ongoing management and upkeep of the facilities by the school. The school's maintenance team will ensure that the grassed pitches are not overused, so that they can be maintained to a good standard throughout the year.

For more information please refer to the landscape management plan that accompanies this application.



---

## 07 - Conclusion

---