



1 EAST ELEVATION
1 : 100

- A. Buff Brick - stretcher bond
- B. Buff Brick - soldier course
- C. Curtain Walling solid metal panel, RAL colour T.B.C
- D. Curtain Walling perforated metal panel, Pattern T.B.C, RAL colour T.B.C
- E. Curtain walling glazing
- F. Glazed window, frame RAL colour T.B.C
- G. Metal Louvres, RAL colour T.B.C
- H. Rainscreen clad wall, RAL colour T.B.C
- I. Glazed Door
- J. Door with metal Louvres, RAL colour T.B.C
- K. Pre-cast concrete banding
- L. Pre-cast concrete coping stone
- M. Recessed brickwork pattern
- N. Rainwater pipe, RAL colour T.B.C
- O. Solid Door, RAL colour T.B.C



2 WEST ELEVATION
1 : 100

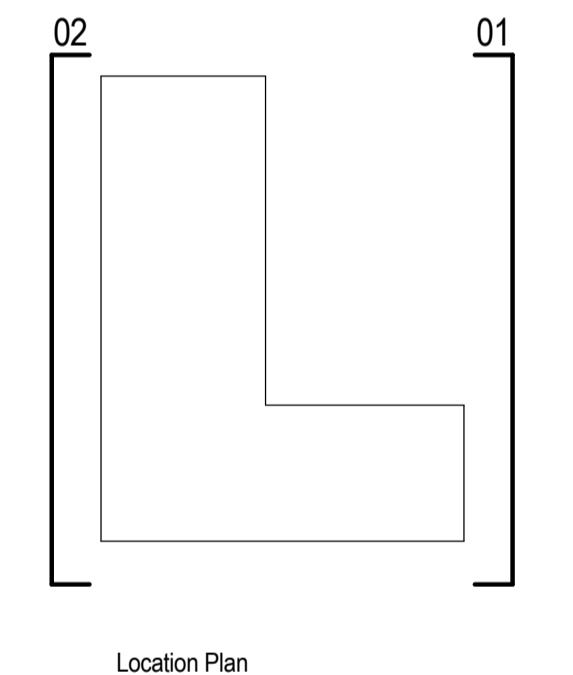

PLANNING

REVISION	DATE	DESCRIPTION	ARCHITECT	PARTNER
S2 P1	15.08.22	Design Freeze Issue	AB	ADP
S2 P2	05.09.22	Draft Planning Submission	AB	ADP
S2 P3	21.09.22	Planning Submission	AB	ADP

CHECK ALL DIMENSIONS AND VERIFY ON SITE. REPORT ANY ERRORS OR OMISSIONS

The Fire Station
 150 Waterloo Road
 London
 SE1 8SB
 T +44 (0) 20 7089 1720
 E london@adp-architecture.com
 www.adp-architecture.com

JOB TITLE:
**KNELLER HALL SCHOOL
TEACHING BUILDING**

DRAWING TITLE:
EAST & WEST ELEVATIONS

SCALE: 1 : 100	DRAWING SHEET SIZE: A1
JOB CODE: 001506	DRAWING NUMBER: ADP-04-XX-DR- A-1250
REVISION: S2 P3	