

EXTERNAL FABRIC REPAIRS WILL BE SUBMITTED AS A
 DEDICATED AND SEPARATE LISTED BUILDING APPLICATION

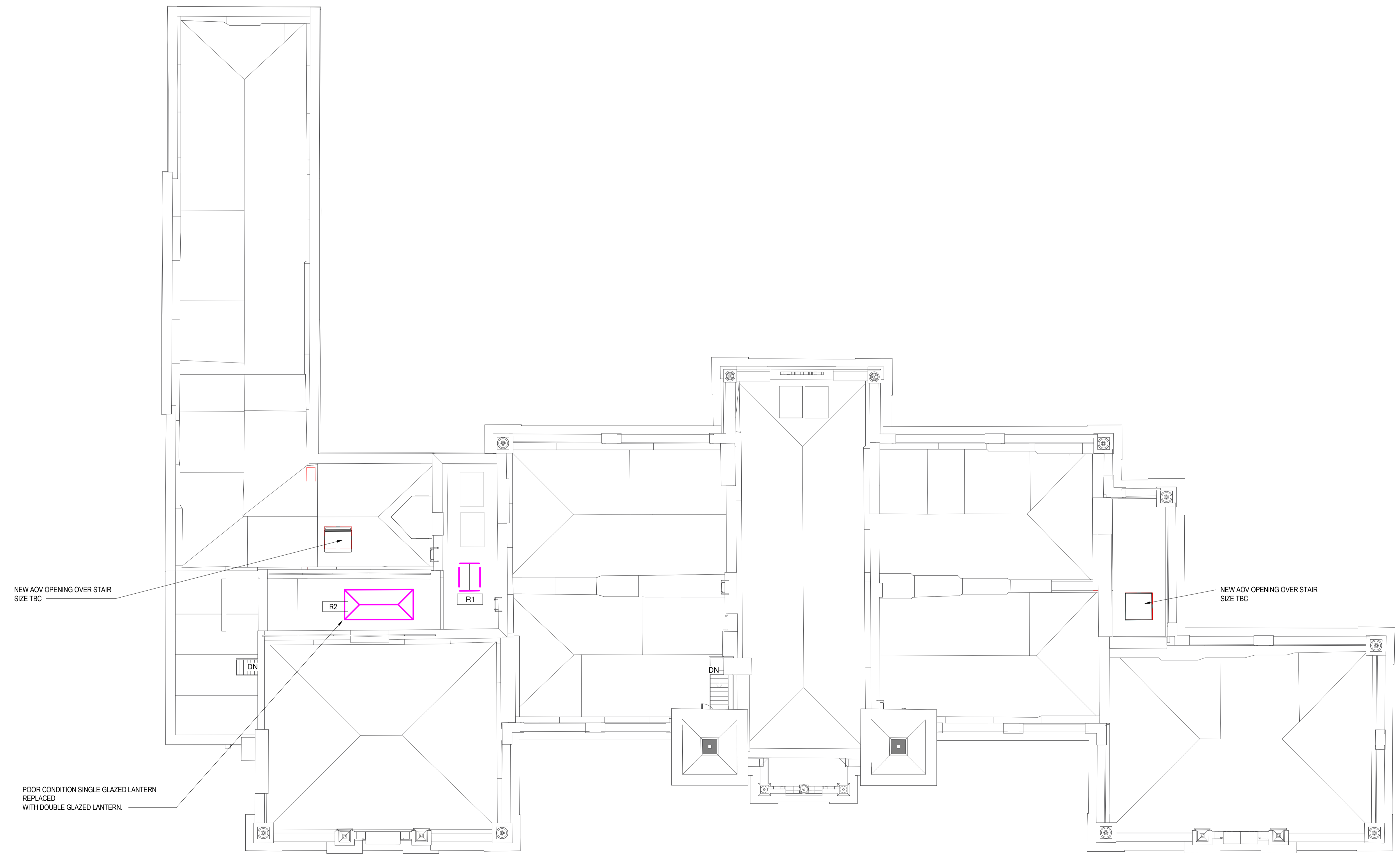

NEW AOV OPENING OVER STAIR
 SIZE TBC

NEW AOV OPENING OVER STAIR
 SIZE TBC

POOR CONDITION SINGLE GLAZED LANTERN
 REPLACED
 WITH DOUBLE GLAZED LANTERN.

KEY

- REFURBISH
- LEAF REPLACEMENT (HISTORIC)
- LEAF REPLACEMENT (CONTEMPORARY)
- DOOR REFURBISH (FIXED/LOCKED SHUT)
- REFURBISH WINDOW AND REMOVE SECONDARY GLAZING
- REFURBISH WINDOW AND REMOVE VENT
- OPEN UP
- BLOCK UP
- FLOOR LEVEL RAISED
- BOXING OUT FOR LTHW F&R PIPEWORK DROPPING FROM HL TO L/L

WALL TYPES

- EXISTING
- PROPOSED

PLANNING

REVISION	DATE	DESCRIPTION	ARCHITECT	PARTNER
S2 P 1	21.08.22	Planning Submission	NM	ADP

CHECK ALL DIMENSIONS AND VERIFY ON SITE. REPORT ANY ERRORS OR OMISSIONS

The Fire Station
 130 Waterloo Road
 London
 SE1 8SB
 T +44 (0) 20 7089 1720
 E london@adp-architecture.com
 www.adp-architecture.com

JOB TITLE:
KNELLER HALL

DRAWING TITLE:
LEVEL R1 - ALTERATIONS

SCALE: 1 : 100	DRAWING SHEET SIZE: A1
JOB CODE: 001506	DRAWING NUMBER: ADP-01-R1-DR- A-1025
REVISION: S2 P 1	