

WIDENING OF EXISTING OPENING FOR DUCT ENTRY

EXISTING OPENING FOR DUCT ENTRY
REMAINING OPENING TO BE BUILT IN BRICK TO MATCH EXISTING ELEVATION

AIR HANDLING UNIT

OPENABLE SECTIONS IN PLANT TO PROVIDE ACCESS TO AHU

EXISTING STAIR TO BASEMENT TO BE COVERED OVER
NO ACCESS

CEILING TO BUILT ABOVE WCS

CEILING TO BUILT ABOVE SHOWERWC

WALL TYPES

- EXISTING
- PROPOSED

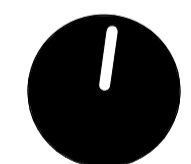
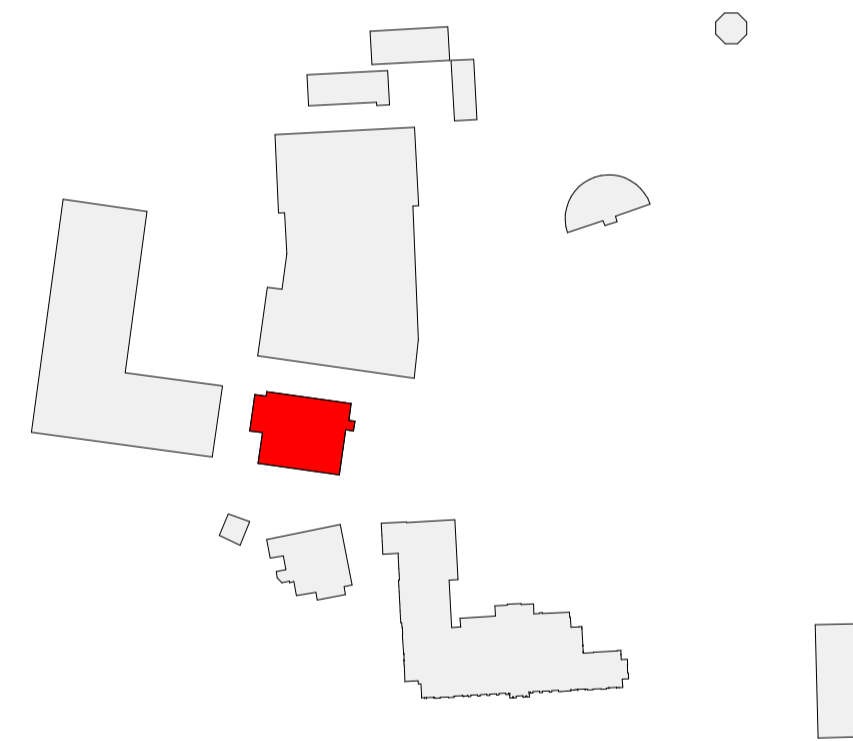
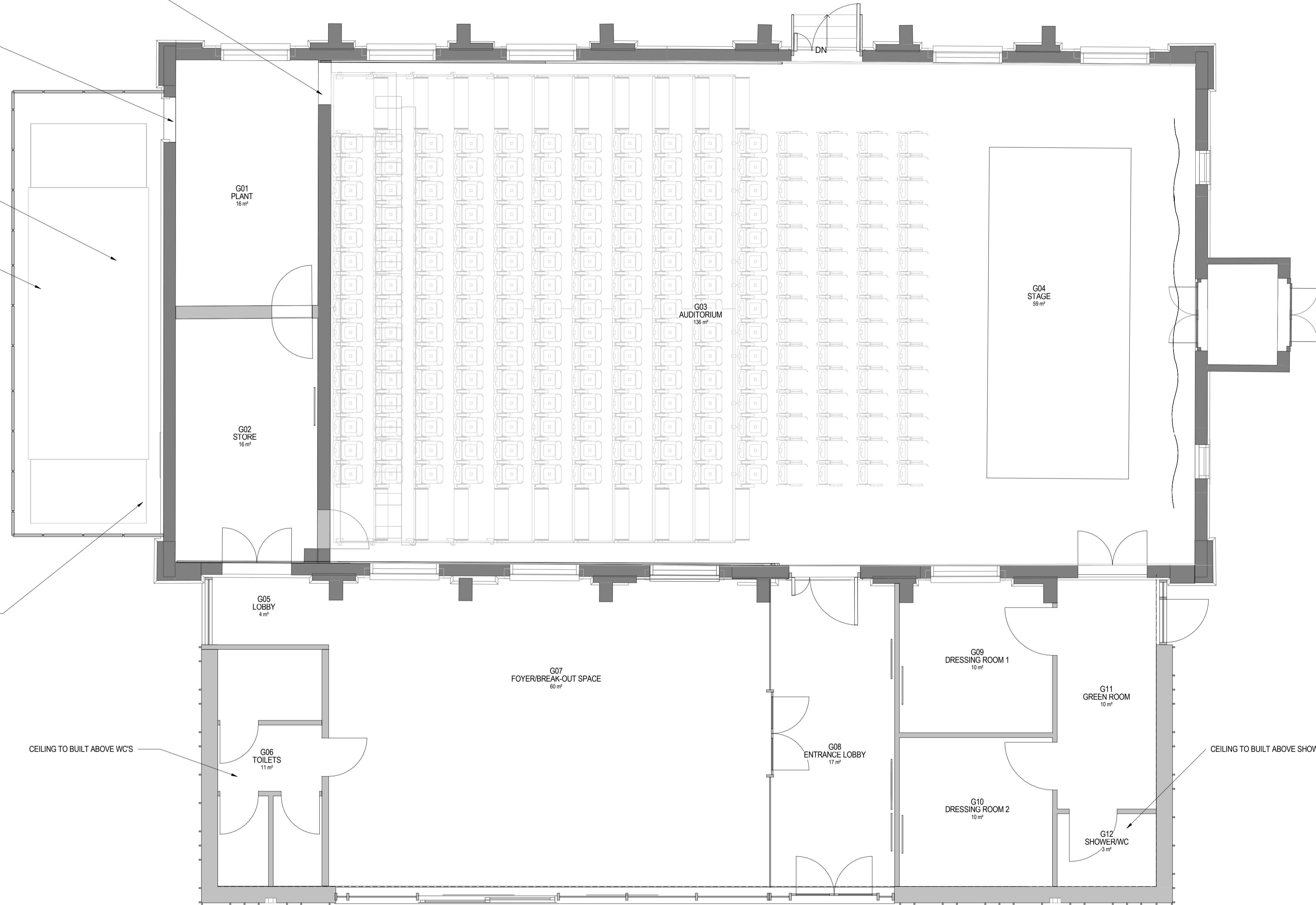

PLANNING

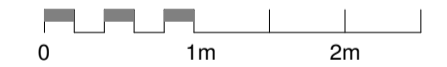

REVISION	DATE	DESCRIPTION	ARCHITECT	PARTNER
S2 P 1	07.06	Preliminary Issue For Information	NM	ADP
S2 P 2	27.07	Riser locations added	NM	ADP
S2 P 3	15.08	Design Freeze Issue	NM	ADP
S2 P 4	05.08	Draft Planning Submission	NM	ADP
S2 P 5	21.09.22	Planning Submission	NM	ADP

CHECK ALL DIMENSIONS AND VERIFY ON SITE. REPORT ANY ERRORS OR OMISSIONS

adp The Fire Station
130 Waterloo Road
London
SE1 8SB
T +44 (0) 20 7089 1720
E london@adp-architecture.com
www.adp-architecture.com

JOB TITLE:
**KNELLER HALL
SCHOOL HALL
(Former Band Practice Hall)**

DRAWING TITLE:
**GROUND FLOOR - PROPOSED
PLANNING**

SCALE: **As indicated** DRAWING SHEET SIZE: **A1**

JOB CODE: **001506** DRAWING NUMBER: **ADP-02-00-DR- A-1000** REVISION: **S2 P 5**

1 PROPOSED GROUND FLOOR - PLANNING

1 : 50