

X:\JOBS\8975_TWICKENHAM_RIVERSIDE\CA\DRAWINGS\8975_100.DWG

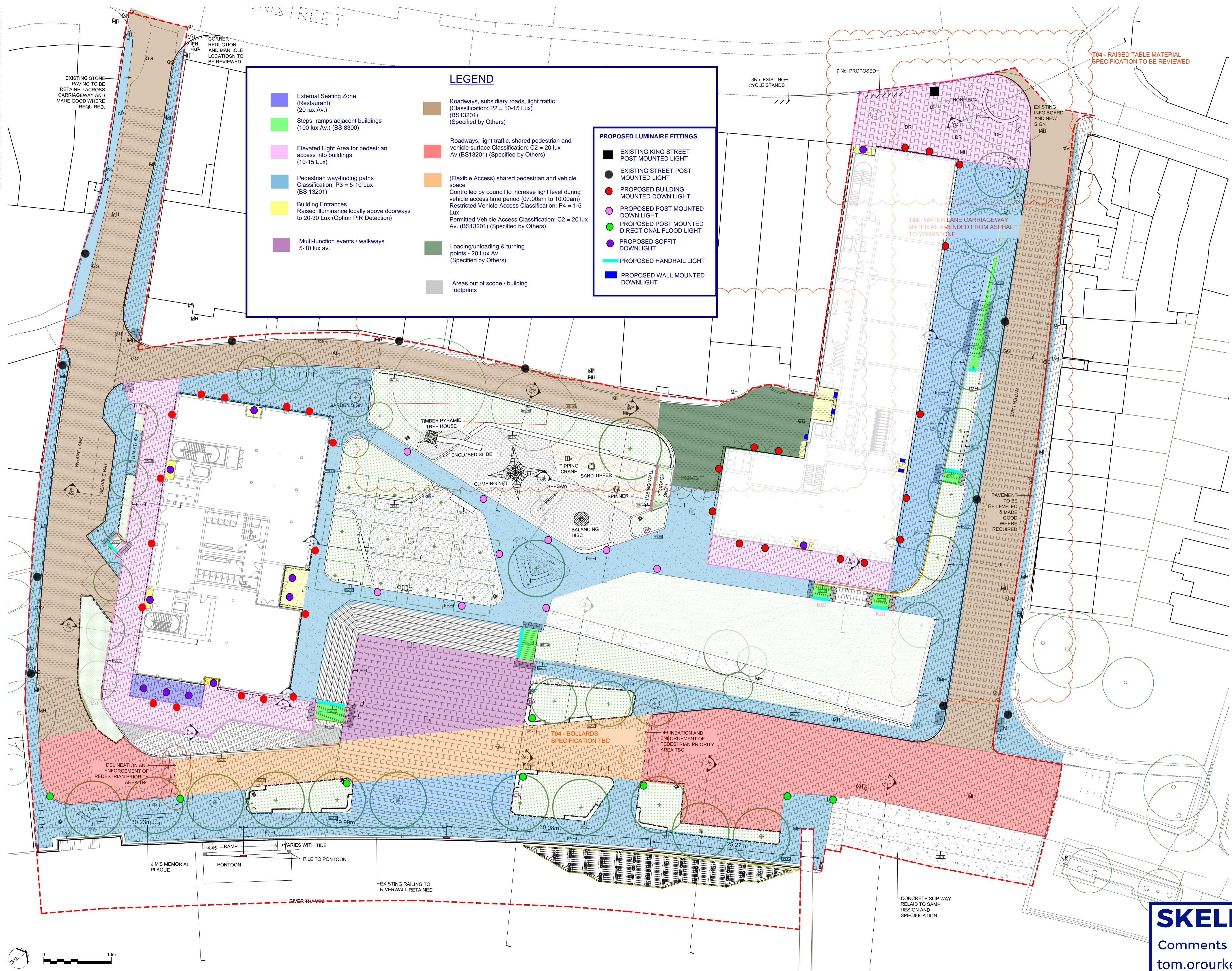

LEGEND

External Seating Zone (Restaurant) (20 lux Av.)	Roadways, subsidiary roads, light traffic (Classification: P2 = 10-15 Lux) (BS13201) (Specified by Others)
Steps, ramps adjacent buildings (100 lux Av.) (BS 8300)	Roadways, light traffic, shared pedestrian and vehicle surface Classification: C2 = 20 lux Av. (BS13201) (Specified by Others)
Elevated Light Area for pedestrian access into buildings (10-15 Lux)	(Flexible Access) shared pedestrian and vehicle space Controlled by council to increase light level during vehicle access time period (07:00am to 10:00am) Restricted Vehicle Access Classification: P4 = 1-5 Lux Permitted Vehicle Access Classification: C2 = 20 lux Av. (BS13201) (Specified by Others)
Pedestrian way-finding paths Classification: P3 = 5-10 Lux (BS 13201)	Loading/unloading & turning points - 20 Lux Av. (Specified by Others)
Building Entrances Raised illuminance locally above doorways to 20-30 Lux (Option PIR Detection)	Areas out of scope / building footprints
Multi-function events / walkways 5-10 lux av.	

PROPOSED LUMINAIRE FITTINGS

- EXISTING KING STREET POST MOUNTED LIGHT
- EXISTING STREET POST MOUNTED LIGHT
- PROPOSED BUILDING MOUNTED DOWN LIGHT
- PROPOSED POST MOUNTED DOWN LIGHT
- PROPOSED POST MOUNTED DIRECTIONAL FLOOD LIGHT
- PROPOSED SOFFIT DOWNLIGHT
- PROPOSED HANDRAIL LIGHT
- PROPOSED WALL MOUNTED DOWNLIGHT

T04 - RAISED TABLE MATERIAL SPECIFICATION TO BE REVIEWED

T04 - WATER LAKE CARRIAGEWAY MATERIAL AMENDED FROM ASPHALT TO YORKSTONE

READ THIS FIRST

Note for Contractors
This drawing should be considered along with the risk information contained in the CDM Pre Construction Information. This information will include details of the SIGNIFICANT risks which LDA Design has identified which may arise from constructing their designs shown on this drawing. A Competent Contractor should be aware of the typical risks associated with doing this work.

Note for Workers
DO NOT START YOUR WORK unless you know the Risks and Controls relating to the work on this drawing (including SAFE SEQUENCES OF WORK AND EQUIPMENT).

Do not issue copies of parts of this drawing without the above Note for Workers (unless you are sure that the Workers can undertake the work safely).

FOR INFORMATION

LDADesign

PROJECT TITLE
TWICKENHAM RIVERSIDE

DRAWING TITLE
General Arrangement Plan

ISSUED BY	London	T: 020 7467 1470	
DATE	JULY 2021	DRAWN	ER
SCALE	@A1 1:250	CHECKED	TW
STATUS	Tender	APPROVED	AH

SKELLY & COUCH

Comments
tom.orourke, 21/04/2022

