

The historical maps shown were reproduced from maps predominantly held at the scale adopted for England, Wales and Scotland in the 1840's. In 1854 the 1:2,500 scale was adopted for mapping urban areas; these maps were used to update the 1:10,560 maps. The published date given therefore is often some years later than the surveyed date. Before 1938, all OS maps were based on the Cassini Projection, with independent surveys of a single county or group of counties, giving rise to significant inaccuracies in outlying areas. In the late 1940's, a Provisional Edition was produced, which updated the 1:10,560 mapping from a number of sources. The maps appear unfinished - with all military camps and other strategic sites removed. These maps were initially overlaid with the National Grid. In 1970, the first 1:10,000 maps were produced using the Transverse Mercator Projection. The revision process continued until recently, with new editions appearing every 10 years or so for urban areas.

Map Name(s) and Date(s)

020SE	1920	1:10,560
025NE	1920	1:10,560

Historical Map - Slice A

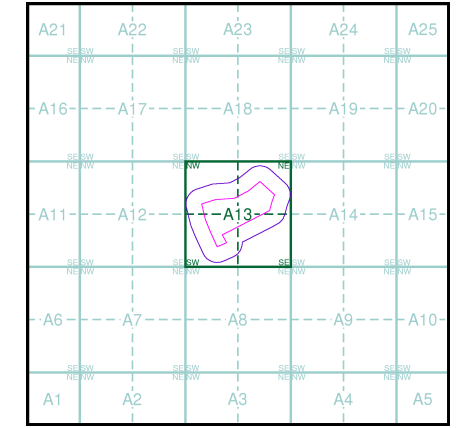

Order Details

Order Number: 300223772_1_1
 Customer Ref: 20295
 National Grid Reference: 516460, 172390
 Slice: A
 Site Area (Ha): 8.93
 Search Buffer (m): 1000

Site Details

Thames Young Mariners O E C, Ham Fields, RICHMOND, TW10 7RX



Middlesex
Published 1920
Source map scale - 1:10,560

The historical maps shown were reproduced from maps predominantly held at the scale adopted for England, Wales and Scotland in the 1840's. In 1854 the 1:2,500 scale was adopted for mapping urban areas; these maps were used to update the 1:10,560 maps. The published date given therefore is often some years later than the surveyed date. Before 1938, all OS maps were based on the Cassini Projection, with independent surveys of a single county or group of counties, giving rise to significant inaccuracies in outlying areas. In the late 1940's, a Provisional Edition was produced, which updated the 1:10,560 mapping from a number of sources. The maps appear unfinished - with all military camps and other strategic sites removed. These maps were initially overprinted with the National Grid. In 1970, the first 1:10,000 maps were produced using the Transverse Mercator Projection. The revision process continued until recently, with new editions appearing every 10 years or so for urban areas.

Map Name(s) and Date(s)

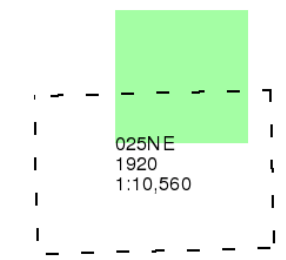

Historical Map - Slice A

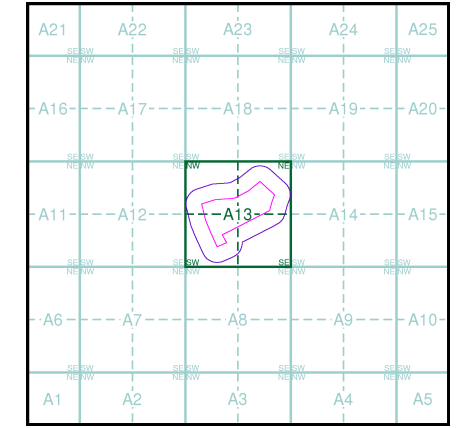

Order Details

Order Number: 300223772_1_1
Customer Ref: 20295
National Grid Reference: 516460, 172390
Slice: A
Site Area (Ha): 8.93
Search Buffer (m): 1000

Site Details

Thames Young Mariners O E C, Ham Fields, RICHMOND, TW10 7RX



Surrey
Published 1920
Source map scale - 1:10,560

The historical maps shown were reproduced from maps predominantly held at the scale adopted for England, Wales and Scotland in the 1840's. In 1854 the 1:2,500 scale was adopted for mapping urban areas; these maps were used to update the 1:10,560 maps. The published date given therefore is often some years later than the surveyed date. Before 1938, all OS maps were based on the Cassini Projection, with independent surveys of a single county or group of counties, giving rise to significant inaccuracies in outlying areas. In the late 1940's, a Provisional Edition was produced, which updated the 1:10,560 mapping from a number of sources. The maps appear unfinished - with all military camps and other strategic sites removed. These maps were initially overlaid with the National Grid. In 1970, the first 1:10,000 maps were produced using the Transverse Mercator Projection. The revision process continued until recently, with new editions appearing every 10 years or so for urban areas.

Map Name(s) and Date(s)

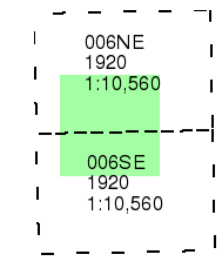

Historical Map - Slice A

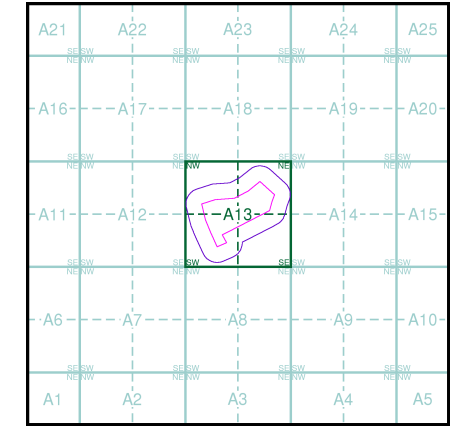

Order Details

Order Number: 300223772_1_1
 Customer Ref: 20295
 National Grid Reference: 516460, 172390
 Slice: A
 Site Area (Ha): 8.93
 Search Buffer (m): 1000

Site Details

Thames Young Mariners O E C, Ham Fields, RICHMOND, TW10 7RX



Tel: 0844 844 9952
 Fax: 0844 844 9951
 Web: www.envirocheck.co.uk

515200 515400 515600 515800 516000 516200 516400 516600 516800 517000 517200 517400 517600 517800



Surrey

Published 1920

Source map scale - 1:10,560

The historical maps shown were reproduced from maps predominantly held at the scale adopted for England, Wales and Scotland in the 1840's. In 1854 the 1:2,500 scale was adopted for mapping urban areas; these maps were used to update the 1:10,560 maps. The published date given therefore is often some years later than the surveyed date. Before 1938, all OS maps were based on the Cassini Projection, with independent surveys of a single county or group of counties, giving rise to significant inaccuracies in outlying areas. In the late 1940's, a Provisional Edition was produced, which updated the 1:10,560 mapping from a number of sources. The maps appear unfinished - with all military camps and other strategic sites removed. These maps were initially overprinted with the National Grid. In 1970, the first 1:10,000 maps were produced using the Transverse Mercator Projection. The revision process continued until recently, with new editions appearing every 10 years or so for urban areas.

Map Name(s) and Date(s)

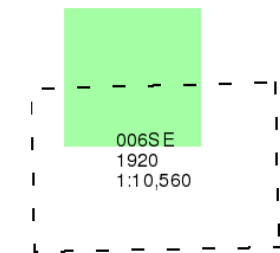

Historical Map - Slice A

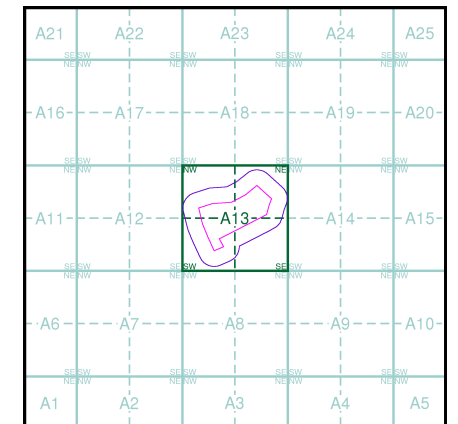

Order Details

Order Number: 300223772_1_1
Customer Ref: 20295
National Grid Reference: 516460, 172390
Slice: A
Site Area (Ha): 8.93
Search Buffer (m): 1000

Site Details

Thames Young Mariners O E C, Ham Fields, RICHMOND, TW10 7RX



Tel: 0844 844 9952
Fax: 0844 844 9951
Web: www.envirocheck.co.uk





The historical maps shown were reproduced from maps predominantly held at the scale adopted for England, Wales and Scotland in the 1840's. In 1854 the 1:2,500 scale was adopted for mapping urban areas; these maps were used to update the 1:10,560 maps. The published date given therefore is often some years later than the surveyed date. Before 1938, all OS maps were based on the Cassini Projection, with independent surveys of a single county or group of counties, giving rise to significant inaccuracies in outlying areas. In the late 1940's, a Provisional Edition was produced, which updated the 1:10,560 mapping from a number of sources. The maps appear unfinished - with all military camps and other strategic sites removed. These maps were initially overprinted with the National Grid. In 1970, the first 1:10,000 maps were produced using the Transverse Mercator Projection. The revision process continued until recently, with new editions appearing every 10 years or so for urban areas.

Map Name(s) and Date(s)

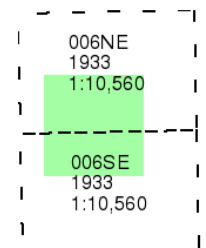

Historical Map - Slice A

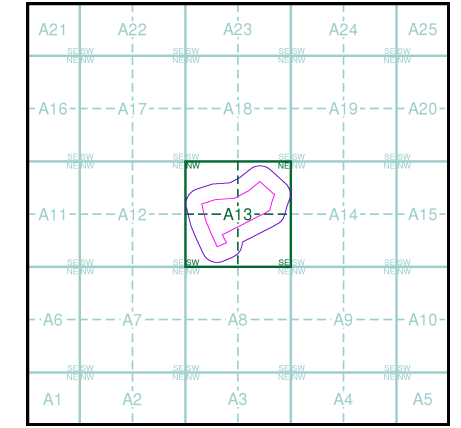

Order Details

Order Number: 30023772_1_1
 Customer Ref: 20295
 National Grid Reference: 516460, 172390
 Slice: A
 Site Area (Ha): 8.93
 Search Buffer (m): 1000

Site Details

Thames Young Mariners O E C, Ham Fields, RICHMOND, TW10 7RX



Middlesex

Published 1934 - 1935

Source map scale - 1:10,560

The historical maps shown were reproduced from maps predominantly held at the scale adopted for England, Wales and Scotland in the 1840's. In 1854 the 1:2,500 scale was adopted for mapping urban areas; these maps were used to update the 1:10,560 maps. The published date given therefore is often some years later than the surveyed date. Before 1938, all OS maps were based on the Cassini Projection, with independent surveys of a single county or group of counties, giving rise to significant inaccuracies in outlying areas. In the late 1940's, a Provisional Edition was produced, which updated the 1:10,560 mapping from a number of sources. The maps appear unfinished - with all military camps and other strategic sites removed. These maps were initially overprinted with the National Grid. In 1970, the first 1:10,000 maps were produced using the Transverse Mercator Projection. The revision process continued until recently, with new editions appearing every 10 years or so for urban areas.

Map Name(s) and Date(s)

020SE	1935	1:10,560
025NE	1934	1:10,560

Historical Map - Slice A

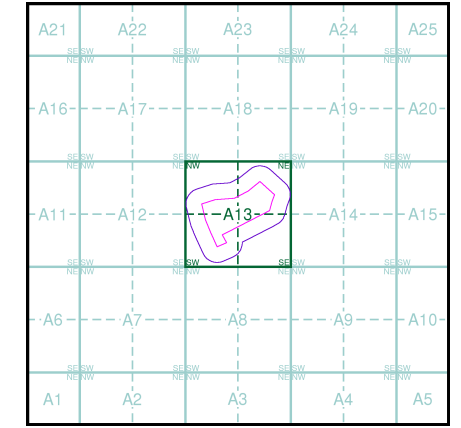

Order Details

Order Number: 30023772_1_1
 Customer Ref: 20295
 National Grid Reference: 516460, 172390
 Slice: A
 Site Area (Ha): 8.93
 Search Buffer (m): 1000

Site Details

Thames Young Mariners O E C, Ham Fields, RICHMOND, TW10 7RX



Tel: 0844 844 9952
 Fax: 0844 844 9951
 Web: www.envirocheck.co.uk



Middlesex
Published 1938
Source map scale - 1:10,560

The historical maps shown were reproduced from maps predominantly held at the scale adopted for England, Wales and Scotland in the 1840's. In 1854 the 1:2,500 scale was adopted for mapping urban areas; these maps were used to update the 1:10,560 maps. The published date given therefore is often some years later than the surveyed date. Before 1938, all OS maps were based on the Cassini Projection, with independent surveys of a single county or group of counties, giving rise to significant inaccuracies in outlying areas. In the late 1940's, a Provisional Edition was produced, which updated the 1:10,560 mapping from a number of sources. The maps appear unfinished - with all military camps and other strategic sites removed. These maps were initially overlaid with the National Grid. In 1970, the first 1:10,000 maps were produced using the Transverse Mercator Projection. The revision process continued until recently, with new editions appearing every 10 years or so for urban areas.

Map Name(s) and Date(s)

020SE	1938
1:10,560	
025NE	1938
1:10,560	

Historical Map - Slice A

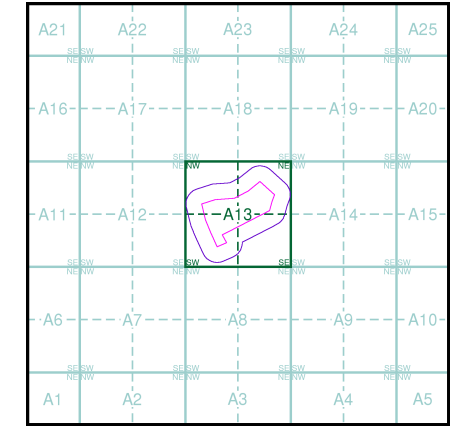

Order Details
 Order Number: 300223772_1_1
 Customer Ref: 20295
 National Grid Reference: 516460, 172390
 Slice: A
 Site Area (Ha): 8.93
 Search Buffer (m): 1000

Site Details
 Thames Young Mariners O E C, Ham Fields, RICHMOND, TW10 7RX



soils
LIMITED
Geotechnical & Environmental
Consultants

Surrey
Published 1938
Source map scale - 1:10,560

The historical maps shown were reproduced from maps predominantly held at the scale adopted for England, Wales and Scotland in the 1840's. In 1854 the 1:2,500 scale was adopted for mapping urban areas; these maps were used to update the 1:10,560 maps. The published date given therefore is often some years later than the surveyed date. Before 1938, all OS maps were based on the Cassini Projection, with independent surveys of a single county or group of counties, giving rise to significant inaccuracies in outlying areas. In the late 1940's, a Provisional Edition was produced, which updated the 1:10,560 mapping from a number of sources. The maps appear unfinished - with all military camps and other strategic sites removed. These maps were initially overprinted with the National Grid. In 1970, the first 1:10,000 maps were produced using the Transverse Mercator Projection. The revision process continued until recently, with new editions appearing every 10 years or so for urban areas.

Map Name(s) and Date(s)

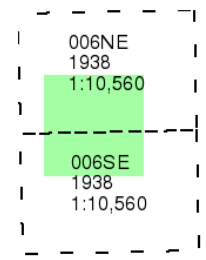

Historical Map - Slice A

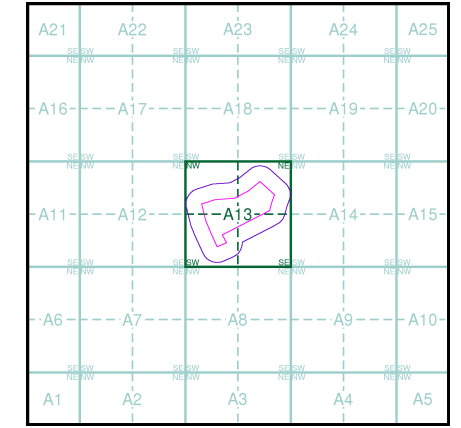

Order Details
Order Number: 300223772_1_1
Customer Ref: 20295
National Grid Reference: 516460, 172390
Slice: A
Site Area (Ha): 8.93
Search Buffer (m): 1000

Site Details
Thames Young Mariners O E C, Ham Fields, RICHMOND, TW10 7RX

Landmark
INFORMATION GROUP
Tel: 0844 844 9952
Fax: 0844 844 9951
Web: www.envirocheck.co.uk



Surrey
Published 1938
Source map scale - 1:10,560

The historical maps shown were reproduced from maps predominantly held at the scale adopted for England, Wales and Scotland in the 1840's. In 1854 the 1:2,500 scale was adopted for mapping urban areas; these maps were used to update the 1:10,560 maps. The published date given therefore is often some years later than the surveyed date. Before 1938, all OS maps were based on the Cassini Projection, with independent surveys of a single county or group of counties, giving rise to significant inaccuracies in outlying areas. In the late 1940's, a Provisional Edition was produced, which updated the 1:10,560 mapping from a number of sources. The maps appear unfinished - with all military camps and other strategic sites removed. These maps were initially overprinted with the National Grid. In 1970, the first 1:10,000 maps were produced using the Transverse Mercator Projection. The revision process continued until recently, with new editions appearing every 10 years or so for urban areas.

Map Name(s) and Date(s)

006NE	1938
1:10,560	
006SE	1938
1:10,560	

Historical Map - Slice A

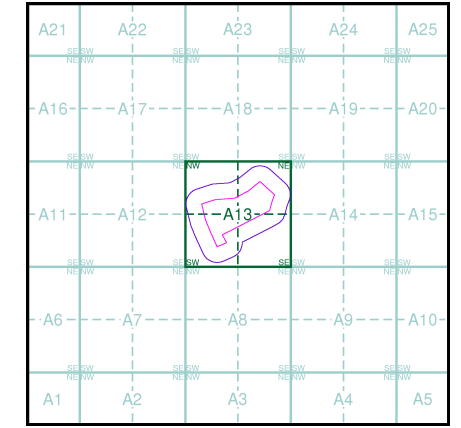

Order Details

Order Number: 300223772_1_1
 Customer Ref: 20295
 National Grid Reference: 516460, 172390
 Slice: A
 Site Area (Ha): 8.93
 Search Buffer (m): 1000

Site Details

Thames Young Mariners O E C, Ham Fields, RICHMOND, TW10 7RX



Ordnance Survey Plan
Published 1940
Source map scale - 1:10,000

The historical maps shown were reproduced from maps predominantly held at the scale adopted for England, Wales and Scotland in the 1840's. In 1854 the 1:2,500 scale was adopted for mapping urban areas; these maps were used to update the 1:10,560 maps. The published date given therefore is often some years later than the surveyed date. Before 1938, all OS maps were based on the Cassini Projection, with independent surveys of a single county or group of counties, giving rise to significant inaccuracies in outlying areas. In the late 1940's, a Provisional Edition was produced, which updated the 1:10,560 mapping from a number of sources. The maps appear unfinished - with all military camps and other strategic sites removed. These maps were initially overprinted with the National Grid. In 1970, the first 1:10,000 maps were produced using the Transverse Mercator Projection. The revision process continued until recently, with new editions appearing every 10 years or so for urban areas.

Map Name(s) and Date(s)

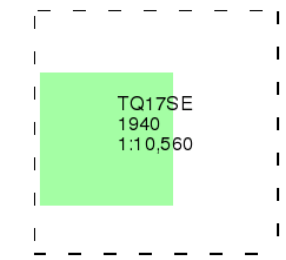

Historical Map - Slice A

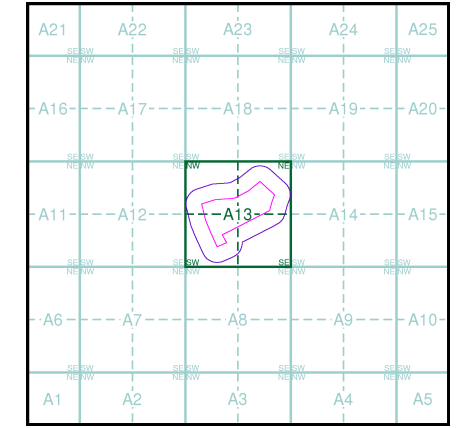

Order Details

Order Number: 300223772_1_1
 Customer Ref: 20295
 National Grid Reference: 516460, 172390
 Slice: A
 Site Area (Ha): 8.93
 Search Buffer (m): 1000

Site Details

Thames Young Mariners O E C, Ham Fields, RICHMOND, TW10 7RX



Tel: 0844 844 9952
 Fax: 0844 844 9951
 Web: www.envirocheck.co.uk

515200 515400 515600 515800 516000 516200 516400 516600 516800 517000 517200 517400 517600 517800

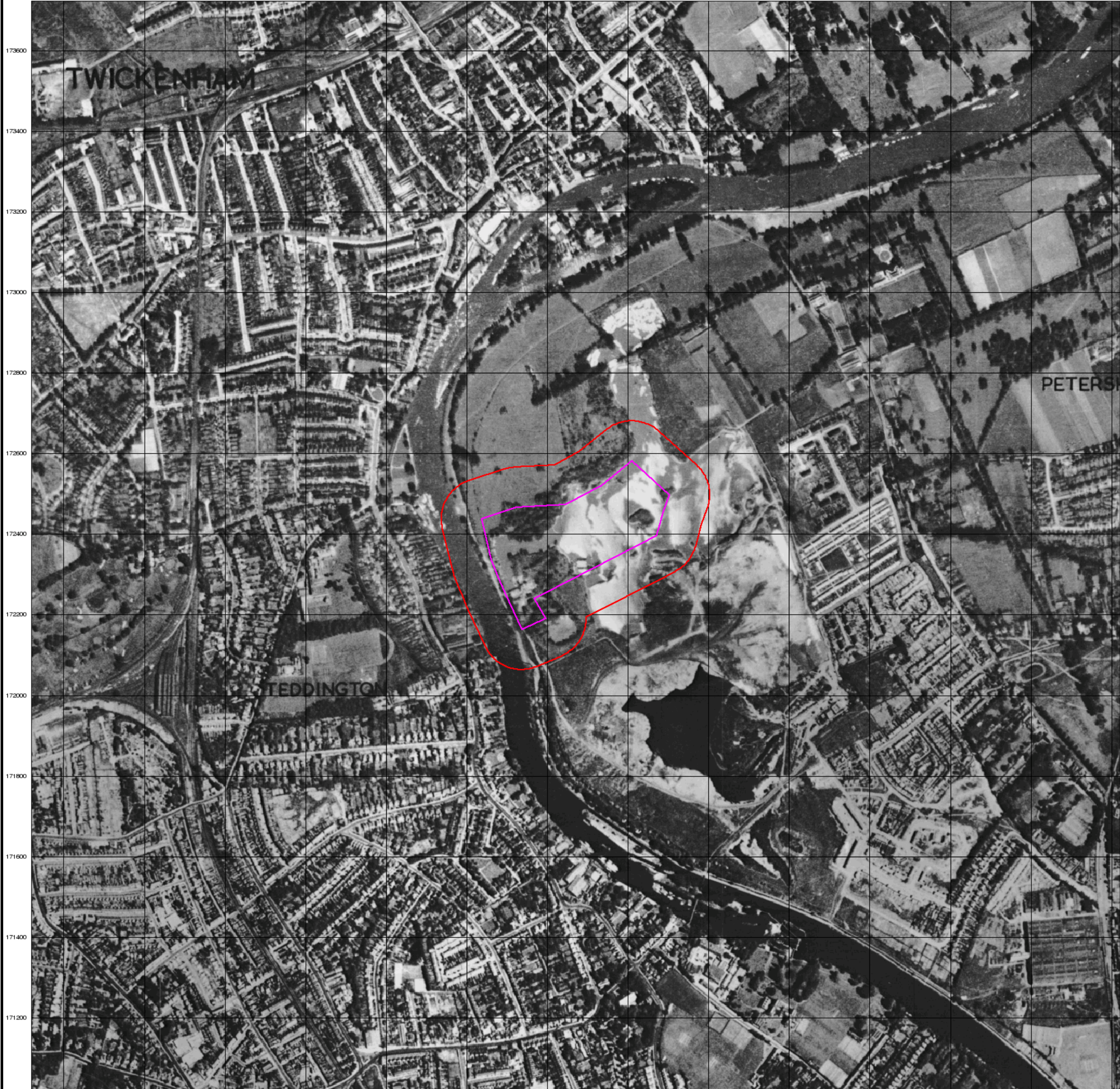

Historical Aerial Photography

Published 1948

Source map scale - 1:10,560

The Historical Aerial Photos were produced by the Ordnance Survey at a scale of 1:1,250 and 1:10,560 from Air Force photography. They were produced between 1944 and 1951 as an interim measure, pending preparation of conventional mapping, due to post war resource shortages. New security measures in the 1950's meant that every photograph was re-checked for potentially unsafe information with security sites replaced by fake fields or clouds. The original editions were withdrawn and only later made available after a period of fifty years although due to the accuracy of the editing, without viewing both revisions it is not easy to spot the edits. Where available Landmark have included both revisions.

© Landmark Information Group and/or Data Suppliers 2010.

Map Name(s) and Date(s)

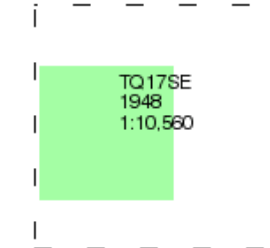

Historical Aerial Photography - Slice A

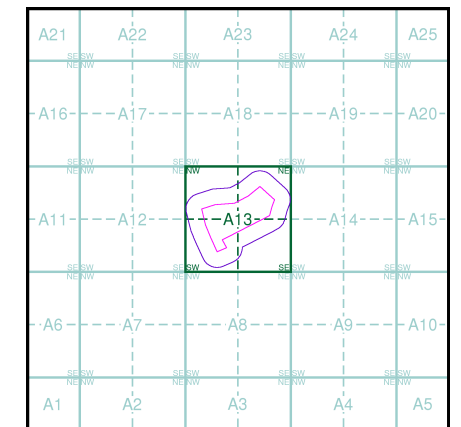

Order Details

Order Number: 300223772_1_1
 Customer Ref: 20295
 National Grid Reference: 516460, 172390
 Slice: A
 Site Area (Ha): 8.93
 Search Buffer (m): 1000

Site Details

Thames Young Mariners O E C, Ham Fields, RICHMOND, TW10 7RX



Tel: 0844 844 9952
 Fax: 0844 844 9951
 Web: www.envirocheck.co.uk

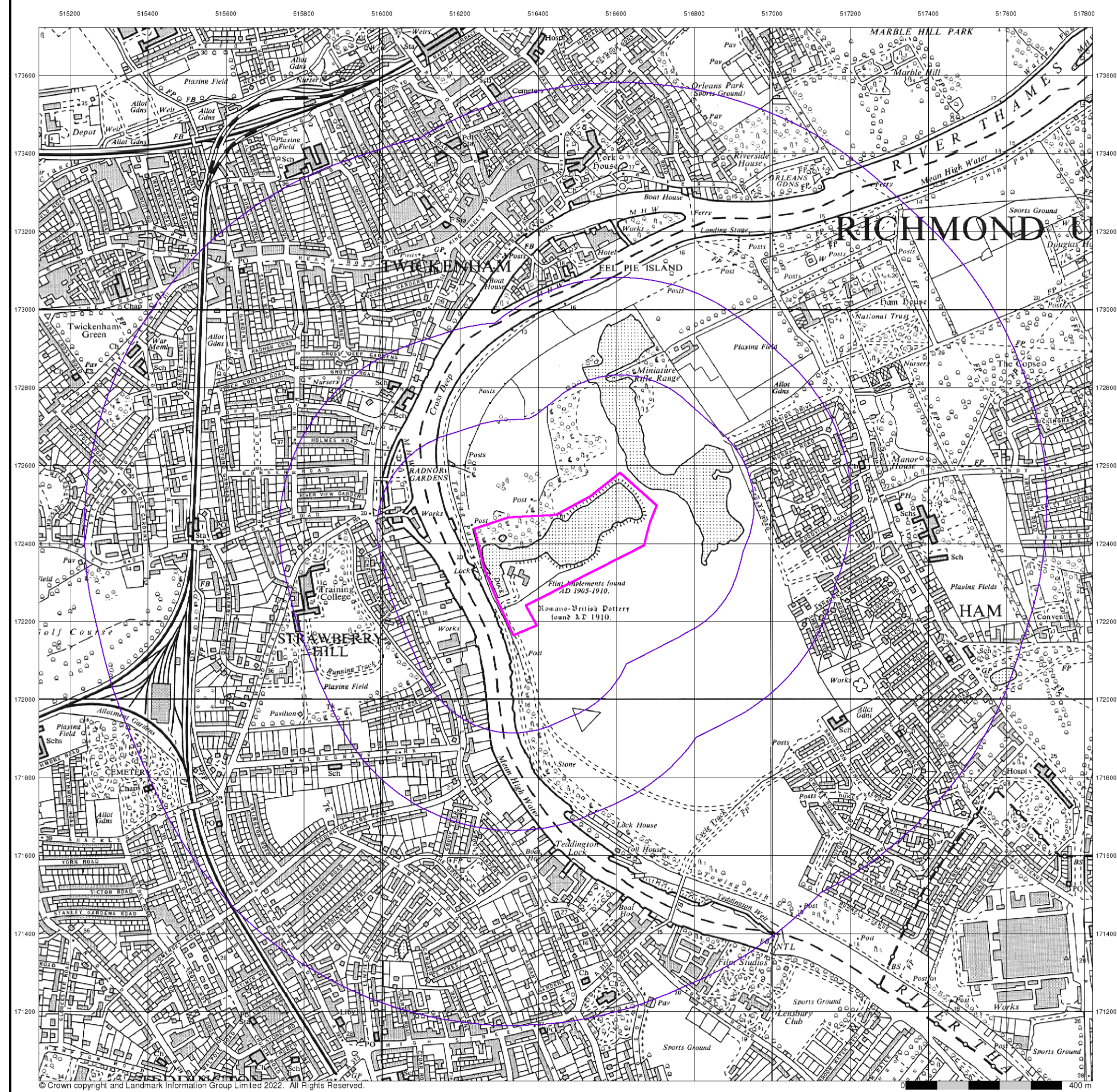

© Crown copyright and Landmark Information Group Limited 2022. All Rights Reserved.



Ordnance Survey Plan
Published 1966
Source map scale - 1:10,000

The historical maps shown were reproduced from maps predominantly held at the scale adopted for England, Wales and Scotland in the 1840's. In 1854 the 1:2,500 scale was adopted for mapping urban areas; these maps were used to update the 1:10,560 maps. The published date given therefore is often some years later than the surveyed date. Before 1938, all OS maps were based on the Cassini Projection, with independent surveys of a single county or group of counties, giving rise to significant inaccuracies in outlying areas. In the late 1940's, a Provisional Edition was produced, which updated the 1:10,560 mapping from a number of sources. The maps appear unfinished - with all military camps and other strategic sites removed. These maps were initially overprinted with the National Grid. In 1970, the first 1:10,000 maps were produced using the Transverse Mercator Projection. The revision process continued until recently, with new editions appearing every 10 years or so for urban areas.

Map Name(s) and Date(s)

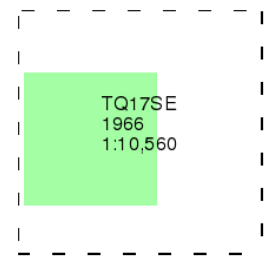

Historical Map - Slice A

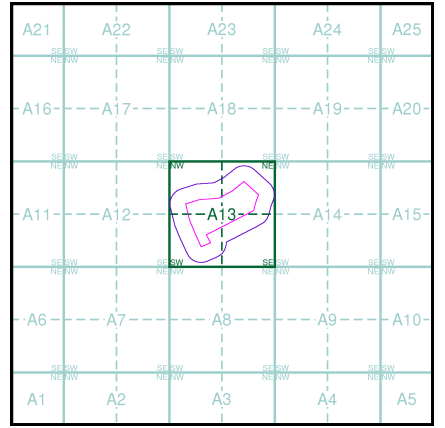

Order Details

Order Number: 300223772_1_1
 Customer Ref: 20295
 National Grid Reference: 516460, 172390
 Slice: A
 Site Area (Ha): 8.93
 Search Buffer (m): 1000

Site Details

Thames Young Mariners O E C, Ham Fields, RICHMOND, TW10 7RX



Tel: 0844 844 9952
 Fax: 0844 844 9951
 Web: www.envirocheck.co.uk