

HEATH RD

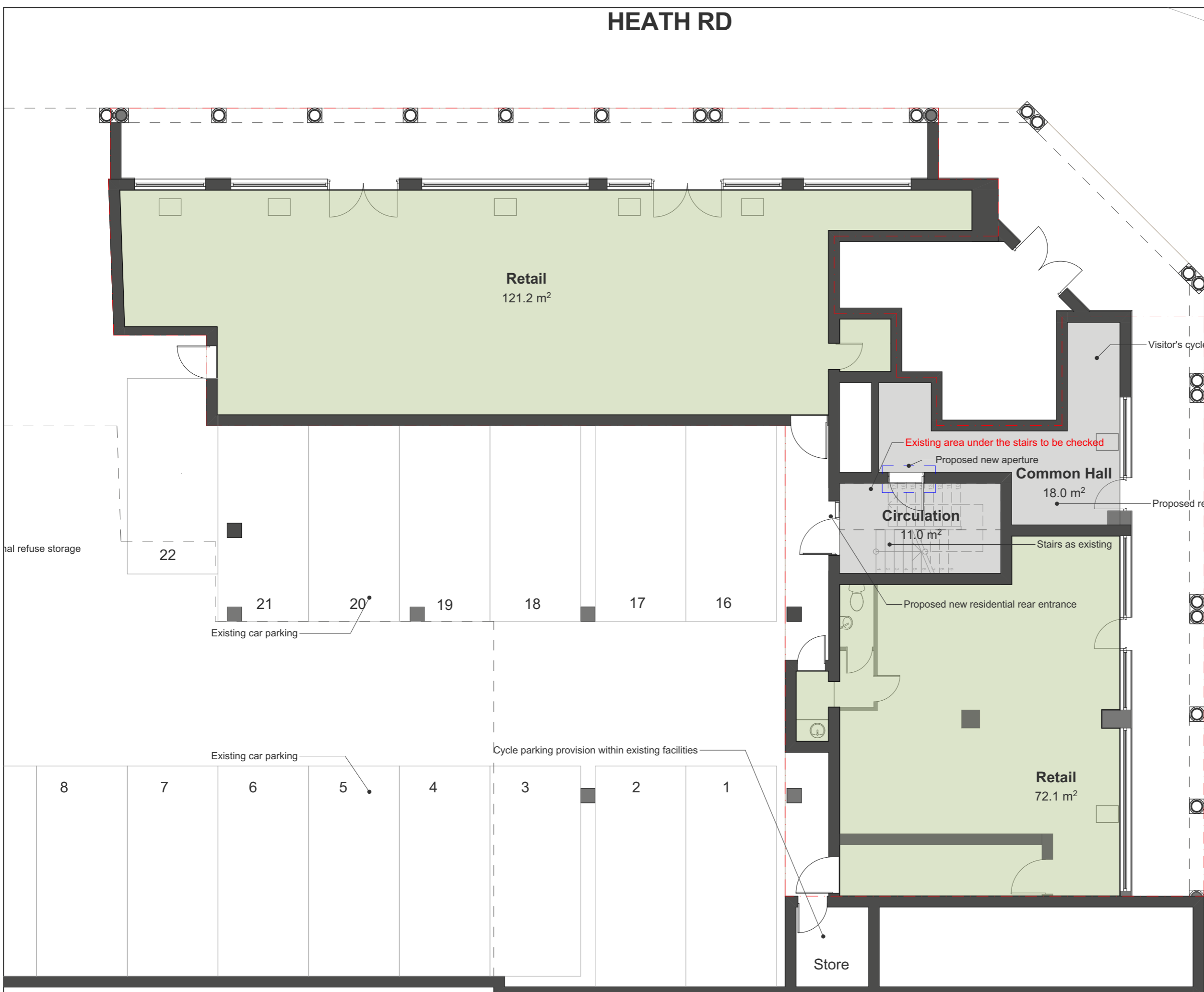

CROSS DEEP



Retail
121.2 m²

Common Hall
18.0 m²

Circulation
11.0 m²

Retail
72.1 m²

Store

hal refuse storage

22

21

20

19

18

17

16

Existing car parking

Existing car parking

Cycle parking provision within existing facilities

8

7

6

5

4

3

2

1

Visitor's cycle storage

Existing area under the stairs to be checked

Proposed new aperture

Proposed residential entrance

Stairs as existing

Proposed new residential rear entrance

- Circulation/Common Spaces
- Retail
- Walls to be demolished, tbc with structural engineer
- Proposed apertures
- Proposed new walls
- Existing walls, to maintain

Rev	Description	Drawn	Checked	Date
02	For Planning	BC	MW	Work in Progress

CREATE
 DESIGN + ARCHITECTURE
 Wigglesworth House 69 Southwark Bridge Road London SE1 9HH
 +44 207 021 0267 info@createdesign.org www.createdesign.org

CROSS DEEP COURT
 TW1 4AG
 Client
 Philip Mallon - Archway Investments

#Project Status
 PROPOSED PLANNING
PROPOSED GROUND FLOOR PLAN

CDA Ref	Scale(s)	Original Paper Size
698	1:100	A3

Drawing Number						
Project	Originator	Volume	Level	Type	Role	Class Number
698	CDA	ZZ	00	DR	A	05 0100
Revision						
Revision	Revision Description					
01 - WIP	For planning					

This document and its design content is copyright ©. It shall be read in conjunction with all other associated project information including models, specifications, schedules and related consultants documents. Do not scale from documents. All dimensions to be checked on site. Immediately report any discrepancies, errors or omissions on this document to the Originator. If in doubt ASK.

