

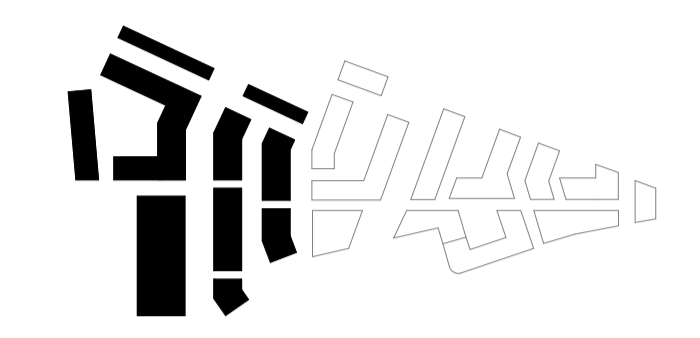

NOTES:  
DO NOT SCALE FROM THIS DRAWING. ALL DIMENSIONS TO BE CHECKED ON SITE. ALL OMISSIONS AND DISCREPANCIES TO BE REPORTED TO THE ARCHITECT IMMEDIATELY.

ALL RIGHTS RESERVED. THIS WORK IS COPYRIGHT AND CANNOT BE REPRODUCED OR COPIED OR MODIFIED IN ANY FORM OR BY ANY MEANS, GRAPHIC ELECTRONIC OR MECHANICAL, INCLUDING PHOTOCOPIING WITHOUT THE WRITTEN PERMISSION OF SQUIRE AND PARTNERS ARCHITECTS.

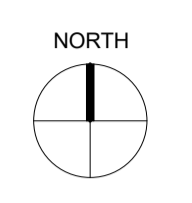

NOTE: UNIT MIX AND LAYOUT FOR DEVELOPMENT AREA 2 IS INDICATIVE AT THIS STAGE

NOTE:    WHEELCHAIR ACCESSIBLE UNIT / CONVERTIBLE UNIT

- Studio
- 3B5P SR
- 3B6P SR
- BIKE STORE
- CAR PARK ENTRANCE
- LV SWITCHROOM
- REFUSE STORE
- SCHOOL
- SUBSTATION
- 2B3P
- 2B4P
- 3B5P
- 3B6P
- 2B3P SR
- 2B4P SR

LBURT 2 APPLICATION AMENDMENTS	21/07/22	BJ	E
LBURT 2 APPLICATION	25/02/22	BJ	D
GLA SUBMISSION	27/04/20	BJ	C
DRAFT GLA SUBMISSION	24/01/20	KH	B
FINAL DRAFT PLANNING APPLICATION	21/10/19	KH	A
LEGAL REVIEW	13/09/19	KH	-

Revision description	Date	Check	Rev

## SQUIRE & PARTNERS

The Department Store  
248 Ferndale Road London SW9 8FR  
T: 020 7278 5555 F: 020 7239 0495

info@squireandpartners.com  
www.squireandpartners.com

Project  
**Stag Brewery**  
Richmond

### PROPOSED DEVELOPMENT AREA 02 GROUND LEVEL PLAN

Drawn	Date	Scale
RKL	18/01/18	1:500 @ A1 1:1000 @ A3
Job Number	Drawing number	Revision
18125	C645_Z2_P_00_001	E

