

From:
Sent: 18/November/2022 11:37 (GMT)
To:
Subject: 22/3004/FUL Kneller Hall (Dukes Education) Traffic Generation and Noise/Disturbance

Your Reference: **22/3004/FUL**

Good morning,

I hope you can assist with some questions I have around the Dukes Education planning application.

Regarding: <https://images.richmond.gov.uk/iam/IAMCache/3562567/3562567.pdf>

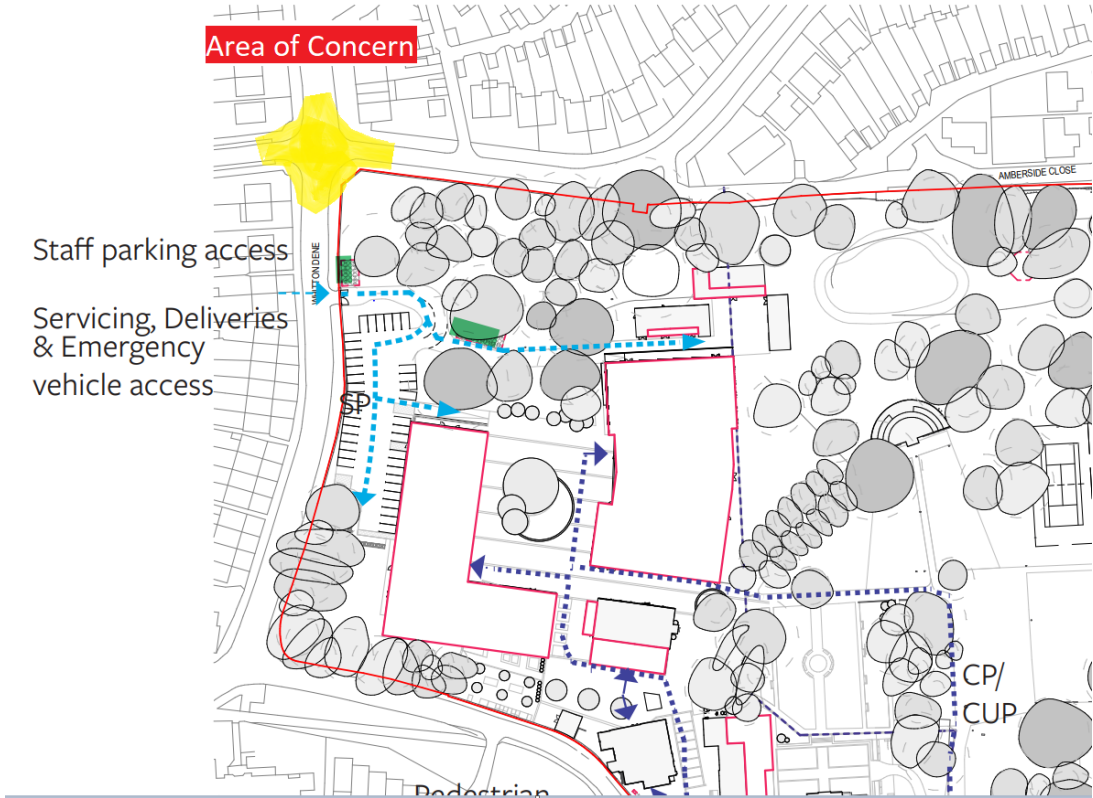



This intersection has a bus stop and parking on the western side of the street.

The staff parking gate is shown above. Please note the proximity to the bus stop, the marked parking bays and the intersection in yellow.

How does the applicant and the council propose to deal with the additional congestion (people, traffic and parking) caused by:

- (a) staff turning right into the staff parking from the western lane?
- (b) the additional traffic at the Kneller Gardens / Old Manor Drive / Whitton Dene intersection (shown in yellow above)?
- (c) interruption to the footpath used by parents taking their children to school in the mornings?

At the moment this stretch of road is a pinch point in the morning rush hour, often delayed by a bus stopping. In addition, the intersection at Kneller Road / Nelson Road / Whitton Dene also congests during school mornings, seeing a back up of traffic affecting the intersection shown above.

Many thanks,

Darren Breen

Official

From: ED Parker-Breen

Sent: 06 December 2022 10:21

To: Edwards, Grace

Subject: Re: 22/3004/FUL Kneller Hall (Dukes Education) Traffic Generation and Noise/Disturbance

Morning Grace,

Thank you for your email.

You can lodge this as an **objection**.

My address is:
27 Old Manor Drive
Isleworth
TW77NN

Many thanks,
Darren