

PLANNING

RED NOTES/ SHOW AMENDMENTS TO ORIGINAL PLANNING APPLICATION

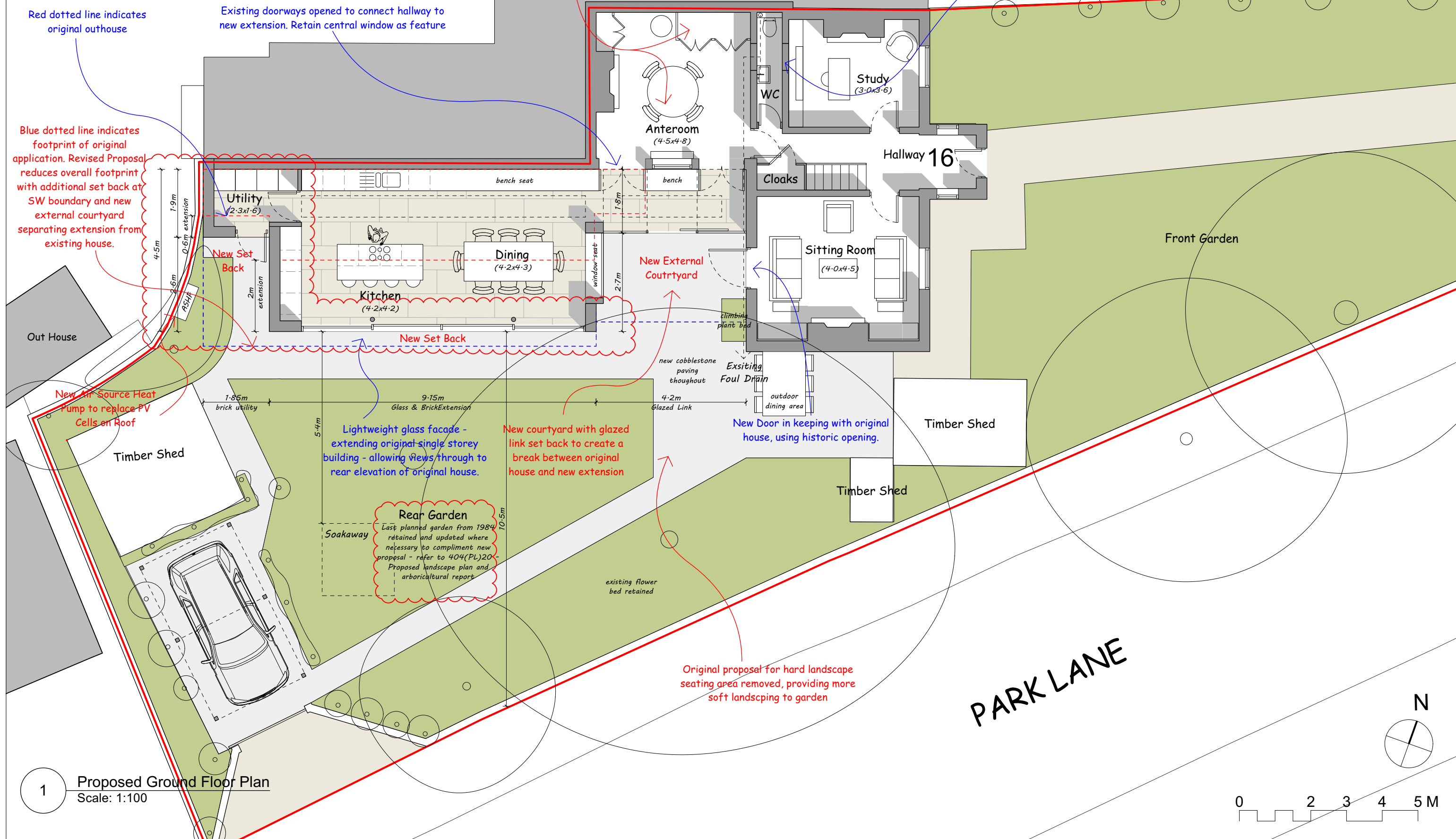

Original Application dividing wall removed and existing joinery retained to Anteroom

Existing storeroom doorways infilled and new door to hallway creating WC. All original corning and architraves retained.

Red dotted line indicates original outhouse

Existing doorways opened to connect hallway to new extension. Retain central window as feature

Blue dotted line indicates footprint of original application. Revised Proposal reduces overall footprint with additional set back at SW boundary and new external courtyard separating extension from existing house.

New Air Source Heat Pump to replace PV Cells on Roof

Lightweight glass facade - extending original single storey building - allowing views through to rear elevation of original house.

New courtyard with glazed link set back to create a break between original house and new extension

New Door in keeping with original house, using historic opening.

Rear Garden
Last planned garden from 1984 retained and updated where necessary to compliment new proposal - refer to 404(PL)20 - Proposed landscape plan and arboricultural report

Original proposal for hard landscape seating area removed, providing more soft landscaping to garden

1 Proposed Ground Floor Plan
Scale: 1:100

