

Notes :

This drawing has been prepared in accordance with BS 5837:2012.

This drawing is intended to be printed and used in colour only, and for no purpose other than the consideration of trees in accordance with BS 5837.

BS5837:2012 Cascade chart for tree quality assessment			
Category & Definition	Criteria (including subcategories where appropriate)	Identification on plan	
<b>Trees unsuitable for retention</b>			
Category U			
Trees in such a position that they are likely to be removed to allow space for new buildings or other structures, or where they are likely to be removed for safety reasons.	Trees that have a serious irreversible structural defect, such that their long term retention is expected to be a disproportionate cost to the client, or where they are likely to be removed for safety reasons.	Red	Red on plan RB 12/0.0
<b>Trees to be considered for retention</b>			
Category A			
Trees of high quality with a canopy spread of at least 4.5m.	Trees that are particularly good specimens of their species, or have a high degree of amenity value, or are particularly old, or have a high degree of historical or scientific interest.	Light Green	Light Green RB 9.5/0.0
Category B			
Trees of moderate quality with a canopy spread of at least 3.5m.	Trees that are particularly good specimens of their species, or have a high degree of amenity value, or are particularly old, or have a high degree of historical or scientific interest.	Blue	Blue RB 0.1/0.0
Category C			
Trees of low quality with a canopy spread of at least 2.5m.	Trees that are particularly good specimens of their species, or have a high degree of amenity value, or are particularly old, or have a high degree of historical or scientific interest.	Grey	Grey RB 0.1/0.0

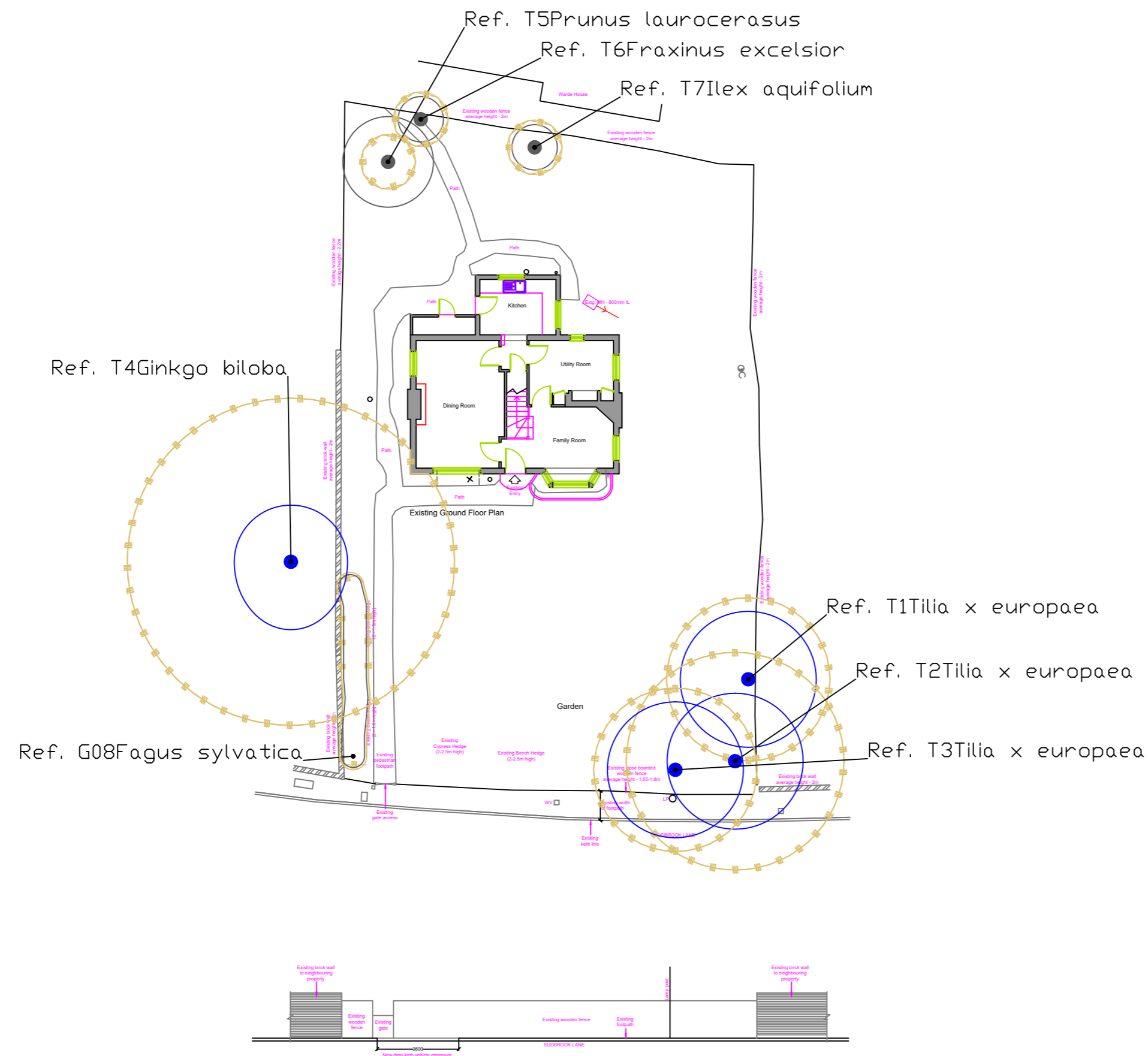

KEY

- Root Protection Area (RPA)
- Tree Stem
- T1 Tree No.

Rev	Details	Date	Checked By
-----	---------	------	------------

Drawing Number AEL-18604-TCP



Apex Environmental Ltd

3 Lawrence Way, Lichfield, WS13 6RD  
TEL: 0121 249 1235 e-mail: info@acl-treecoconsultants.co.uk web: www.acl-treecoconsultants.co.uk

Client O Hill-Mathieson

Project The Cottage, Sudbrook Lane

Title Tree Constraints Plan

Scale	Date	Drawn By	Checked By	Drawing Number	Revision
1:200	01/09/2022	RJH			A

THIS DRAWING IS CONFIDENTIAL AND MUST NOT BE REPRODUCED WITHOUT THE CONSENT OF APEX ENVIRONMENTAL LTD

