

Tree reference number	Species	Category grading	RPA m ²	Wall Incursion (m ²)	TOTAL %	Significance	Comments
T2	European Lime (<i>Tilia x europaea</i>)	B1	58	1.5	2.6	Insignificant	The impact on the root system is just at the permitted amount of 20% as per the BS5837 S7.4.2.3. This will require an area of engineered wall of pile and beam design. The design and impact is seen as acceptable to the tree.
T3	European Lime (<i>Tilia x europaea</i>)	B1	41	2	4.9	Insignificant	The impact on the root system is just at the permitted amount of 20% as per the BS5837 S7.4.2.3. This will require an area of engineered wall of pile and beam design. The design and impact is seen as acceptable to the tree.

Notes :

This drawing has been prepared in accordance with BS 5837:2012.

This drawing is intended to be printed and used in colour only, and for no purpose other than the consideration of trees in accordance with BS 5837.

BS5837:2012 Cascade chart for tree quality assessment

Category & Definition	Criteria (including subcategories where appropriate)	Identification on plan
Trees unsuitable for retention	Category U	Red on plan RGB 127,0,0
Trees to be considered for retention	Category A, B, C	Light Green RGB 0,255,0; Blue RGB 0,0,255; Grey RGB 091,091,091

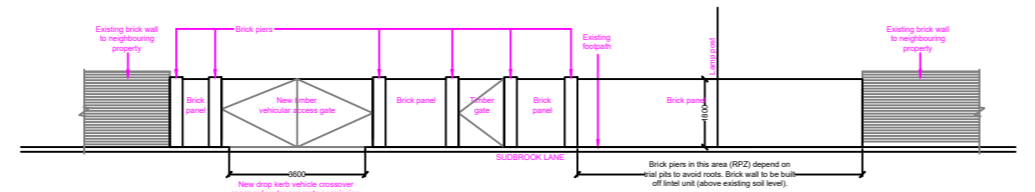
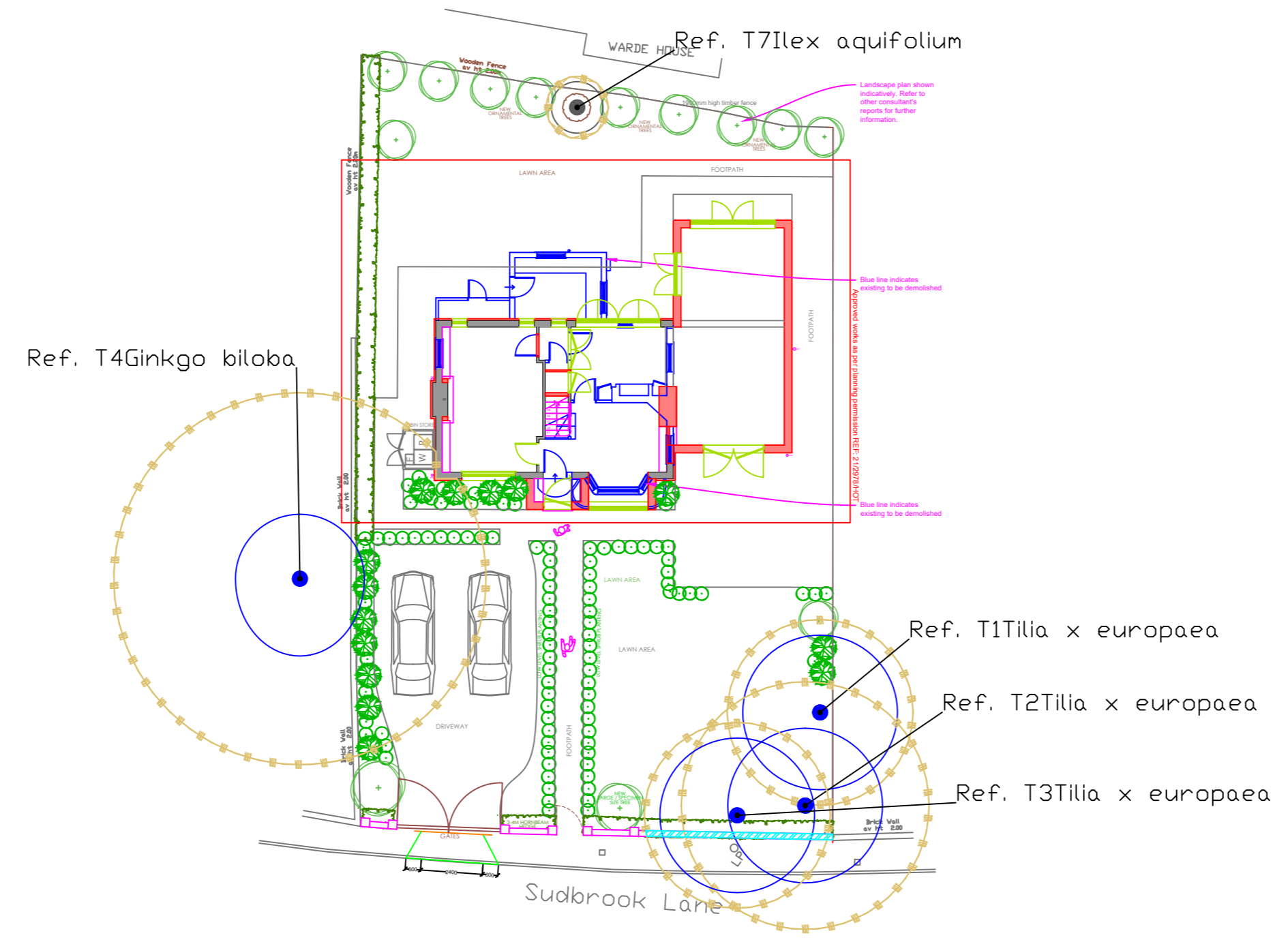

- KEY**
- Root Protection Area (RPA)
 - Tree Stem
 - T1 Tree No.
 - Tree Incursion

Rev	Details	Date	Checked By

Drawing Number **AEL-18604-TIP**

Apex Environmental Ltd
 3 Lawrence Way, Lichfield, WS13 6RD
 TEL: 0121 249 1235 e-mail: info@ael-treiconsultants.co.uk web: www.ael-treiconsultants.co.uk

Client **O Hill-Mathieson**

Project **The Cottage, Sudbrook Lane**

Title **Tree Impct Plan**

Scale	Date	Drawn By	Checked By	Drawing Number	Revision
1:200	06/04/2022	RJH			B

THIS DRAWING IS CONFIDENTIAL AND MUST NOT BE REPRODUCED WITHOUT THE CONSENT OF APEX ENVIRONMENTAL LTD

