

Notes :

This drawing has been prepared in accordance with BS 5837:2012.

This drawing is intended to be printed and used in colour only, and for no purpose other than the consideration of trees in accordance with BS 5837.

BS5837:2012 Cascade chart for tree quality assessment

Category & Definition	Criteria (including subcategories where appropriate)	Identification on plan
Trees unsuitable for retention		
Category U	Trees that have a serious irreparable structural defect such that their early loss is expected due to their condition. The loss or removal of such trees is required by statute. Trees that are dead or dying, or trees that are severely damaged by disease, or trees that are severely damaged by other factors such that they are expected to die within a short period of time.	Red on plan RGB 127,0,0
Trees to be considered for retention		
Category A	Trees that are particularly good examples of their species, or trees that are particularly good examples of their species, or trees that are particularly good examples of their species, or trees that are particularly good examples of their species.	Light Green RGB 0,255,0
Category B	Trees that are of moderate quality and are considered worthy of retention. Trees that are of moderate quality and are considered worthy of retention.	Blue RGB 0,0,255
Category C	Trees of low quality with an expected remaining life expectancy of at least 10 years, or young trees with a diameter below 100mm.	Grey RGB 255,255,255

KEY

- Root Protection Area (RPA)
- Tree Stem
- T1 Tree No.
- Tree to be removed
- Tree to be pruned

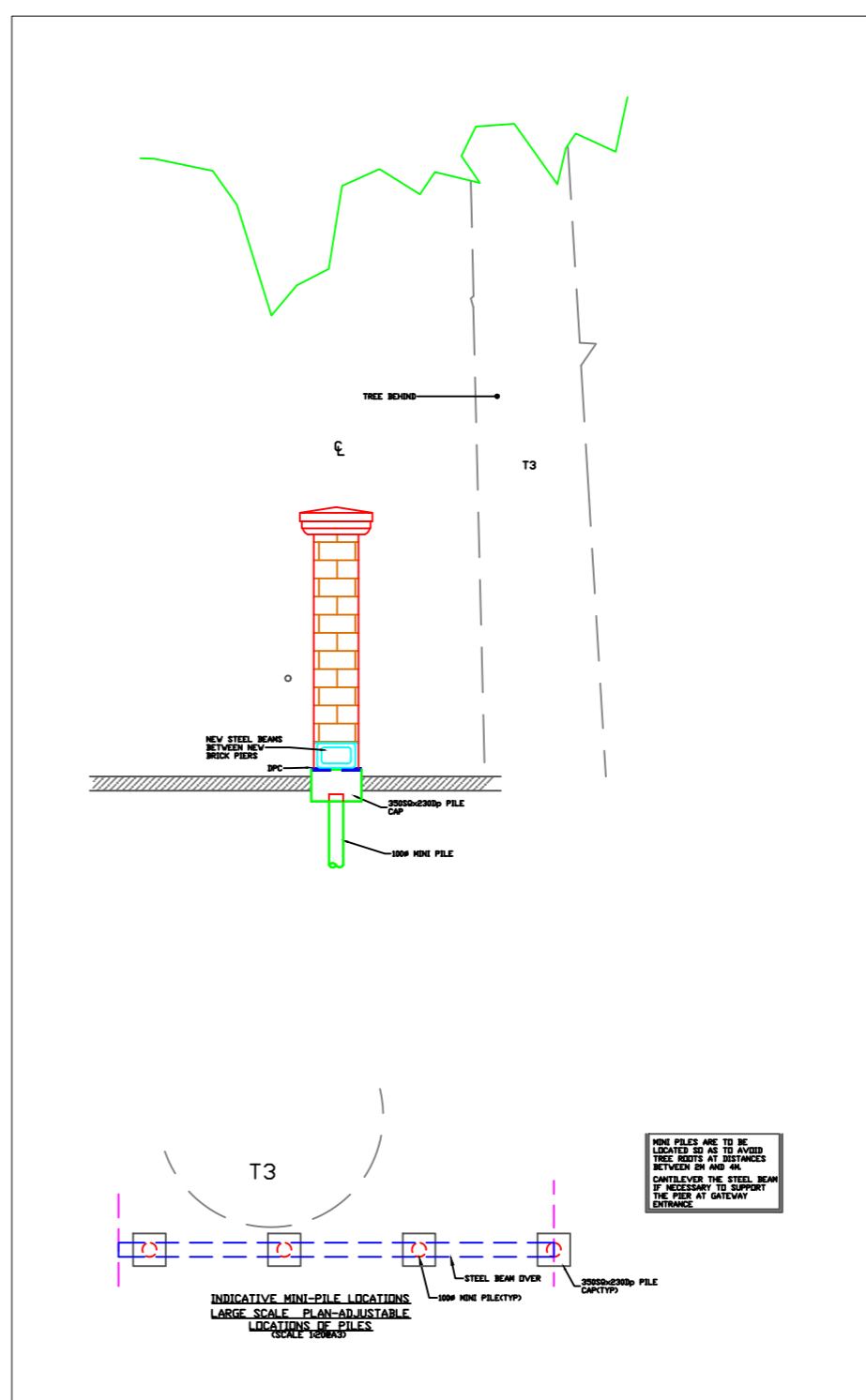

Scale 1:50
Indicative proposal of pile and beam for wall construction

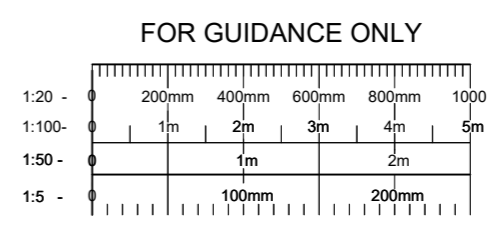
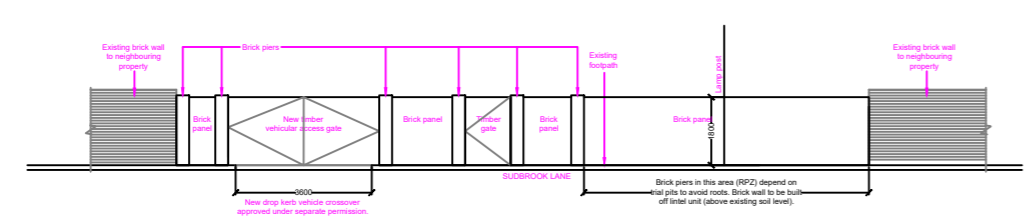
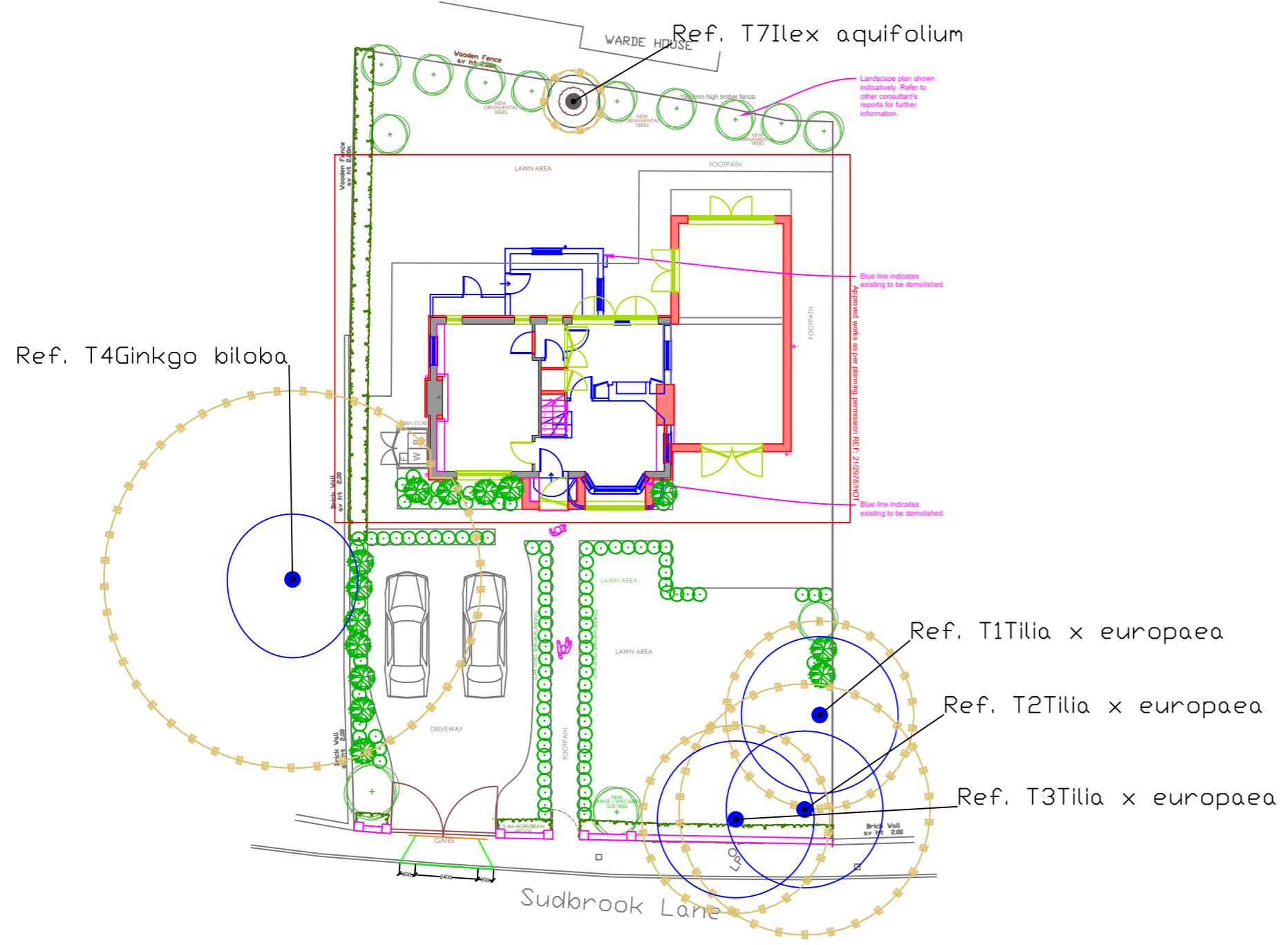

Rev	Details	Date	Checked By

Drawing Number: AEL-18604-TWP

APEX Environmental Ltd
3 Lawrence Way, Lichfield, WS13 6RD
TEL: 0121 249 1235 e-mail: info@ael-treecoconsultants.co.uk web: www.ael-treecoconsultants.co.uk

Client: O Hill-Mathieson
Project: The Cottage, Sudbrook Lane
Title: Tree Work Plan

Scale	Date	Drawn By	Checked By	Drawing Number	Revision
1:200	01/09/2022	RJH			A

THIS DRAWING IS CONFIDENTIAL AND MUST NOT BE REPRODUCED WITHOUT THE CONSENT OF APEX ENVIRONMENTAL LTD