

1. Existing / Proposed Site Section / Typical Elevation 1:200

- New area of permeable grasscrete to arena entrances, to ensure consistency of surface for access all year round and to avoid injuries to horses.
- Existing arena fence removed
- Existing 5 bar metal gate to be retained
- Existing 5 bar timber gate to be removed, and new timber fence infill to match existing adjacent boundary fence
- Access gates at either end to double up as goals once closed
- Additional hedgerow planting to landscape architects spec
- Existing arena fence removed
- All existing trees to Melancholy walk to be protected throughout the duration of the works, see accompanying arboricultural method statement for details
- Thick red dashed line denotes site boundary
- New planted hedgerow to landscape architects specification
- Existing foliage removed
- Existing trees removed as shown, replacement planting to landscape architects design
- Finished ground level of sand arena as per section/elevation shown above in detail 1, to ensure no net increase in ground level to maintain flood storage capacity
- Levels shown in red denote proposed new levels.
- Additional hedgerow planting to landscape architects spec
- Dashed lines denote drainage channels with 100mm perforated pipe, to attenuate storm water, and to soakaway beneath the playing surface. Located for away from root protection areas of existing trees, to avoid damage to roots.
- New planted hedgerow to landscape architects specification
- Proposed replacement and enlargement of existing sand arena, with new surface, new drainage and new perimeter timber fence
- Levels shown in red denote proposed new levels.
- Access gates at either end to double up as goals once closed
- New area of permeable grasscrete to arena entrances, to ensure consistency of surface for access all year round and to avoid injuries to horses.
- Additional hedgerow planting to landscape architects spec
- Thick red dashed line denotes site boundary

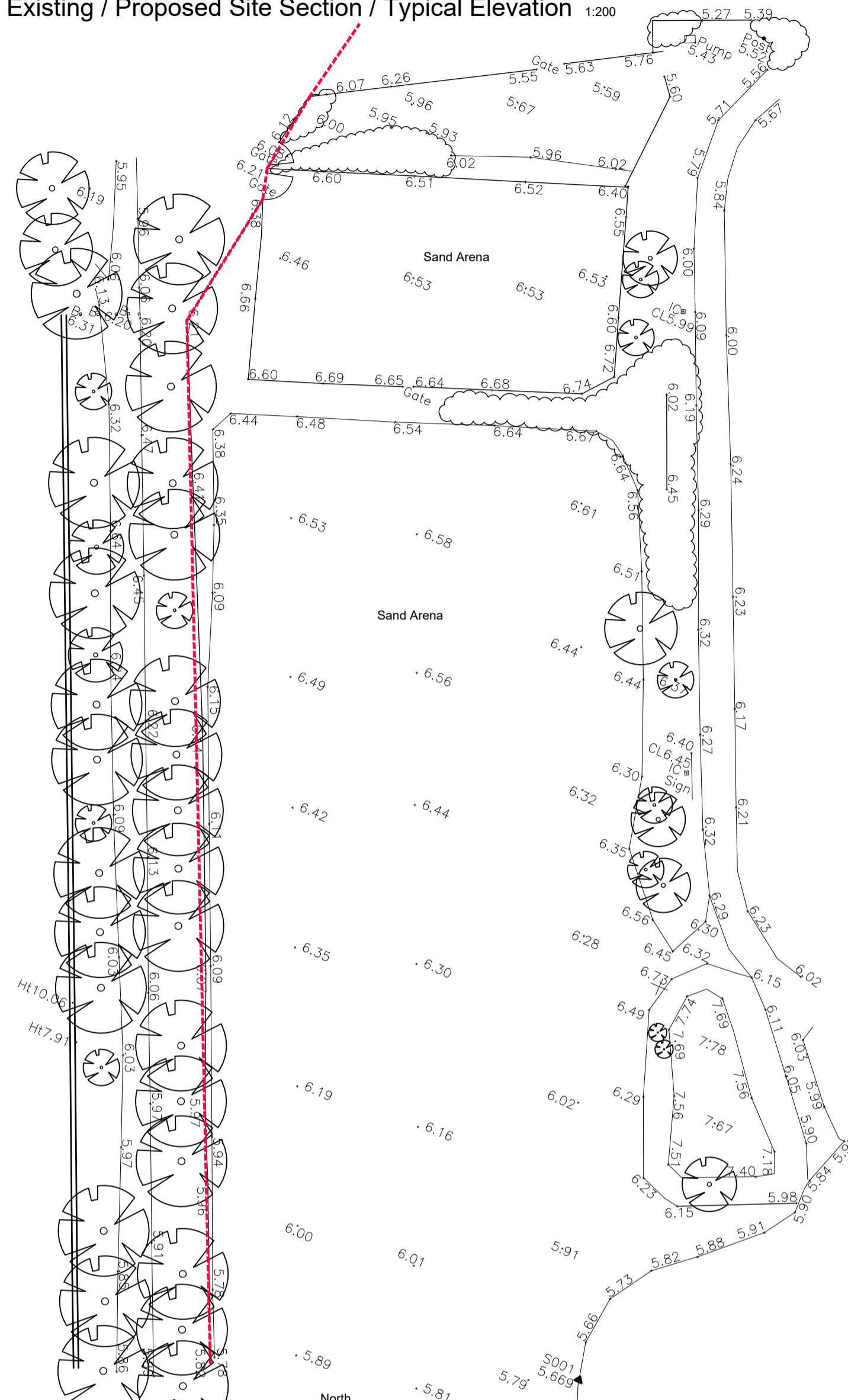

2. Existing Site Plan 1:500

3. Proposed Site Plan 1:500

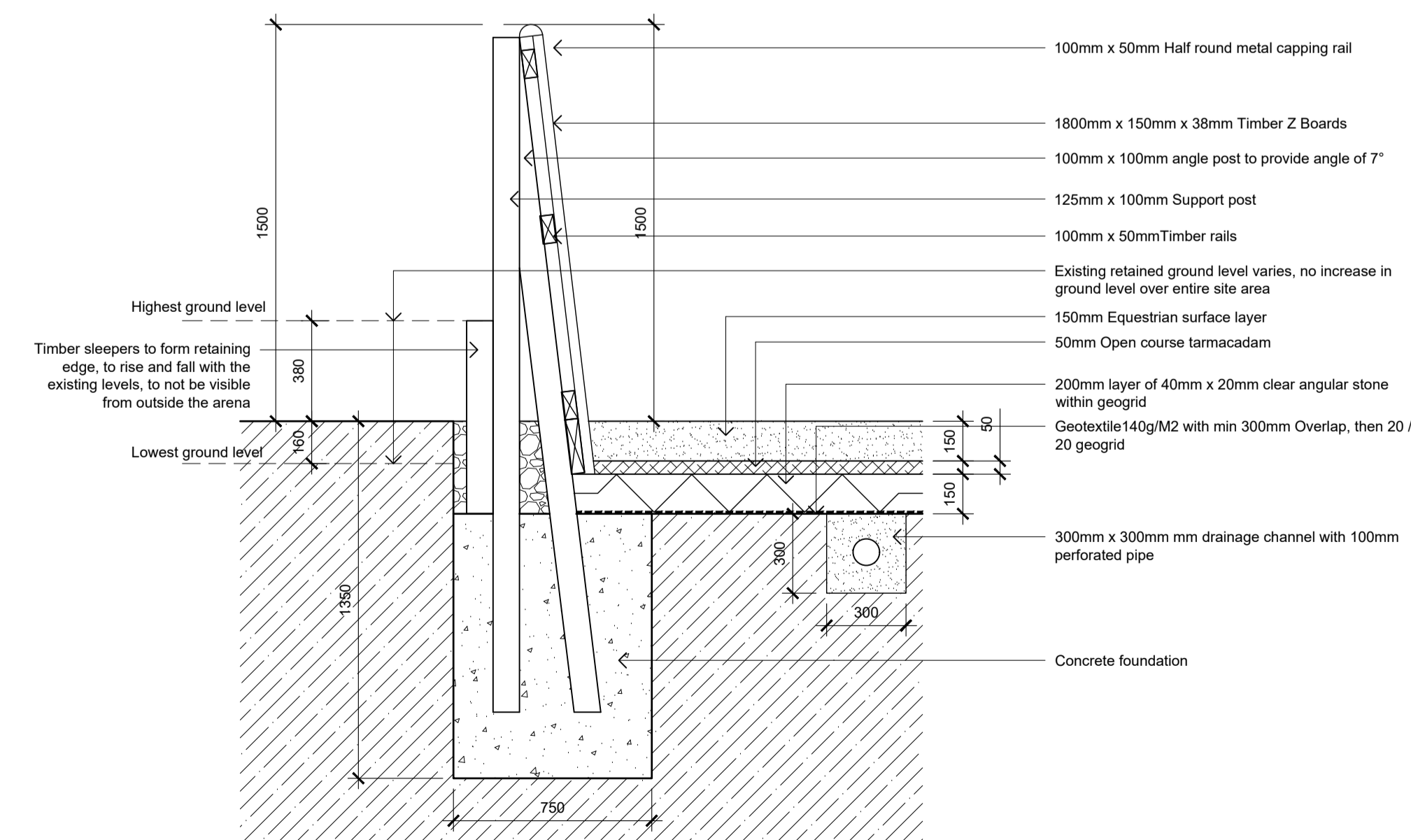
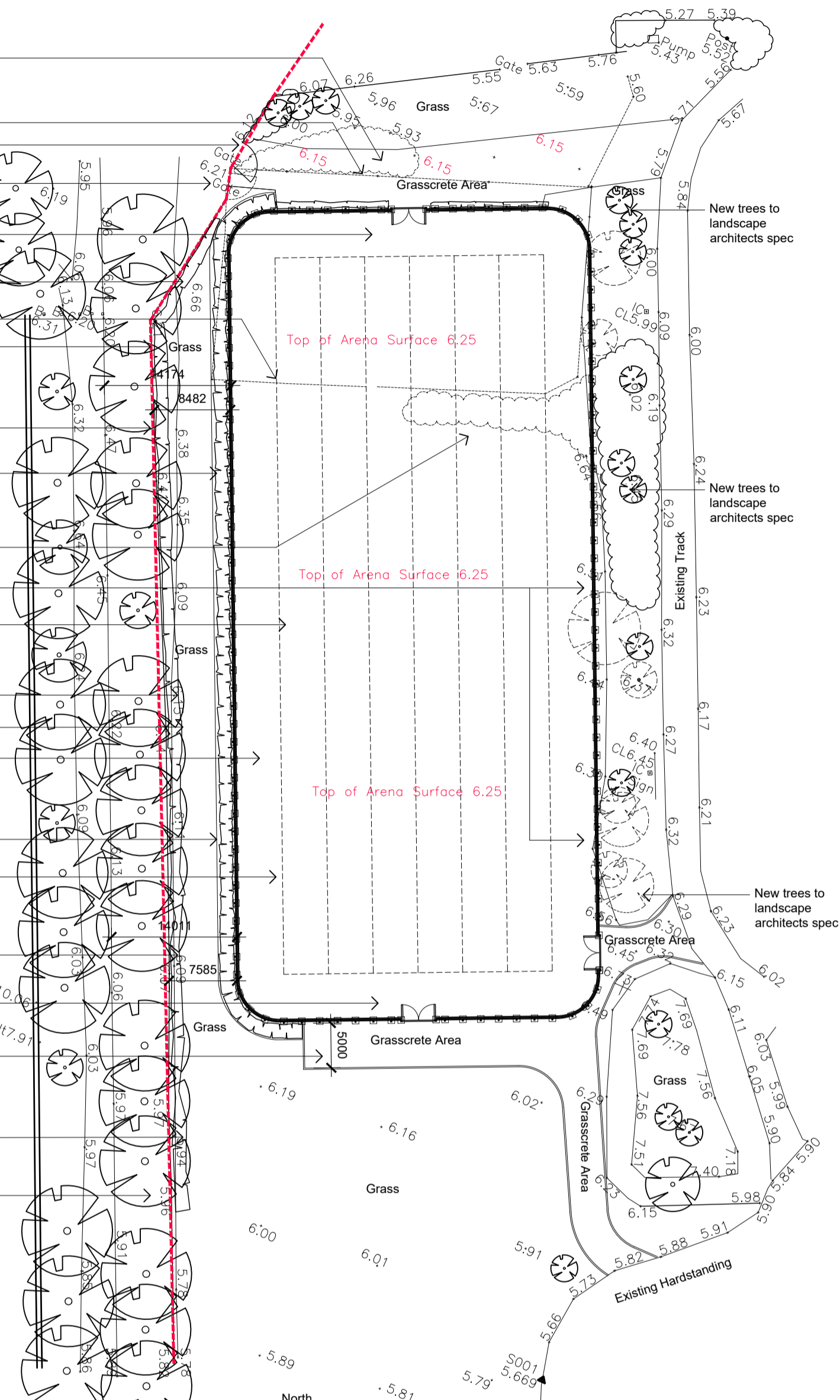

4. Fence / Arena Floor Detail 1:20

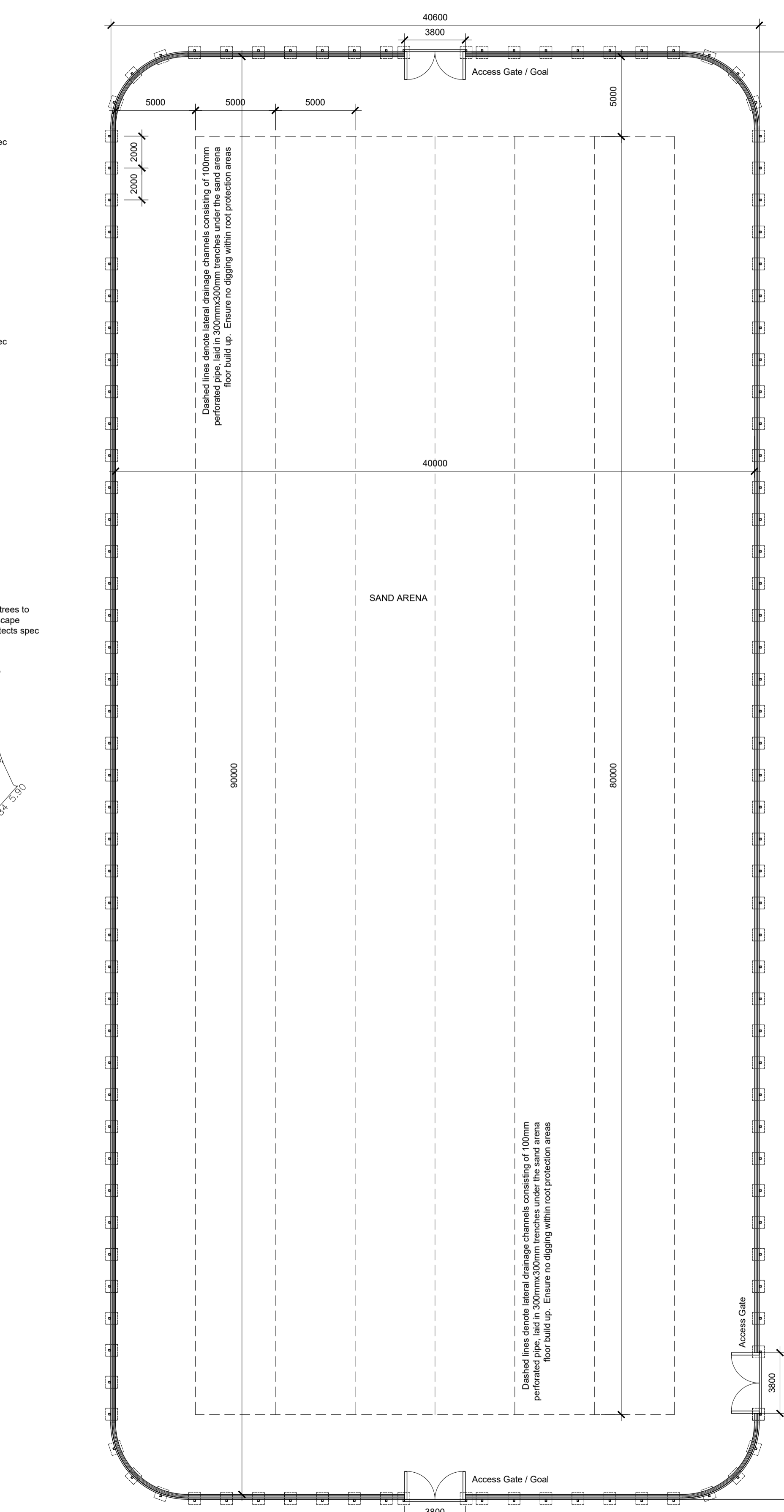

5. Proposed Arena Plan 1:200

1. All boundaries, dimensions and levels are to be checked on site before construction and any discrepancies are to be reported to the Architect. 2. Drawings may be scaled from for planning purposes. 3. Drawings not supplied in paper format by Will Aust Architecture may not be to the scale indicated in the size box. 4. This drawing is copyright and may not be reproduced or used for any purpose other than that intended without the prior written agreement of the Architect. 5. Any parts of the drawing based on Ordnance Survey maps are executed with the sanction of the controller of H.M. Stationery Office: Crown Copyright Reserved.

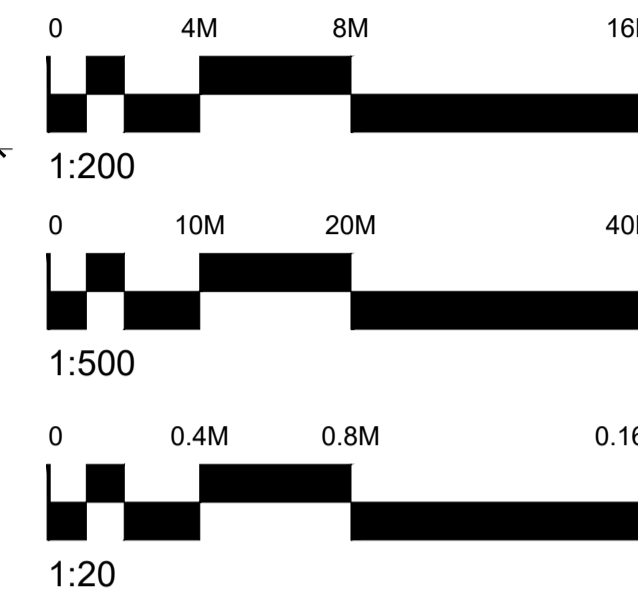

Rev	Date	Description	By	CHK
H	12.01.23	Additional landscaping added	WA	WA

WILLAUSTRARCHITECTURE

162 Julian Road
West Bridgford
Nottingham
NG2 5AN

t: 07738260093
e: will@willaust.co.uk
w: www.willaust.co.uk

Client:
Ham Polo Club

Project:
Proposed Sand Arena Extension

Drawing title:
Proposed Plans and Details

Scale(s)	Size	First issue	Drawn
Varies	A1	24.05.21	WA
Job no:	Drawing no:	Rev:	
LTD34	10	H	

PLANNING