

1954-EXA-00-ZZ-DR-L-1001

1954-EXA-00-ZZ-DR-L-1002

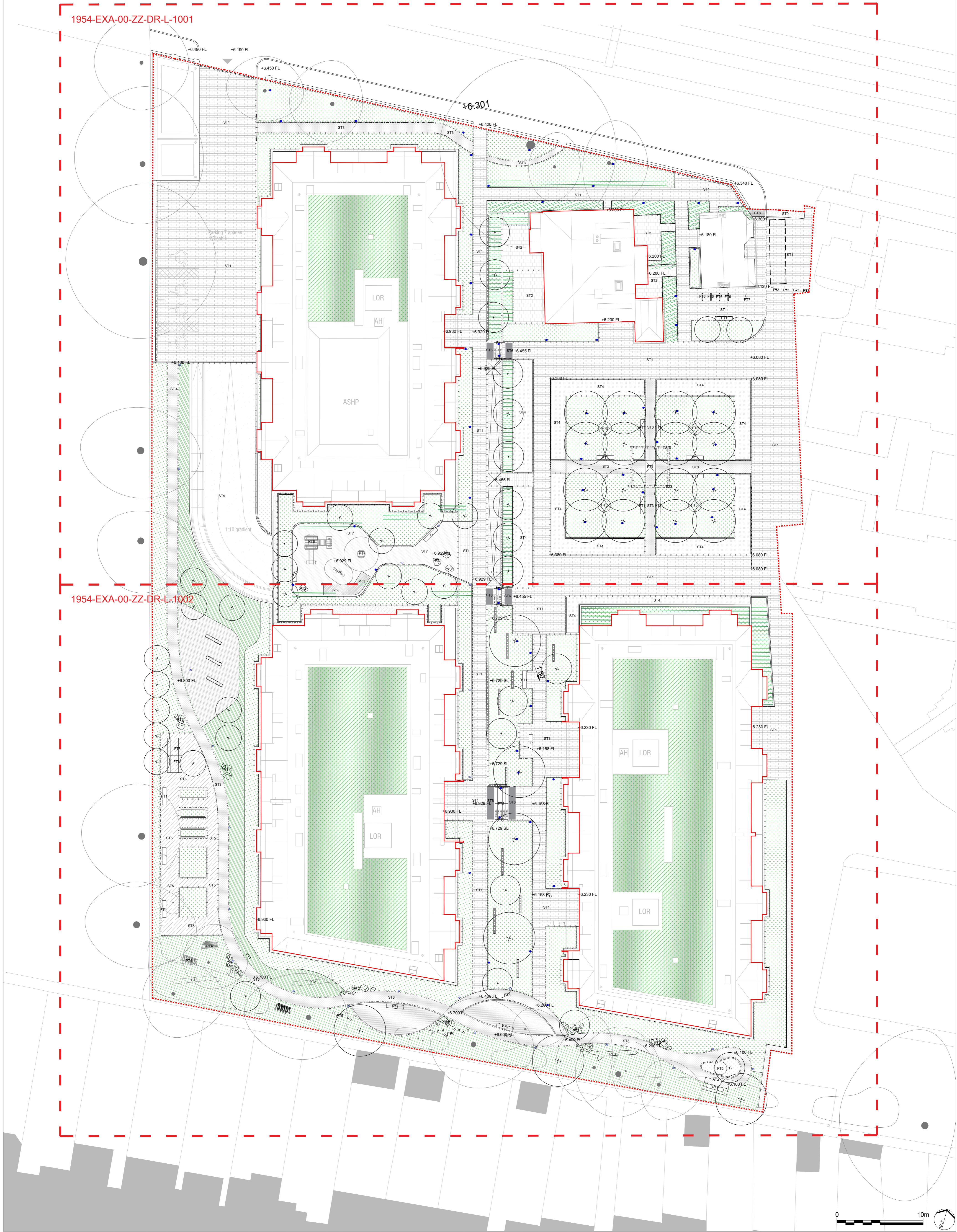

EXTERIOR ARCHITECTURE

LONDON
Unit 17.1, The Leather Market, 11-13 Weston Street, London, SE1 3ER
MANCHESTER
Studio 537, The Royal Exchange, St Anns Square, Manchester, M2 7DH

E-MAIL office@exteriorarchitecture.com
WEB www.exteriorarchitecture.com

Client
LS ESTATES

No dimensions are to be scaled from this drawing.
All dimensions are to be checked on site.
Area measurements for indicative purposes only.

This drawing is the property of Exterior Architecture Ltd.
No part of the drawing may be reproduced in any manner
without permission from Exterior Architecture Ltd.

Rev	Description	Date
---	---	---
P3	FOR PLANNING	11.10.2022
P2	FOR PLANNING	11.02.2022
P1	FOR PLANNING	15.11.2021
P0	FOR PLANNING	29.07.2021
Rev	Description	Date

Project title
BARNES HOSPITAL

Drawing title
GENERAL ARRANGEMENT PLAN

Issued By London
Scale 1:200 @ A1
Status PLANNING
Date 08.07.2021

Drawing number
1954-EXA-00-ZZ-DR-L-1000

T: 020 7978 2101
Drawn DF
Checked ExA
Approved ExA

Revision
P3

P:\LONDON PROJECTS\2019\1954_BARNES HOSPITAL\01 CAD\02 SHEET LAYOUT\1954-EXA-00-ZZ-DR-L-1000.DWG