

GENERAL NOTES
 1. ALL WORK IS TO BE IN ACCORDANCE WITH THE LATEST EDITIONS OF THE BUILDING REGULATIONS AND THE LATEST EDITIONS OF THE BRITISH STANDARDS INSTITUTION (BSI) STANDARDS.
 2. THE CONTRACTOR SHALL BE RESPONSIBLE FOR OBTAINING ALL NECESSARY CONSENTS AND APPROVALS FROM THE LOCAL AUTHORITY.
 3. THE CONTRACTOR SHALL BE RESPONSIBLE FOR OBTAINING ALL NECESSARY CONSENTS AND APPROVALS FROM THE LOCAL AUTHORITY.
 4. THE CONTRACTOR SHALL BE RESPONSIBLE FOR OBTAINING ALL NECESSARY CONSENTS AND APPROVALS FROM THE LOCAL AUTHORITY.
 5. THE CONTRACTOR SHALL BE RESPONSIBLE FOR OBTAINING ALL NECESSARY CONSENTS AND APPROVALS FROM THE LOCAL AUTHORITY.
 6. THE CONTRACTOR SHALL BE RESPONSIBLE FOR OBTAINING ALL NECESSARY CONSENTS AND APPROVALS FROM THE LOCAL AUTHORITY.
 7. THE CONTRACTOR SHALL BE RESPONSIBLE FOR OBTAINING ALL NECESSARY CONSENTS AND APPROVALS FROM THE LOCAL AUTHORITY.
 8. THE CONTRACTOR SHALL BE RESPONSIBLE FOR OBTAINING ALL NECESSARY CONSENTS AND APPROVALS FROM THE LOCAL AUTHORITY.
 9. THE CONTRACTOR SHALL BE RESPONSIBLE FOR OBTAINING ALL NECESSARY CONSENTS AND APPROVALS FROM THE LOCAL AUTHORITY.
 10. THE CONTRACTOR SHALL BE RESPONSIBLE FOR OBTAINING ALL NECESSARY CONSENTS AND APPROVALS FROM THE LOCAL AUTHORITY.

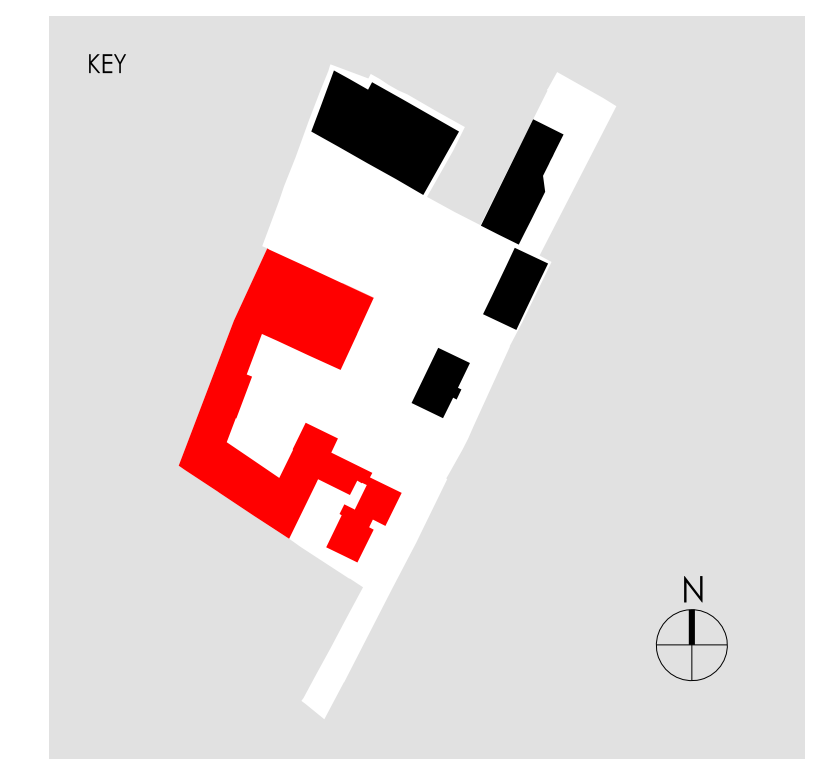
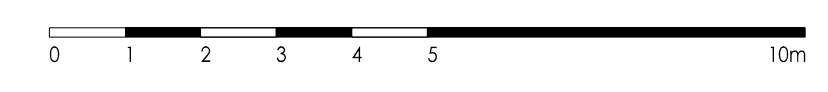

EXISTING GROUND FLOOR PLAN (SOUTH SIDE)

| | | |
|--|------------|------|
| DATE | BY | CHKD |
| DATE | BY | CHKD |
| PCKO | | |
| an AR company | | |
| ARCHITECTS INTERIOR DESIGNERS MASTER PLANNERS URBAN DESIGNERS | | |
| GINT | | |
| Notling Hill Genesis | | |
| PROJECT | | |
| St Clare SCL-AHR | | |
| DRAWING TITLE | | |
| Existing Ground Floor Plan South Side | | |
| PLANNING | | |
| SCALE | DRAWN BY | APP |
| 1:100 | PP | PP |
| DATE | CHECKED BY | DDG |
| 2019.10 | DDG | DDG |
| DRAWING NO | REVISION | |
| S0-00-DR-B-10-010-P1 | P01 | |