

**GENERAL NOTES**  
 1. ALL WORK TO BE IN ACCORDANCE WITH THE BUILDING REGULATIONS AND THE BUILDING ACT 2004.  
 2. THE CLIENT HAS PROVIDED ALL NECESSARY INFORMATION AND DOCUMENTATION.  
 3. THE DESIGNER HAS CONDUCTED VISUAL SURVEYS AND VISUAL IMPACT ASSESSMENTS.  
 4. THE DESIGNER HAS CONDUCTED VISUAL SURVEYS AND VISUAL IMPACT ASSESSMENTS.  
 5. THE DESIGNER HAS CONDUCTED VISUAL SURVEYS AND VISUAL IMPACT ASSESSMENTS.  
 6. THE DESIGNER HAS CONDUCTED VISUAL SURVEYS AND VISUAL IMPACT ASSESSMENTS.  
 7. THE DESIGNER HAS CONDUCTED VISUAL SURVEYS AND VISUAL IMPACT ASSESSMENTS.  
 8. THE DESIGNER HAS CONDUCTED VISUAL SURVEYS AND VISUAL IMPACT ASSESSMENTS.  
 9. THE DESIGNER HAS CONDUCTED VISUAL SURVEYS AND VISUAL IMPACT ASSESSMENTS.  
 10. THE DESIGNER HAS CONDUCTED VISUAL SURVEYS AND VISUAL IMPACT ASSESSMENTS.

0 1 2 3 4 5 10m

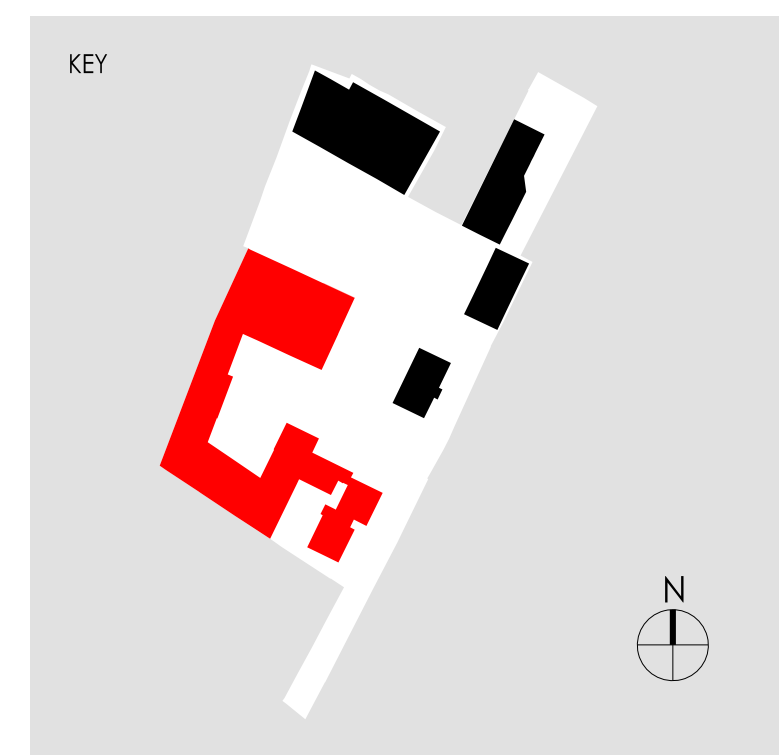

EXISTING SECOND FLOOR PLAN (SOUTH SIDE)

DATE	2019.10	BY	PP
SCALE	1:100	BY	PP
		S - 8 HARDWICK STREET TEL: 020 - 7372 - 8918 www.pcko.co.uk	
ARCHITECTS INTERIOR DESIGNERS MASTER PLANNERS URBAN DESIGNERS			
Notting Hill Genesis			
St Clare SCL-AHR			
Existing Second Floor Plan South Side			
DATE	2019.10	DRAWN BY	PP
SCALE	1:100	CHECKED BY	DDG
DATE	2019.10	BY	PP
SCALE	1:100	BY	PP