

PRIOR TO THE COMMENCEMENT OF ANY WORKS, THE BUILDER IS TO CHECK AND/OR DETERMINE ALL CONSTRUCTION DETAILS, INCLUDING CHECKING EXISTING SITE LEVELS AND DIMENSIONS. THE DRAWING IS TO BE READ IN CONJUNCTION WITH ALL OTHER PROJECT DRAWINGS, CONSTRUCTION NOTES AND/OR PROJECT SPECIFICATION. ALL DISCREPANCIES SHOULD BE REPORTED IMMEDIATELY.

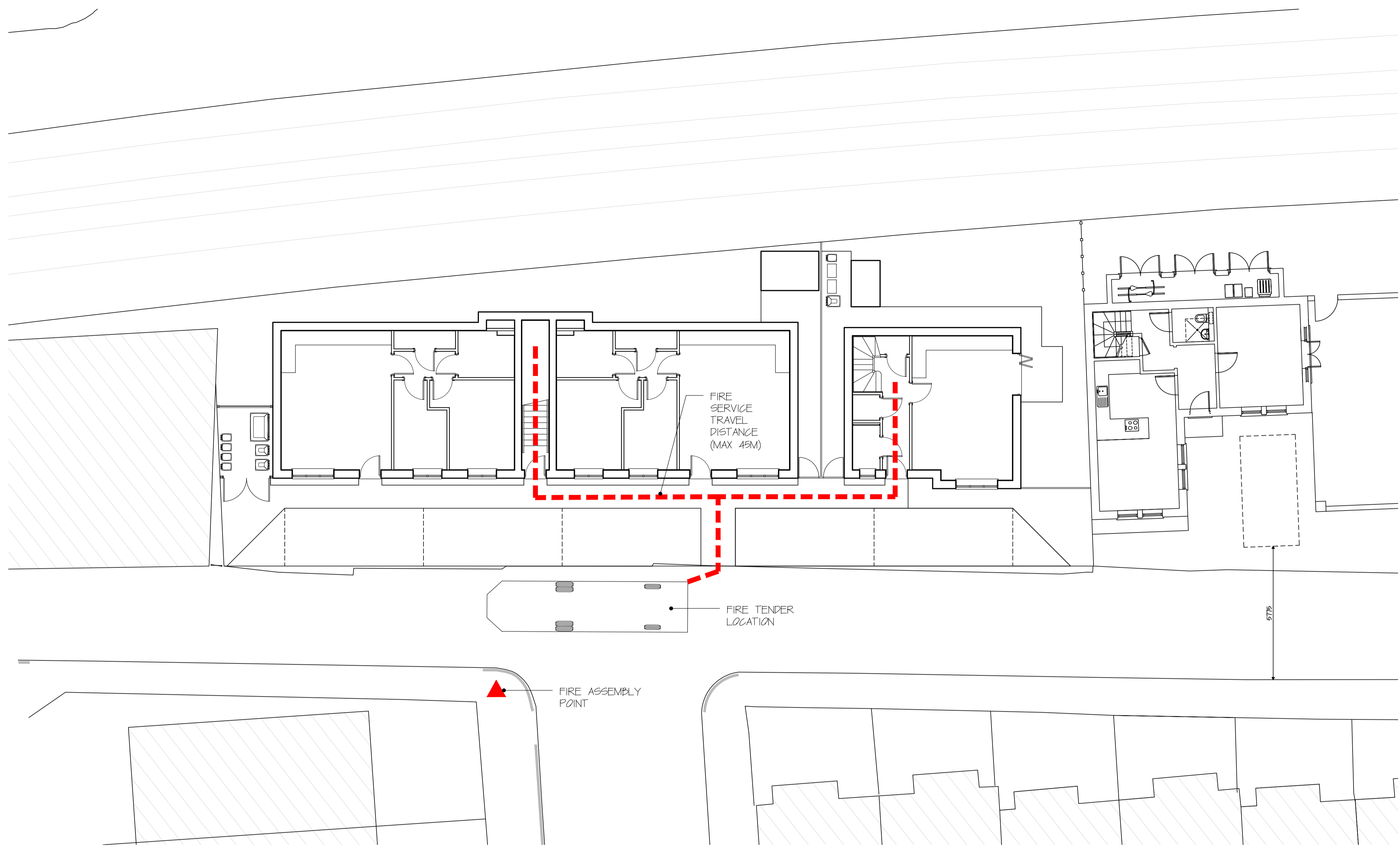

Rev	Date	Details	Drawn

Client:

BIRCHWOOD
HOMES
01932 832277

Site Address:
SOUTH WORPLE WAY
EAST SHEEN, LONDON

Description:
FIRE SAFETY PLAN

Status:	PLANNING		
Date:	NOV 2022	Scale:	1:100@A1
Drawn:	MN	Checked:	TCA
Job Number:	1332	Drawing Number:	06
		Revision:	-

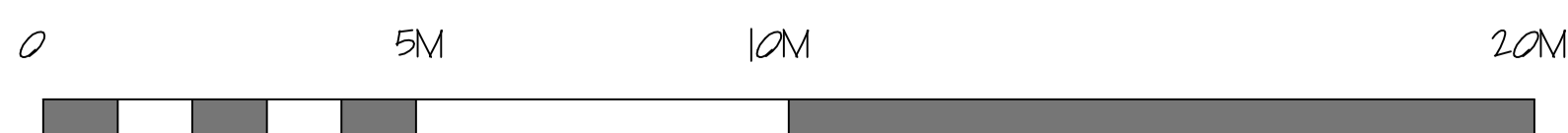
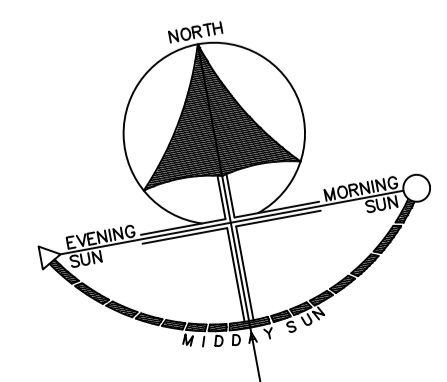

TCA
ARCHITECTURAL
DESIGN

Dorset House,
297-299 Kingston Road,
Leatherhead,
KT22 7PL
Tel: 01372 466443
Email: info@tcalimited.com
www.tcalimited.com

THIS DRAWING IS THE COPYRIGHT OF TAYLOR COX ASSOCIATES AND MUST NOT BE USED IN CONJUNCTION WITH ANY OTHER PROJECT WITHOUT WRITTEN CONSENT.