

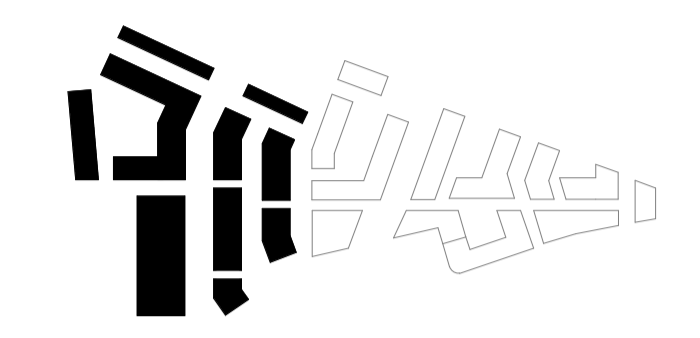

NOTES:
DO NOT SCALE FROM THIS DRAWING. ALL DIMENSIONS TO BE CHECKED ON SITE. ALL OMISSIONS AND DISCREPANCIES TO BE REPORTED TO THE ARCHITECT IMMEDIATELY.

ALL RIGHTS RESERVED. THIS WORK IS COPYRIGHT AND CANNOT BE REPRODUCED OR COPIED OR MODIFIED IN ANY FORM OR BY ANY MEANS, GRAPHIC ELECTRONIC OR MECHANICAL, INCLUDING PHOTOCOPIING WITHOUT THE WRITTEN PERMISSION OF SQUIRE AND PARTNERS ARCHITECTS.

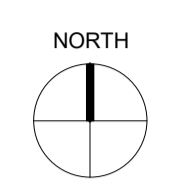

NOTE: UNIT MIX AND LAYOUT FOR DEVELOPMENT AREA 2 IS INDICATIVE AT THIS STAGE

NOTE:
[Red dashed line] WHEELCHAIR ACCESSIBLE UNIT / CONVERTIBLE UNIT

- Studio
- 1B2P
- 2B3P
- 2B4P
- 3B6P
- 4B8P
- 1B2P INT
- 3B5P SR
- 3B6P SR
- 4B7P SR
- SCHOOL

UPDATED AFFORDABLE HOUSING OFFER	24/04/23	RKB	G
AFFORDABLE HOUSING OFFER	08/02/23	RKB	F
LBRUT 2 APPLICATION AMENDMENTS	21/07/22	BJ	D
LBRUT 2 APPLICATION	25/02/22	BJ	E
GLA SUBMISSION	27/04/20	BJ	C
DRAFT GLA SUBMISSION	24/01/20	KH	B
FINAL DRAFT PLANNING APPLICATION	21/10/19	KH	A
LEGAL REVIEW	13/09/19	KH	-

Revision description	Date	Check	Rev

SQUIRE & PARTNERS

The Department Store
248 Ferndale Road London SW9 8FR
T: 020 7278 5555 F: 020 7239 0495

info@squireandpartners.com
www.squireandpartners.com

Project
Stag Brewery
Richmond

PROPOSED DEVELOPMENT AREA 2 TYPICAL LEVEL PLAN

Drawn	Date	Scale
RKL	18/01/18	1:500 @ A1 1:1000 @ A3
Job Number	Drawing number	Revision
18125	C645_Z2_P_TY_001	G

