

Spa Complex Timber Windows and Door Schedule					
Element ID	SW 1.01	SW 1.02	SW 1.03	SW 1.04	SW 1.05
Structural Opening (W x H)	261x925	8,514x925	358x925	3,115x2,300	3,095x925
Elevation View					

Spa Complex Timber Windows and Door Schedule					
Element ID	SW 1.06	SW 1.07	SW 1.08	SW 1.09	SW 1.10
Structural Opening (W x H)	2,840x2,138	3,869x925	2,882x2,300	2,882x925	1,720x925
Elevation View					

Spa Complex Timber Windows and Door Schedule				
Element ID	SW 1.11	SW 1.12	SW 1.13	SW 1.14
Structural Opening (W x H)	8,424x925	2,611x900	8,955x900	2,609x900
Elevation View				

**General Notes**  
THIS DRAWING IS © CUBE DESIGN LTD  
CONTRACTORS MUST CHECK ALL DIMENSIONS ON SITE. ONLY FIGURED DIMENSIONS ARE TO BE WORKED FROM. DISCREPANCIES MUST BE REPORTED TO THE ARCHITECT BEFORE PROCEEDING  
WHEN THIS DRAWING IS ISSUED IN DWG FORMAT CUBE DESIGN TAKE NO RESPONSIBILITY OR LIABILITY FOR THE USE AND/OR ADJUSTMENT OF THESE LAYOUTS BY A THIRD PARTY. THE USE OF THIS INFORMATION IS AT THE USER'S RISK.  
CUBE DESIGN LTD DRAWINGS ARE PRODUCED IN COLOUR. DRAWINGS SHOULD BE PRINTED AND/OR VIEWED IN COLOUR.  
STRUCTURAL INFORMATION TAKEN FROM STRUCTURAL ENGINEERS - THORPE ENGINEERING CONSULTANTS LTD.

**NOTES**

Dimensions provided are for tender purposes only. Subcontractor MUST complete a site survey to confirm window, external door sizes. SCHEDULE TO BE READ IN CONJUNCTION WITH SPECIFICATION CLAUSES, L10, L20 AND L40.

Windows & Door frames to be Hardwood timber construction. All units to accommodate a double glazed unit

Blue Hatch indicates Solid Glazed Spandrel panel

**CDM RISKS**

- Protection of members of public, the client and others. Secure site using hoarding, net scaffolds and robust chutes
- Working from height. Ensure prevention of people and or materials falling from height. Ensure suitable edge protection, guard rails, and toe boards in place. Fall restraint systems to be used as necessary. Ensure fragile roof surfaces are covered, secure working platforms with guard rails.
- Heavy lifting. Avoid manual handling if possible. Ensure manual handling procedures are in place.
- Awareness of working in and around open trenches. Shoring excavations, cover or barrier excavations to prevent falls
- Supporting structures inc walls and beams and roofs with props, ensure props are installed by a competent person
- Turn electricity off and other services before drilling into walls. Do not use excavators or power tools near known or suspected buried services

REV	DATE	DESCRIPTION	DRWN	CHKD
A	01/05/2020	First Issue External Glazing package	AA	JLS
B	13/07/2020	Timber Window & Door sizes updated - Marker References Changed	AA	JLS
C	25/08/2020	SW111 Window size updated	AA	JLS
D	29/09/2020	Protected Fire rated Glazing added	AA	JLS

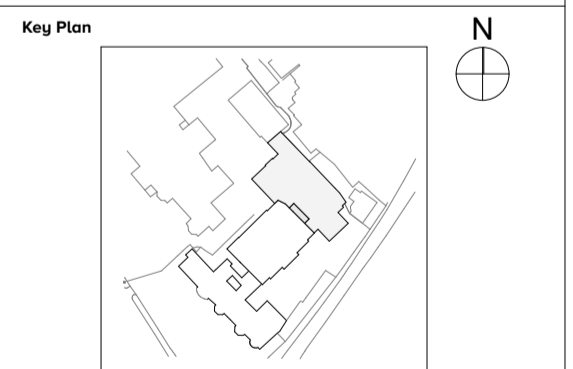

**cube design**  
architecture interior design graphics  
Unit 12, Headlands Business Park, Salisbury road  
Ringwood, Hampshire, BH24 3PB  
T: 01425 481 999  
e-mail: mail@cube-designltd.co.uk  
www.cube-designltd.co.uk

**PROJECT**  
Richmond Harbour Hotel  
152-158 Richmond Hill Richmond Upon Thames  
TW10 6RP Surrey

**DRAWING TITLE**  
First Floor Double Glazed Timber Window Schedule

**STATUS**  
Tender

**DATE DRAWN**  
29/09/2020

**SCALE**  
1:1@A1

**DRAWING NUMBER**  
project | originator | role | zone | level | type | number | rev

1354 - CDL - A - 01 - 01 - DR - 31101 D