

**TOWN AND COUNTRY PLANNING ACT 1990**

**TREE PRESERVATION ORDER T1090**

The London Borough of Richmond upon Thames, in exercise of the powers conferred on them by sections 198 of the Town and Country Planning Act 1990 make the following order –

**Citation**

1. This Order may be cited as:  
**TREE PRESERVATION ORDER T1090, 1 SHELDON HOUSE, CROMWELL ROAD, TEDDINGTON**

**Interpretation**

2. (1) In this Order “the authority” means the London Borough of Richmond upon Thames  
(2) In this Order any reference to a numbered section is a reference to the section so numbered in the Town and Country Planning Act 1990 and any reference to a numbered regulation is a reference to the regulation so numbered in the Town and Country Planning (Tree Preservation)(England) Regulations 2012.

**Effect**

3. (1) Subject to article 4, this Order takes effect provisionally on the date on which it is made.  
(2) Without prejudice to subsection (7) of section 198 (power to make tree preservation orders) or subsection (1) of section 200 (tree preservation orders: Forestry Commissioners) and, subject to the exceptions in regulation 14, no person shall –  
(a) cut down, top, lop, uproot, wilfully damage, or wilfully destroy; or  
(b) cause or permit the cutting down, topping, lopping, uprooting, wilful damage or wilful destruction of,  
any tree specified in the Schedule to this Order except with the written consent of the authority in accordance with regulations 16 and 17, or of the Secretary of State in accordance with regulation 23, and, where such consent is given subject to conditions, in accordance with those conditions.

**Application to trees to be planted pursuant to a condition**

4. In relation to any tree identified in the first column of the Schedule by the letter “C”, being a tree to be planted pursuant to a condition imposed under paragraph (a) of section 197 (planning permission to include appropriate provision for preservation and planting of trees), this Order takes effect as from the time when the tree is planted.

Dated this 9<sup>th</sup> day of June 2023 (month and year)

Signed on behalf of the **London Borough of Richmond upon Thames**



.....  
Authorised by the Council to sign in that behalf.

**TOWN AND COUNTRY PLANNING ACT 1990**

**TREE PRESERVATION ORDER T1090  
CONFIRMATION OF ORDER**

This Order was confirmed by the **London Borough of Richmond upon Thames** without modification

on the                                      day of                                      *(month and year)*

*(OR)*

This Order was confirmed by the **London Borough of Richmond upon Thames**, subject to the modifications indicated by *(state how indicated)*,

on the                                      day of                                      *(month and year)*

Signed on behalf of the **London Borough of Richmond upon Thames**

.....  
Authorised by the Council to sign in that behalf.

**DECISION NOT TO CONFIRM ORDER**

A decision not to confirm this Order was taken by the **London Borough of Richmond upon Thames**

on the                                      day of                                      *(month and year)*

Signed on behalf of the **London Borough of Richmond upon Thames**

.....  
Authorised by the Council to sign in that behalf.

**VARIATION OF ORDER**

This Order was varied by the **London Borough of Richmond upon Thames**

on the                                      day of                                      *(month and year)*

by a variation order under reference number *(insert reference number to the variation order)* a copy of which is attached.

Signed on behalf of the **London Borough of Richmond upon Thames**

.....  
Authorised by the Council to sign in that behalf.

**REVOCAATION OF ORDER**

This Order was revoked by the **London Borough of Richmond upon Thames**

on the                                      day of                                      *(month and year)*

Signed on behalf of the **London Borough of Richmond upon Thames**

.....  
Authorised by the Council to sign in that behalf.

TOWN AND COUNTRY PLANNING ACT 1990

TREE PRESERVATION ORDER T1090  
SCHEDULE

Specification of trees

**Trees specified individually**  
(encircled in black on the map)

Reference on map	Description	Situation
T1	Cedar	Centered on grid ref: (E) 516282 (N) 170633
T2	Oak Tree	Centered on grid ref: (E) 516284 (N) 170627
T3	Sweet Chestnut	Centered on grid ref: (E) 516271 (N) 170607
T4	Lime Tree	Centered on grid ref: (E) 516266 (N) 170600
T5	Lime Tree	Centered on grid ref: (E) 516265 (N) 170597
T6	Lime Tree	Centered on grid ref: (E) 516261 (N) 170591
T7	Cedar	Centered on grid ref: (E) 516255 (N) 170599
T8	Lime Tree	Centered on grid ref: (E) 516251 (N) 170618
T9	Yew	Centered on grid ref: (E) 516251 (N) 170631
T10	Birch Tree	Centered on grid ref: (E) 516250 (N) 170641

**TOWN AND COUNTRY PLANNING ACT 1990**

**TREE PRESERVATION ORDER T1090**

**Trees specified by reference to an area**  
(within a dotted black line on the map)

**Groups of trees**  
(within a broken black line on the map)

**Woodlands**  
(within a continuous black line on the map)

**TOWN AND COUNTRY PLANNING ACT 1990**

**TREE PRESERVATION ORDER T1090**

**Application Number**  
**Description**  
**Location**

T1090  
**TREE PRESERVATION ORDER T1090**  
1 Sheldon House  
Cromwell Road  
Teddington  
TW11 9EJ

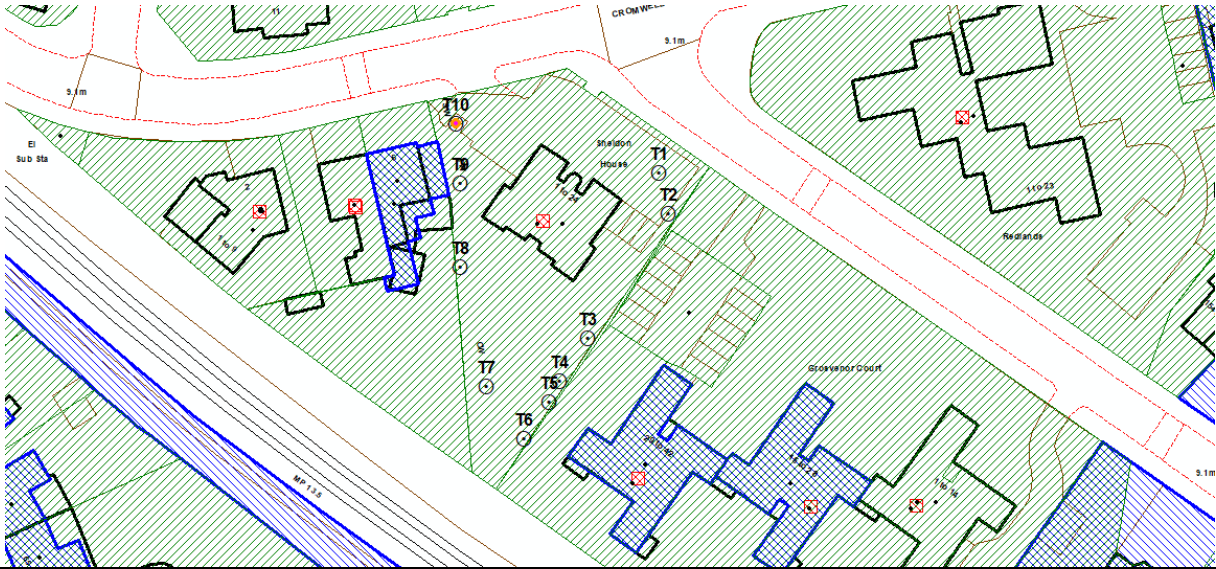

<p>Reproduced by permission of Ordnance Survey on behalf of HMSO. (C) Crown Copyright and database right 2011. All Rights Reserved. Ordnance Survey License number 100019441</p>	<p>Scale 1:625</p>	<p>North</p> 
--	--------------------	--