

rev	details	by	date
00	For information	AP	07.11.2018
01	For Planning	AP	29.01.2019
02	Inclusion of play areas	AP	28.03.2019
03	Revised play areas	GP	16.04.2019
04	Revised tree planting	GP	08.05.2019
05	Updated for addendum submission	PC	22.11.2019
06	Updated to revised Block E design	PC	08.01.2020
07	Issued as draft for review	PC	17.07.2020
08	Issued for planning	PC	24.07.2020
09	Red line update	CC	10.11.2021
10	Refuse store update	CC	15.11.2021
11	Flooding update	PC	10.11.2022
12	Addendum issue	PC	14.11.2022
13	Updated to comments	PC	18.11.2022
14	Updated to comments	MH	14.12.2022
15	Updated to comments	MP	05.01.2023
16	Updated GF door positions	MP	17.03.2023

Notes

1.0 Do not scale from drawing, use figured dimensions only
 1.1 All dimensions to be checked onsite
 1.2 This drawing to be read in conjunction with all other Gillespies drawings and specifications

GENERAL

	Concrete flags		Lawn
	Granite paving with frame		Proposed amenity planting mix
	Granite slabs		Proposed rain garden planting mix
	Granite setts		Proposed native buffer planting mix
	Asphalt		Existing Trees
	Resin bound paving		Proposed Trees
	High quality concrete block paving		Planning Boundary
	Private terraces		0-4 Play space Total: 721m ²
	Reinforced grass		5-11 Play space Total: 505m ²
	Existing paving retained		Existing surface level
	Stepping stones		Proposed surface level
	Seating elements		Surface gradient
	Play elements		
	2.4m Height Gates and Fences		
	Proposed timber fence infill		
	2.4m max brick screen wall with climber planting		
	Cycle stands		
	Step with handrails and tactile paving to meet part M		

Project title

Manor Road Richmond

Drawing title

Landscape General Arrangement

PLANNING	Drawing status	Scale	Drawn
		1:500 @ A1	GP
		Date	Checked
		13.10.2022	RC
	Drawing number	Revision	
	P11559-00-001-100		16

Client

Avaton

56 Queen Anne Street,
Luton, W10 3JA

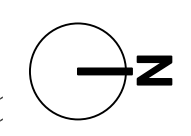
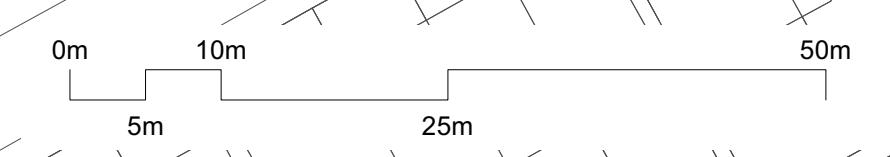
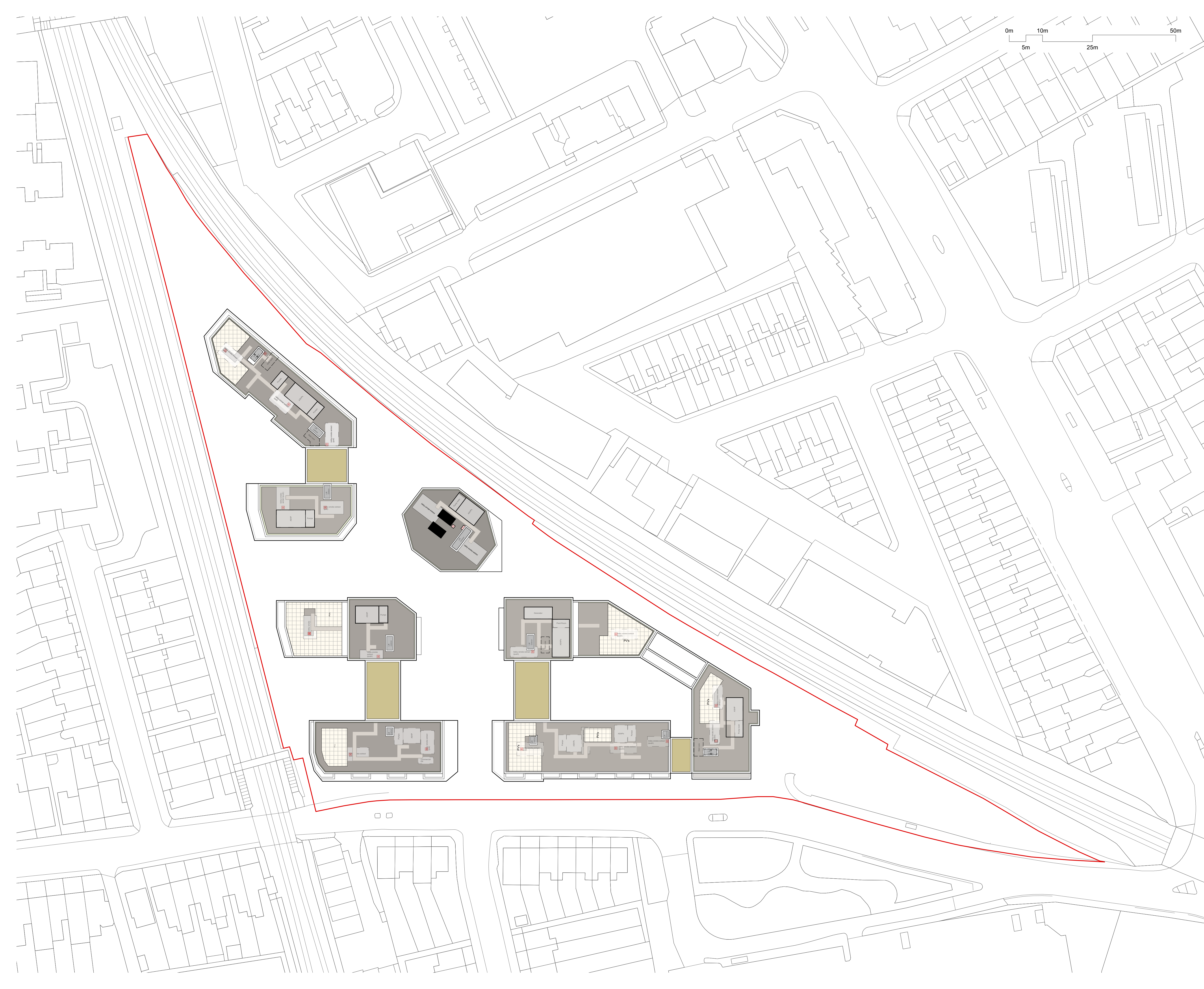

General notes

All setting out must be checked on site
 All levels must be checked on site and refer to Ordnance Datum Newlyn unless alternative Datum given
 All fixings and weatherings must be checked on site
 This drawing must not be scaled
 This drawing must be read in conjunction with all other relevant drawings, specification clauses and current design risk register
 This drawing must not be used for land transfer purposes
 Calculated areas in accordance with Assael Architecture's Definition of Areas for Schedule of Areas
 This drawing must not be used on site unless issued for construction
 Subject to survey, consultation and approval from all statutory Authorities

Revision Status:
 P=Preliminary
 C=Contract

© 2019 Assael Architecture Limited

Assael Architecture Limited has prepared this document in accordance with the instructions of the Client under the agreed Terms of Appointment. This document is for the sole and specific use of the Client and Assael Architecture shall not be responsible for any use of its contents for any purpose other than that for which it was prepared and provided. Should the Client require to pass electronic copies of the document to other parties, this should be for co-ordination purposes only; the whole of the file should be so copied, but no professional liability or warranty shall be extended to other parties by Assael Architecture in this connection without the explicit written agreement thereto by Assael Architecture Limited.

Drawing notes

Electronic file reference
 MNR-AA-SK-230315HB02

Status	R	Revision	Date	DRN	CHK	CDM
27	For Planning		05/04/23	HB	HB	
28	For Information		22/05/23	KC	KC	
29	For Planning		26/05/23	KC	KC	

- Key:
- Green/brown roofs
 - PV panels
 - ASHPs and Plant
 - Shared Communal Terraces

- Purpose of information
- The purpose of the information on this drawing is for:
- Planning
 - Information
 - Comment
 - Client approval
 - Construction
- All information on this drawing is not for construction unless it is marked for construction.



Client

Avanton

Project title

**A3004
 Manor Road Richmond**

Drawing title

**GA Plans Proposed
 Roof Plan**

Scale @ A1 size Date

1:500 July '20

Drawing N°

MNR-AA-ALL-11-DR-A-2011

Status & Revision

R29

