

**General notes**

All setting out must be checked on site  
 All levels must be checked on site and refer to  
 Ordnance Datum Newlyn unless alternative Datum given  
 All fixings and weatherings must be checked on site  
 All dimensions must be checked on site  
 This drawing must not be scaled  
 This drawing must be read in conjunction with all other  
 relevant drawings, specification clauses and current design risk  
 register.  
 This drawing must not be used for land transfer purposes  
 Calculated areas in accordance with Assael Architecture's  
 Definition of Areas for Schedule of Areas  
 This drawing must not be used on site unless issued for  
 construction  
 Subject to survey, consultation and approval from all statutory  
 Authorities

**Revision Status:**  
 P=Preliminary  
 C=Contract

© 2019 Assael Architecture Limited

Assael Architecture Limited has prepared this document in  
 accordance with the instructions of the Client under the agreed  
 Terms of Appointment. This document is for the sole and specific  
 use of the Client and Assael Architecture shall not be responsible  
 for any use of its contents for any purpose other than that for  
 which it was prepared and provided. Should the Client require to  
 pass electronic copies of the document to other parties, this  
 should be for co-ordination purposes only; the whole of the file  
 should be so copied, but no professional liability or warranty shall  
 be extended to other parties by Assael Architecture in this  
 connection without the explicit written agreement thereto by  
 Assael Architecture Limited.

**Drawing notes**

**Electronic file reference**  
 MNR-AA-SK-230315HB02

Status	R	Revision	Date	DRN	CHK	CDM
18	For Planning		05/04/23	HB	HB	
19	For information		25/08/23	ED	HB	
20	For Planning		04/09/23	AL	ED	



**Purpose of information**

The purpose of the information on this drawing is for:

Planning   
 Information   
 Comment   
 Client approval   
 Construction

All information on this drawing is not for construction unless it is marked for construction.

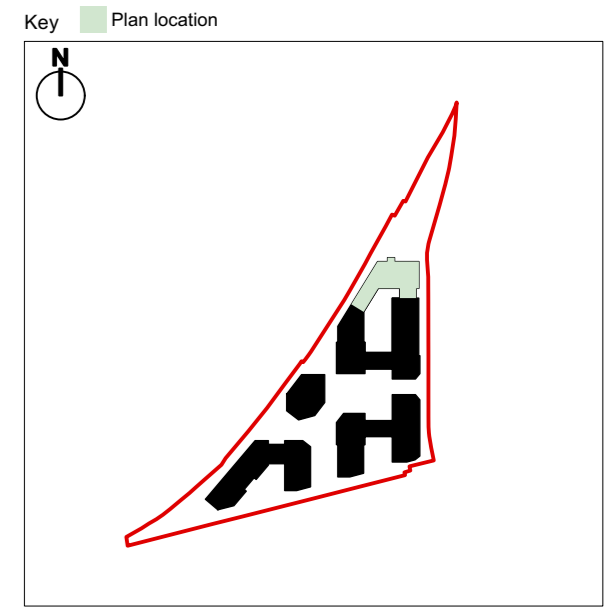

**Client**  
**Avanton**

**Project title**  
**A3004 Manor Road Richmond**

**Drawing title**  
**Block A Plans (North) Proposed First Floor**

**Scale @ A1 size** **Date**  
**1:100** **Aug '23**

**Drawing N°**  
**MNR-AA-BA1-01-DR-A-2101**

**Status & Revision**  
**R20**

**Assael**

Assael Architecture Limited  
 123 Upper Richmond Road  
 London SW15 2TL

+44 (0)20 7736 7744  
 info@assael.co.uk  
 www.assael.co.uk