

**General notes**

All setting out must be checked on site  
 All levels must be checked on site and refer to Ordnance Datum Newlyn unless alternative Datum given  
 All fixings and weatherings must be checked on site  
 All dimensions must be checked on site  
 This drawing must not be scaled  
 This drawing must be read in conjunction with all other relevant drawings, specification clauses and current design risk register  
 This drawing must not be used for land transfer purposes  
 Calculated areas in accordance with Assael Architecture's Definition of Areas for Schedule of Areas  
 This drawing must not be used on site unless issued for construction  
 Subject to survey, consultation and approval from all statutory Authorities

**Revision Status:**  
 P=Preliminary  
 C=Contract

© 2019 Assael Architecture Limited

Assael Architecture Limited has prepared this document in accordance with the instructions of the Client under the agreed Terms of Appointment. This document is for the sole and specific use of the Client and Assael Architecture shall not be responsible for any use of its contents for any purpose other than that for which it was prepared and provided. Should the Client require to pass electronic copies of the document to other parties, this should be for co-ordination purposes only; the whole of the file should be so copied, but no professional liability or warranty shall be extended to other parties by Assael Architecture in this connection without the explicit written agreement thereto by Assael Architecture Limited.

**Drawing notes**

**Electronic file reference**  
 MNR-AA-SK-230315HB02

Status	R:	Revision	Date	DRN	CHK	CDM
17	For Planning		05/04/23	HB	HB	
18	For information		25/08/23	ED	HB	
19	For Planning		04/09/23	AL	ED	

**Purpose of information**

The purpose of the information on this drawing is for:

Planning   
 Information   
 Comment   
 Client approval   
 Construction

All information on this drawing is not for construction unless it is marked for construction.

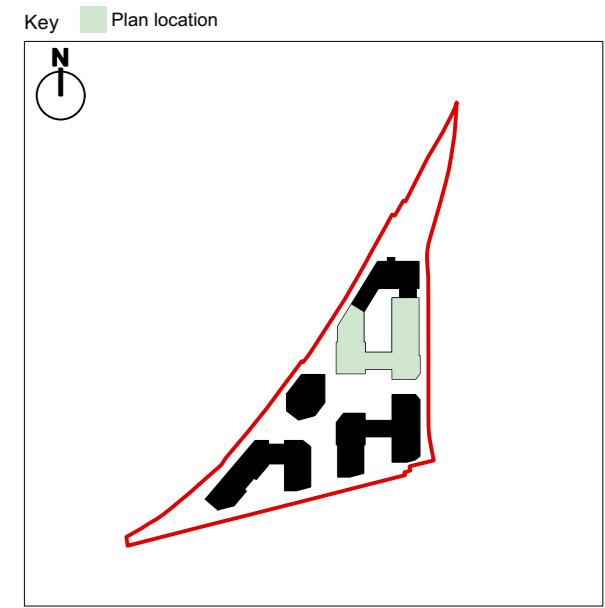

**Client**  
**Avanton**

**Project title**  
**A3004 Manor Road Richmond**

**Drawing title**  
**Block A Plans (South) Proposed Fifth Floor**

**Scale @ A1 size** **Date**  
**1:100** **Aug '23**

**Drawing N°**  
**MNR-AA-BA2-05-DR-A-2205**

**Status & Revision**  
**R19**

