

General notes

All setting out must be checked on site
 All levels must be checked on site and refer to Ordnance Datum Newlyn unless alternative Datum given
 All fixings and weathersheds must be checked on site
 This drawing must not be scaled
 This drawing must be read in conjunction with all other relevant drawings, specification clauses and current design risk register
 This drawing must not be used for land transfer purposes
 Calculated areas in accordance with Assael Architecture's Definition of Areas for Schedule of Areas
 This drawing must not be used on site unless issued for construction
 Subject to survey, consultation and approval from all statutory Authorities

Revision Status:
 P=Preliminary
 C=Contract

© 2019 Assael Architecture Limited

Assael Architecture Limited has prepared this document in accordance with the instructions of the Client under the agreed Terms of Appointment. This document is for the sole and specific use of the Client and Assael Architecture shall not be responsible for any use of its contents for any purpose other than that for which it was prepared and provided. Should the Client require to pass electronic copies of the document to other parties, this should be for co-ordination purposes only; the whole of the file should be so copied, but no professional liability or warranty shall be extended to other parties by Assael Architecture in this connection without the explicit written agreement thereto by Assael Architecture Limited.

Drawing notes

Electronic file reference

MNR-AA-SK-230315HB02

| Status | Revision | Date | DRN | CHK | CDM |
|--------|-----------------|----------|-----|-----|-----|
| 19 | For Planning | 05/04/23 | HB | HB | |
| 20 | For information | 25/08/23 | ED | HB | |
| 21 | For Planning | 04/09/23 | AL | ED | |

Purpose of information

The purpose of the information on this drawing is for:

- Planning
- Information
- Comment
- Client approval
- Construction

All information on this drawing is not for construction unless it is marked for construction.

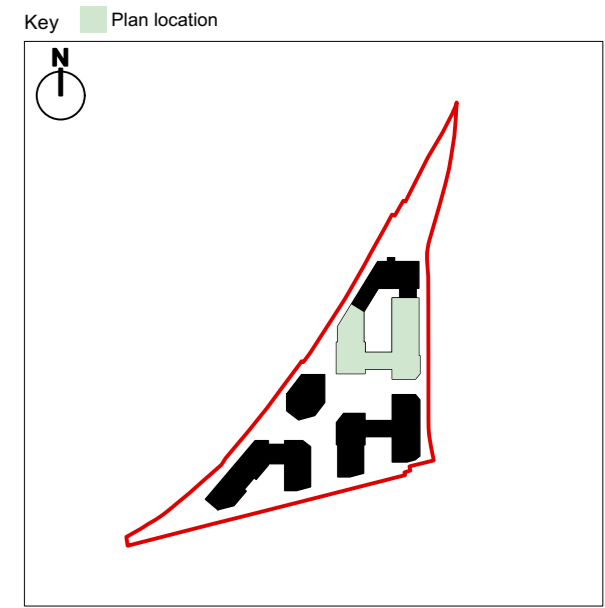

Client
Avanton

Project title
A3004 Manor Road Richmond

Drawing title
Block A Plans (South) Proposed First Floor

Scale @ A1 size Date
1:100 **Aug '23**

Drawing N°
MNR-AA-BA2-01-DR-A-2201

Status & Revision
R21

Assael

Assael Architecture Limited
 123 Upper Richmond Road
 London SW15 2TL

+44 (0)20 7736 7744
 info@assael.co.uk
 www.assael.co.uk