

NOTE:

- Carefully re-fix loose carvings to match existing
- Allow for redecoration of gateway in appropriate finish to compliment the existing structure using paint analysis and historical records to determine the finish.
- Check all copper repousse details and carefully re-fix loose fittings to match existing
- Bird deterrent measures and design to be as unobtrusive as possible.
- Inspect and adjust any raised paving stones to create a level surface, mitigating any trip hazards.

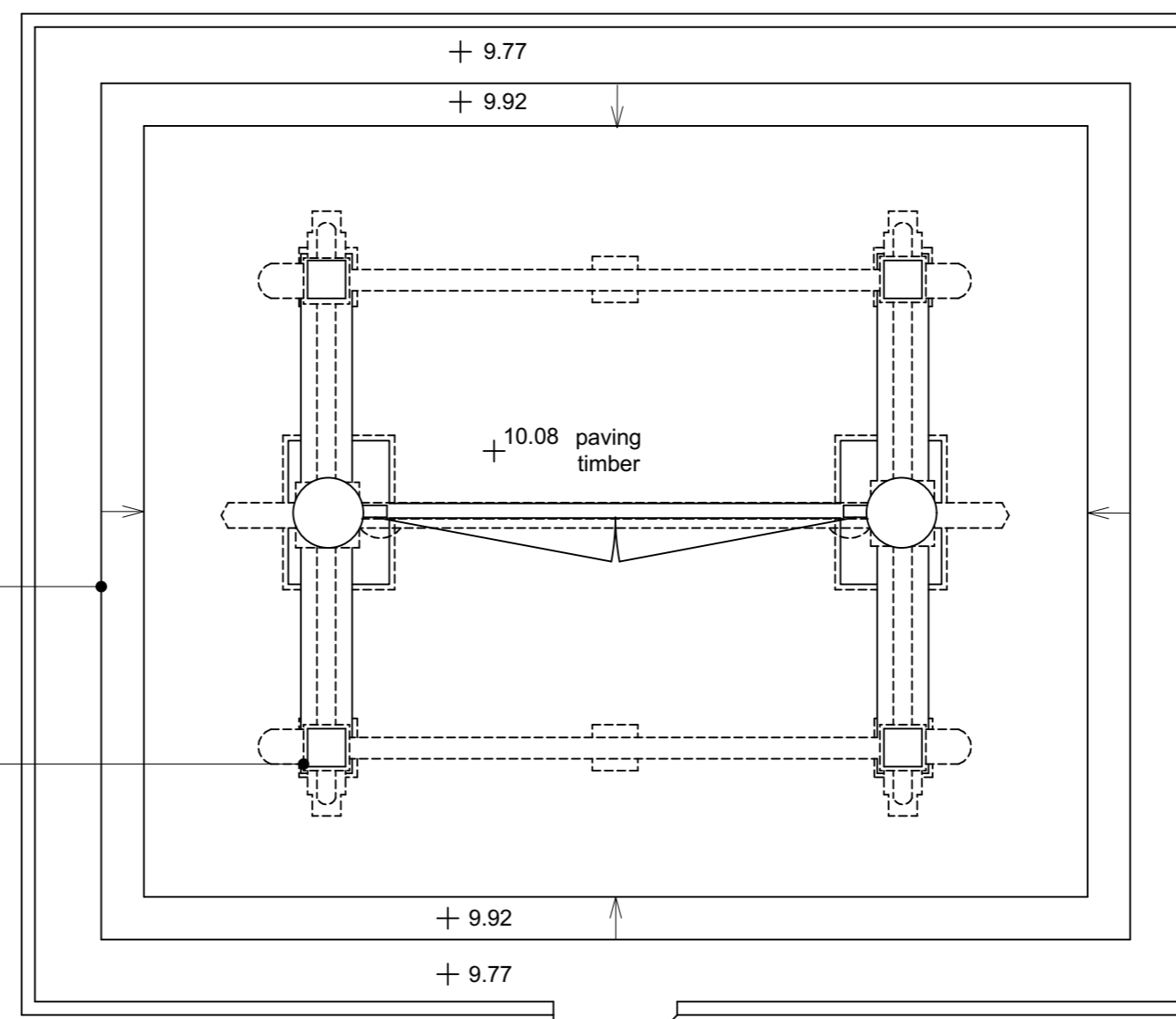

Generally clean paving stones around roof perimeter to remove blue/ green staining caused by copper roof

Carefully re-fix loose timber beam to match existing

Replace missing section of handrail to match existing

GROUND FLOOR PLAN
SCALE - 1:50 @ A1 / 1:100 @ A3

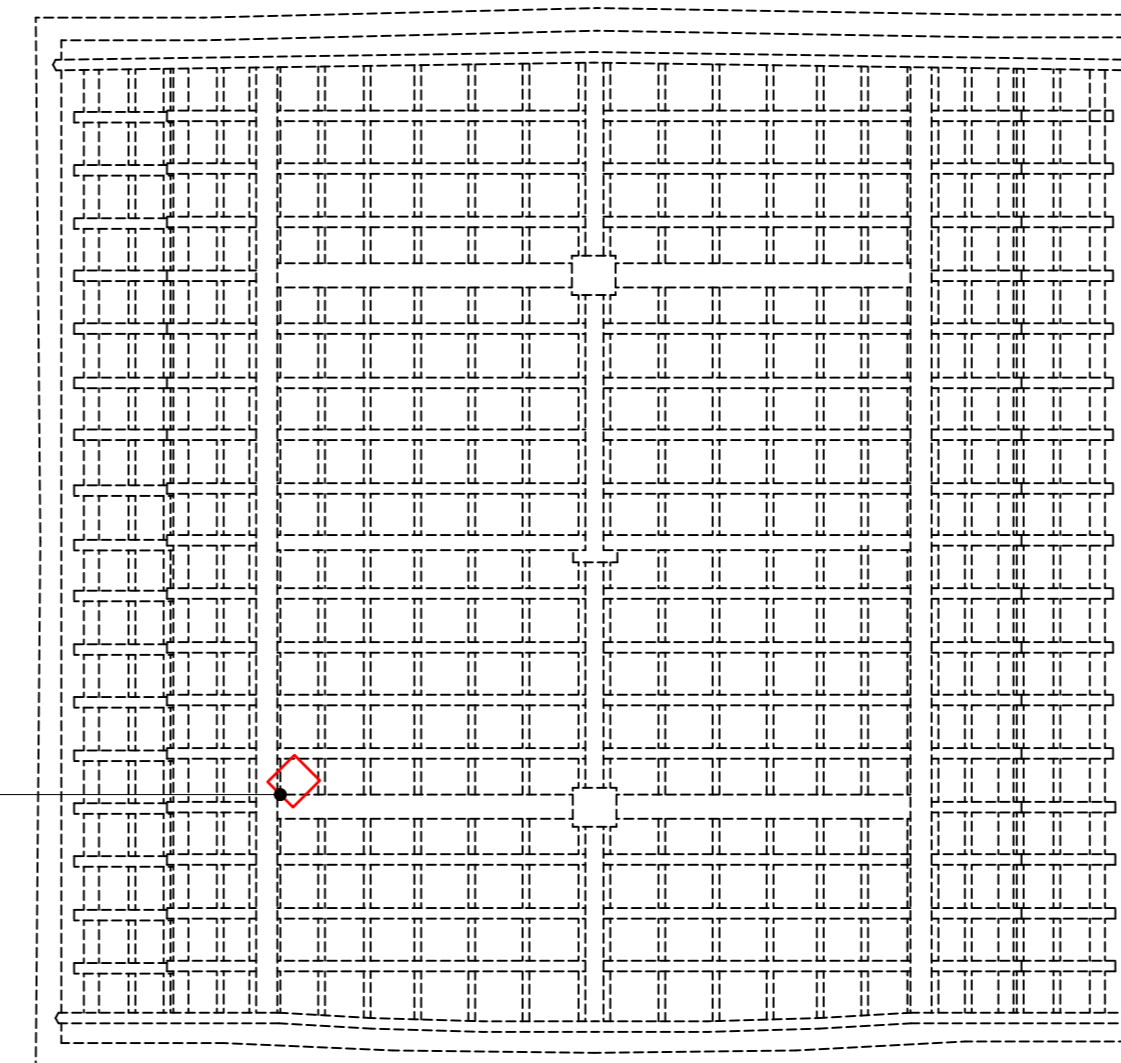

Existing bat box to be retained. Mitigation measures to be agreed with ecologist.

REFLECTED CEILING PLAN
SCALE - 1:50 @ A1 / 1:100 @ A3

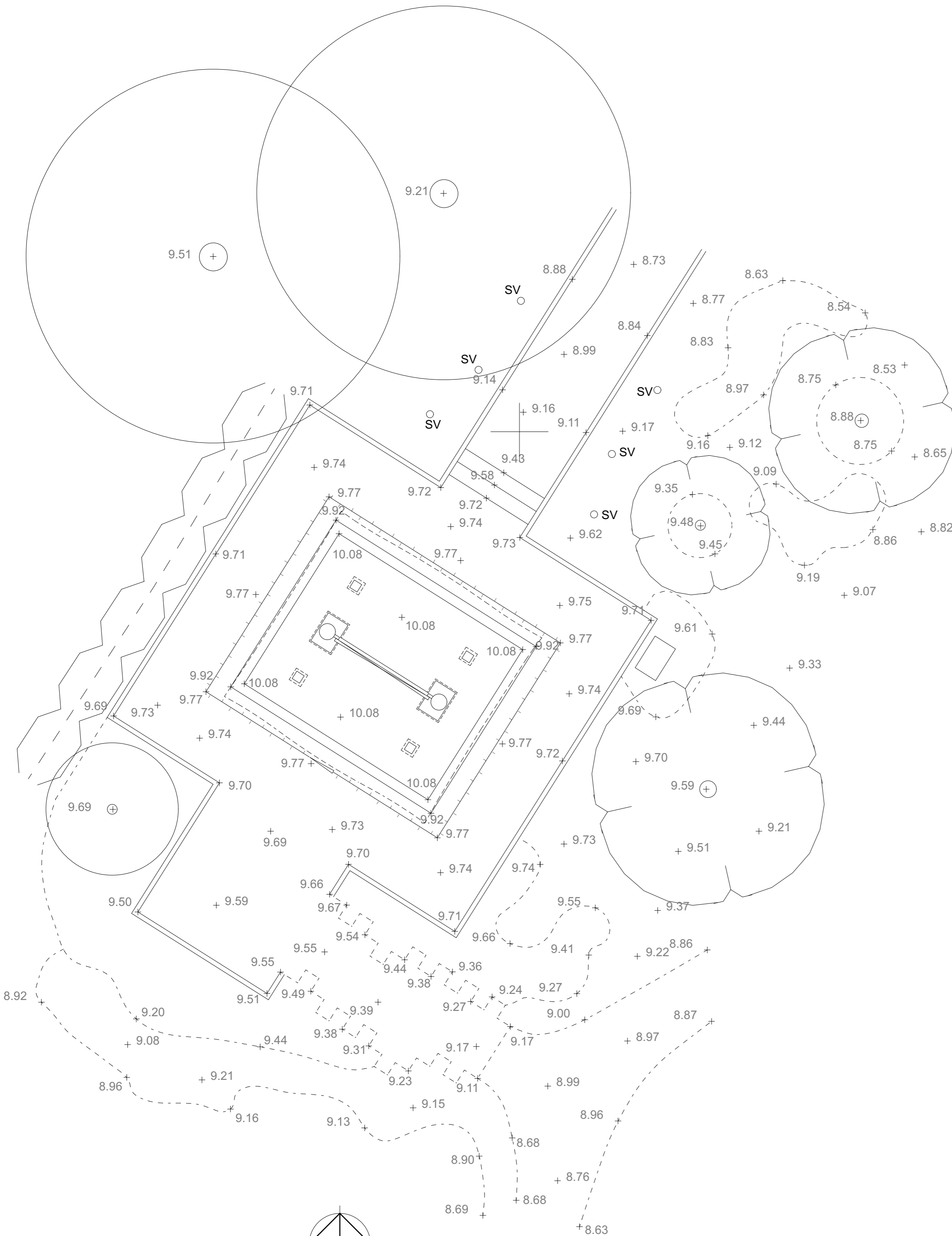

SITE PLAN
SCALE - 1:100 @ A1 / 1:200 @ A3

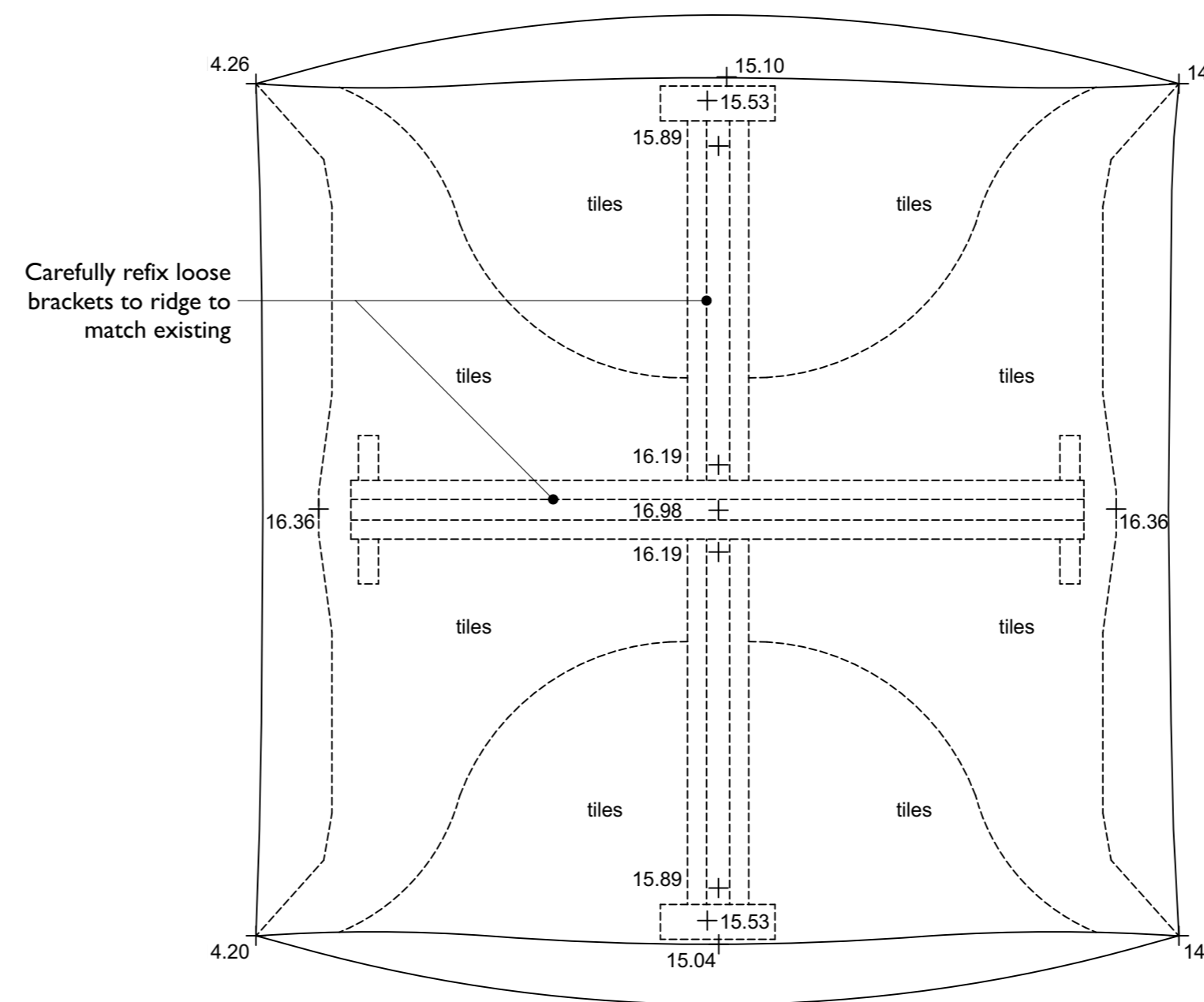

Carefully re-fix loose brackets to ridge to match existing

ROOF PLAN
SCALE - 1:50 @ A1 / 1:100 @ A3

DO NOT SCALE THIS DRAWING USE DIMENSIONS ONLY
VERIFY ALL DIMENSIONS ON SITE BEFORE COMMENCING ANY WORK OR SHOP DRAWINGS
INFORM THE ARCHITECT BEFORE ANY WORK STARTS IF THIS DRAWING EXCEEDS THE QUANTITIES IN ANY WAY

ISSUE STATUS: For Planning

Revision A Date 05/01/2024 Title block amended

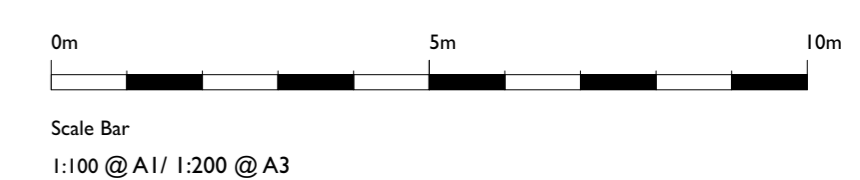
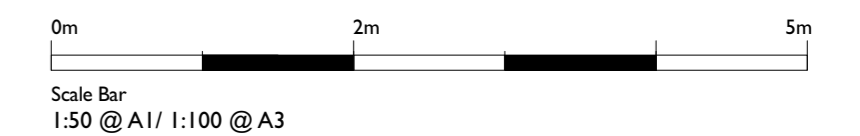

CLIENT
Royal Botanic Gardens Kew

PROJECT
Japanese Gateway

TITLE
As Proposed Plans

SCALE AS NOTED DATE 18/08/2023 DRAWN JBY

JOB N° 23_082 DRAWING N° 210A

www.clewsarchitects.co.uk architects@clewsarchitects.co.uk ©

