

PRIOR TO THE COMMENCEMENT OF ANY WORKS, THE BUILDER IS TO CHECK AND/OR DETERMINE ALL CONSTRUCTION DETAILS, INCLUDING CHECKING EXISTING SITE LEVELS AND DIMENSIONS. THE DRAWING IS TO BE READ IN CONJUNCTION WITH ALL OTHER PROJECT DRAWINGS, CONSTRUCTION NOTES AND/OR PROJECT SPECIFICATION. ALL DISCREPANCIES SHOULD BE REPORTED IMMEDIATELY.

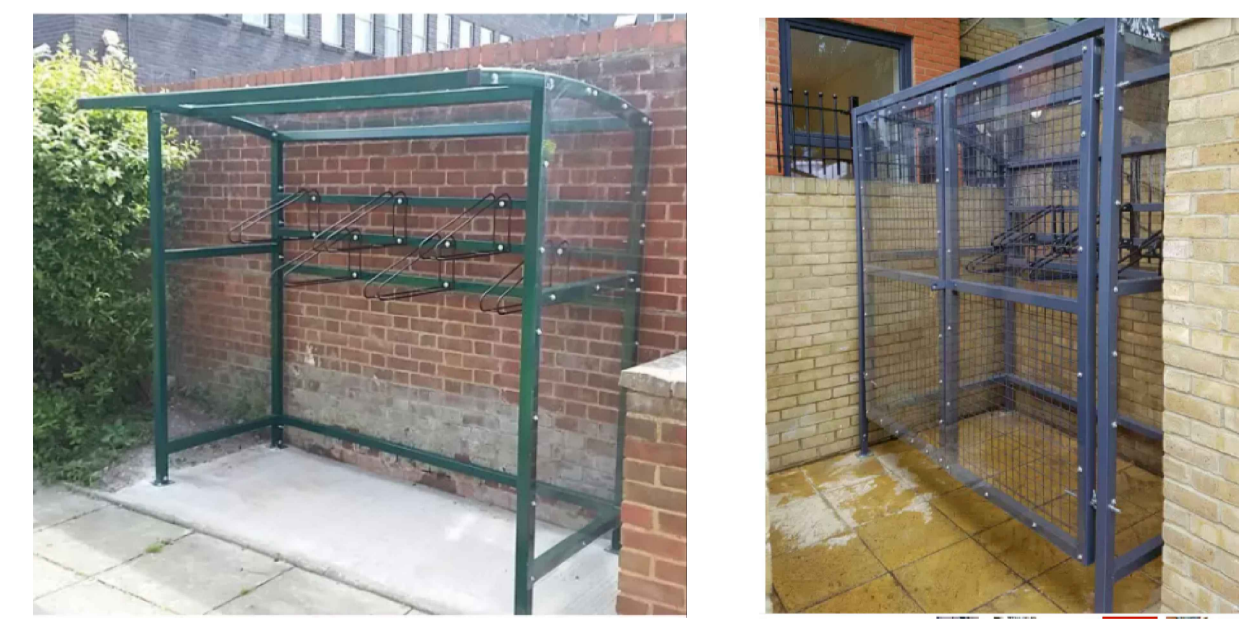

INDICATIVE IMAGE OF PROPOSED COMMUNAL CYCLE STORE

**WASTE CALCULATIONS**  
 IN ACCORDANCE WITH LONDON BOROUGH OF RICHMOND REFUSE AND RECYCLING STORAGE REQUIREMENTS' FOR ONE 2 BEDROOM HOUSE THE FOLLOWING SHOULD BE PROVIDED:  
 240L REFUSE  
 102L DRY RECYCLING (2 NO 55 LITRE RECYCLING BOXES)  
 29L FOOD PER UNIT  
 FOR FOUR 2 BEDROOM FLATS THE FOLLOWING SHOULD BE PROVIDED:  
 560L REFUSE (BASED ON 70 LITRES PER BEDROOM)  
 480L DRY RECYCLING (1 NO 240 LITRE BIN FOR MIXED PAPER AND 1 NO 240 LITRE BIN FOR MIXED CONTAINERS)  
 29L FOOD PER UNIT

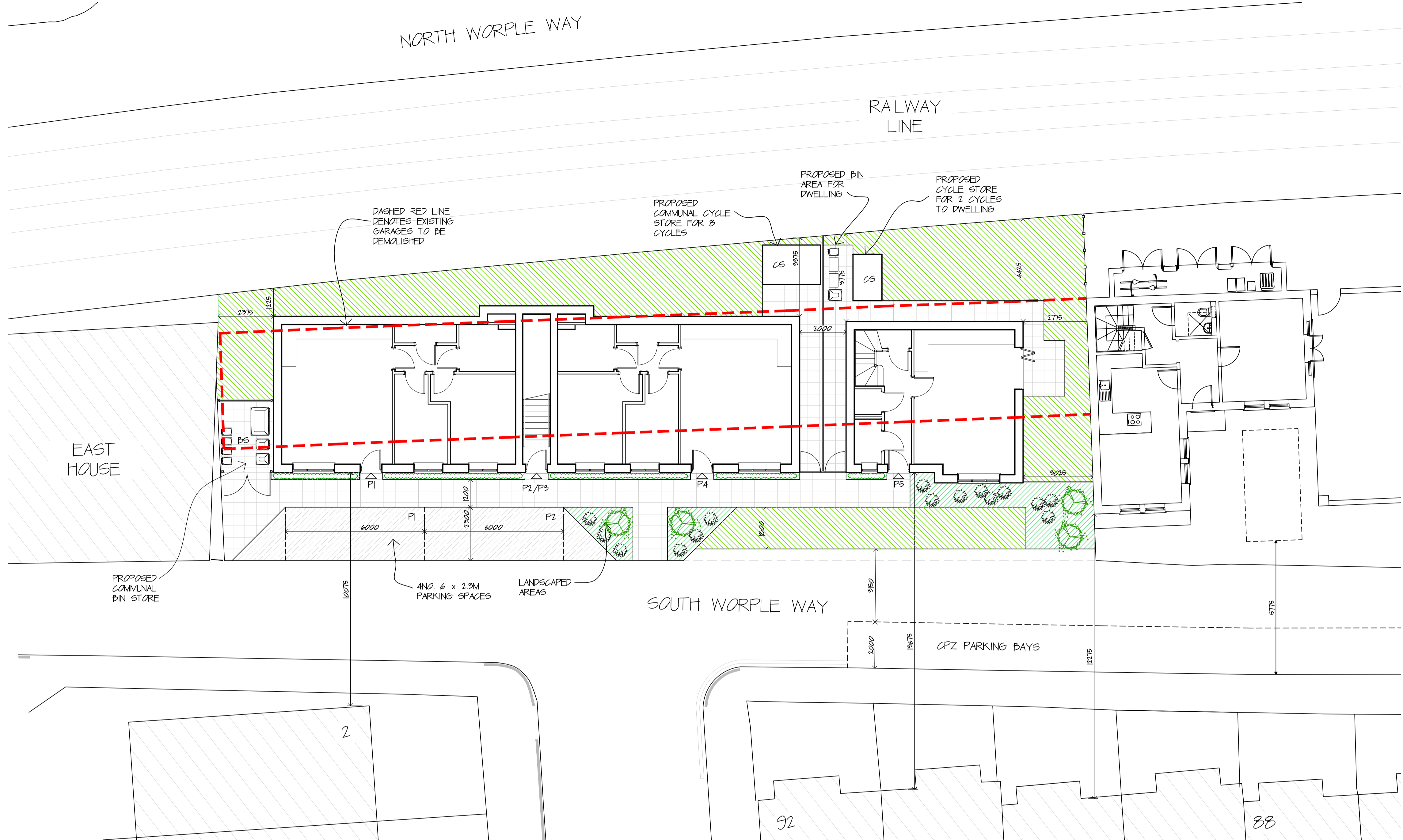
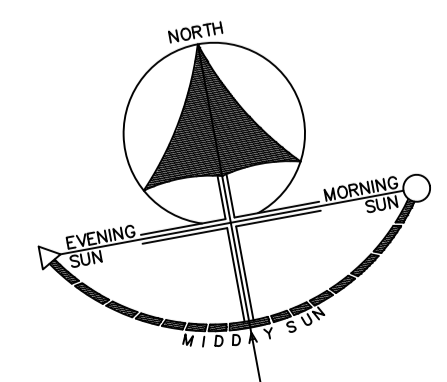

Rev	Date	Details	Rev	Date	Details
A	05.02.24	PARKING SPACES 3 & 4 OMITTED TO ALLOW FOR FIRE BRIGADE ACCESS FOLLOWING DISCUSSIONS WITH PLANNERS.	JC		
					Drawn



Site Address:  
 SOUTH WORPLE WAY  
 EAST SHEEN, LONDON

Description:  
 PROPOSED SITE PLAN

Status:	PLANNING		
Date:	NOV 2022	Scale:	1:100@A1
Drawn:	MN	Checked:	TCA
Job Number:	1332	Drawing Number:	03
		Revision:	A



Dorset House,  
 297-299 Kingston Road,  
 Leatherhead,  
 KT22 7PL  
 Tel: 01372 466443  
 Email: info@tcalimited.com  
 www.tcalimited.com

THIS DRAWING IS THE COPYRIGHT OF TAYLOR COX ASSOCIATES AND MUST NOT BE USED IN CONJUNCTION WITH ANY OTHER PROJECT WITHOUT WRITTEN CONSENT.