

1 Main Building - Basement Existing
1 : 200

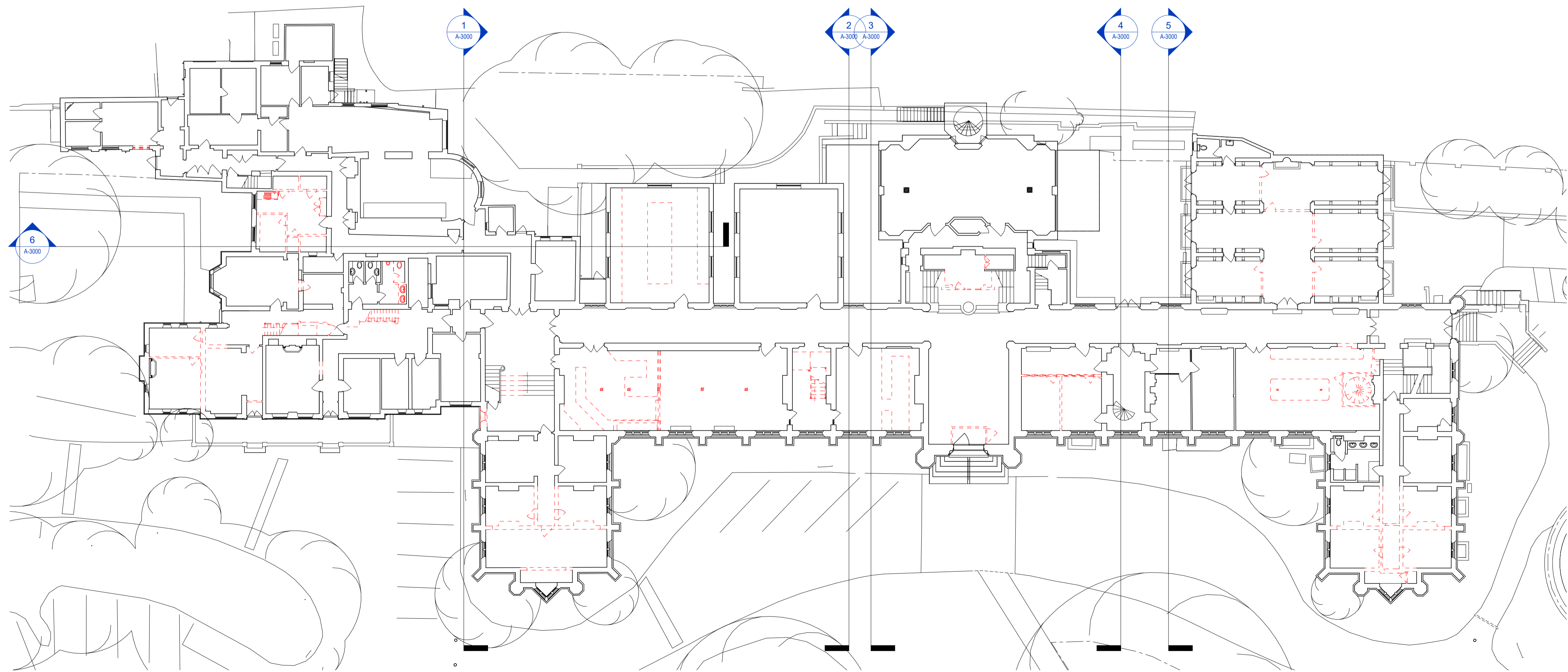

2 Main Building - Ground Floor Existing
1 : 200

P01	Planning Issue	16.02.24
-----	----------------	----------

REV	DESCRIPTION	DATE
-----	-------------	------

IID Architects
Richmond Place
15 Petersham Road
Richmond
TW10 6TP
info@iid.co.uk
020 3274 1100
www.iid.co.uk

CLIENT
Thomas's London Day Schools

PROJECT
Thomas's College

DRAWING TITLE
**Main Building - Existing
Basement & Ground Floor
Plans**

SCALE: 1 : 200 @ A1

DRAWING NUMBER	REV
1714 IID PL XX DR A-1010 P01	