

### GENERAL NOTES

- THIS DRAWING IS TO BE READ IN CONJUNCTION WITH ALL ENGINEER'S, ARCHITECT'S OR OTHER RELEVANT DRAWINGS AND SPECIFICATIONS.
- ALL DIMENSIONS AND LEVELS ARE TO BE CHECKED ON SITE BY THE CONTRACTOR PRIOR TO PREPARING ANY WORKING DRAWINGS OR COMMENCING ON SITE.
- THE CONTRACTOR MUST ENSURE AND WILL BE HELD RESPONSIBLE FOR THE OVERALL STABILITY OF THE BUILDING/STRUCTURE/EXCAVATION AT ALL STAGES OF THE WORK.
- ALL WORK BY THE CONTRACTOR MUST BE CARRIED OUT IN SUCH A WAY THAT ALL REQUIREMENTS UNDER THE HEALTH AND SAFETY AT WORK ACT ARE SATISFIED.
- ALL WORK IS TO BE CARRIED OUT IN COMPLIANCE WITH THE REQUIREMENTS OF THE RELEVANT STATUTORY AUTHORITIES AND REGULATIONS.
- EXISTING DRAINAGE LAYOUT BASED ON THAMES WATER SEWER RECORDS AND PENBORN TECHNICAL SERVICES DRAWING (REF P979/07/31).
- EXISTING FOUL AND SURFACE WATER CONNECTIONS TO BE RE-USED WHERE FEASIBLE, SUBJECT TO DETAILED DESIGN.
- GREEN ROOFS AND WATER BUTTS ARE TO BE INCORPORATED ACROSS THE SITE TO PROVIDE SOURCE CONTROL AND FACILITATE WATER REUSE. THE PROPOSED LOCATION OF GREEN ROOFS CAN BE FOUND ON THE SITEWIDE URBAN GREEN FACTOR DRAWING (P10736-00-004-GIL-0802), WHICH IS AVAILABLE IN APPENDIX K OF THE DRAINAGE STRATEGY REPORT. THE PROPOSED LOCATION OF WATER BUTTS IS TO BE DETERMINED AT DETAILED DESIGN STAGE BUT CAN BE INDICATIVELY ASSUMED BASED ON THE LOCATION OF THE DEVELOPMENT BLOCKS, AS SHOWN WITHIN THE DEVELOPMENT PROPOSALS.

REV	SO	28.07.22	ISSUED	SW	BM
Status	Date	Description		By	Chk

Amendments

## STAG BREWERY

### PROPOSED SURFACE WATER DRAINAGE STRATEGY

Client  
**RESELTON PROPERTIES LIMITED**



Office Address  
 Telephone & Fax numbers  
 mail@watermangroup.com www.watermangroup.com

Suitability  
**INITIAL STATUS (WIP)** SO

Designed By	Designer	Director	BM	Waterman Ref	IProjec
Drawn By	SW	Date	August 2022	Scales @ A3	1:25,000

Project - Originator - Volume - Level - Type - Role - Number	Revision
18671-WIE-ZZ-ZZ-DR-D-92001	P01

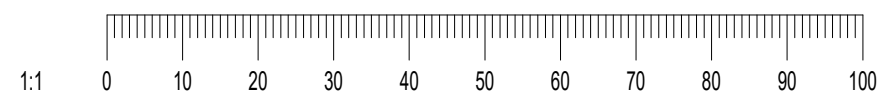

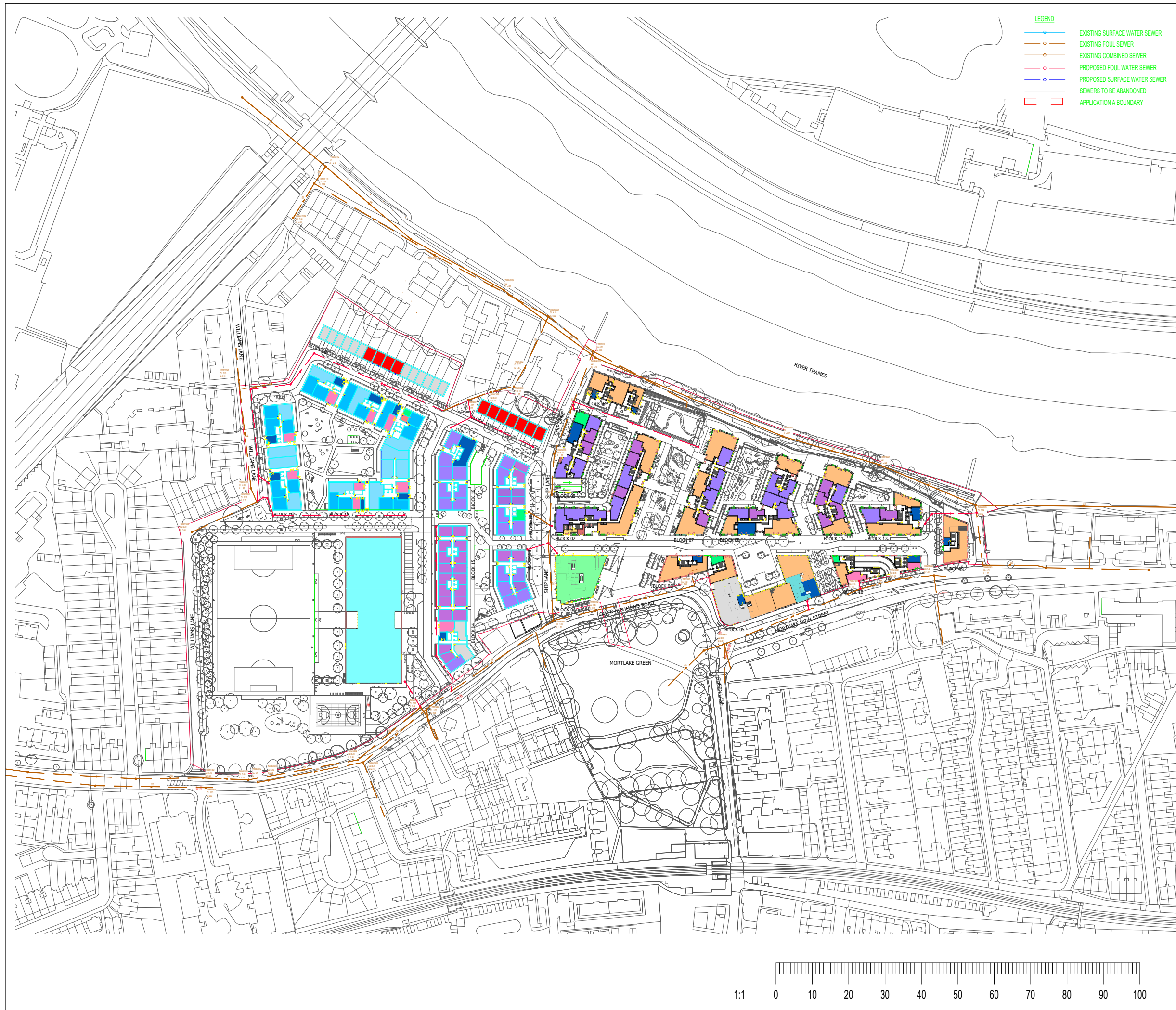

**LEGEND**

- EXISTING SURFACE WATER SEWER
- EXISTING FOUL SEWER
- EXISTING COMBINED SEWER
- PROPOSED FOUL WATER SEWER
- PROPOSED SURFACE WATER SEWER
- SEWERS TO BE ABANDONED
- - - APPLICATION A BOUNDARY

**GENERAL NOTES**

1. THIS DRAWING IS TO BE READ IN CONJUNCTION WITH ALL ENGINEER'S, ARCHITECT'S OR OTHER RELEVANT DRAWINGS AND SPECIFICATIONS.
2. ALL DIMENSIONS AND LEVELS ARE TO BE CHECKED ON SITE BY THE CONTRACTOR PRIOR TO PREPARING ANY WORKING DRAWINGS OR COMMENCING ON SITE.
3. THE CONTRACTOR MUST ENSURE AND WILL BE HELD RESPONSIBLE FOR THE OVERALL STABILITY OF THE BUILDING/STRUCTURE/EXCAVATION AT ALL STAGES OF THE WORK.
4. ALL WORK BY THE CONTRACTOR MUST BE CARRIED OUT IN SUCH A WAY THAT ALL REQUIREMENTS UNDER THE HEALTH AND SAFETY AT WORK ACT ARE SATISFIED.
5. ALL WORK IS TO BE CARRIED OUT IN COMPLIANCE WITH THE REQUIREMENTS OF THE RELEVANT STATUTORY AUTHORITIES AND REGULATIONS.
6. EXISTING DRAINAGE LAYOUT BASED ON THAMES WATER SEWER RECORDS AND PENBORN TECHNICAL SERVICES DRAWING (REF P979/07/31).
7. EXISTING FOUL AND SURFACE WATER CONNECTIONS TO BE RE-USED WHERE FEASIBLE, SUBJECT TO DETAILED DESIGN.

REV	S0	28.07.22	ISSUED	SW	BM
Status	Date	Description		By	Chk

Amendments

Project  
**STAG BREWERY**

Title  
**PROPOSED FOUL WATER DRAINAGE STRATEGY**

Client  
**RESELTON PROPERTIES LIMITED**



Office Address  
Telephone & Fax numbers  
mail@watermangroup.com www.watermangroup.com

Suitability  
**INITIAL STATUS (WIP)** S0

Designed By	Designer	Director	BM	Waterman Ref	IProjec
Drawn By	SW	Date	August 2022	Scales @ A3	1:25,000

Project - Originator - Volume - Level - Type - Role - Number	Revision
<b>18671-WIE-ZZ-ZZ-DR-D-92002</b>	<b>P01</b>

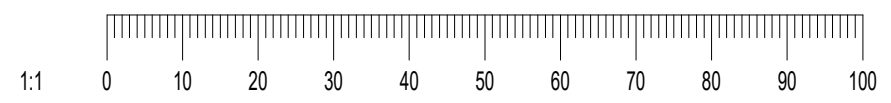

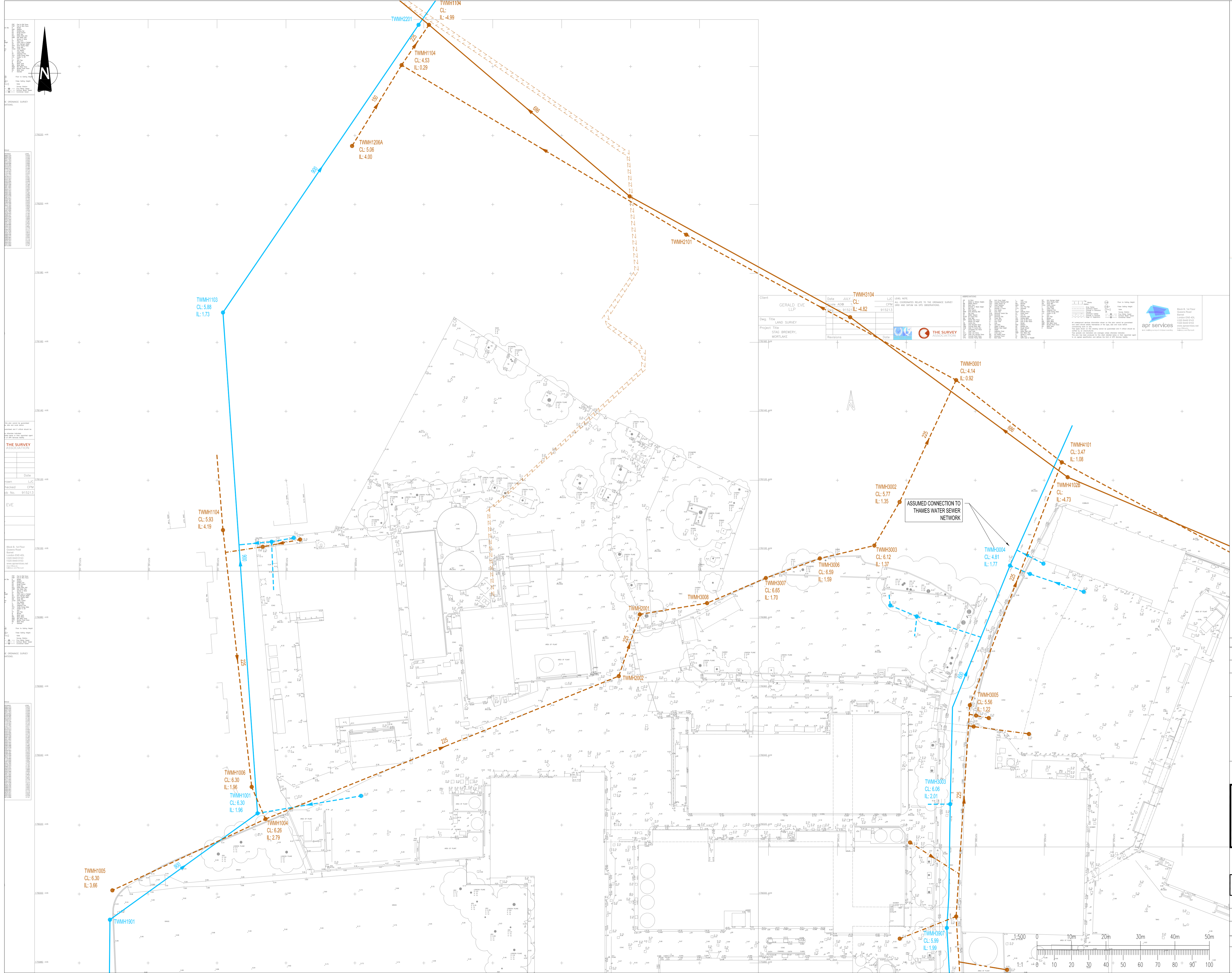

**LEGEND**

- EXISTING PRIVATE SURFACE WATER SEWER
- - -●- - - EXISTING PRIVATE FOUL SEWER
- EXISTING PRIVATE COMBINED SEWER
- EXISTING PUBLIC SURFACE WATER SEWER
- - -●- - - EXISTING PUBLIC FOUL SEWER
- EXISTING PUBLIC COMBINED SEWER
- - - - - EXISTING PUBLIC RISING MAIN

**NOTES**  
 1) EXISTING DRAINAGE LAYOUT BASED ON THAMES WATER SEWER RECORDS AND PENBORN TECHNICAL SERVICES DRAWING (REF: P979/07/31).

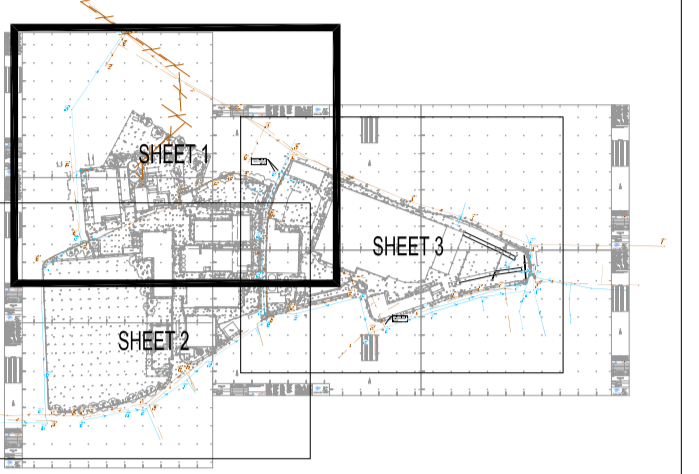

Client	GERALD EVE LLP	Date	JULY 2016	Drawn	ADG	Checked	ADG	Scale	AS SHOWN
Project Title	STAG BREWERY, MORTLAKE	Project No.	915213	Project Date	20160715	Project Status	PRELIMINARY	Project Location	MORTLAKE, LONDON

Rev	Date	Description	By
A01	20.10.16	PRELIMINARY ISSUE	DO

**Project**  
 Amendments  
**STAG BREWERY**

**Title**  
 EXISTING FOUL AND SURFACE WATER DRAINAGE LAYOUT  
 SHEET 1 OF 3

**Client**  
 DARTMOUTH CAPITAL ADVISORS LIMITED



**Drawing Status**  
**PRELIMINARY**

Designed by	Checked by	DO	Project No	WIE10667
Drawn by	DO	Date	OCTOBER 2016	Computer File No
Scales @ A1	1:500	Work to figure dimensions only	1:500	WIE10667CSA20001.dwg

Publisher	Zone	Category	Number	Revision
WIE	SA	92	0001	A01

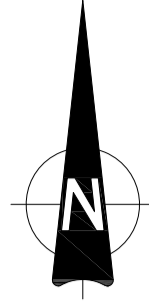

Revision	Date	Drawn	Checked	CPM
1	JULY 2015	LJC		



Revision	Date	Drawn	Checked	CPM
1	JULY 2015	LJC		

Client: GERALD EVE LLP

Project Title: STAG BREWERY, MORTLAKE

Scale: A09 1:200

Drawn: LJC

Checked: CPU

CPM: CPU

Date: JULY 2015

Drawn: LJC

Checked: CPU

CPM: CPU

Date: JULY 2015

Drawn: LJC

Checked: CPU

CPM: CPU

Date: JULY 2015

Drawn: LJC

Checked: CPU

CPM: CPU

Date: JULY 2015

Drawn: LJC

Checked: CPU

CPM: CPU

Date: JULY 2015

Drawn: LJC

Checked: CPU

CPM: CPU

Date: JULY 2015

Drawn: LJC

Checked: CPU

CPM: CPU

Date: JULY 2015

Drawn: LJC

Checked: CPU

CPM: CPU

Date: JULY 2015

Drawn: LJC

Checked: CPU

CPM: CPU

Date: JULY 2015

Drawn: LJC

Checked: CPU

CPM: CPU

Date: JULY 2015

Drawn: LJC

Checked: CPU

CPM: CPU

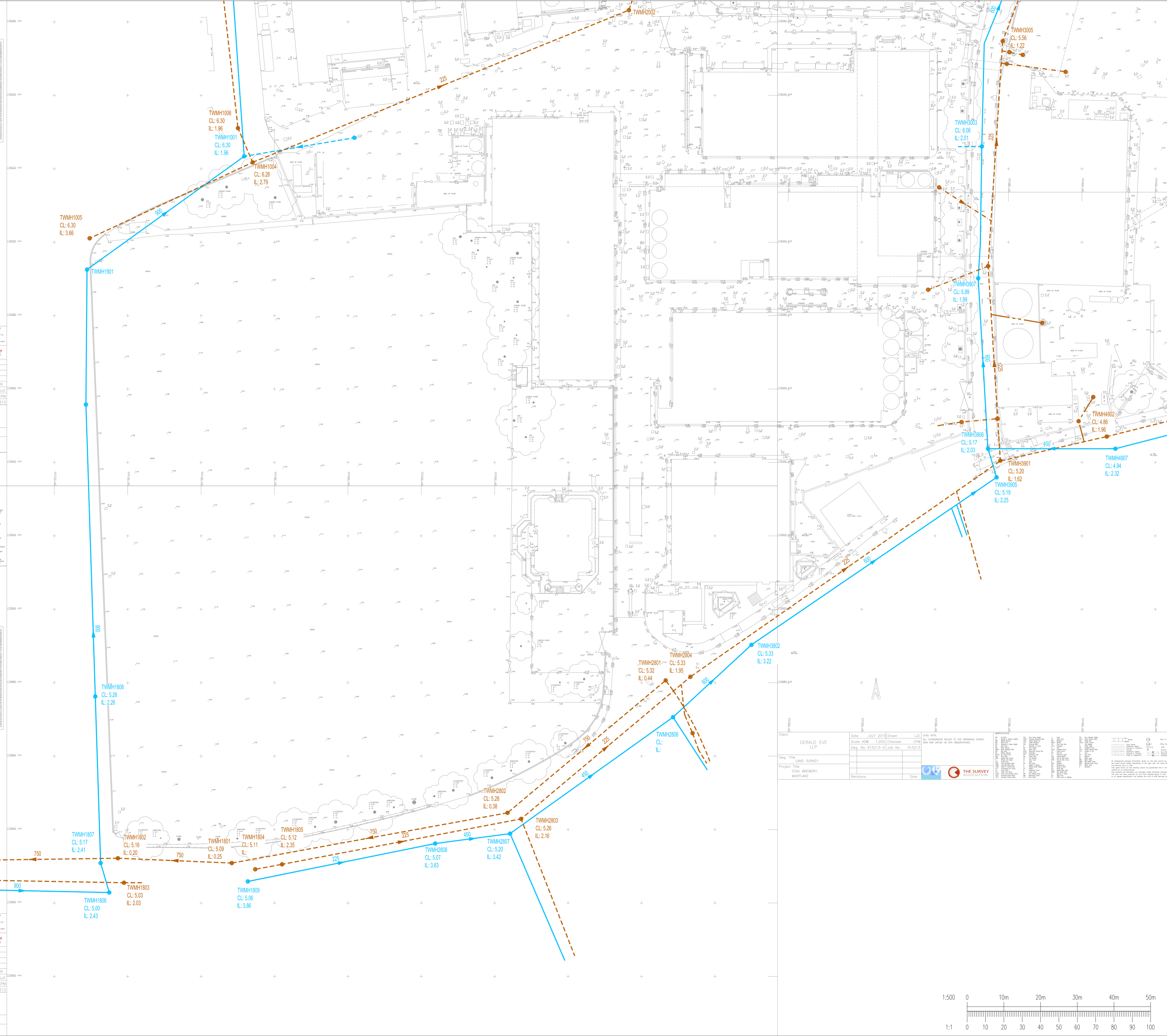

**LEGEND**

- EXISTING PRIVATE SURFACE WATER SEWER
- EXISTING PRIVATE FOUL SEWER
- EXISTING PRIVATE COMBINED SEWER
- EXISTING PUBLIC SURFACE WATER SEWER
- EXISTING PUBLIC FOUL SEWER
- EXISTING PUBLIC COMBINED SEWER
- EXISTING PUBLIC RISING MAIN

**NOTES**  
1) EXISTING DRAINAGE LAYOUT BASED ON THAMES WATER SEWER RECORDS AND PENBORN TECHNICAL SERVICES DRAWING (REF: P97907/31).

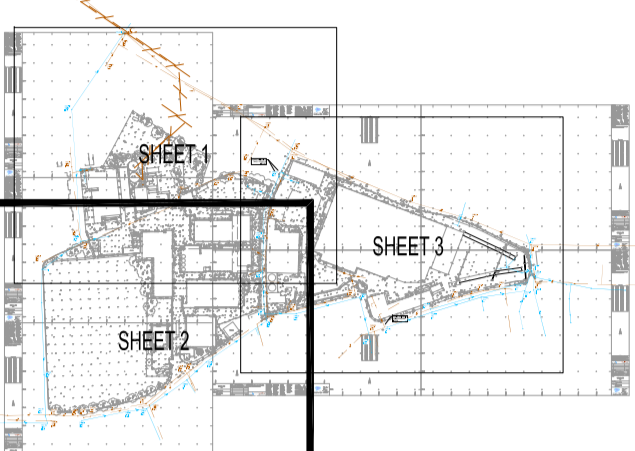

Rev	Date	Description	By
A01	20.10.16	PRELIMINARY ISSUE	DO

**Project**  
STAG BREWERY

**Title**  
EXISTING FOUL AND SURFACE WATER DRAINAGE LAYOUT SHEET 2 OF 3

**Client**  
DARTMOUTH CAPITAL ADVISORS LIMITED



Drawing Status				
<b>PRELIMINARY</b>				
Designed by	Checked by	DO	Project No	WIE10667
Drawn by	DO	Date	OCTOBER 2016	Computer File No
Scales @ A1				WIE10667CSA20002.dwg
work to figured dimensions only				1:500
Publisher	Zone	Category	Number	Revision
WIE	SA	92	0002	A01

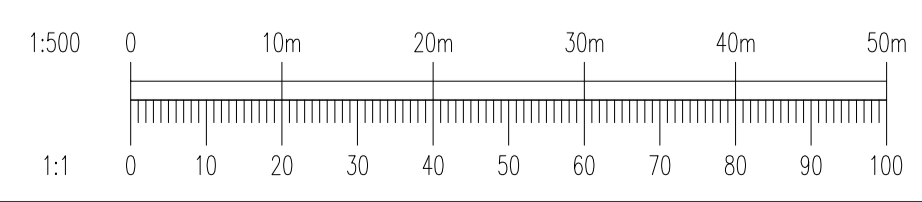

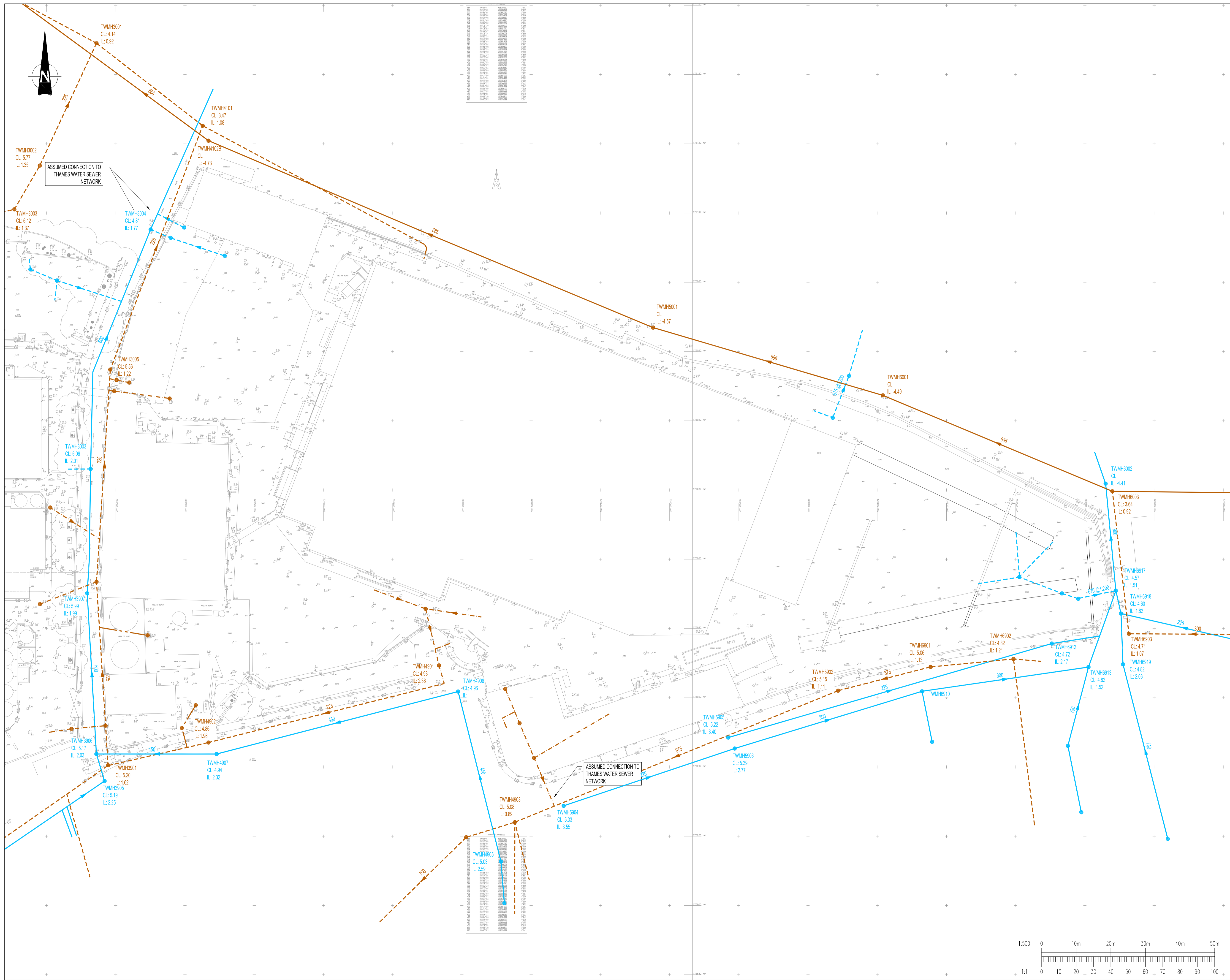

**LEGEND**

- EXISTING PRIVATE SURFACE WATER SEWER
- EXISTING PRIVATE FOUL SEWER
- EXISTING PRIVATE COMBINED SEWER
- EXISTING PUBLIC SURFACE WATER SEWER
- EXISTING PUBLIC FOUL SEWER
- EXISTING PUBLIC COMBINED SEWER
- EXISTING PUBLIC RISING MAIN

**NOTES**  
 1) EXISTING DRAINAGE LAYOUT BASED ON THAMES WATER SEWER RECORDS AND PENBORN TECHNICAL SERVICES DRAWING (REF: P979/07/31).

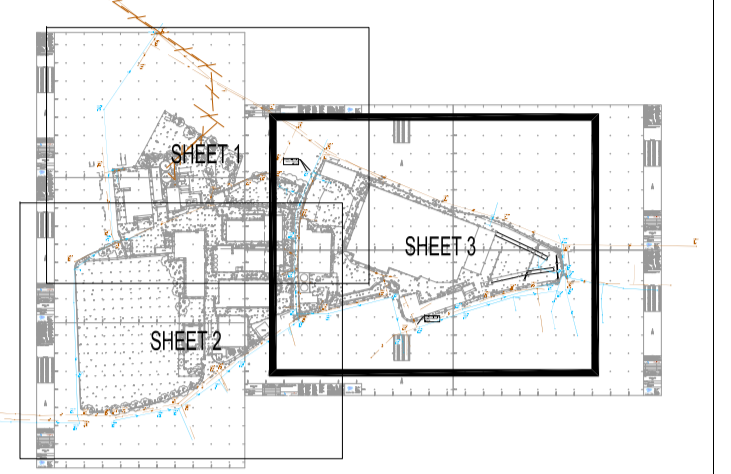

Rev	Date	Description	By
A03	21.11.16	INVERT/COVER LEVELS ADDED	DO
A02	24.10.16	VIEWPORT AMENDED	DO
A01	20.10.16	PRELIMINARY ISSUE	DO

Amendments

**Project**  
STAG BREWERY

**Title**  
EXISTING FOUL AND SURFACE WATER DRAINAGE LAYOUT SHEET 3 OF 3

**Client**  
DARTMOUTH CAPITAL ADVISORS LIMITED



<b>PRELIMINARY</b>				
Designed by	Checked by	DO	Project No	WIE10667
Drawn by	DO	Date	OCTOBER 2016	Computer File No WIE10667CSA282003.dwg
Scalcs @ A1 work to figured dimensions only	1:500			
Publsher	Zone	Category	Number	Revision
WIE	SA	92	0003	A03

