

01 Proposed Elevation
scale 1:20

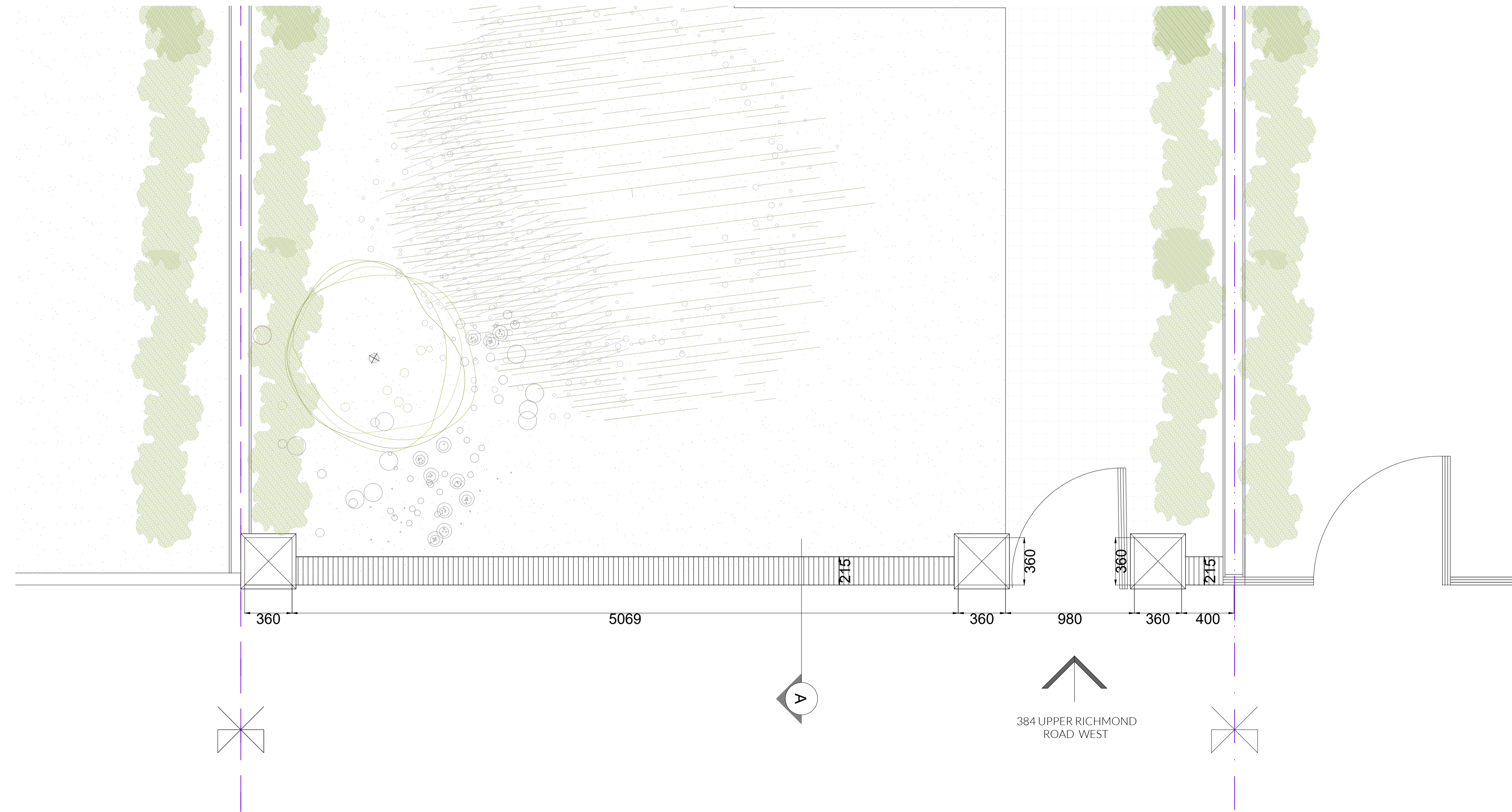

02 Proposed Plan
scale 1:20

General Notes:

- Site and existing buildings are based upon survey drawings received from clients dated 03.2017, supplied by ENGINEERING LAND&BUILDING SURVEYS, from previous home owners. All drawings are subject to Planning and Building Control consent.
- The details shown are for design intent purposes only and are subject to further design development with suppliers and sub-contractors.
- Proposal subject to consultation and approval from Building Control/Approved Inspector.
- All setting out dimensions should be checked onsite prior to construction and any discrepancies and/or omissions should be reported to the Architect immediately.
- For all structural and underground drainage layouts refer to Structural Engineer's drawings.
- Tree protection to be put in place prior to any work commencing on site in accordance with agricultural report
- Do not scale off drawings, if in doubt ask.

Disclaimer
Our services exclude fire safety advice and a specialist Fire Specialist Consultant will need to be appointed. L+ Architects shall not be liable against any claim or loss arising directly or indirectly out of or in any way involving the combustibility or fire safety requirements of any cladding, glazing, doors, balconies, roofs, roof voids, roof cavities, external wall system (including anything attached thereto) and/or internal wall system (including ceilings and floors) of any building or structure; including any component or material used in the manufacture, assembly or construction thereof.

384
Upper Richmond Road West
L+2415

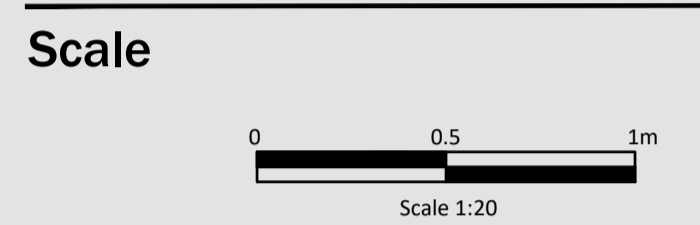

Revisions

Rev.	Date	Details	Drawn	Checked
A		PLANNING	GL	PL

Drawn By: GL Date: 25.03.24 Checked By: PL Date: 25.03.24

Issued for:

PLANNING	
Drawing:	Project No:
GENERAL ARRANGEMENT	L+2415
PROPOSED FLOOR PLAN	Scale:
PROPOSED ELEVATION	1:20 @A1
Project/Client:	Dwg No:
Ms.Kate Nodulman	L+2415_10_101
	Rev: A

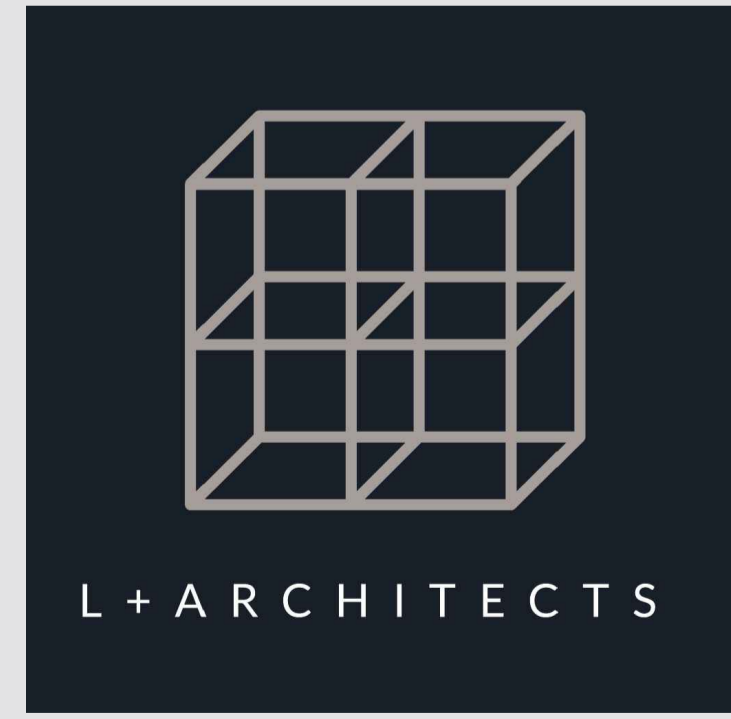

Notes:

- All drawings are subject to Planning and Building Control consent.
- The details shown are for design intent purposes only and are subject to further design development with suppliers and sub-contractors
- Proposals subject to consultation and approval from Local Authority Building Control or an Approved Inspector
- All setting out dimensions should be checked on-site prior to construction and any discrepancies and/or omissions should be reported to the Architect immediately

499 Upper Richmond Road W, North Street, London SW12 7DE
T: 020 8274 9933 E: office@lplusarchitects.com Web: www.lplusarchitects.com
© Lplus Architects Ltd. Contractors must work only to figured dimensions which are to be checked on site.