

# GEORGE HOUSE FRAME TEMPORARY WORKS - FOUNDATION PLAN

**CO-ORDINATION REQUIRED WITH SUBCONTRACTORS AND LEAD DESIGNERS**

**GENERAL NOTES**  
1. IF IN DOUBT, ASK  
2. DO NOT SCALE OFF THE DRAWINGS  
3. TO BE READ IN CONJUNCTION WITH OTHER CONSULTANT'S DRAWINGS  
4. THE DESIGN IS BASED ON LIMITED INVESTIGATION WORKS DONE BY OTHERS. FURTHER REVIEW OF THE SCHEME IS REQUIRED AFTER STRIP-OUT TO CONFIRM THE ASSUMPTIONS MADE AT THIS STAGE

**NO WORK IS TO BE CARRIED OUT UNTIL THE FOUNDATION PLAN IS ACTIONED. REFER TO CONSTRUCTION SEQUENCE**

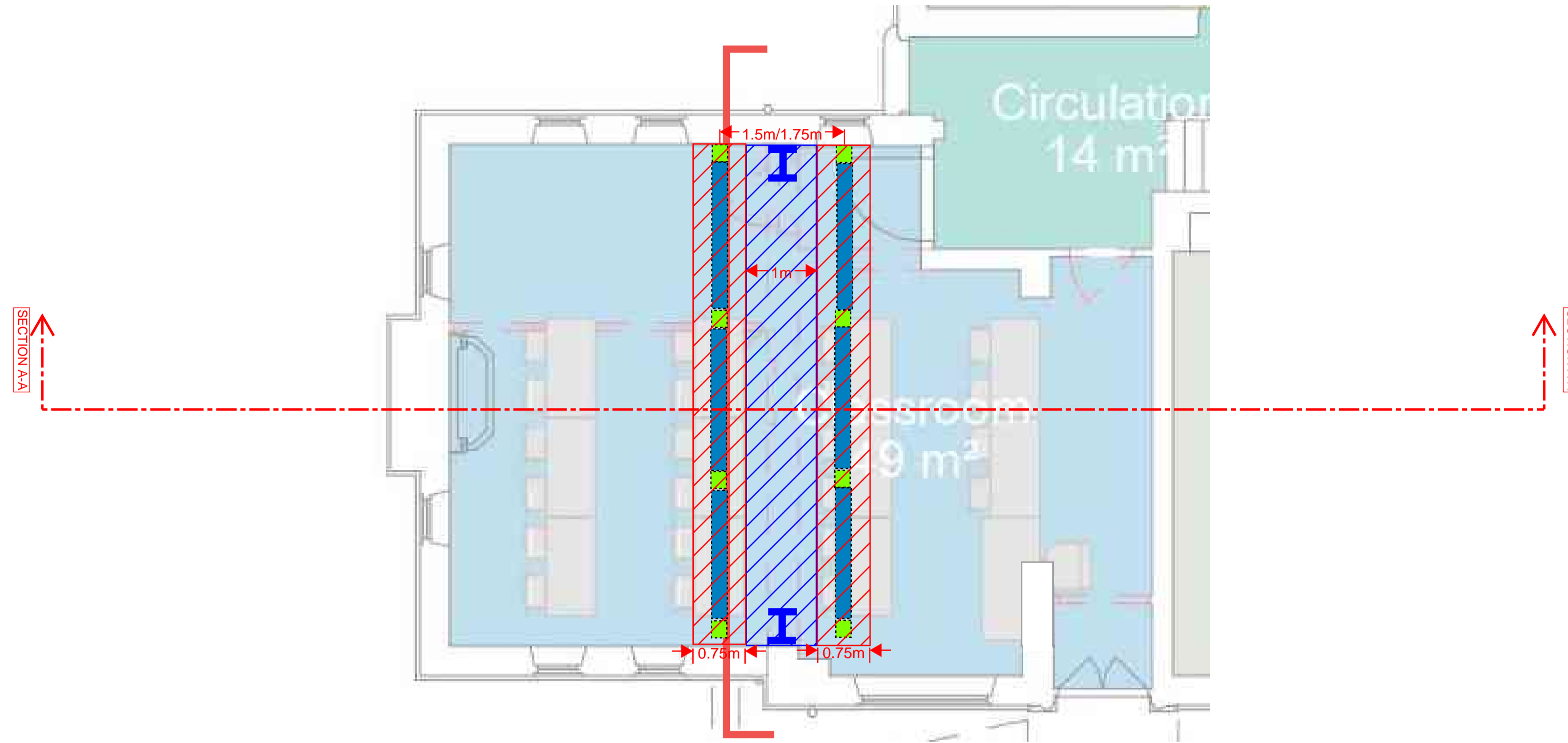

- INDICATIVE CONSTRUCTION SEQUENCE:**
1. TRENCH FOUNDATIONS TO BE DUG FOR THE TEMPORARY PROPS.
  2. WHEN TRENCHES DUG, TEMPORARY PROPS CAN BE ERECTED.
  3. ONLY WHEN TRENCH FOUNDATIONS AND TEMPORARY PROPS INSTALLED CAN THE REMOVAL OF THE STABILITY WALL COMMENCE
  4. REMOVE WALL.
  5. WHEN WALL IS FULLY REMOVED, THE MIDDLE SECTION OF THE SLAB CAN BE LIFTED TO ALLOW FOR REMAINING SECTION OF FOUNDATION TO BE INFILLED.
  6. WHEN THIS IS COMPLETE, THE MOMENT FRAME CAN BE INSTALLED
  7. UPON COMPLETION OF THE PERMANENT WORKS, TEMPORARY PROPPING CAN THEN BE REMOVED

**FOUNDATION WIDTH MATCHES THAT OF INTEGRAL'S PROPOSED PERMANENT WORKS PAD FOUNDATION (2.5m). A MIN. DEPTH OF 1m IS REQUIRED**

**PROP PLACED CENTRALLY OVER "TRENCH" FOUNDATION**

**TRENCH FOUNDATION**

**TRENCH FOUNDATIONS**

**REMAINING FOUNDATION INFILL (REFER TO CONSTRUCTION SEQUENCE)**

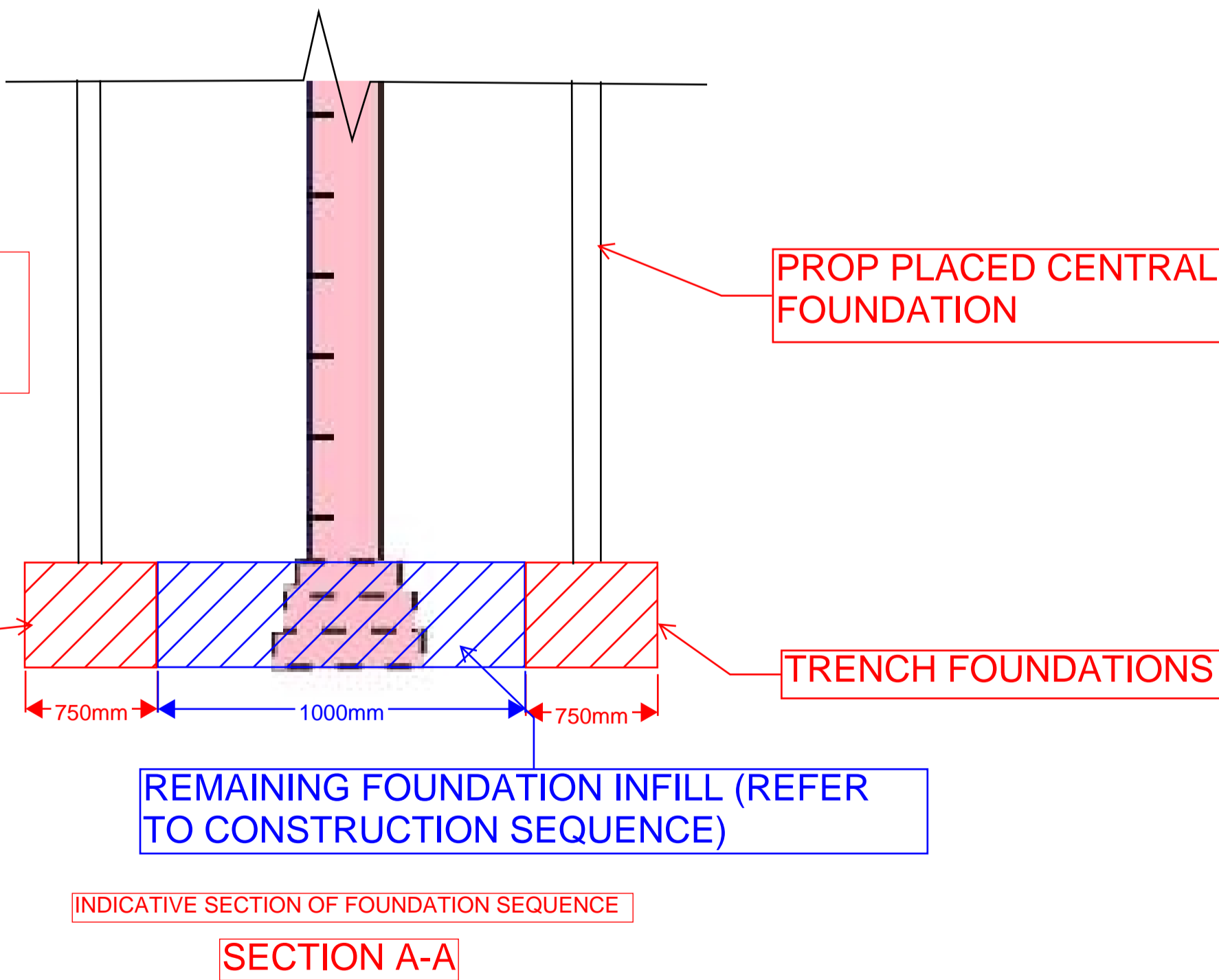

**DRAWINGS ARE PRELIMINARY AND ARE ONLY TO BE USED FOR INDICATIVE INFORMATION AND TENDER.**

**FURTHER CONSTRUCTION ISSUES WILL NEED TO BE DETAILED DESIGNED**

T00	22/04/24	ISSUE OF INFORMATION FOR TENDER	PC	SC	MA
Rev	Date	Description	By	Chk	App



**CLIENT**  
BUXTON

**PROJECT**  
ST. THOMAS'S SCHOOL, RICHMOND

**DRAWING TITLE**  
GEORGE HOUSE FRAME TEMPORARY WORKS PLAN - FOUNDATION PLAN

**STATUS**  
TENDER

Date:	18/04/24	Scale:	NA	Drawn:	PC	Chk:	SC	App:	MA
Project No.:	L1617	Dwg. No.:	L1617 - SK07	Rev:					T00

# GEORGE HOUSE FRAME TEMPORARY WORKS

CO-ORDINATION REQUIRED WITH SUBCONTRACTORS AND LEAD DESIGNERS

GENERAL NOTES

1. IF IN DOUBT, ASK
2. DO NOT SCALE OFF THE DRAWINGS
3. TO BE READ IN CONJUNCTION WITH OTHER CONSULTANT'S DRAWINGS
4. THE DESIGN IS BASED ON LIMITED INVESTIGATION WORKS DONE BY OTHERS. FURTHER REVIEW OF THE SCHEME IS REQUIRED AFTER STRIP-OUT TO CONFIRM THE ASSUMPTIONS MADE AT THIS STAGE

INDICATIVE AREA TO TAKE A STANDARD SCAFFOLD TO ALLOW MATERIALS TO BE MOVED UP STRUCTURE AT SITE.

SCAFFOLDING HEIGHT IS APPROXIMATELY 10.7m. THIS SCAFFOLD CAN ALSO BE MIRRORED ON THE OPPOSITE SIDE OF FRAME

LEGEND:

SIZE 2 TITAN S TELESCOPIC PROP	
SIZE 2 TITAN MEGASHORE LEG	
SIZE 4 TITAN MEGASHORE LEG	
TITAN RSK NO.4	
SYSTEM 160 152x152 UC 37	

LOAD CAPACITIES

SIZE 2 TITAN S TELESCOPIC PROP:	25kN
SIZE 2 TITAN MEGASHORE LEG:	54kN (SCREW JACK AT TOP)
SIZE 4 TITAN MEGASHORE LEG:	128kN (SCREW JACK AT TOP)
TITAN RSK NO.4:	40kN TENSILE FORCE

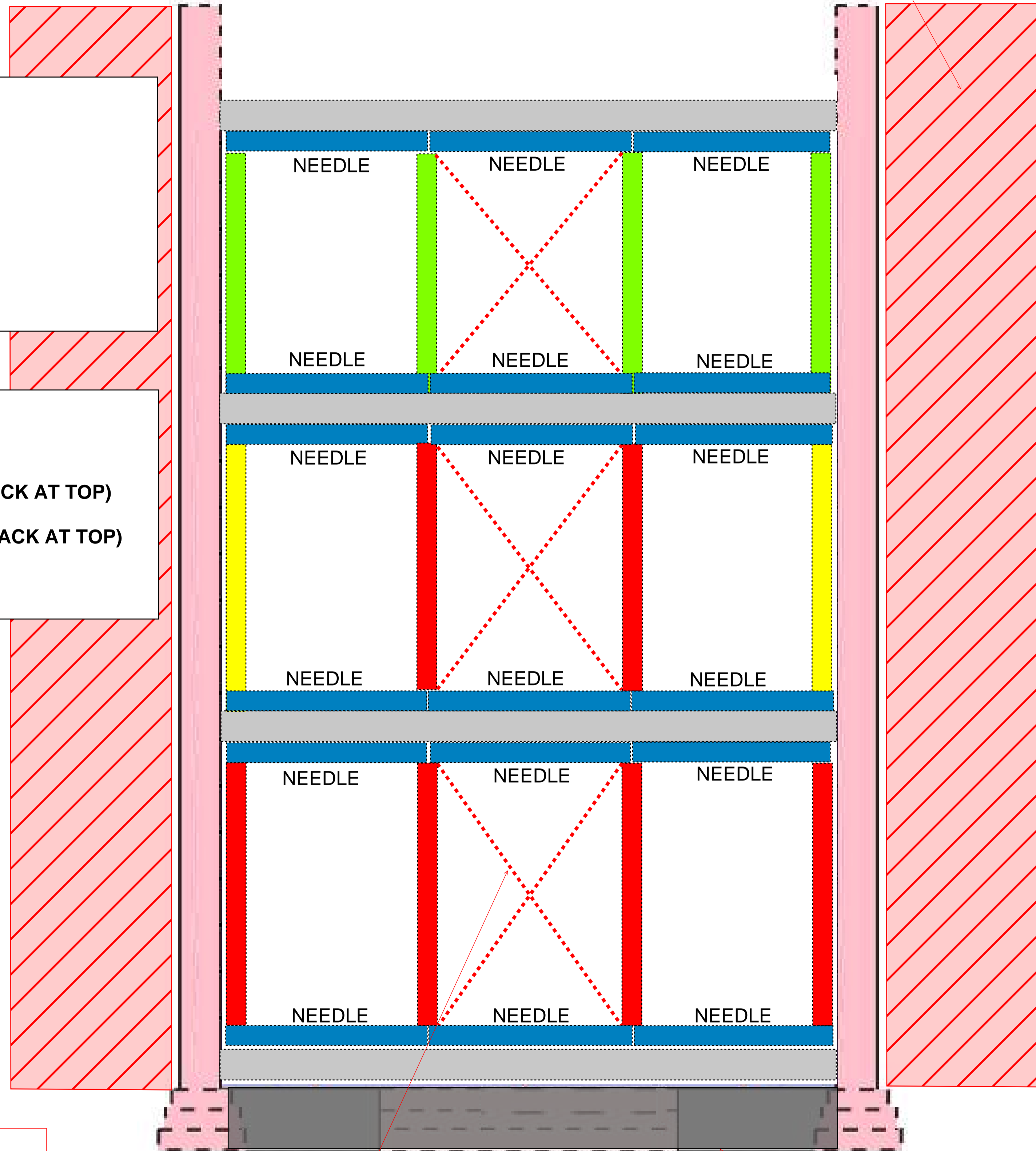

THE FIGURES USED ARE BASED ON THE ASSUMPTION THAT ALL PROPS BEING USED ARE NEW

DRAWINGS ARE PRELIMINARY AND ARE ONLY TO BE USED FOR INDICATIVE INFORMATION AND TENDER. FURTHER CONSTRUCTION ISSUES WILL NEED TO BE DETAILED DESIGNED

IN BRACED BAYS, ONLY 1 BRACE IS REQUIRED. THE DASHED LINES REPRESENT OPTION ROTATIONS

REFER TO FOUNDATION PLAN FOR FOUNDATION DETAILS

INDICATIVE CONSTRUCTION SEQUENCE:

1. TRENCH FOUNDATIONS TO BE DUG FOR THE TEMPORARY PROPS.
2. WHEN TRENCHES DUG, TEMPORARY PROPS CAN BE ERECTED.
3. ONLY WHEN TRENCH FOUNDATIONS AND TEMPORARY PROPS INSTALLED CAN THE REMOVAL OF THE STABILITY WALL COMMENCE
4. REMOVE WALL.
5. WHEN WALL IS FULLY REMOVED, THE MIDDLE SECTION OF THE SLAB CAN BE LIFTED TO ALLOW FOR REMAINING SECTION OF FOUNDATION TO BE INFILLED.
6. WHEN THIS IS COMPLETE, THE MOMENT FRAME CAN BE INSTALLED
7. UPON COMPLETION OF THE PERMANENT WORKS, TEMPORARY PROPPING CAN THEN BE REMOVED

T00	22/04/24	ISSUE OF INFORMATION FOR TENDER	PC	SC	MA
Rev	Date	Description	By	Chk	App



CLIENT: BUXTON

PROJECT: ST. THOMAS'S SCHOOL, RICHMOND

DRAWING TITLE: GEORGE HOUSE FRAME TEMPORARY WORKS

STATUS: TENDER

Date:	19/04/24	Scale:	NA	Drawn:	PC	Chk:	SC	App:	MB
Project No.:	L1617	Drwg. No.:	L1617 - SK08						

# GEORGE HOUSE FRAME TEMPORARY WORKS TYPICAL PLAN

## PLAN VIEW TAKEN AT SECOND FLOOR

**LEGEND:**

- SIZE 2 TITAN S TELESCOPIC PROP
- SIZE 2 TITAN MEGASHORE LEG
- SIZE 4 TITAN MEGASHORE LEG
- TITAN RSK NO.4
- 152x152 UC 37

INDICATIVE AREA TO TAKE A STANDARD SCAFFOLD TO ALLOW MATERIALS TO BE MOVED UP STRUCTURE AT SITE.  
SCAFFOLDING HEIGHT IS APPROXIMATELY 10.7m.

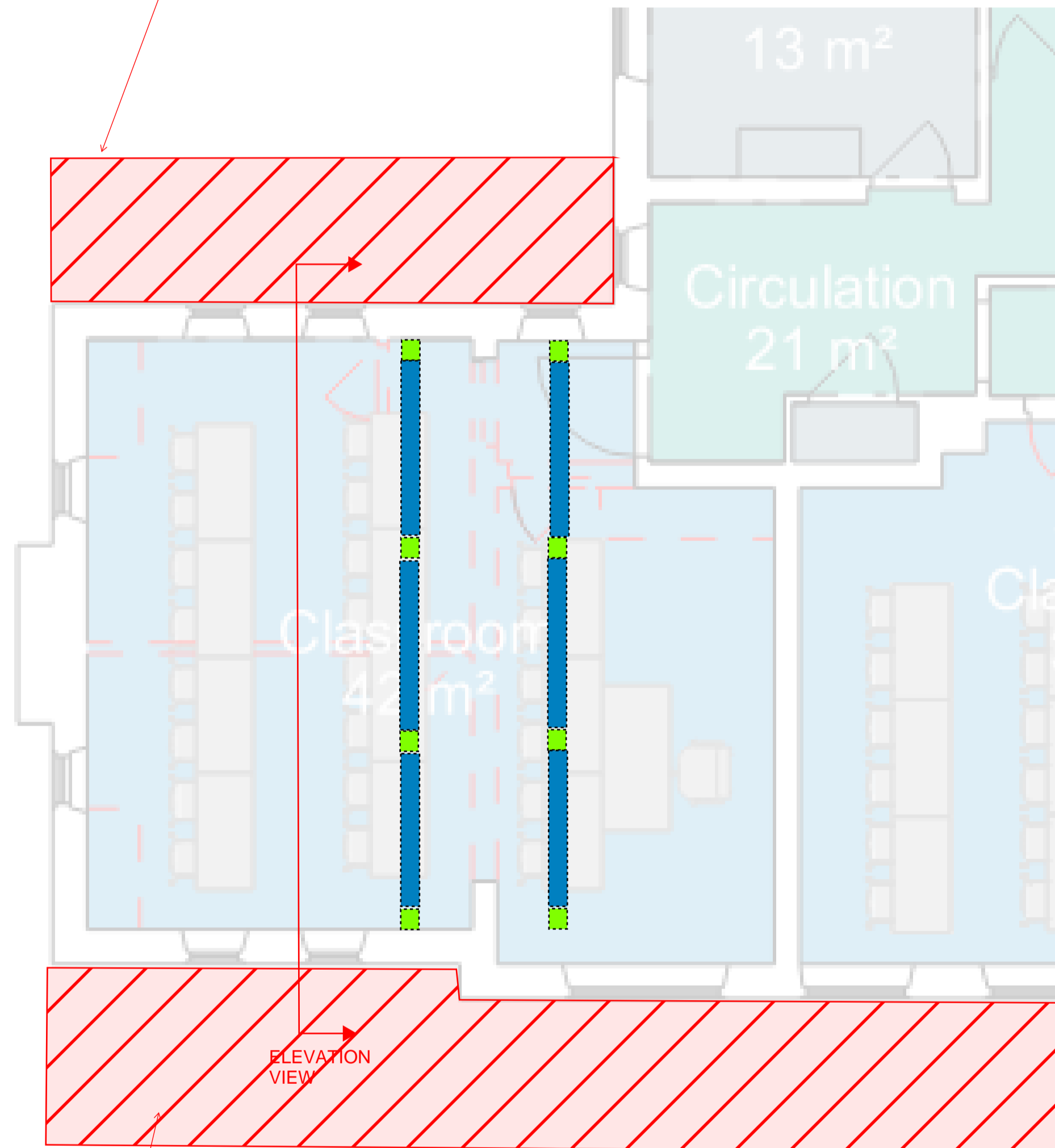

INDICATIVE AREA TO TAKE A STANDARD SCAFFOLD TO ALLOW MATERIALS TO BE MOVED UP STRUCTURE AT SITE.  
SCAFFOLDING HEIGHT IS APPROXIMATELY 10.7m

THE FIGURES USED ARE BASED ON THE ASSUMPTION THAT ALL PROPS BEING USED ARE NEW

DRAWINGS ARE PRELIMINARY AND ARE ONLY TO BE USED FOR INDICATIVE INFORMATION AND TENDER.

FURTHER CONSTRUCTION ISSUES WILL NEED TO BE DETAILED DESIGNED

**CO-ORDINATION REQUIRED WITH SUBCONTRACTORS AND LEAD DESIGNERS**

**GENERAL NOTES**

1. IF IN DOUBT, ASK
2. DO NOT SCALE OFF THE DRAWINGS
3. TO BE READ IN CONJUNCTION WITH OTHER CONSULTANT'S DRAWINGS
4. THE DESIGN IS BASED ON LIMITED INVESTIGATION WORKS DONE BY OTHERS. FURTHER REVIEW OF THE SCHEME IS REQUIRED AFTER STRIP-OUT TO CONFIRM THE ASSUMPTIONS MADE AT THIS STAGE

T00	22/04/24	ISSUE OF INFORMATION FOR TENDER	PC	SC	MA
Rev	Date	Description	By	Chk	App



CLIENT  
**BUXTON**

PROJECT  
**ST. THOMAS'S SCHOOL, RICHMOND**

DRAWING TITLE  
**GEORGE HOUSE FRAME TEMPORARY WORKS PLAN**

STATUS  
**TENDER**

Date:	19/04/24	Scale:	NA	Drawn:	PC	Chk:	SC	App:	MB
Project No.:	L1617	Dwg. No.:	L1617 - SK09	Rev:					T00